

- (1) All persons employed by the AGENCY during the term of the Contract to perform employment duties within Florida; and
- (2) All persons, including subcontractors, assigned by the AGENCY to perform work pursuant to the contract with the DEPARTMENT.

Except as modified by this amendment, all terms and conditions of the Agreement shall remain in full force and effect.

Exhibits

- Exhibit A – Landscape Improvements Location & Maintenance Boundaries
- Exhibit B – Landscape Improvements Plans
- Exhibit C – Maintenance Plan for Landscape Improvements
- Exhibit D – Approximate Cost for Landscape Improvements

In Witness whereof, the parties hereto have executed with this Amendment effective the 23 day May year written and approved.

CITY OF COCONUT CREEK

State of Florida
Department of Transportation

BY:

BY:

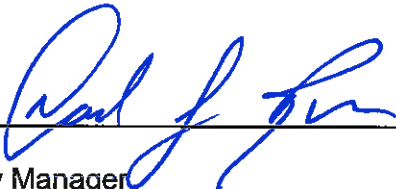

City Manager



Director of Transportation Development



ATTEST:



City Clerk

5/16/11
Date



District General Counsel

5/23/2011
Date



Agency Attorney

5/16/11
Date

NANCY A. COUSINS

SECTION NO: 86039000
S.R. NO(S): 814 (Atlantic Blvd)
COUNTY: Broward
FM NO.(S): 426010-1-58-01
426011-1-58-01

EXHIBIT A

**PROJECT LOCATION AND LANDSCAPE IMPROVEMENTS
MAINTENANCE BOUNDARIES**

I. GRANT PROJECT LOCATION(S) INCLUDE THE FOLLOWING:

State Road 814 (Atlantic Blvd) from 1,750ft west of Lyons Road (M.P. 0.899) to Florida's Turnpike (M.P. 1.715)

**II. INCLUSIVE LIMITS OF LANDSCAPE IMPROVEMENTS MAINTENANCE FOR
SR 814 (ATLANTIC BLVD):**

State Road 814 (Atlantic Blvd) from East Hemingway Court (M.P. 0.753) to Florida's Turnpike (M.P. 1.715)

**III. LANDSCAPE IMPROVEMENTS MAINTENANCE MAP FOR THIS GRANT
PROJECT: SEE ATTACHED**

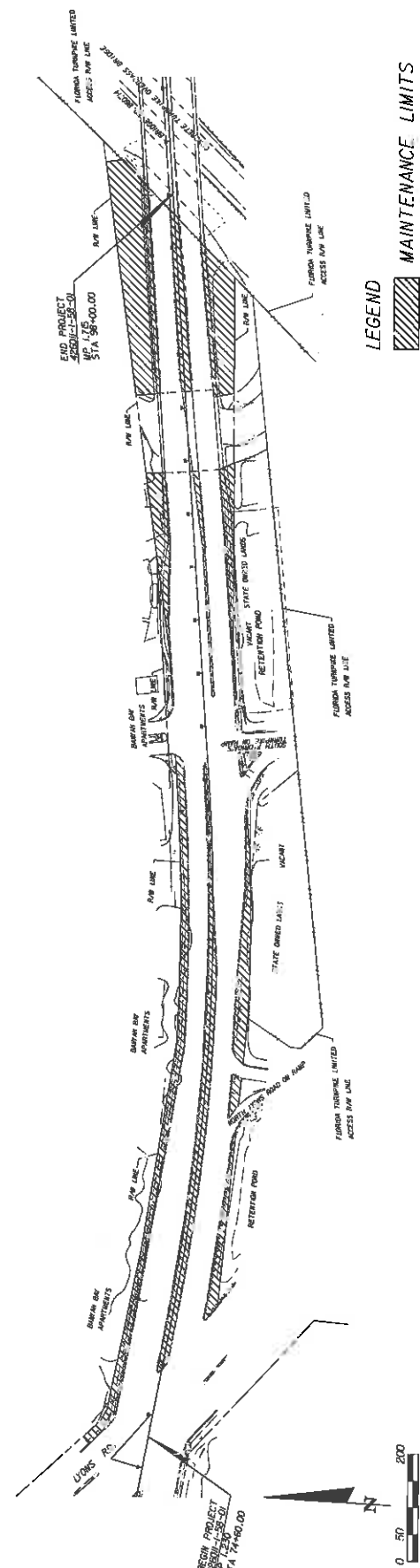
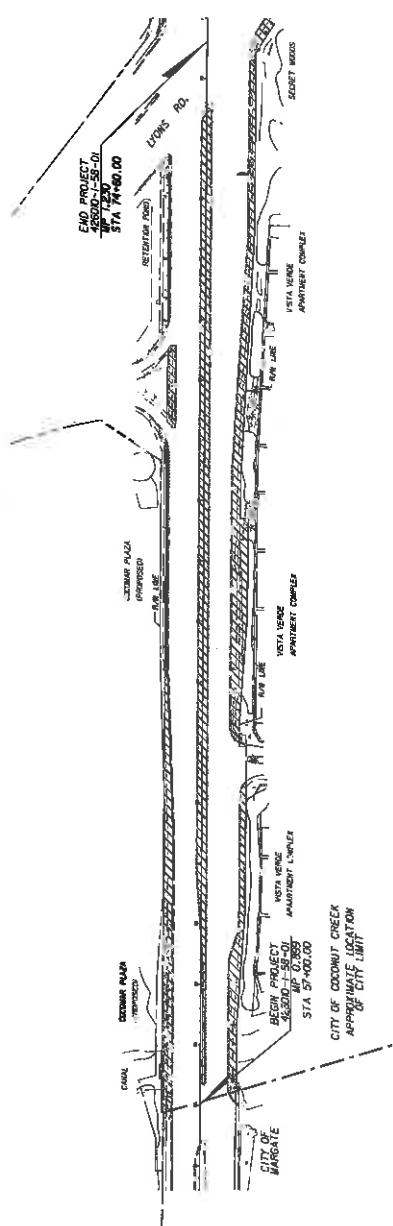

LEGEND
 MAINTENANCE LIMITS

DATE	BY	DESCRIPTION	REVISIONS

 MILLER LEGG 5701 North Loop West, Suite 1000, Houston, TX 77057-3004 (713) 865-9800 Fax: (713) 865-5561 City of North Little Rock, AR (501) 666-6670		CITY OF COCONUT CREEK	
		ROAD NO. 814	COUNTY BROWARD

SHEET NO.	A
-----------	---

SECTION NO: 86039000
S.R. NO(S): 814 (Atlantic Blvd)
COUNTY: Broward
FM NO.(S): 426010-1-58-01
426011-1-58-01

EXHIBIT B

LANDSCAPE IMPROVEMENT PLANS

The **AGENCY** agrees to install the landscape improvements in accordance with the plans and specifications attached hereto and incorporated herein.

Please see attached plans prepared by: **Miller Legg and Associates**
Brian Shore, RLA

Dated: March 8, 2011

CONTRACT PLANS

BROWARD COUNTY

STATE ROAD NO. 814 / ATLANTIC BOULEVARD

F.M. 426010-1-58-01 FROM WEST OF LYONS ROAD (M.P. 0.899) TO LYONS ROAD (M.P. 1.230)
 F.M. 426011-1-58-01 FROM LYONS ROAD (M.P. 1.230) TO FLORIDA'S TURNPIKE (M.P. 1.715)

LANDSCAPE BEAUTIFICATION PROJECT

CORAL SPRINGS

END PROJECT
 F.M. 426011-1-58-01
 M.P. 1.715 STA. 98+00.00
 BEGIN PROJECT
 F.M. 426011-1-58-01
 M.P. 1.230 STA. 74+60.00
 TAMARAC
 END PROJECT
 F.M. 426010-1-58-01
 M.P. 1.230 STA. 74+60.00
 BEGIN PROJECT
 F.M. 0.899 STA. 57+00.00



City of Coconut Creek

480 West Cypress Road
 561-973-6770 Fax: 561-973-6774
 www.coconutcreek.org

Mayor: Lisa K. Annonson
 Vice Mayor: Lou Sabone
 Commissioner: Marilyn Garber
 Commissioner: Becky Tooley
 Commissioner: Mikkie Belvedere
 City Manager: David J. Rivera

GOVERNING STANDARDS AND SPECIFICATIONS:
 FLORIDA DEPARTMENT OF TRANSPORTATION,
 DESIGN STANDARDS DATED 2004,
 STANDARD SPECIFICATIONS FOR ROAD AND
 BRIDGE CONSTRUCTION, LATEST EDITION,
 AS AMENDED BY CONTRACT DOCUMENTS.

APPLICABLE DESIGN STANDARDS MODIFICATIONS: D-0-0-0
 For design standards modifications click on "Design
 Standards" in the following web site:
<http://www.dot.state.fl.us/Transportation/DesignStandards/Standards.htm>

WESTERN HALF F.M. 426010-1-58-01
 EASTERN HALF F.M. 426011-1-58-01

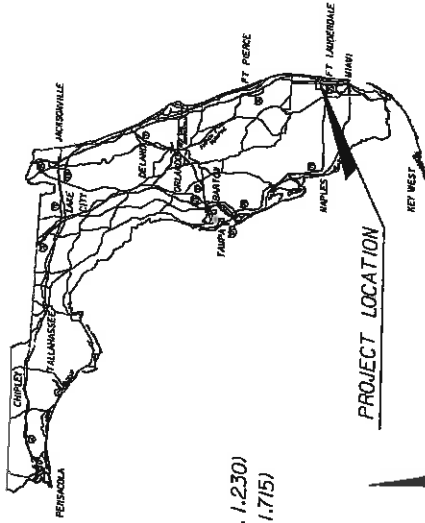

PROJECT LOCATION

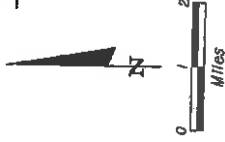

PLANS PREPARED BY:

MILLER LEGG
 5741 N. Andrews Way, Fort Lauderdale, Florida 33309-2864
 954-436-7000 Fax: 954-436-8864 www.millerlegg.com
 Certification of Professional Engineer: LD0000037

NOTE: THE SCALE OF THESE PLANS MAY
 HAVE CHANGED DUE TO REPRODUCTION.
 DESIGN SPEED: 45 MPH

Handwritten: 3-2-11

SHEET NO.	LD-1
-----------	------

DATE: 11/20/09 3/7/2010 9:47:05 AM 9:47:05 AM 3/7/2010 9:47:05 AM 3/7/2010 9:47:05 AM

TABULATION OF QUANTITIES / PLANT SCHEDULE

PAY ITEM NO.	SYM	PA YBZLZ	BOTALANCAL NAME	COMMON NAME	INSTALLED SIZE	MAX. MAINTAINED SIZE	SPACING	REMARKS	NATIVE	DROUGHT TOLERANCE	UNIT	SHEET NUMBERS								TOTAL THIS SHEET					
												LD-3	LD-4	LD-5	LD-6	LD-7	LD-8	LD-9	LD-10		LD-11	LD-12	LD-13	LD-14	
107-LITTER REMOVAL AND DISPOSAL																									
Litter Removal and Disposal																									
107-1	107YBZ																								
286-70 LINE ROCK BASE																									
Mobility																									
1																									
523-2 PATTER CONCRETE																									
New concrete base																									
1																									
580-43 PATTER CONCRETE																									
New concrete base																									
1																									
582-1 LANDSCAPE TURF																									
St. Augustine Sod																									
1																									
582-2 LANDSCAPE TURF																									
St. Augustine Sod																									
1																									
583-1 LANDSCAPE LARGE																									
St. Augustine Sod																									
1																									
583-2 LANDSCAPE SMALL																									
St. Augustine Sod																									
1																									
584-3 PATTER CONCRETE																									
New concrete base																									
1																									
584-4 PATTER CONCRETE																									
New concrete base																									
1																									
585-1 LANDSCAPE LARGE																									
St. Augustine Sod																									
1																									
585-2 LANDSCAPE SMALL																									
St. Augustine Sod																									
1																									
585-3 LANDSCAPE TURF																									
St. Augustine Sod																									
1																									
585-4 LANDSCAPE TURF																									
St. Augustine Sod																									
1																									
585-5 LANDSCAPE TURF																									
St. Augustine Sod																									
1																									
585-6 LANDSCAPE TURF																									
St. Augustine Sod																									
1																									
585-7 LANDSCAPE TURF																									
St. Augustine Sod																									
1																									
585-8 LANDSCAPE TURF																									
St. Augustine Sod																									
1																									
585-9 LANDSCAPE TURF																									
St. Augustine Sod																									
1																									
585-10 LANDSCAPE TURF																									
St. Augustine Sod																									
1																									
585-11 LANDSCAPE TURF																									
St. Augustine Sod																									
1																									
585-12 LANDSCAPE TURF																									
St. Augustine Sod																									
1																									
585-13 LANDSCAPE TURF																									
St. Augustine Sod																									
1																									
585-14 LANDSCAPE TURF																									
St. Augustine Sod																									
1																									
585-15 LANDSCAPE TURF																									
St. Augustine Sod																									
1																									
585-16 LANDSCAPE TURF																									
St. Augustine Sod																									
1																									
585-17 LANDSCAPE TURF																									
St. Augustine Sod																									
1																									
585-18 LANDSCAPE TURF																									
St. Augustine Sod																									
1																									
585-19 LANDSCAPE TURF																									
St. Augustine Sod																									
1																									
585-20 LANDSCAPE TURF																									
St. Augustine Sod																									
1																									
585-21 LANDSCAPE TURF																									
St. Augustine Sod																									
1																									
585-22 LANDSCAPE TURF																									
St. Augustine Sod																									
1																									
585-23 LANDSCAPE TURF																									
St. Augustine Sod																									
1																									
585-24 LANDSCAPE TURF																									
St. Augustine Sod																									
1																									
585-25 LANDSCAPE TURF																									
St. Augustine Sod																									
1																									
585-26 LANDSCAPE TURF																									
St. Augustine Sod																									
1																									
585-27 LANDSCAPE TURF																									
St. Augustine Sod																									
1																									
585-28 LANDSCAPE TURF																									
St. Augustine Sod																									
1																									
585-29 LANDSCAPE TURF																									
St. Augustine Sod																									
1																									
585-30 LANDSCAPE TURF																									
St. Augustine Sod																									
1																									

523-1-2: LIME ROCK BASE - Includes installation of base material as shown in plans and details.
 523-1-2: 6" SIDEWALK - Includes installation of concrete sidewalk as shown in plans and details.
 523-1-2: 2" PATTERN CONCRETE - Includes installation of patterned concrete as shown in plan; and details.
 570-1: PERFORMANCE TURF - Includes installation and establishment of sod within project limits as outlined within general notes, plans. Sod to be St. Augustine Sod (Stenotaphrum secundatum).
 580-1-1: LANDSCAPE SMALL - Includes all activities associated with installation and maintenance of landscape as shown in landscape plans and notes. Sod to be done twice a month or when sod is greater than 6".
 580-1-2: LANDSCAPE LARGE - Includes all activities associated with installation and maintenance of landscape as shown in landscape plans and notes. Sod to be done twice a month or when sod is greater than 6".
 590-70: IRRIGATION - Includes all activities associated with installation and maintenance of irrigation as shown in irrigation plans and notes.

Miller Legg
 547 South Andrews Way, Fort Lauderdale, Florida 33308-1144
 954-935-1900 Fax 954-934-8864 www.millerlegg.com
 Date of Issue: 12/20/07 L.L. of Merritt Island, Inc. L.L. 06/6770

CITY OF COCONUT CREEK			MILLER LEGG PROJECT ID	
ROAD NO.	COUNTY	MILLER LEGG PROJECT ID		
B14	BROWARD	10-002-49		
CITY OF COCONUT CREEK		MILLER LEGG PROJECT ID		
107-1: LITTER REMOVAL		10-002-49		

TABULATION OF QUANTITIES		SHEET NO.
/ PLANT SCHEDULE		10-2

DATE	BY	DESCRIPTION

REVISIONS	DATE	BY	DESCRIPTION

107-1: MOBILIZATION - Includes all the cost of all activities associated with preliminary work and operations in mobilizing for beginning work on the project.
 102-1: MAINTENANCE OF TRAFFIC - Includes all the cost of all activities associated with but not limited to the maintenance/replacement of existing signs during construction, work zone signs, arrow panels, off-duty officer, barricades, dust control, and operations for maintaining traffic flow.
 107-1: LITTER REMOVAL - Includes all activities associated with litter removal within proposed landscape areas as shown in landscape plans and notes.
 107-2: MOWING - Includes all activities associated with mowing in medians within project limits as shown in landscape plans and notes.
 110-1-1: CLEARING AND GRUBBING - Includes all Clearing and Grubbing activities associated with proposed project limits as shown in landscape plans and notes.

Pay Items:

577/2826

11-8-11
 J. Miller

PROJECT GENERAL NOTES:

1. The Contractor shall visit the site prior to placing the bid to assess the amount of planting required for the general conditions as they relate to traffic control, access to the site and other challenges of the Project.
2. All above survey data information shown per FDOT Project Plan AP3002-1-52 is the best available information available at the time of preparation of this plan. The Contractor shall verify the City of any discrepancies in the information provided. Base data for this project was collected and geographically located within any survey data. Features such as utility lines, manholes, and other utilities, have been compiled and incorporated from as-built data obtained from various sources. Geometric data for manholes has been conducted to add contractor in construction of landscape features. Contractor to verify that all manholes are shown as reference. Baseline shown on plans is provided for reference only and is an assumed condition of contract.
3. All public land corners and monuments within the limits of construction are to be protected by the Contractor as follows: Corners and monuments in conflict with the work and in danger of being damaged, removed or obscured shall be properly referenced by a registered-land surveyor in accordance with the rules and regulations of the Florida Board of Professional Land Surveyors prior to beginning work at the site. The Contractor shall maintain the monuments and reference, and restore upon completion of the work. All such corners and monuments shall be referenced to the Florida Department of Transportation (FDOT) as signed and sealed copy of the Land Surveyor's reference drawing.
4. The Contractor shall comply with all state codes and ordinances. Contractor shall be responsible for obtaining all applicable permits unless otherwise directed by the City.
5. The Contractor shall submit a site plan showing the location of all existing signs including photos to the City prior to installation. Any existing signs damaged by the contractor during construction, shall be replaced by the Contractor at no additional cost to the City or FDOT.
6. Contractor is to notify the City/FDOT, who shall notify the State's Farmers Office at 850-480-4961 at least 7 calendar days in advance of a DOT Set-up that will impact Overweight/Overheight Vehicles.
7. Contractor shall remove and dispose of existing sod and surplus materials off-site or as directed by the City. All existing sod within the limits of the proposed work shall be removed for landscape treatments or removed for tree installation shall be re-used in the formation of the proposed "water" landscape.
8. **CLEANING AND GRUBBING:**
 - a. SOI: includes removal of existing sod within medium and areas where proposed plant material is specified within the right-of-way unless otherwise noted.
9. **IRIGATION:** include: protection of existing irrigation systems within the right of way. Contractor shall be responsible for repair of damaged systems.
10. **SIGHT VISIBILITY CLEAR ZONES:** on the main travel/through lanes for this project are based on a design speed of 45 mph.

ENVIRONMENTAL NOTES:

1. The Contractor shall review environmental requirements of any proposed staging areas with the City and submit to the City and submit to the FDOT District Environmental Permits Coordinator at least seventy-two (72) hours prior to use.
2. Contractor shall submit to City a Stormwater Prevention Pollution Protection Plans (S.W.P.P.P.) to City for review and submit to appropriate agencies with copies to FDOT.
3. Any material to be stockpiled for periods greater than 24 hours shall be protected by appropriate erosion control devices. No material shall be stockpiled between sidewalk and water bodies.
4. All access material as designated by the City is to be deposited by the Contractor in areas provided by him within 72 hours of being deposited in the construction area and at the Contractor's expense.
5. The Contractor is responsible for keeping existing and new rights clean of planting soil, debris, etc. during the construction at no additional cost to the City. Contractor shall submit plan for protection of rights and for erosion during construction.
6. If necessary the Contractor shall use a street sweeper (with water) or other equipment capable of controlling and removing dirt or slant. Approval of the use of such equipment is contingent upon its demonstration of ability to do the work.

UTILITIES GENERAL NOTES:

1. The Contractor shall verify the utility owner and location of all utility lines. A Contractor's representative shall be present when utility companies locate their facilities.
2. All existing utilities are to remain.
3. Contractor shall explore by hand digging and expose all utilities located within 5' of all proposed trees and plants.



UTILITIES GENERAL NOTES:

1. Two full business days prior to digging, the Contractor shall call Sunshine State One Call of Florida, telephone number 811, and the utility owner and request utility locations. A Contractor's representative must be present when utility companies locate their facilities.
2. All existing utilities are to remain.
3. Contractor shall explore by hand digging and expose all utilities located within 5' of all proposed trees and plants.

GOVERNING STANDARDS:

- Florida Department of Transportation (FDOT) DESIGN STANDARDS AND SPECIFICATIONS; Contractor to refer to the following:
1. FDOT Standards Specifications for Road and Bridge Construction 2010
 2. FDOT Design Standards for Design, Construction, Maintenance and Utility Operations on the State Highway System 2010 (English Units)
 3. FDOT 2010 Interim Design Standard (01/01/11)

LANDSCAPE GENERAL NOTES:

1. **LANDSCAPE:** Installation of plant material shall be performed by a Contractor certified by the Florida Nurserymen, Growers and Landscape Association (FLNGLA) as a Certified Landscape Contractor. Any planting activities of trees and/or palms shall be supervised by a Certified Nurseryman, as certified by The International Society of Arboriculture (ISA) and licensed in Broward County.
2. **SOIL:**
 - a. For Trees and Shrubs and Groundcover beds: Provide a consultant mix consisting of 50% Sand / 40% Muck / 10% Peat for the planting soil mix.
 - b. For Palms: Provide a consultant mix consisting of 70% Sand / 30% Muck for the planting soil mix.
 - c. For Sod area: Provide a 6" to 12" wear / layer of soil consisting of 70% Sand / 30% Peat mix.

LANDSCAPE GENERAL NOTES Cont'd:

3. **SOI:**
 - a. Provide specified species of sod as shown on plans. All existing turf areas within the medium shall be removed. Replace sod within the medium, outside of planting beds, as indicated on plans. Contractor shall include a 6" to 12" layer or more of existing sod in the area within the median that are to be sodded. The sod material and placement of the sod shall be as specified on the plan. No sod shall be removed during the course of construction, the Contractor shall be responsible to take to the damaged areas and restore the proposed grade. Cost of replacement material shall be included within Mobilization and at the Contractor's expense.
 - b. All existing areas within areas shall remain unless otherwise specified. The Contractor shall be responsible to re-sod any areas damaged by construction activities. Restoration sod (re-sodding damaged areas) shall match the species of the existing surrounding sod.
 - c. MULKCH: A consistent 3" layer of overhead Grade A mulch or better shall be spread over all planting beds. All mulch shall extend to include shown on plans. Contractor to submit sample of mulch to City for acceptance.
5. **FERTILIZATION:** Contractor shall provide at a minimum, one (1) application at time of planting. A schedule of fertilization based upon the Manufacturer's recommended rates shall be submitted by the Contractor at the pre-construction meeting.

AT TIME OF PLANTING: Fertilizer with planting tablets 20-10-5 plus urea. Do not place tablets in bottom of holes; tablets shall be 1/8" from the bottom of the rootball.

ESTABLISHMENT PERIOD OF PLANT MATERIAL: Fertilizer for direct trees, shrubs and ground covers shall be 20-10-5 plus urea, 6% phosphorus and 6% potassium with minor elements composition analysis. Fertilizer for plants in planters shall be 15% nitrogen, 3% phosphorus, and 15% of potassium composition analysis with minor elements. Contractor shall apply granular fertilizer at the manufacturer's recommended rates. Contractor reserves the right to modify N-P-K ratio and soil nutrient product data sheets. For review and acceptance prior to any installation of plant material consistent with the above criteria.

5. WATERING: At a minimum, the Contractor shall provide the following recommended watering schedule beginning immediately after installation of plant material. At the pre-construction meeting, the Contractor shall submit a watering schedule based upon the following recommended rates:

All watering applications required during Plant Establishment Period and Warranty Period and its source shall be included as part of the unit price for each plant material. Contractor shall adjust watering schedule during heavy rain season upon approval by Project Engineer.

7. WARRANTY: Install, establish and maintain landscape as indicated in the contract documents. Take responsibility for the proper maintenance, survival and condition of all plants for a period of one year after final acceptance in accordance with FDOT Standard Specifications for Road and Bridge Construction Section 550.

6. REFACEMENT MATERIAL: shall be subject to all the requirements of the FDOT Standard Specifications for Road and Bridge Construction Section 560.

9. MAINTENANCE: Begin maintenance of all plants immediately after each planting as indicated in the contract documents and in accordance with Standard Specifications Section 560.

A. Keep all plants watered, fertilized, mulched, pruned and staked and staked as necessary to assure established minimum grade of Florida No. 1 through the duration of the project construction period and establishment period.

B. During the establishment period, keep the individual planting locations and planting beds free of litter and undesirable vegetation.

C. Ensure that the plants are maintained so that they are healthy, vigorous, and undamaged throughout the duration of the project construction period and establishment period.

D. For the duration of the establishment period, operate and maintain in good operating condition, all components of any irrigation system installed in compliance with the Contract Documents.

E. During the establishment period, replace any plants that fall below specified minimum grade. Use replacement plants of the same species, size and planting medium as the plant being replaced and as specified in the Contract Documents.

10. The Contractor shall furnish to the City a unit price breakdown for all material. The City may, at its discretion, add or delete items from the material taking the unit price breakdown submitted. This unit price breakdown shall be provided by the Contractor at the Pre-Construction meeting.

11. No plant material will be accepted showing evidence of cable, chain marks, equipment scars, or when the ball of earth surrounding its roots has been crushed, broken or otherwise damaged.

DATE	BY	DESCRIPTION	REVISIONS
DATE	BY	DESCRIPTION	REVISIONS

MILLER LEGG 3100 W. Broward Blvd., Ft. Lauderdale, Florida 33309-5204 P: 954.343.1000 F: 954.343.1000 City of Broward County, Florida		CITY OF COCONUT CREEK MILLER LEGG PROJECT ID: 10-00249	
ROAD NO. 814	COUNTY BROWARD	SHEET NO. LD-3	

LANDSCAPE GENERAL NOTES

3/7/2010 8:20:28 AM W:\Projects\2009-2010\814\814.dwg

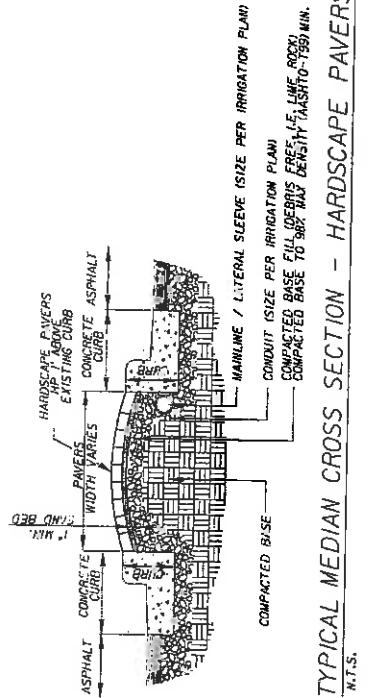
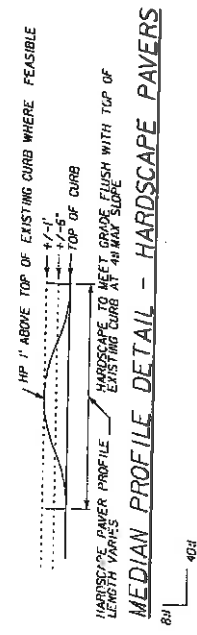
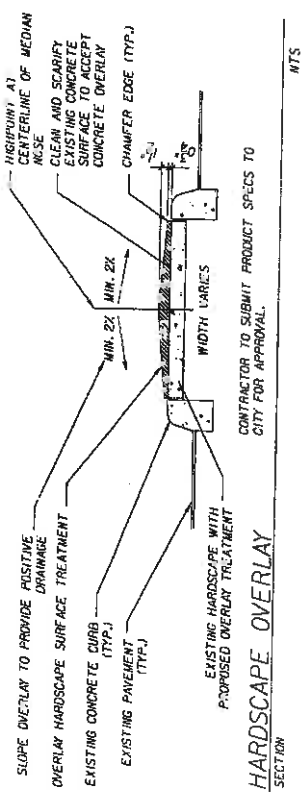

Handwritten notes:
 11/25/20
 [Signature]

DATE	BY	DESCRIPTION

MILLER LEGG 5741 North Ardmore Way, Fort Lauderdale, Florida 33309-2964 954-558-7000 Fax: 954-558-9664 www.millerlegg.com Div. Of: 661-1200007, L.A. of Howard Breen & Co., Inc. LA-666770		CITY OF COCONUT CREEK ROAD NO. 814 COUNTY BROWARD MILLER LEGG PROJECT ID 10-00249
SHEET NO. LD-4		HARDSCAPE DETAILS

HARDSCAPE PAVER TREATMENT

NOTE: CONTRACTOR TO SUBMIT SAMPLES OF ALL HARDSCAPE MATERIALS FOR REVIEW AND APPROVAL.
 CONTRACTOR TO PROVIDE MOCK-UPS OF EACH HARDSCAPE TREATMENT FOR REVIEW AND APPROVAL.
 SET PAVEMENT MORTAR BED WITH A COMPACTED SAND BED.
 SAND-SWEEP JOINT.
 PAVER FIELD: 12"x12" SET AT 45-DEG ANGLE TO BACK OF CURB, CUT TO FIT.
 1/2" EXPANSION JOINT BETWEEN BACK OF CURB AND PAVER.

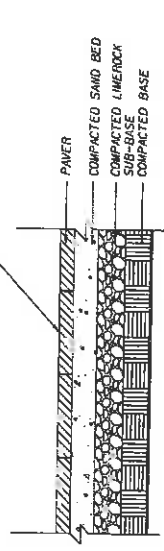

PAVER DETAIL SECTION NTS

OVERLAY TREATMENT: COLOR SURFACE TREATMENT

NOTE: CONTRACTOR TO SUBMIT SAMPLES OF ALL HARDSCAPE MATERIALS FOR REVIEW AND APPROVAL.
 CONTRACTOR TO PROVIDE MOCK-UPS OF EACH HARDSCAPE TREATMENT FOR REVIEW AND APPROVAL.
 SET PAVEMENT MORTAR BED WITH A COMPACTED SAND BED.
 SAND-SWEEP JOINT.
 PAVER FIELD: 12"x12" SET AT 45-DEG ANGLE TO BACK OF CURB, CUT TO FIT.
 1/2" EXPANSION JOINT BETWEEN BACK OF CURB AND PAVER.

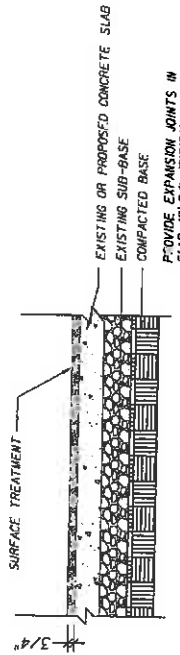

HARDSCAPE DETAIL SECTION NTS

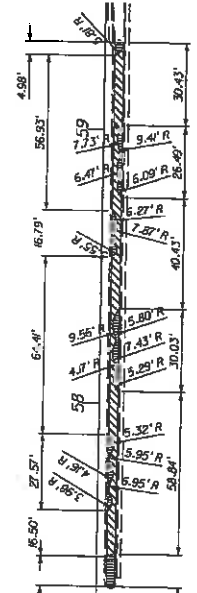

HARDSCAPE DETAIL - STA. 57+00 - 60+00

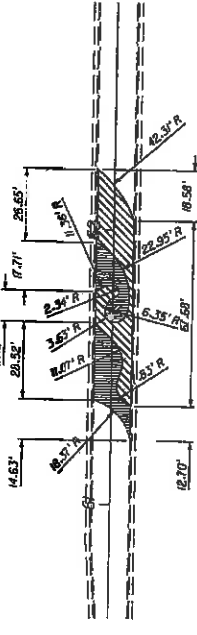

HARDSCAPE DETAIL - STA. 61+00 - 62+00

HARDSCAPE LEGEND
 BLUE HARDSCAPE COLOR
 SAND HARDSCAPE COLOR

DATE	BY	DESCRIPTION	REVISIONS	DATE	BY	DESCRIPTION

MILLER LEGG
 3714 S. 10th St., Fort Lauderdale, Florida 33304-2504
 Phone: 954-344-1111
 Fax: 954-344-1112
 Website: www.millerlegg.com
 City of Fort Lauderdale, FL
 Project No. 10-00249

CITY OF COCONUT CREEK
 ROAD NO. 814
 CITY OF COCONUT CREEK
 MILLER LEGG PROJECT ID 10-00249

SHEET NO. LD-5

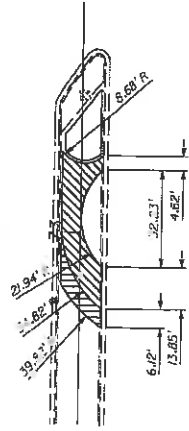

HARDSCAPE DETAIL - STA. 61+00 - 62+00

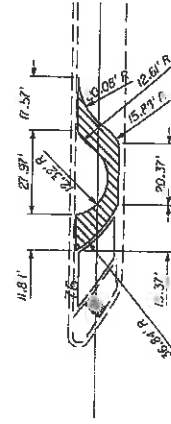

HARDSCAPE DETAIL - STA. 76+00

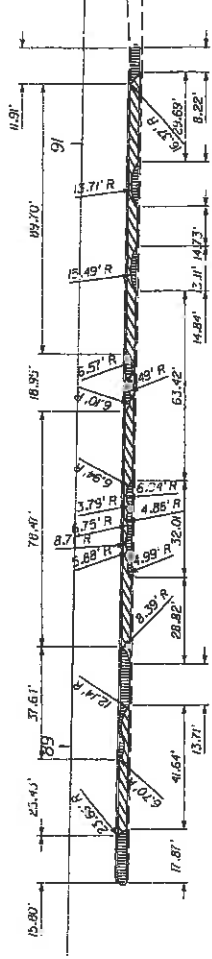

HARDSCAPE DETAIL - STA. 89+00 - 91+00

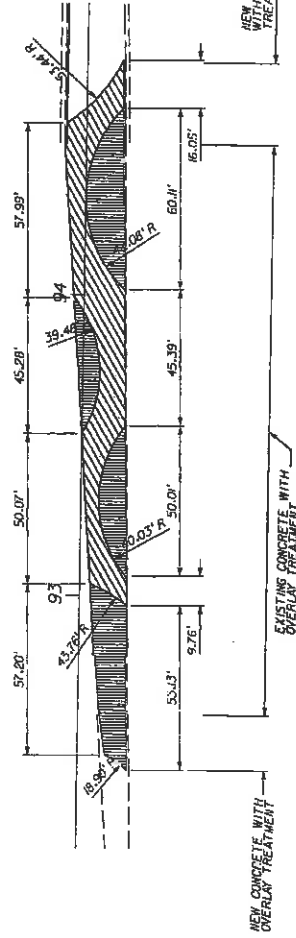

HARDSCAPE DETAIL - STA. 93+000 - 94+00

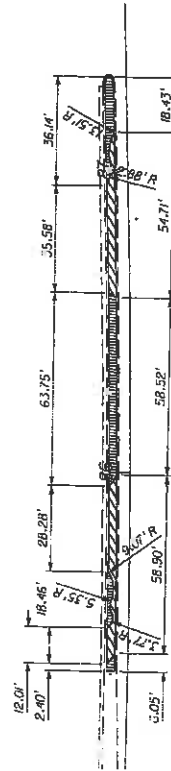

HARDSCAPE DETAIL - STA. 86+00 - 87+00

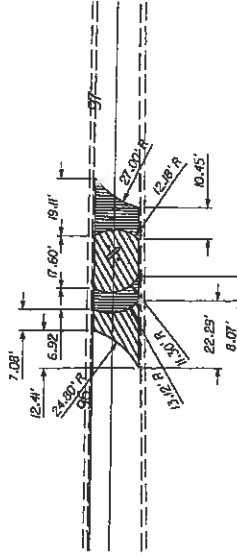

HARDSCAPE DETAIL - STA. 96+000 - 97+00

11-8-5-5
MWB

HARDSCAPE LEGEND
 [Hatched] BLUE HARDSCAPE COLOR
 [Stippled] SAND HARDSCAPE COLOR

DATE	BY	DESCRIPTION

MILLER LEGG
 5700 Highway 17, Fort Worth, Texas 76104
 817-342-1111
 City of Aledo, Texas, 75009-2020
 City of Aledo, Texas, 75009-2020

CITY OF COCONUT CREEK
 ROAD NO. 814
 COUNTY BROWARD
 MILLER LEGG PROJECT ID 10-00249

HARDSCAPE DETAILS

SHEET NO.	LD-6
-----------	------

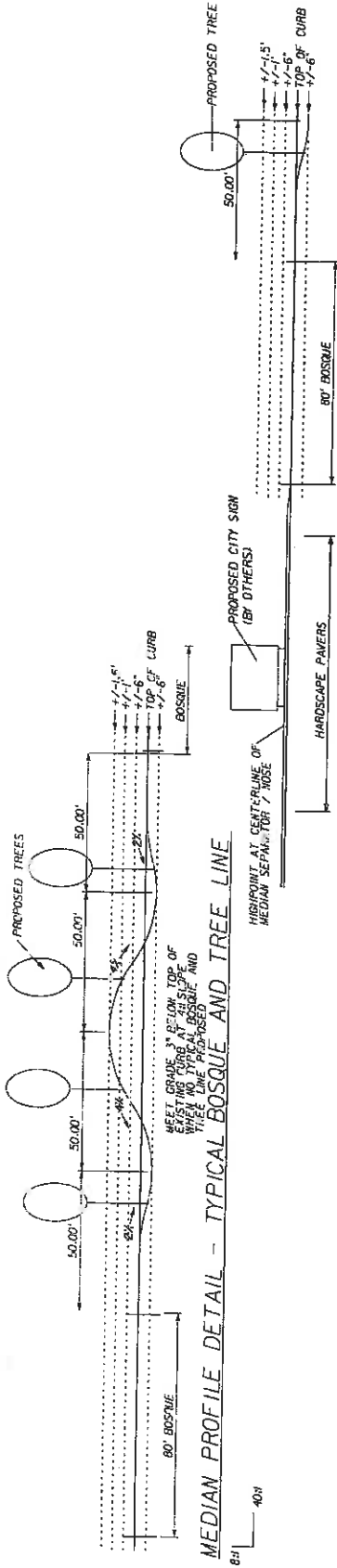

MEDIAN PROFILE DETAIL - TYPICAL BOSQUE AND TREE LINE
N.T.S.

MEDIAN PROFILE DETAIL - BOSQUE AND CITY SIGN
N.T.S.

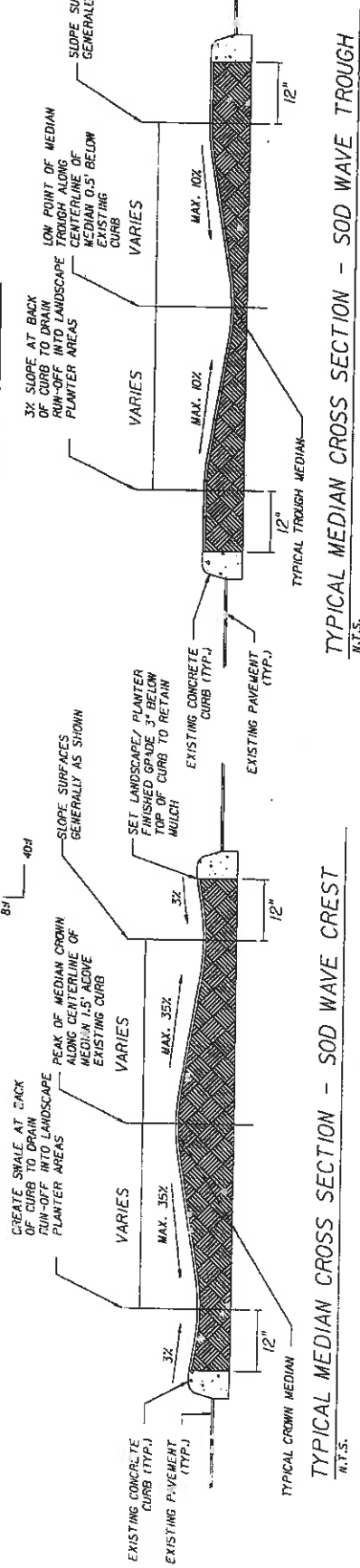

TYPICAL MEDIAN CROSS SECTION - SOD WAVE CREST
N.T.S.

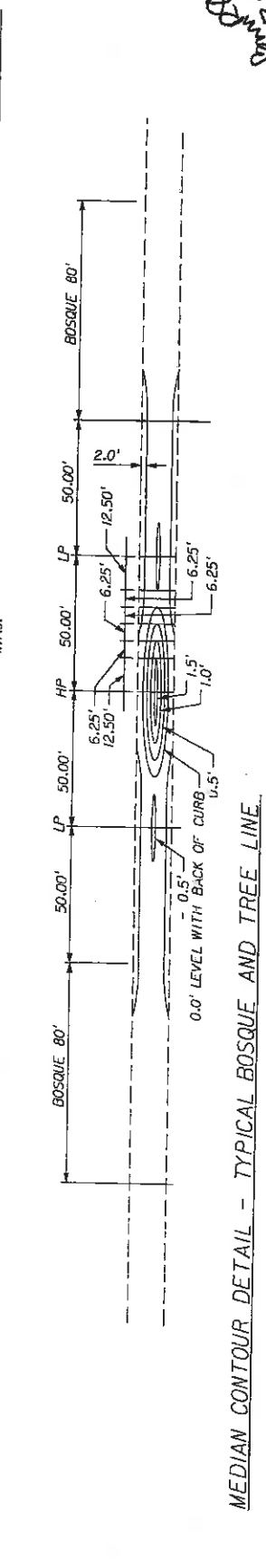

TYPICAL MEDIAN CROSS SECTION - SOD WAVE TROUGH
N.T.S.



MEDIAN CONTOUR DETAIL - TYPICAL BOSQUE AND TREE LINE
N.T.S.

NO.	DESCRIPTION	DATE	BY

MILLER LEGG
 5705 Main Street
 Metairie, LA 70001
 (504) 833-1000
 FAX (504) 833-1000
 E-MAIL: MILLER@MLL.CM.LA.GOV

CITY OF COCONUT CREEK
 ROAD NO. B14
 COUNTY BROWARD
 MILLER LEGG PROJECT ID 10-00249

SHEET NO. LD-7

J. Miller
 11-8-2009

11-8-11
 Amy Brown

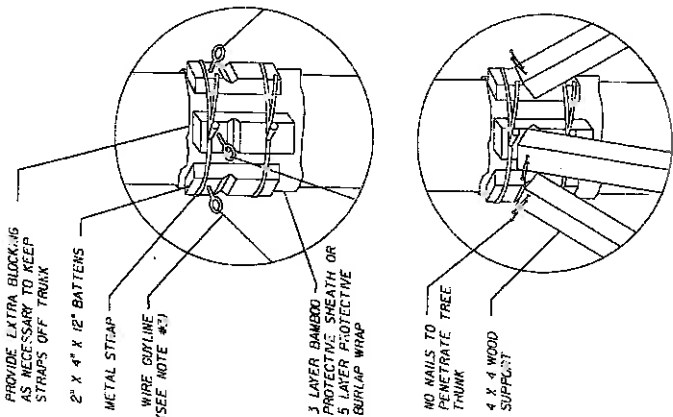

WOOD BATTEN DETAIL

M.T.S.

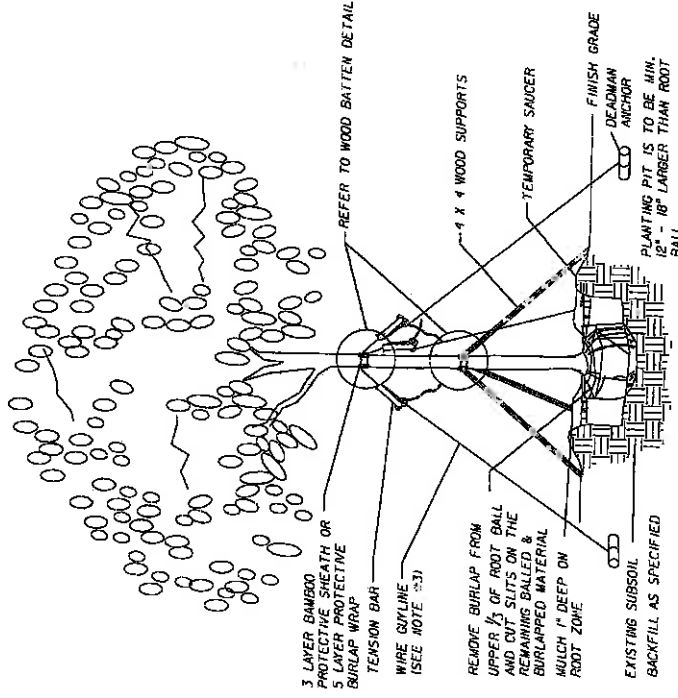

LARGE CALIPER TREE PLANTING DETAIL

M.T.S.

- NOTES:
1. Submit shop drawing of staking/support detail.
 2. Provide narrative of installation and care of trees during establishment period.
 3. Optional tree rootball capping system can be specified to supplement bracing of trees. Provide shop drawing as necessary.

REVISIONS	
NO.	DESCRIPTION

MILLER LEGG
 501 West Main Street, Suite 200
 Phoenix, Arizona 85001
 Phone: (602) 441-1111
 Fax: (602) 441-1112
 E-mail: sales@mllegg.com
 Web: www.mllegg.com

CITY OF COCONUT CREEK
 ROAD NO. B14 COUNTY BROWARD PROJECT NO. 10-00249

SHEET NO. LD-8

LANDSCAPE DETAILS

11-8-2014
MB

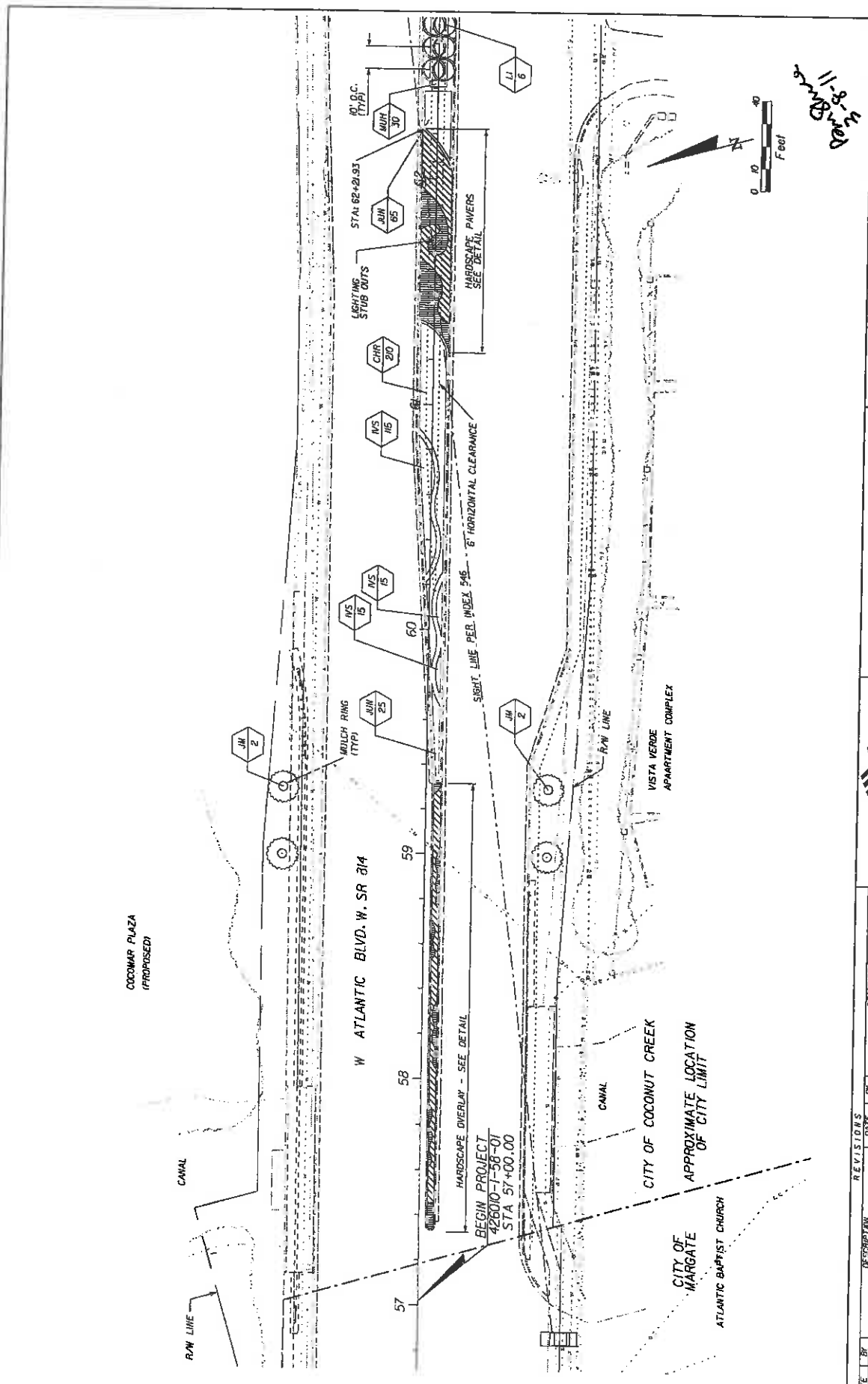

COCOONAR PLAZA
(PROPOSED)

R/W LINE

W ATLANTIC BLVD. W. SR 814

HARDSCAPE OVERLAY - SEE DETAIL
 BEGIN PROJECT
 42610-1-58-01
 STA 57+00.00

CITY OF MARGATE

ATLANTIC BAPTIST CHURCH

CANAL

CITY OF COCONUT CREEK

APPROXIMATE LOCATION
OF CITY LIMIT

VISTA VERDE
APARTMENT COMPLEX

R/W LINE

SIGHT LINE PER INDEX 546 - 6' HORIZONTAL CLEARANCE

60

59

58

57

STATION 62+20.93

JUN 85

CHR 20

JMS 10

JMS 15

JUS 15

JUN 25

JIN 2

MULCH RING
(TYP)

JMS 15

JUN 30

MUH 30

LI 6

DATE	BY	DESCRIPTION	REVISIONS DATE	BY	DESCRIPTION
<p>MILLER LEGG 8741 Main St., Fort Lauderdale, FL 33308 Phone: 954-445-8800 Fax: 954-445-8801 Co. # 1101010000033 - I.A. of Home & Garden Supply</p>					
<p>CITY OF COCONUT CREEK</p>			<p>MILLER LEGG PROJECT ID:</p>		
<p>ROAD NO. B14</p>		<p>COUNTY BROWARD</p>		<p>PROJECT NO. 10-00249</p>	
<p>DATE: 11/8/2014</p>					
<p>SCALE: 1/8" = 1'-0"</p>					
<p>PROJECT NO. 10-00249</p>					
<p>SHEET NO. LD-9</p>					

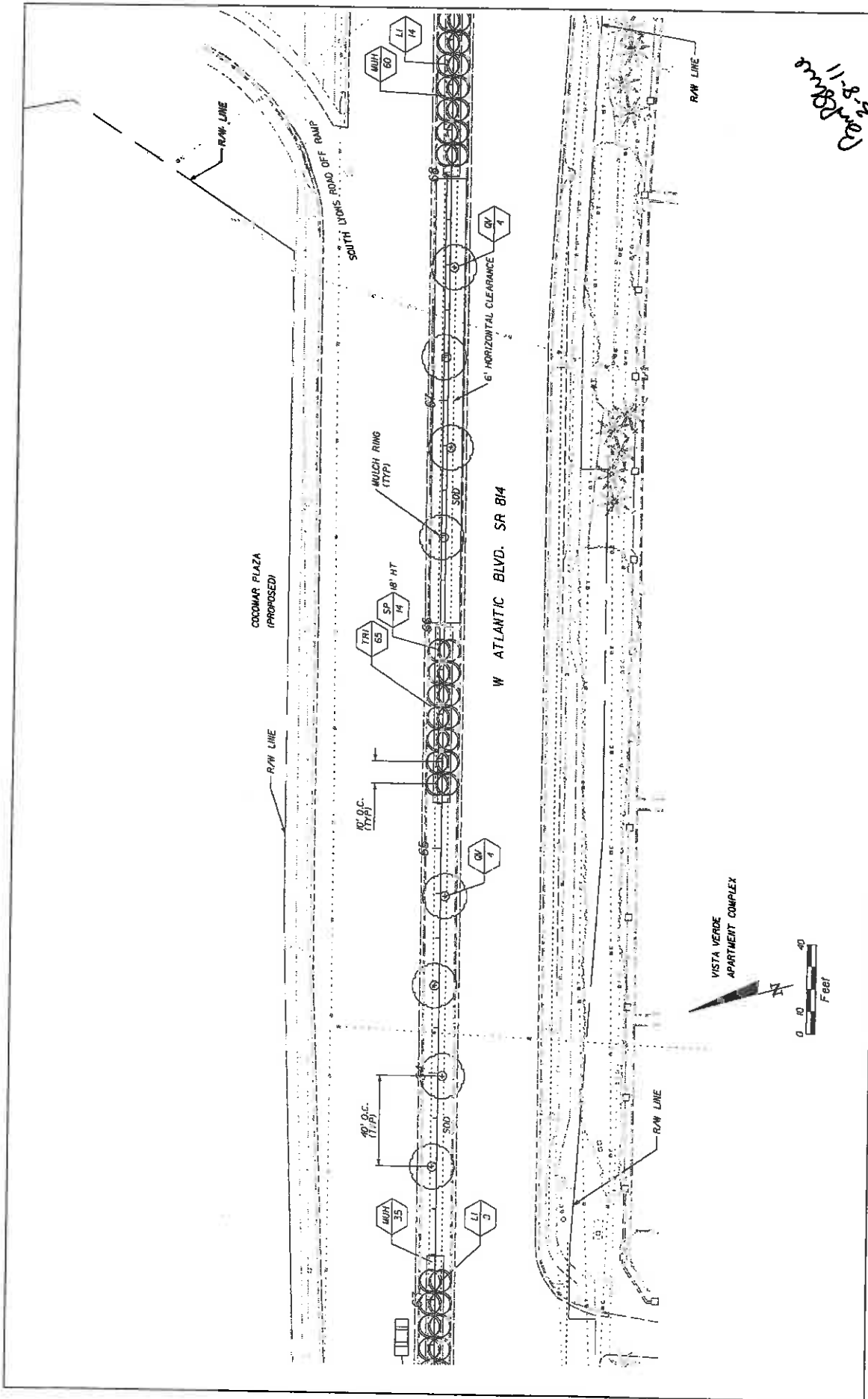

DATE	BY	DESCRIPTION	DATE	BY	DESCRIPTION

MILLER LEGG 577 Peach Avenue West, Fort Lauderdale, Florida 33309-3344 352-443-9100 Fax: 352-406-5044 www.mlegg.com One of the LEED ACCREDITED L.A. of Record Firms in State LA 0889770		CITY OF COCONUT CREEK ROAD NO. B14 COUNTY BROWARD MILLER LEGG PROJECT ID 10-00249	SHEET NO. LD-10
---	--	--	-----------------

Handwritten: 11-8-11
 [Signature]

DATE PLOTTED: 11/08/11 11:08 AM
 PLOTTER: HP DesignJet 2450

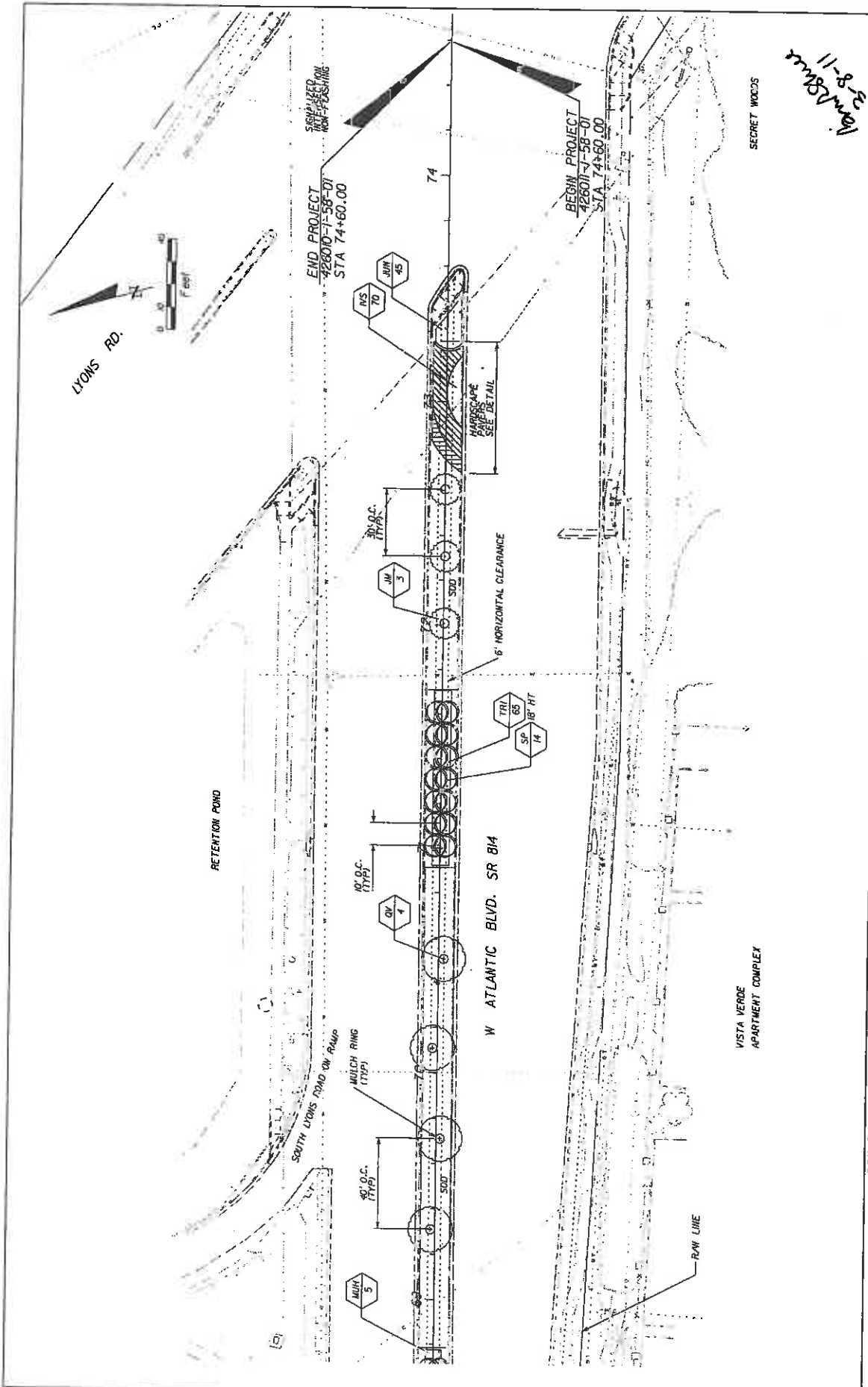

SECRET WOODS

11-8-20
 10/11/20
 10/11/20

REVISIONS		DESCRIPTION	
DATE	BY	DATE	DESCRIPTION

MILLER LEGG 314 N. University Blvd., Tallahassee, Florida 32304 P.O. Box 100000, Tallahassee, Florida 32304 Tel: 904.438.1000, Fax: 904.438.1001, Email: info@mllegg.com		CITY OF COCONUT CREEK ROAD NO. B14 COUNTY BROWARD PROJECT ID 10-00249	
SHEET NO. LD-11		DATE: 11-8-20	

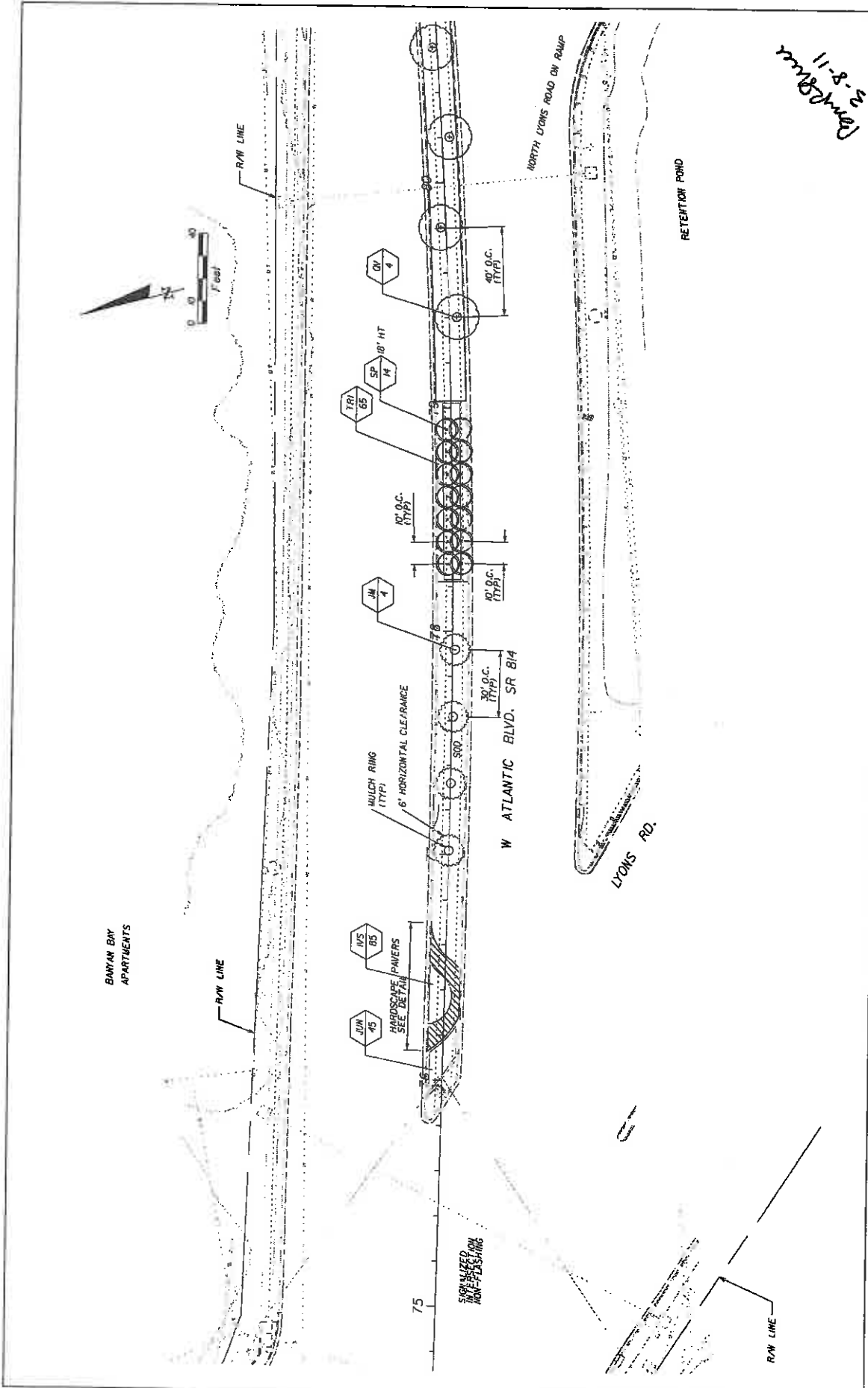

11-8-20
mmBchmed

REVISIONS		DESCRIPTION	
DATE	BY	DATE	BY

MILLER LEGG 3101 W. Atlantic Blvd., Fort Lauderdale, Florida 33309-2004 Phone: (954) 344-4444 Fax: (954) 344-4444 Website: www.millerlegg.com Date of this plan: 10/02/19		CITY OF COCONUT CREEK ROAD NO. 814 COUNTY BROWARD	MILLER LEGG PROJECT ID 10-00249
LANDSCAPE PLAN		SHEET NO. LD-12	DATE: 3/7/20



BANYAN GAY
APARTMENTS

R/W LINE

EXISTING SIGN

11
14

HIGH
65

10' O.C.
(TYP)

10' O.C.
(TYP)

MULCH RING
(TYP)

6' HORIZONTAL CLEARANCE

W ATLANTIC BLVD. SR 814

HARDSCAPE OVERLAY
SEE DETAIL

NORTH LOUIS ROAD OFF RAMP
NORTH DOWS ROAD ON RAMP

R/W LINE

STATE OWNED LANDS

VACANT

FLORIDA TURNPIKE LIMITED
ACCESS R/W LINE

FLORIDA TURNPIKE LIMITED
ACCESS R/W LINE

*11-28-12
amb*

DATE	BY	DESCRIPTION	DATE	BY	DESCRIPTION

MILLER LEGG
5975 South Lakeside Way, Fort Lauderdale, Florida 33309-3164
954-482-0080 Fax: 954-482-0664 www.mlegg.com
Civil & Mechanical Engineering, L.L.C. (a Florida Limited Liability Company)

ROAD NO. 814
COUNTY BROWARD
PROJECT ID MILLER LEGG PROJECT ID 10-00249

SHEET NO. LD-13



BANYAN BAY APARTMENTS

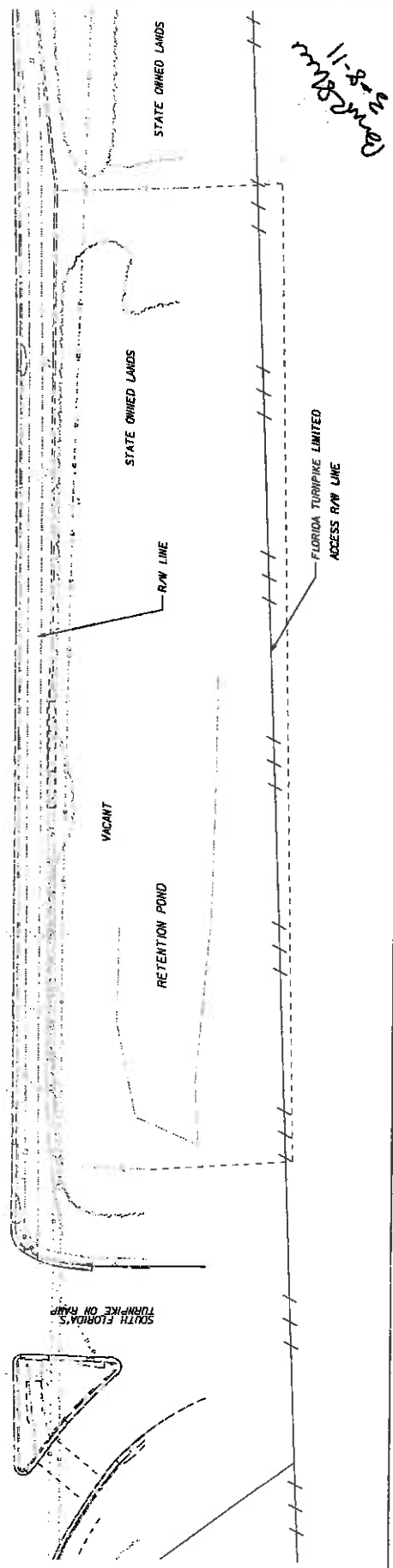
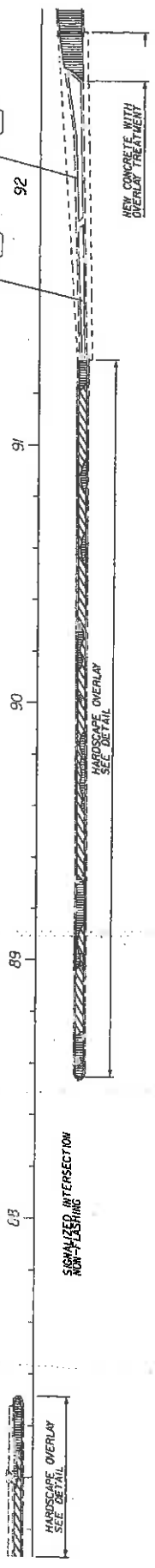
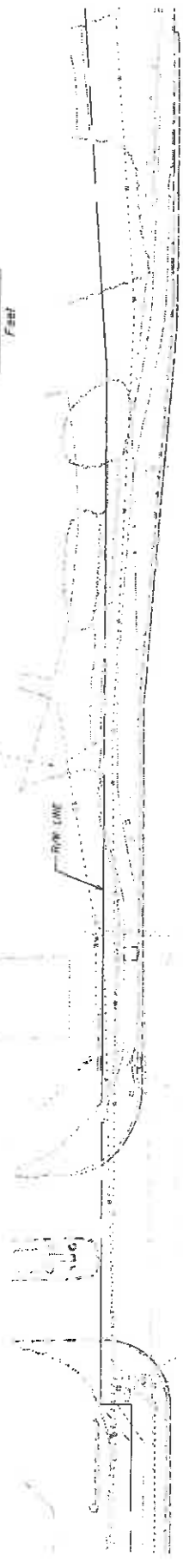

REVISIONS		CITY OF COCONUT CREEK		SHEET NO. LD-14
DATE	BY	DESCRIPTION	DATE	

ROAD NO.	814	PROJECT ID	10-00249
COUNTY	BROWARD	MILLER LEGG PROJECT ID	

MILLER LEGG
 5870 N.W. 11th Street, Ft. Lauderdale, Florida 33309-3008
 954-527-9800 Fax 954-583-6666
 City of Jacksonville, Florida, L.A. # 00000001 (L.A. # 00000001)

6/6/04
 JPL/LSM
 6/28/07 PJ
 1/10/07 JLS/LSM/07-00000001-00000001
 5/17/08 JLS/LSM/08-00000001-00000001
 8/28/08 JLS/LSM/08-00000001-00000001

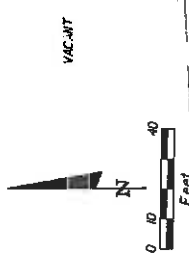
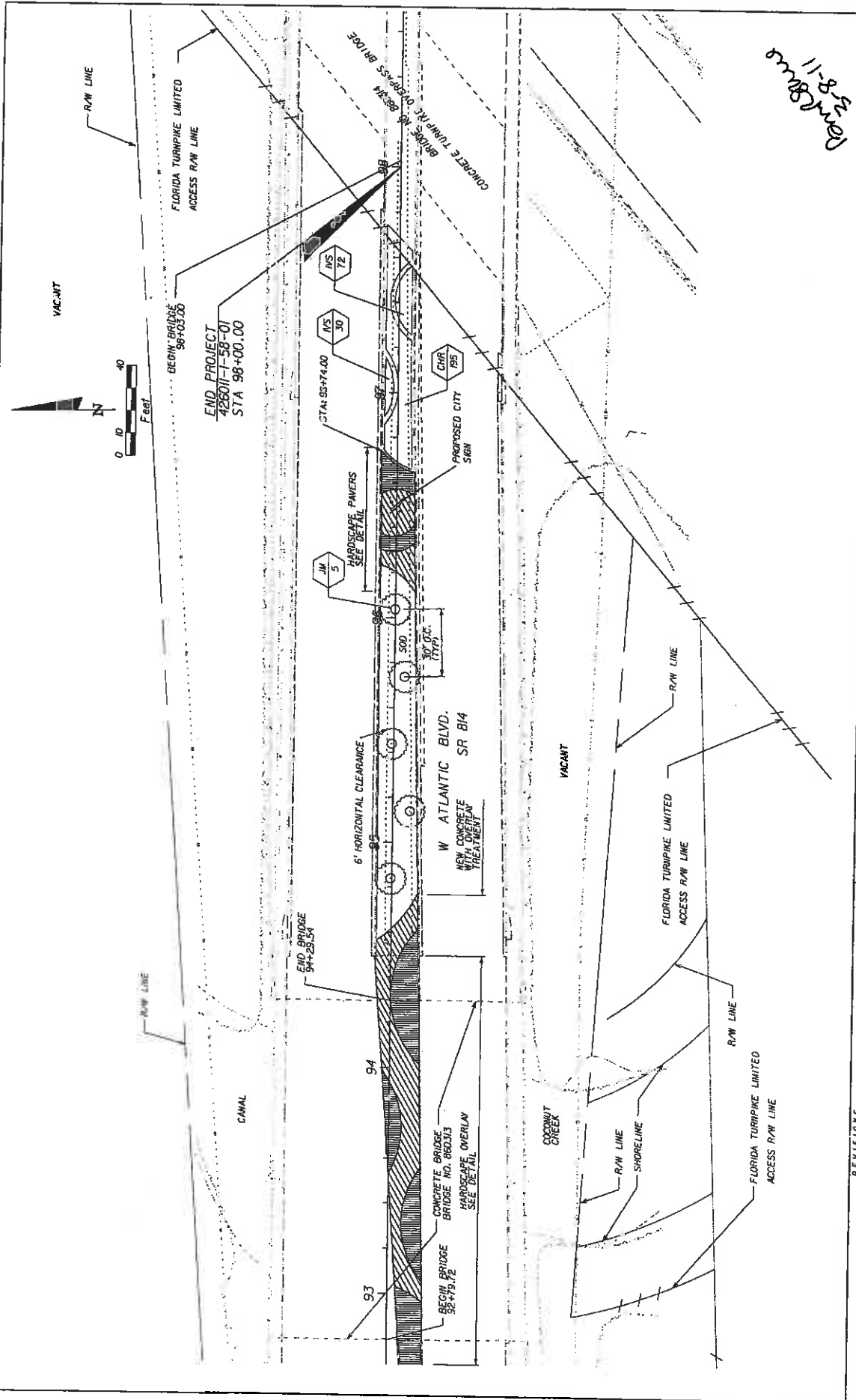

11-8-23
 rmb
 DWG

REVISIONS		DESCRIPTION	
DATE	BY	DATE	DESCRIPTION

MILLER LEGG <small>500 North Address Way, Suite 100, Metairie, LA 70002 504-885-2000 Fax: 504-885-9561 www.millerlegg.com One of North Louisiana's L.A. of Plaquemine, Iron T. Smith, L.A. 66078</small>		CITY OF COCONUT CREEK <small>ROAD NO. B14 COUNTY BROWARD PROJECT ID 10-00249</small>	SHEET NO. LD-15
ADDRESS: PM 31728E		PROJECT: W/PLANS 10/07/03-10249 - SR-B14 Atlantic Blvd. 3/24/2003-7/25/2003 - W/ADDN-04	

LANDSCAPE PLAN

IRRIGATION GENERAL NOTES AND SPECIFICATIONS

The system has been designed to conform with the requirements of all applicable codes. Should any conflict exist, the requirements of the codes shall prevail. It is the responsibility of the owner/installation contractor to insure the entire system is installed according to all applicable laws, rules, regulations and conventions. Irrigation contractor responsible for obtaining all required permits according to federal, state and local laws.

The scope of work is shown on the plans, notes and details. The Irrigation Contractor shall be certified as a CERTIFIED IRRIGATION CONTRACTOR by the Irrigation Association. The certification shall be current and in good standing.

THE WORK

The work specified in this section consists of furnishing all components necessary for the installation, testing, and delivery of a complete, fully functional automatic landscape irrigation system that completely complies with the irrigation plans, specifications, notes, details and all applicable laws, regulations, codes and ordinances. This work shall include, but not be limited to, the providing of all required material (pipe, valves, fittings, controllers, wire, primer, glue, etc.), layout, protection to the public, excavation, assembly, installation, back filling, compacting, repair of road surfaces, controller and low voltage leads to valves, clean-up, maintenance, guarantee and as-built plans.

All irrigated areas shall provide 100% head-to-head coverage from a fully automatic irrigation system with a rain sensor. The rain sensor shall be installed to prevent activation of rain sensor by adjacent heads. All watering procedures shall conform to local codes, as well as this project's regional Water Management District restrictions and regulations. Zones are prioritized first by public safety and then by hydraulic concerns. This sequencing will be a mandatory punch list item. These plans have been designed to satisfy/exceed the Florida Building Code (FBC) Appendix F and the Florida Irrigation Society Standards and Specifications for Turf and Landscape Irrigation Systems, fourth edition.

Contractor shall verify all underground utilities 72 hours prior to commencement of work.

It is the responsibility of the Irrigation contractor to familiarize themselves with all grade differences, location of walls, retaining walls, structures and utilities. Do not willfully install the sprinkler system as shown on the drawings when it is obvious in the field that unknown obstruction, grade differences or differences in the area dimensions exist that might not have been considered in the engineering. Such obstructions, or differences, should be brought to the attention of the owner's authorized representative. In the event this notification is not performed, the Irrigation contractor shall assume full responsibility for any revisions necessary.

Irrigation Contractor shall repair or replace all items damaged by their work. Irrigation Contractor shall coordinate their work with other Contractors for the location and installation of pipe sleeves and laterals under roadways and paving, etc.

The contractor shall take immediate steps to repair, replace, or restore all services to any utilities which are disrupted due to their operations. All costs involved in disruption of service and repairs due to negligence on the part of the contractor shall be their responsibility.

POINT OF CONNECTION (P.O.C.)

The P.O.C. is a proposed 51/2" centrifugal pump station, Hoover Pumping model HCF-5CS-2303-D-E-24-W-Z or equal, utilizing an well source as specified on plan details. The P.O.C. must be capable of delivering a minimum of 55 GPM at 50 PSI. Contractor shall verify these minimum conditions can be met prior to the begin irrigation system installation.

If the conditions can not be met, the contractor must notify the designer prior to proceeding with the work. If the Contractor does not do so, the contractor proceeds at their own risk and becomes responsible for any future work required to make the system perform as required.

THE PIPE

Pipe locations shown on the plan are schematic and shall be adjusted in the field. When laying out mainlines place a 18"-24" away from either the back of curb, front of walk, back of walk, or other hardscape to allow for ease in locating and protection from physical damage. Install all lateral pipe near edges of pavement or against buildings whenever possible to allow space for plant root balls. Always install piping inside project properties boundary.

Pipe sizes shall conform to those shown on the plans. No substitutions of smaller pipe sizes shall be permitted, but substitutions of larger sizes may be approved. All damaged / rejected pipe shall be removed from the site at the time of said rejection.

All pipes are to always be placed in planting beds. If it is necessary to have piping under hardscapes, such as roads, pavers, and walks, the pipes must be sleeved using High Density Polyethylene (HDPE) under existing roadways and sidewalks where directional bore is utilized and Sch 40 PVC elsewhere with the sleeve diameter being twice the size of the pipe it is carrying with a minimum sleeve size of 2".

Mainline shall be Class 200 gassteels O' ring PVC with ductile iron fittings (sized per plans).

Contractor to ensure all machine piping is properly restrained using mechanical joint fittings, restraining collars, etc., as and where required. Contractor shall refer to pipe manufacturers recommended installation practices for further direction.

PVC pipe joint compound and primer, slow-drying, heavy duty cement and lined (purple) primer that is compatible with the cement. The PVC cement shall be Weld-On 2711 grey and the primer shall be Weld-On P70 purple primer, or approved equals.

ELECTRICAL POWER SUPPLY

Electrical supply and phone line for pumps and controllers to be provided by irrigation contractor. Contractor to coordinate with local utilities for the installation of, and connection to, site available power supply's for required electrical components as set forth in the irrigation plans. Provide electrical shop drawings signed and sealed by Electrical Engineer.

All electrical to comply with the National Electrical Code and any, and all, other applicable electrical codes, laws and regulations. A licensed electrician shall perform all electrical hook-ups. Power for the controller shall be 120 volts. Power for pump station shall be 208 volts Phase 3.

WRING

Irrigation control wire shall be thermoplastic solid copper, single conductor, low voltage irrigation controller wire; suitable for direct burial and continuous operation at rated voltages.

Tape and bundle control wires every 10' and run alongside the mainlines. At all turns in direction make a 2' coil of wire. At all valve boxes coil wire around a 3/4" piece of PVC pipe to make a coil using 30 linear inches of wire. Make electrical connections with 3M-DBY,DBR connectors.

Number all wires, using an electrical book of numbers, according to the plans. Number wires in all valve boxes, junction boxes and at the controller.

Wire sized, numbered and colored as follows:

- #14 white for common
- #14 spare black common
- #14 red for hot wires
- #14 spare yellow hot wire

SPARE WIRES

Run spare wires into every RCV valve box. Install a minimum of 2 common and 4 hot wires, in all directions, to every RCV connected to its respective controller.

CONTROLLER GROUNDING

Contractor to utilize 4"x8"x5/8" copper grounding plates, 5/8"x10" copper clad grounding rods, One Strike CAD wells at all connection points, #8 bare copper wire, and earth contact material. Install these and other required components as outlined in the detail. Contractor to verify that the earth to ground resistance does not exceed 10 ohms. Contractor shall provide a written certification on a licensed electrical contractor's letter head, showing the date of the test, controller location, and test results. Each controller shall be so grounded and tested.

LAYOUT

Lay out irrigation system mainlines and lateral lines. Make the necessary adjustments as required to take into account all site obstructions and limitations prior to excavating trenches.

Stake all sprinkler head locations. Adjust location and make the necessary modifications to nozzle types, etc. required to insure 100 % head to head coverage. Refer to the Edge of Pavement Detail on the Irrigation Detail Sheet.

Spray heads shall be installed 4" from sidewalks or curbed roadways and 12" from uncurbed roadways and building foundations. Rotors shall be installed 4" from sidewalks or curbed roadways, 12" from building foundations, and 36" from uncurbed roadways.

Shrub heads shall be installed on 3/4" Sch 40 PVC risers. The risers shall be set at a minimum of 18" off sidewalks, roadway curbing, building foundations, and/or any other landscaped areas. Shrub heads shall be installed to a standard height of 4" below maintained height of plants and shall be installed within planter masses to be less visible and offer protection. Paint all shrub risers with flat black or forest green paint, unless irrigation system will be installed from a reuse water system with purple PVC risers.

Port Done 2-8-11

DATE	BY	DESCRIPTION

MILLER LEGG
 5747 Field Avenue West, The Woodlands, Texas 77382-2566
 936-257-0000 • Fax: 936-257-4524 • www.millerlegg.com
 One of Miller Legg Companies, L.L.C. • Houston, Texas 77061-4607

CITY OF COCONUT CREEK	
ROAD NO. B14	MILLER LEGG PROJECT ID 10-00247
COUNTY BROWARD	

IRRIGATION NOTES

SHEET NO. LD-16

IRRIGATION GENERAL NOTES AND SPECIFICATIONS (CONTINUED)

Locate valves prior to excavation. Insure that their location provides for easy access and that there is no interference with physical structures, plants, trees, poles, etc. Valve boxes must be placed a minimum of 12" and a maximum of 15" from the edge of pavement, curbs, etc. and the top of the box must be 2" above finish grade. No valve boxes shall be installed in turf areas without approval by the irrigation designer - only in shrub beds. Never install in sport field areas.

VALVES

Sequence all valves so that the farthest valve from the P.O.C. operates first and the closest to the P.O.C. operates last. The closest valve to the P.O.C. should be the last valve in the programmed sequence.

Adjust the flow control on each RCV to ensure shut off in 10 seconds after deactivation by the irrigation controller.

VALVE BOXES

Valve boxes shall be standard unless otherwise noted to be traffic rated boxes.

Using 3" high number stencils paint the valve number in white on the lid of each valve box.

EQUIPMENT

Bubbles shall be installed using Sch 80 nipples and shall be placed at the base of trees for low level watering.

All pop-up heads and shrub risers shall be pressure compensating. All pop-up heads shall be mounted on flex-type swing joints.

All sprinkler equipment not otherwise detailed or specified shall be installed as per manufacturer's recommendations and specifications, and according to local and state laws.

TRENCHING

Excavate straight and vertical trenches with smooth, flat or sloping bottoms. Trench width and depth should be sufficient to allow for the proper vertical and horizontal separation between piping as shown in the pipe installation detail on the detail sheet.

Protect existing landscaped areas. Remove and replant any damaged plant material upon job completion. The replacement material shall be of the same genus and species, and of the size of the material it is replacing. The final determination as to what needs to be replaced and the acceptability of the replacement material shall be solely up to the owner or owner's representative.

INSTALLATION

Cut all pipe square and deburr. Clean pipe end fittings of foreign material; then apply a small amount of primer while ensuring that any excess is wiped off immediately. Primer should not puddle or drip from pipe or fittings. Next apply a thin coat of PVC cement; first apply a thin layer to the pipe, next a thin layer inside the fitting, and finally another very thin layer on the pipe. Insert the pipe into the fitting. Insure that the pipe is inserted to the bottom of the fitting, then turn the pipe a 1/4 turn and hold for 10 seconds. Make sure that the pipe doesn't recede from the fitting. If the pipe isn't at the bottom of the fitting upon completion, the glue joint is unacceptable and must be discarded.

Pipes must cure a minimum of 30 minutes prior to handling and placing into trenches. A longer curing time may be required; refer to the manufacturer's specifications. The pipe must cure a minimum of 24 hours prior to filling with water.

BACK FILL

The Backfill 6" below and 6" above all piping shall be of clean sand and anything beyond that in the trench can be of native material but nothing larger than 2" in diameter.

Main line pipe depth measured to the top of pipe shall be 18" minimum, 36" minimum at vehicular crossings.

Lateral line depths measured to top of pipe shall be 12" minimum, 36" minimum at vehicular crossings.

Contractor shall backfill all piping, both mainline and laterals, prior to performing any pressure tests. The pipe shall be backfilled with the exception of 2 on each side of every joint (bell fittings, 90's, tees, 45's, etc.). These joints shall not be backfilled until all piping has satisfactorily passed the appropriate pressure test as outlined below.

FLUSHING

Prior to the placement of heads, flush all lines for a minimum of 10 minutes or until lines are completely clean of debris, whichever is longer.

Use screens in heads and adjust heads for proper coverage avoiding excess water on walls, walks and parking. TESTING

Remove all remote control valves and cap using a threaded cap. Fill mainline with water and pressurize the system to 125 PSI. Monitor the system pressure at two gauge locations; the gauge locations must be at opposite ends of the mainline. With the same respective pressure, monitor the gauges for two hours. There can be no loss in pressure at either gauge for solvent-welded pipe. Gasketed piping shall lose no more water than allowed per the Florida State Building Code, Volume II Plumbing, Part VI, Appendix F. Refer to this section for the formula to be used to calculate the maximum allowable water loss during the testing time. If these parameters are exceeded, locate the problem; repair it; wait 24 hours and retest. This procedure must be followed until the mainline passes the test.

The lateral lines must be filled and visually checked for leaks. Any leaks detected must be repaired. No pressure test of the lateral lines is required.

Once the mainline and lateral lines have passed their respective tests, and the system is completely operational, a coverage test and demonstration of the system is required. The irrigation contractor must demonstrate to the owner, or his/her representative that proper coverage is obtained and that the system works automatically from the controller. This demonstration requires that each zone is turned on, in the proper sequence as shown on the plans, from the controller. Each zone will be inspected for proper coverage and function. The determination of proper coverage and function is at the sole discretion of the owner or owner's representative.

Operational Testing - Upon completion of back filling, finish grading and contouring, test the entire system for proper operation; including electrically actuating the remote control valves. Run each zone until water begins to puddle or run off. This will allow you to determine the number of irrigation start times necessary to meet the weekly evapotranspiration requirements of the planting material in each zone. In sandy soils no puddling will occur. Instead, calculate the required run times.

SUBMITTALS

The contractor must submit for approval, prior to installation, copies of the manufacturer's cut sheets/specifications for all components to be used in the irrigation system. Minimum submittal items are: Irrigation Heads, Valves, Controller, Pump (Pump, Flow Sensor, Valves, Pipes, Fiberglass Enclosure), Lateral / Main line, Sleeves, Swing Joint assembly, Fittings, Wires, Waterproof Connection, Valve Boxes, Rain Sensor and Grounding Kit.

Record Drawings - After project completion, and as a condition of final acceptance, the irrigation contractor shall provide the owner with a high quality, accurate, and legible set of as-built drawings. The as-builts must identify all remote control valves, gate valves, ball valves, splice boxes, controllers, mainline, sleeving, and low voltage wiring. Each of these items is to be located using a submeter GPS system. The irrigation contractor must also provide accurate, informative, and easy to follow and understand operation and maintenance manuals for all components of the irrigation system.

Controller charts - Upon completion of "as-built" prepare controller charts; one per controller. Indicate on each chart the area controlled by a remote control valve (using a different color for each zone). This chart shall be reduced to a size that will fit inside of the controller door. The reduction shall be hermetically sealed inside two 2ml pieces of clear plastic.

Furnish extra materials described below that match products installed and that are packaged with protective covering for storage and identified with labels describing contents. Include tools to service these products.

- 1. Sprinkler Units: Five of each unit for each type and size installed, but no fewer than two units.
- 2. Emitter Units: Five of each unit for each type and size installed, but no fewer than two units.
- 3. Drip Tube Units: Five of each unit for each type and size installed, but no fewer than two units.

FINAL ACCEPTANCE

Final acceptance of the irrigation system will be given after the following documents and conditions have been completed and approved. Final payment will not be released until these conditions are satisfied.

- 1. Final walk-thru and correction of all punch list items.
- 2. Completion and acceptance of "as-built" drawings.
- 3. Acceptance of required controller charts and placement inside of controllers.
- 4. Turn over of all required parts and tools as outlined in the project specifications.

GUARANTEE AND MAINTENANCE

The irrigation systems shall be guaranteed and maintained for a minimum of one calendar year from the time of final acceptance.

Per Approved 9-8-11

DATE	BY	DESCRIPTION	REVISIONS	DATE	BY	DESCRIPTION

MILLER LEGG
 501 Park Avenue, Suite 1200, Jacksonville, Florida 32202-2584
 Phone: 904.251.3434 Fax: 904.251.3434
 Doc. # 1400000077 - 14-01 (REVISED) DATE: 06/06/07

CITY OF COCONUT CREEK
 MILLER LEGG PROJECT ID
 ROAD NO. B14 QUANTITY BROWARD 10 - 00247

IRRIGATION NOTES

SHEET NO. LD-17

IRRIGATION SCHEDULE

VALVE SCHEDULE

SYMBOL	MANUFACTURER/MODEL/DESCRIPTION	QTY	ARC	PSI	OPN	RADIUS	NUMBER	MODEL	SIZE	TYPE	PSI	POC	OPN	PRECIP
1	Rain Bird 1800-SAM-PRS-NP 15 Slip Series 6" pop-up with check valve, pressure regulator, purple cap.	3	E5T	30	0.61	4'x15'	1	Rain Bird PESSB	1-1/2"	Turf Spray	37.04	39.00	51.08	1.35 in/h
2	Rain Bird 1800-SAM-PRS-NP 15 Slip Series 6" pop-up with check valve, pressure regulator, purple cap.	11	B5T	30	1.21	4'x30'	2	Rain Bird PESSB	1-1/2"	Bubbler	38.88	38.88	48.00	30.04 in/h
3	Rain Bird 1800-SAM-PRS-NP 15 Slip Series 6" pop-up with check valve, pressure regulator, purple cap.	42	B5T	30	0.78	10'	3	Rain Bird PESSB	1-1/2"	Turf Spray	37.06	39.76	51.80	1.46 in/h
4	Rain Bird 1800-SAM-PRS-NP 10 Series MPR 6" pop-up with check valve, pressure regulator, purple cap.	5	80	30	0.38	10'	4	Rain Bird PESSB	1-1/2"	Bubbler	40.01	43.69	51.00	1.47 in/h
5	Rain Bird 1800-SAM-PRS-NP 10 Series MPR 6" pop-up with check valve, pressure regulator, purple cap.	7	120	30	0.53	10'	5	Rain Bird PESSB	1-1/2"	Bubbler	39.04	42.68	42.00	30.64 in/h
6	Rain Bird 1800-SAM-PRS-NP 10 Series MPR 6" pop-up with check valve, pressure regulator, purple cap.	1	180	30	1.85	15'	6	Rain Bird PESSB	1-1/2"	Turf Spray	36.91	42.79	50.30	1.37 in/h
7	Rain Bird 1800-SAM-PRS-NP 15 Series MPR 6" pop-up with check valve, pressure regulator, purple cap.	278	80	30	0.92	15'	7	Rain Bird PESSB	1-1/2"	Bubbler	40.09	47.53	51.00	1.44 in/h
8	Rain Bird 1800-SAM-PRS-NP 15 Series MPR 6" pop-up with check valve, pressure regulator, purple cap.	12	120	30	1.23	15'	8	Rain Bird PESSB	1-1/2"	Turf Spray	36.91	44.41	51.00	1.44 in/h
9	Rain Bird 1800-SAM-PRS-NP 15 Series MPR 6" pop-up with check valve, pressure regulator, purple cap.	11	15-A	30	1.00	1'	9	Rain Bird PESSB	1"	Turf Spray	34.82	35.54	50.33	1.42 in/h
10	Rain Bird 1800-SAM-PRS-NP 15 Series MPR 6" pop-up with check valve, pressure regulator, purple cap.	207	15-B	30	1.00	1'	10	Rain Bird PESSB	1-1/2"	Turf Spray	36.17	41.37	52.35	1.70 in/h
11	Rain Bird 1800-SAM-PRS-NP 15 Series MPR 6" pop-up with check valve, pressure regulator, purple cap.	1	18	30	1.00	1'	11	Rain Bird PESSB	1-1/2"	Turf Spray	36.02	46.52	45.75	1.55 in/h

MANUFACTURER/MODEL/DESCRIPTION

- Rain Bird PESSB
Electric Remote Control Scrubber Valve
- Nibco T-113
Class 125 bronze gate shut off valve with wheel handle, same size as pipe diameter, Size Range - 1/4" - 3"
- Rain Bird ESP-24/SITE-W
Rain Bird ESP-SITE-SAT satellite controller with 24 stations, wall mount.
- SHF Centrifugal Pump Station
- Ingration Lateral Line: PVC Schedule 40
- Ingration Mainline: PVC Schedule 40
- Pipe Sleeves: PVC Schedule 40
Typical pipe sleeve for irrigation pipe. Pipe sleeve size shall allow for irrigation piping and their related couplings to easily slide through sleeve material. Extend sleeves 18 inches beyond edges of paving or construction.
- Valve Callout
--- Valve Number
--- Valve Flow
--- Valve Size

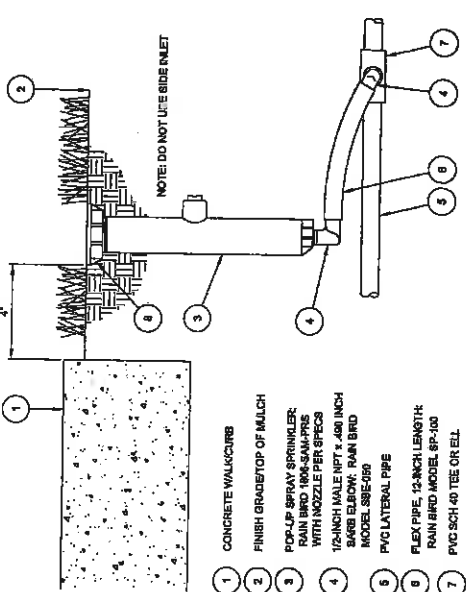

1 6" POP-UP SPRAY

2 TREE BUBBLER

Amal Shah 7-8-11

<p>MILLER LEGG 5750 University Blvd., Jacksonville, Florida 32217-3364 Tel: 904-744-1488 • Fax: 904-744-1489 • www.millerlegg.com City of Jacksonville, Florida, USA • Project No. 10-00247</p>		<p>CITY OF COCONUT CREEK MILLER LEGG PROJECT ID ROAD NO. COUNTY PROJECT ID B14 BROWARD 10-00247</p>		<p>SHEET NO. LD-18</p>						
<p>REVISIONS</p> <table border="1"> <thead> <tr> <th>DATE</th> <th>BY</th> <th>DESCRIPTION</th> </tr> </thead> <tbody> <tr> <td> </td> <td> </td> <td> </td> </tr> </tbody> </table>		DATE	BY	DESCRIPTION				<p>IRRIGATION NOTES</p>		
DATE	BY	DESCRIPTION								

- 1 30-INCH LINEAR LENGTH OF WIRE, COILED
- 2 WATERPROOF CONNECTION (1 OF 2)
- 3 10 TAGS
- 4 REMOTE CONTROL VALVE MAIN BRASS NIPPLE
- 5 STANDARD VALVE BOX PURPLE
- 6 FINISH GRADE
- 7 PVC SCH 80 NIPPLE (CLOSE)
- 8 PVC SCH 40 ELL
- 9 PVC SCH 80 NIPPLE (LENGTH AS REQUIRED)
- 10 BRICK (1 OF 4)
- 11 DUCTILE IRON TEE
- 12 PVC MAINLINE PIPE
- 13 PVC SCH 40 MALE ADAPTER
- 14 PVC LATERAL PIPE
- 15 6.0-INCH MINIMUM DEPTH OF 3/4-INCH WASHED GRAVEL
- 16 1/2" WIRE CLOTH GOPHER SCREEN, WRAP UP ALL SIDES

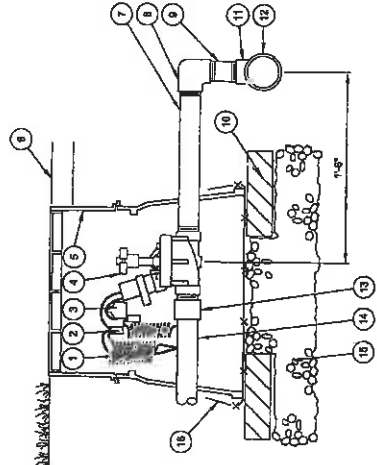

3 REMOTE CONTROL VALVE

- NOTES:
1. BACKFILL MINIMUM DEPTHS:
 - 1. MAIN LINE - 18"
 - 2. LATERAL PIPE - 12"

- ELECTRICAL SPECIFICATIONS
- 24 VAC 3000 Hz (CYCLOPSICAL SOLAR) INRUSH CURRENT: 0.41 A (0.34 VA) AT 80 1/2° C
 - HOLDING CURRENT: 0.29 A (0.22 VA) AT 80 Hz
 - COIL RESISTANCE: 0.39 OHMS

FLOW (GPM)	100-PESS PSI LOSS	150-PESS PSI LOSS	200-PESS PSI LOSS
5	1.7		
10	1.9		
20	2.9		
30	5.6		
40		3.0	
50		3.5	
75		5.4	4.5
100			5.2
125			6.2

PESS SERIES VALVE PRESSURE LOSS

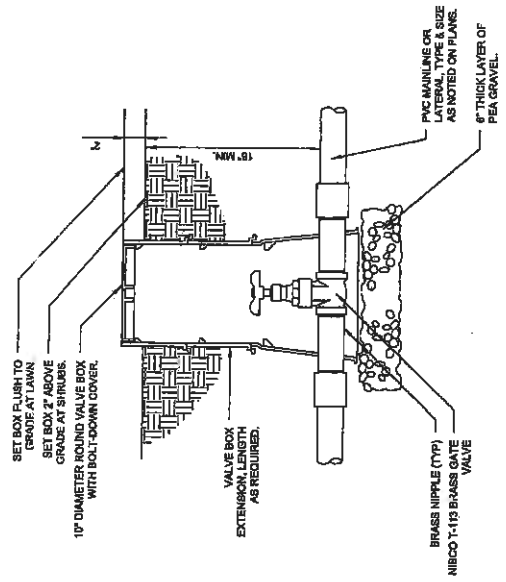

4 BRASS ISOLATION VALVE

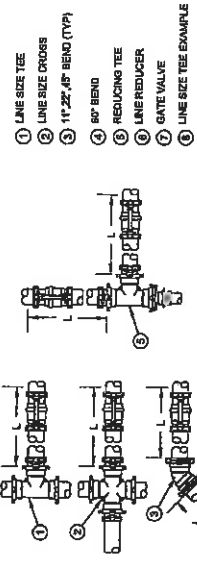

- NOTES:
1. ALL PVC MAINLINE PIPING SHALL RECEIVE LEAKMO JOINT RESTRAINTS OR EQUAL.
 2. REFERENCE ONLY REFER TO JOINT MANUFACTURERS SPECIFICATIONS FOR INSTALLATION INSTRUCTIONS.

7 JOINT RESTRAINTS

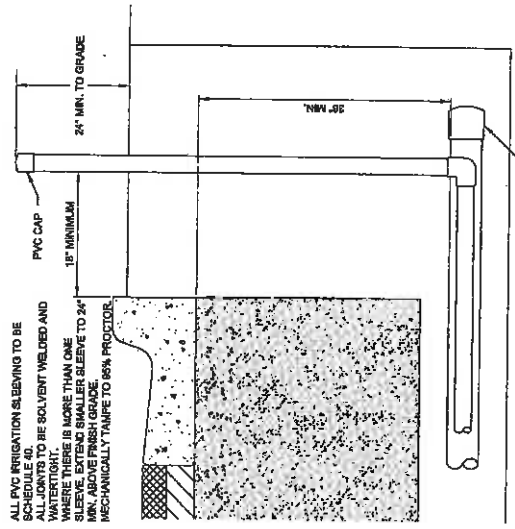

6 PIPE SLEEVE DETAIL

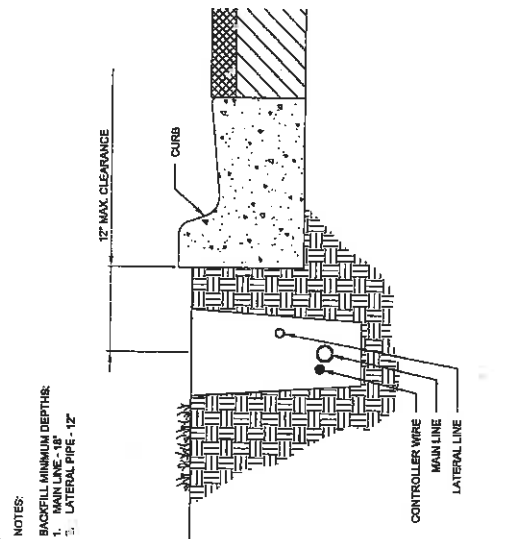

5 MAINLINE AND LATERAL PIPING DETAIL

DATE	BY	DESCRIPTION	REVISIONS

MILLER LEGG
 5741 North Andrews Way - Fort Lauderdale, Florida - 33309-3564
 954-475-1000 Fax: 954-475-5564 www.millerlegg.com
 One of ANIR 10000077, Ltd. of Harlow, Essex, U.K. Reg. No. 14 66878

CITY OF COCONUT CREEK
 ROAD NO. COUNTY PROJECT ID
 B14 BROWARD ID-00247

SHEET NO.
 LD-19

IRRIGATION NOTES

Handwritten note: 2/21/11

IRRIGATION SCHEDULE

SYMBOL	MANUFACTURER/MODEL	QTY	APC	ESJ	GPM	RADIUS	SYMBOL	MANUFACTURER/MODEL	QTY
1	Rain Bird 1806-SAM-PRS-NP 15 Series	1	EST	30	0.61	4'x15'	1	Rain Bird PIESB	1
2	Rain Bird 1806-SAM-PRS-NP 15 Series	3	SST	30	1.21	4'x30'	2	Nibco T-113	2
3	Rain Bird 1806-SAM-PRS-NP 10 Series	8	MFR	160	30	0.79	10'	6" SCH. 40 SLEEVE	1811 L.F.
4	Rain Bird 1806-SAM-PRS-NP 15 Series	19	MFR	160	30	1.05	15'	2" SCH. 40 CONDUIT	1811 L.F.
5	Rain Bird 1806-SAM-PRS-NP 15 Series	2	MFR	90	30	0.92	15'	3" SCH. 40 SLEEVE	390 L.F.
6	Rain Bird 1806-SAM-PRS-NP 15 Series	2	MFR	120	30	1.23	15'	Valve Callout	
7	Rain Bird 1806-SAM-PRS-NP 15 Series	14	MFR	360	30	1.00	1'	Valve Number	
8	Rain Bird 1800-1400 Flood							Valve Flow	
9								Valve Size	

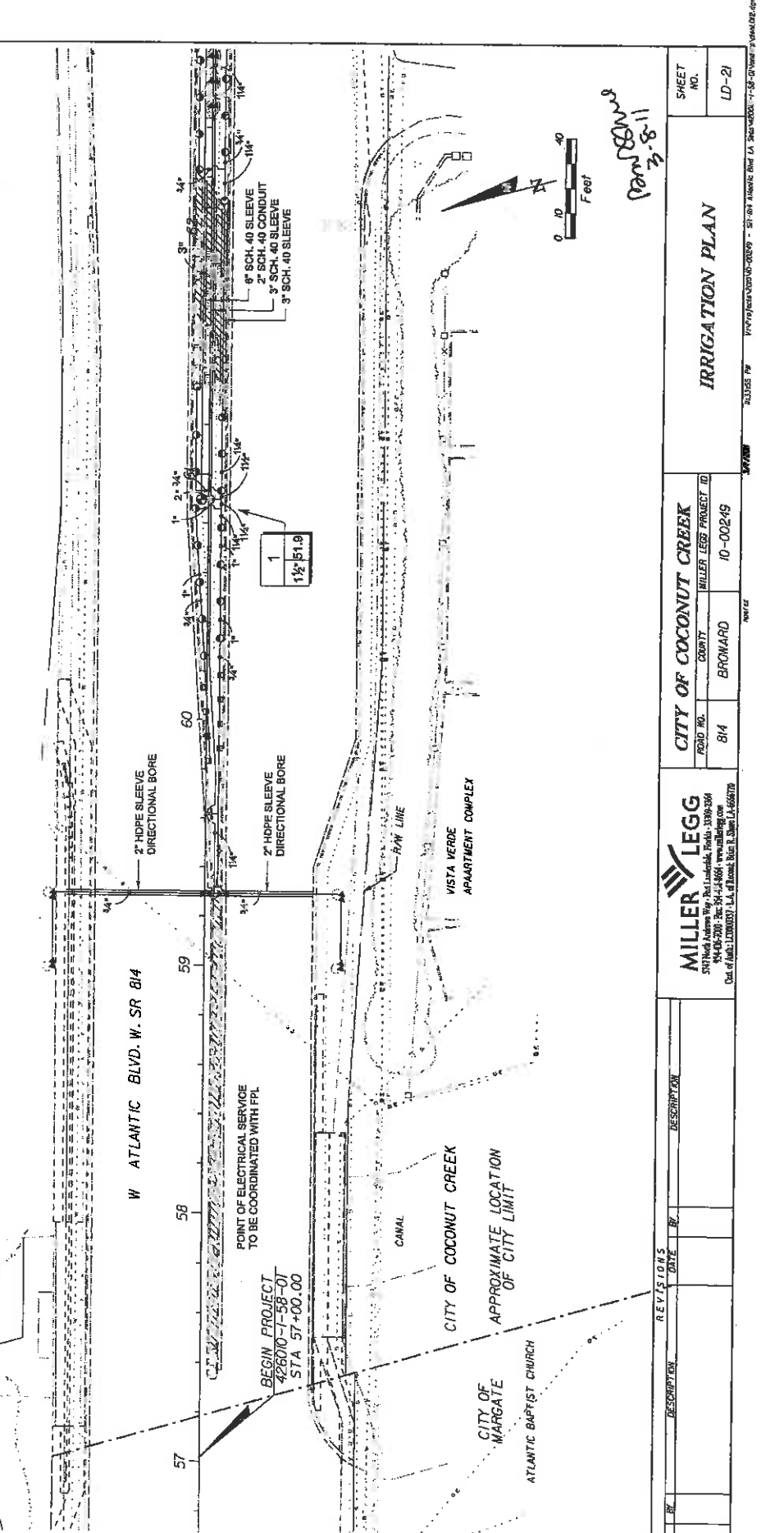

DATE	BY	DESCRIPTION	REVISIONS	DATE	BY	DESCRIPTION

MILLER LEGG		CITY OF COCONUT CREEK	
507 West Andrews Way, Ft. Lauderdale, Florida 33309-2364		MILLER LEGG PROJECT ID	
954-457-5000 Fax: 954-457-5866 www.millerlegg.com		10-00249	
City of Miami 12000037 L.A. of Broward, Brev. P. Stone 14, 466770		COUNTY	
		BROWARD	
		ROAD NO.	
		814	

SHEET NO.		LD-21	
-----------	--	-------	--

IRRIGATION SCHEDULE

SYMBOL	MANUFACTURER/MODEL	CITY	ARC PSI	GPM	RADIUS
●	Rain Bird 190S-SAM-PRS-NP 1S Series MPR 81	81	180	30	1.85' 16"
▲	Rain Bird 190S-1400 Flood	80	360	30	1.00' 1"

SYMBOL	MANUFACTURER/MODEL	CITY
○	Rain Bird PRESS	
—	Irrigation Lateral Line: PVC Schedule 40	1,892 LL
—	Irrigation Mainline: PVC Schedule 40	601 LL

#	Valve Number
#	Valve Flow
#	Valve Size

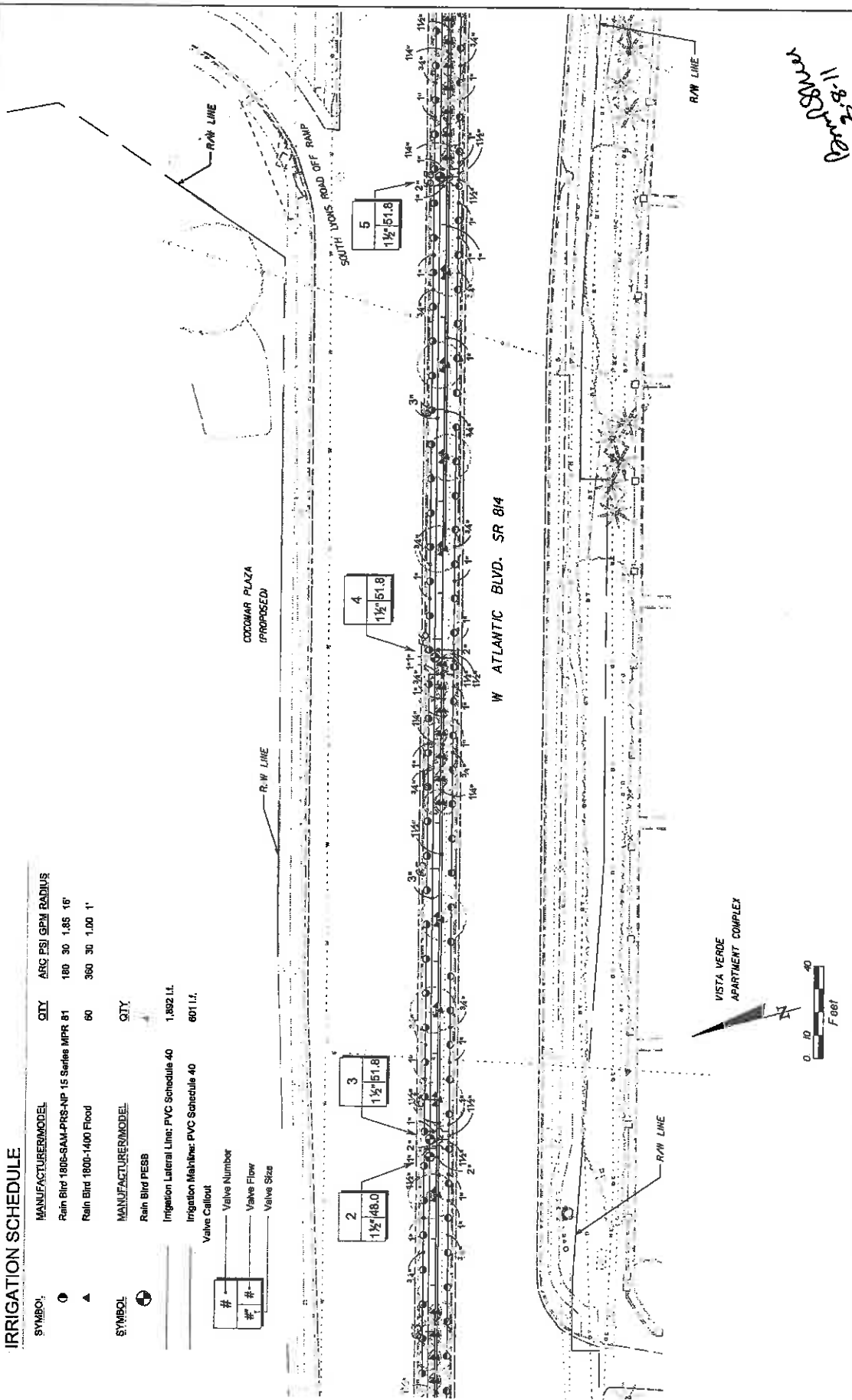

11-8-2022
[Handwritten signature]

DATE	BY	DESCRIPTION	REVISIONS	DATE	BY	DESCRIPTION

MILLER LEGG 570 North Andrews Way, Fort Lauderdale, Florida 33309-2514 954-435-1000 Fax: 954-435-8844 mlegg@mllegg.com Div. of Public Utilities, LLC of Broward County, Inc.		CITY OF COCONUT CREEK ROAD NO. 814 COUNTY: BROWARD MILLER LEGG PROJECT ID: 10-00249	SHEET NO. LD-22
--	--	--	-----------------

IRRIGATION SCHEDULE

SYMBOL	MANUFACTURER/MODEL	QTY	ARC	PSI	GPM	RADIUS	SYMBOL	CITY
□	Rain Bird 180B-SAM-FRS-NP 10 Series MPR 6	180	30	0.78	10'	⊕	3	
□	Rain Bird 180B-SAM-FRS-NP 10 Series MPR 2	90	30	0.39	10'	⊗	1	
○	Rain Bird 180B-SAM-FRS-NP 15 Series MPR 49	180	30	1.85	15'			
○	Rain Bird 180B-SAM-FRS-NP 15 Series MPR 3	90	30	0.92	15'			
●	Rain Bird 180B-SAM-FRS-NP 15 Series MPR 2	120	30	1.23	15'			
▲	Rain Bird 1800-1400 Flood	32	360	30	1.00	1'		

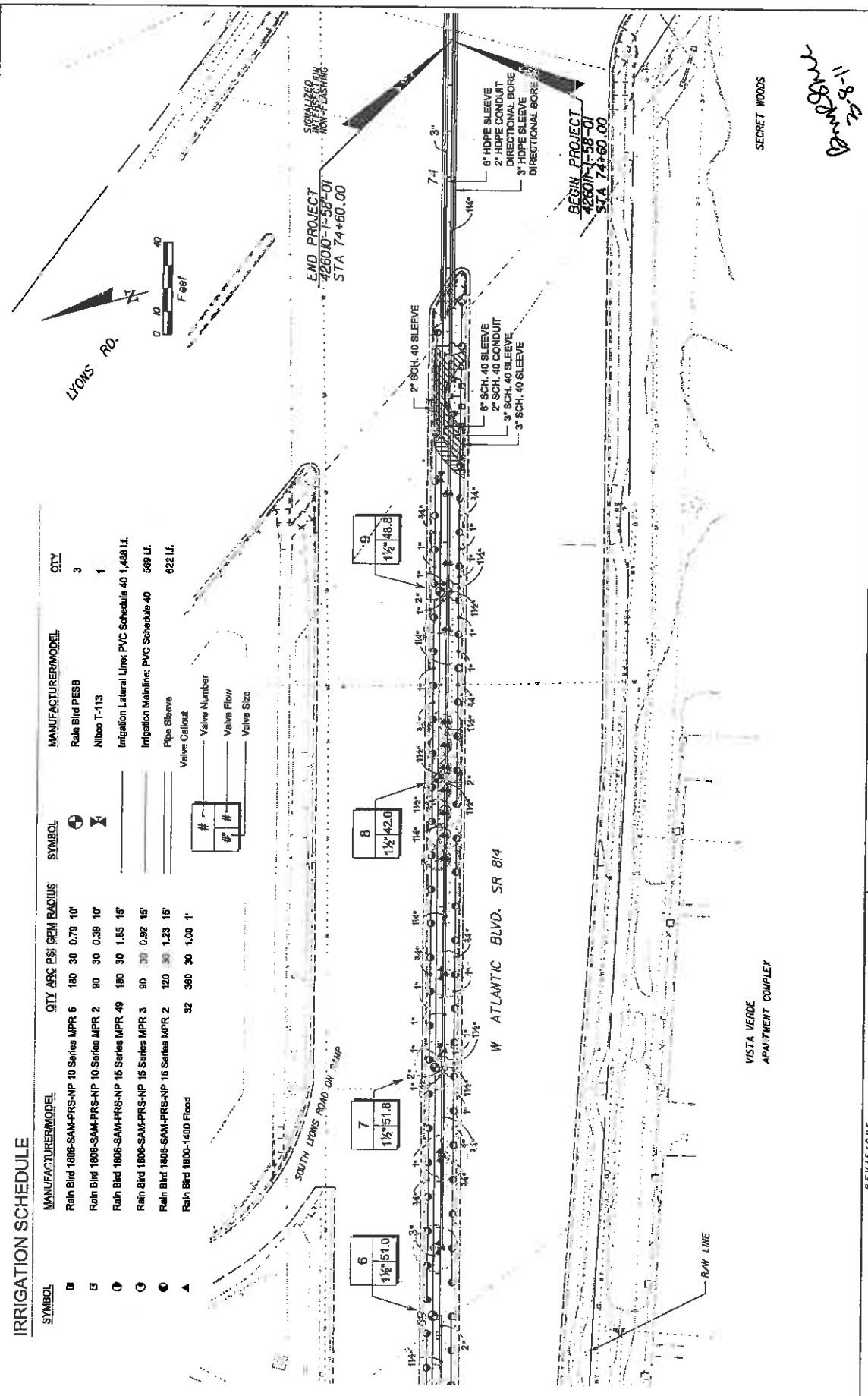

MILLER LEGG 570 North Auburn Way, Fort Lauderdale, Florida 33309-3368 954-438-7000 • Fax 954-432-8861 • www.mlegg.com Div. of T&E, L10000077, L.A. of Rowlett Blvd. 7, Suite LA-666770		CITY OF COCONUT CREEK ROAD NO. 814 COUNTY BROWARD ID-00249	SHEET NO. LD-23
DATE: _____ BY: _____	REVISIONS DATE: _____ BY: _____	DESCRIPTION: _____ DATE: _____ BY: _____	IRRIGATION PLAN SECRET WOODS 11-8-22 [Signature]

IRRIGATION SCHEDULE

SYMBOL	MANUFACTURER/MODEL	QTY	ARC	PSI	GPM	RADIUS	SYMBOL	MANUFACTURER/MODEL	QTY
☉	Rain Blvd 1806-SAM-PRS-NP 10 Series MPR 3	180	30	0.79	10'		☉	Rain Blvd PESS	2
☉	Rain Blvd 1806-SAM-PRS-NP 10 Series MPR 2	90	30	0.39	10'		☉	Nibloc T-113	1
☉	Rain Blvd 1806-SAM-PRS-NP 15 Series MPR 55	180	30	1.65	15'		C	Rain Blvd ESP-24SITE-W	1
☉	Rain Blvd 1806-SAM-PRS-NP 15 Series MPR 3	90	30	0.92	15'		ESHP	SHP Centrifugal Pump Station / Well	1
☉	Rain Blvd 1806-SAM-PRS-NP 15 Series MPR 3	120	30	1.23	15'			Irrigation Lateral Line: PVC Schedule 40	1,765 Lf.
▲	Rain Blvd 1800-1400 Flood	36	300	3.0	1.00 1'			Irrigation Mainline: PVC Schedule 40	619 Lf.

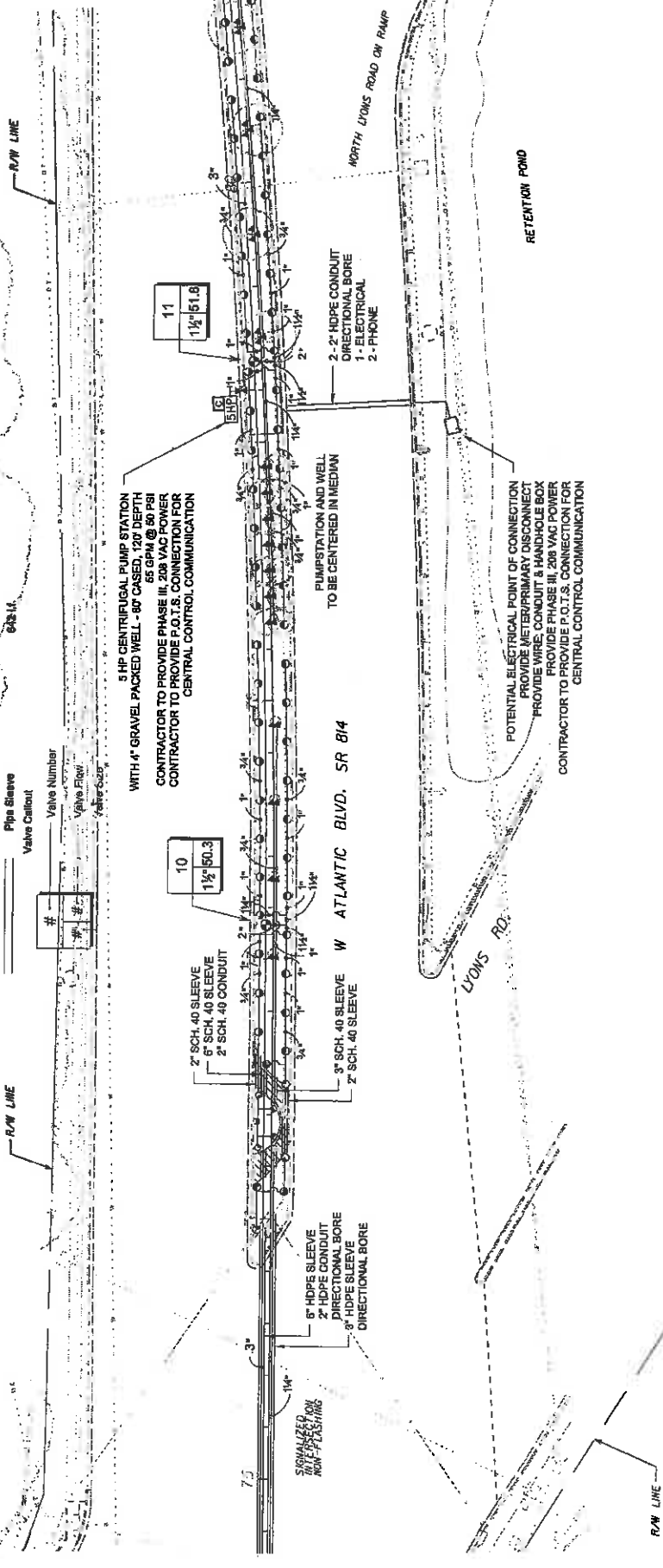

10	1 1/2" 50.3
----	-------------

11	1 1/2" 51.6
----	-------------

DATE	REVISION	DESCRIPTION

MILLER LEGG
570 North Auburn Way, Port Lizards, WA 92008-2084
914-466-2000, Fax: 914-466-4444, www.millerlegg.com
Dist. of: 11/2007, L.A. of: 11/2007, L.A. of: 11/2007

CITY OF COCONUT CREEK		
ROAD NO.	COUNTY	MILLER LEGG PROJECT ID
814	BROWARD	10-00249

SHEET NO.	LD-24
-----------	-------

Handwritten: 2-8-11
Handwritten signature



IRRIGATION SCHEDULE

SYMBOL	MANUFACTURER/MODEL	CITY ARC PSI GPM RADIUS	SIZE	MANUFACTURER/DESCRIPTION	CITY
1	Rain Blnd 1806-SAM-PRS-NP 16 Strip Series 1	EST 30 0.61 4'x16'	⊕	Rain Blnd PESSB	3
2	Rain Blnd 1806-SAM-PRS-NP 15 Strip Series 4	SST 30 1.21 4'x30'	⊗	Nibco T-113	1
3	Rain Blnd 1806-SAM-PRS-NP 10 Series MFR 17	180 30 0.79 10'		Irrigation Lateral Line: PVC Schedule 40 1,197 LL	
4	Rain Blnd 1806-SAM-PRS-NP 16 Series MFR 41	180 30 1.85 15'		Irrigation Mainline: PVC Schedule 40 671 LL	
5	Rain Blnd 1800-1400 Flood	28 390 30 1.00 1'		Pipe Sleeve Valve Callout	50 LL

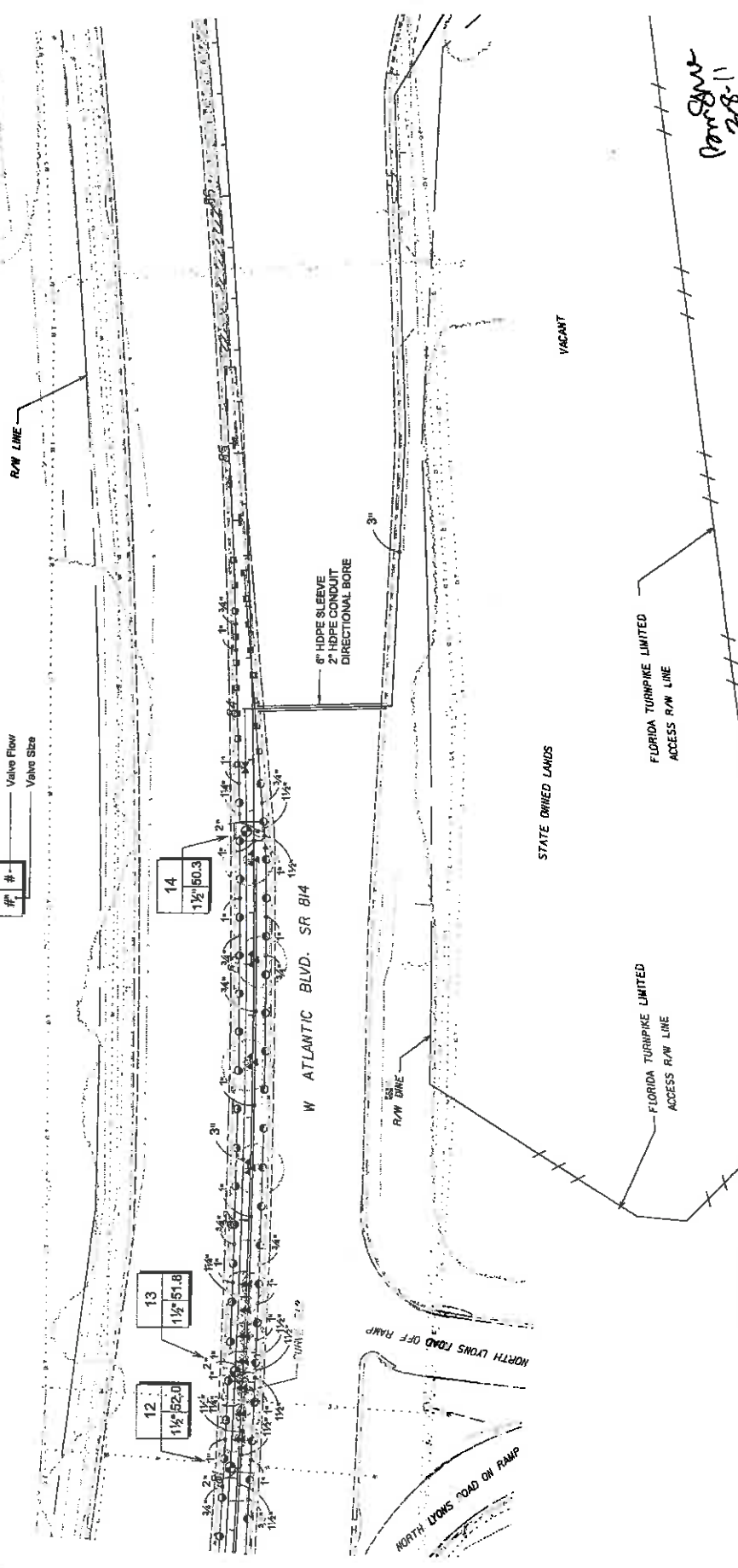
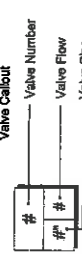

Long Shot 7-8-11

DATE	BY	DESCRIPTION	REVISIONS	DATE	BY	DESCRIPTION

MILLER LEGG
 3714 N. W. 11th Street, Ft. Lauderdale, Florida 33309-3304
 954-532-9800 • Fax 954-532-9866
 Div. of Miller LUMBER CO. L.L.C. of Boardman, Ohio 44603

CITY OF COCONUT CREEK
 ROAD NO. 814
 COUNTY BROWARD
 MILLER LEGG PROJECT ID 10-C0249

SHEET NO.	LD-25
-----------	-------

IRRIGATION SCHEDULE

SYMBOL	MANUFACTURER/MODEL	QTY	ABC ESI GPM RADIUS
—	Rain Bird 1806-SAM-PRS-NP 16 Strip Section 1	ESST 30	0.61 4X16"
⊥	Rain Bird 1806-SAM-PRS-NP 15 Strip Series 4	SSST 30	1.21 4X30"
⊖	Rain Bird 1806-SAM-PRS-NP 10 Series MPR 8	180 30	0.79 10"
⊖	Rain Bird 1806-SAM-PRS-NP 10 Series MPR 1	90 30	0.39 10"
⊖	Rain Bird 1806-SAM-PRS-NP 10 Series MPR 1	120 30	0.53 10"

SYMBOL	MANUFACTURER/MODEL	QTY
⊖	Rain Bird PESB	1
⊖	Nihoco T-113	2
—	Irrigation Lateral Line: PVC Schedule 40	218 ft.
—	Irrigation Mainline: PVC Schedule 40	692 ft.
—	Pipe Sleeve	104 ft.

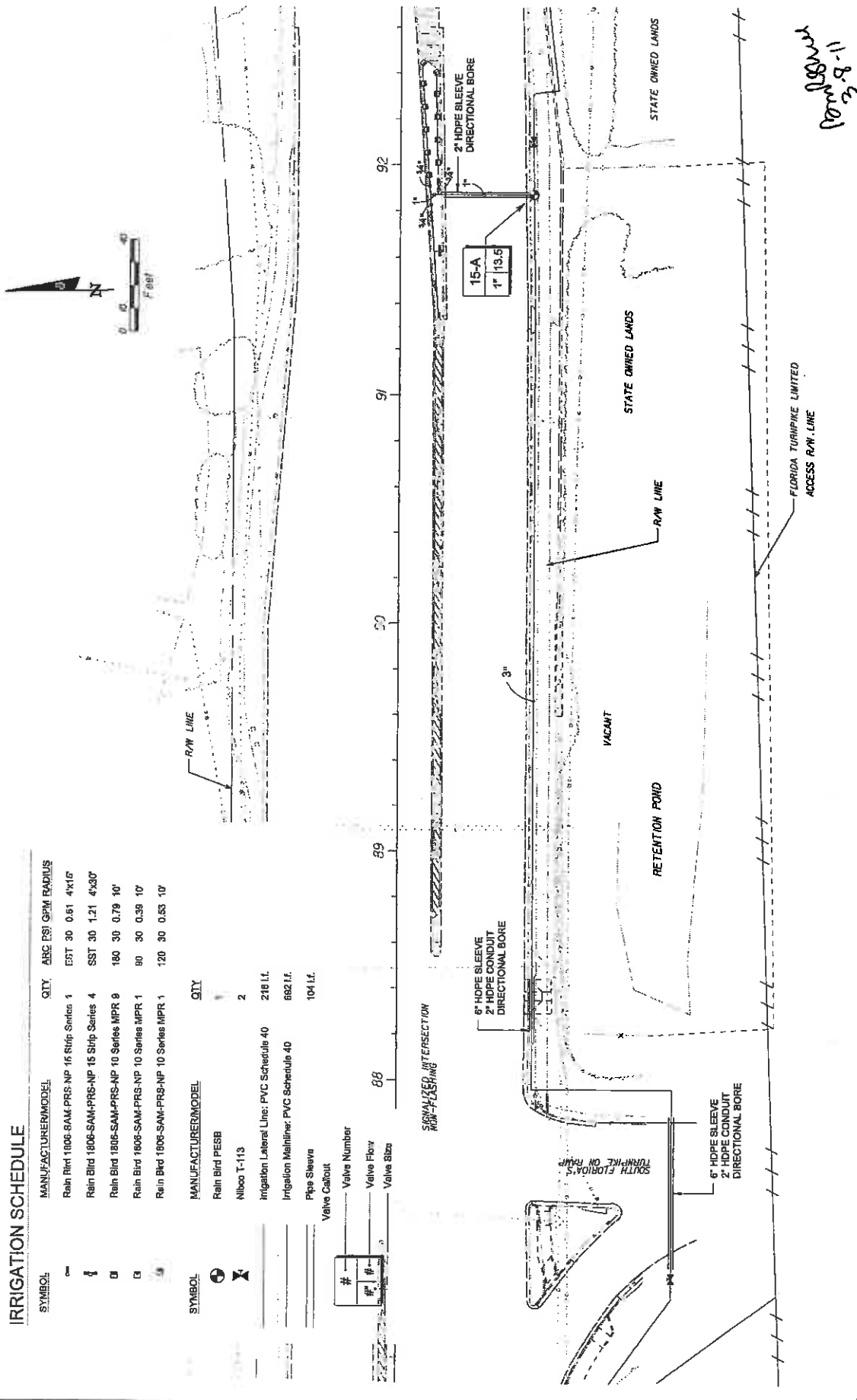
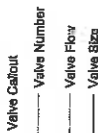

<h2>IRRIGATION PLAN</h2>	
<p><i>11-18-23</i></p>	
<p>FLORIDA TURNPIKE LIMITED ACCESS R/W LINE</p>	
<p>STATE OWNED LANDS</p>	
<p>VACANT</p>	
<p>RETENTION POND</p>	
<p>R/W LINE</p>	
<p>STATE OWNED LANDS</p>	
<p>15-A 1" (3.5)</p>	
<p>2" HDPE SLEEVE DIRECTIONAL BORE</p>	
<p>3"</p>	
<p>6" HDPE SLEEVE 2" HDPE CONDUIT DIRECTIONAL BORE</p>	
<p>SOUTH FLORIDA'S TURNPIKE ON RAMP</p>	
<p>6" HDPE SLEEVE 2" HDPE CONDUIT DIRECTIONAL BORE</p>	
<p>88 89 90 91 92</p>	
<p>SIGNALIZED INTERSECTION ROW FLASHING</p>	
<p>104 ft.</p>	
<p>692 ft.</p>	
<p>218 ft.</p>	
<p>2</p>	
<p>1</p>	
<p>ESST 30</p>	
<p>SSST 30</p>	
<p>180 30</p>	
<p>90 30</p>	
<p>120 30</p>	
<p>0.61 4X16"</p>	
<p>1.21 4X30"</p>	
<p>0.79 10"</p>	
<p>0.39 10"</p>	
<p>0.53 10"</p>	

DATE	BY	DESCRIPTION

MILLER LEGG 570 North Jackson Way - Fort Lauderdale, Florida 33309-2364 954-437-2000 Fax: 954-542-8861 www.millerlegg.com Dist. of Fla. Lic. 120000077, Lic. of Record Plans Lic. 14-0000770		CITY OF COCONUT CREEK ROAD NO. 814 COUNTY BROWARD MILLER LEGG PROJECT ID 10-00249
--	--	--

DATE	BY	DESCRIPTION

SHEET NO.	LD-26
-----------	-------

IRRIGATION SCHEDULE

SYMBOL	MANUFACTURER/MODEL	QTY	ARC PSI	GPM	RADIUS
⊙	Rain Bird 1806-SAM-PRS-NP 15 Series MPR 30	180	30	1.85	16'
⊙	Rain Bird 1808-SAM-PRS-NP 15 Series MPR 4	90	30	0.92	16'
⊙	Rain Bird 1806-SAM-PRS-NP 15 Series MPR 4	120	30	1.23	16'
▲	Rain Bird 1800-1400 Flood	14	30	1.00	1'

MANUFACTURER/MODEL	QTY
Rain Bird PESS	2
Irrigation Lateral Line: PVC Schedule 40	770 LI.
Irrigation Mainline: PVC Schedule 40	382 LI.
Galvanized pipe / conduit	287 LI.

Valve Cabout

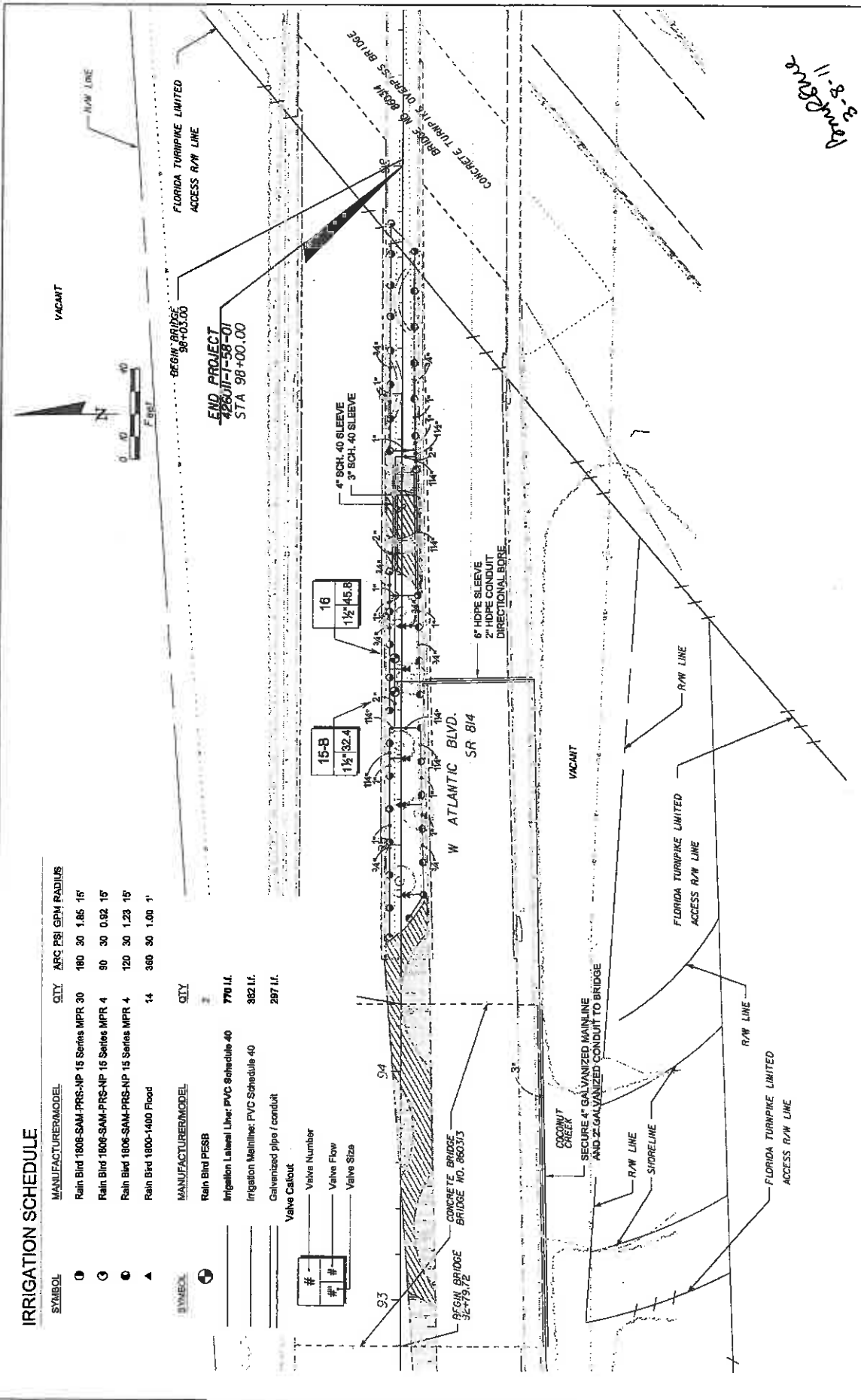
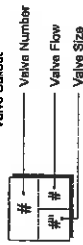

DATE	BY	DESCRIPTION	REVISIONS	DATE	BY	DESCRIPTION

MILLER LEGG
 5101 North Avenue Way, Fort Lauderdale, Florida 33309-3304
 954-485-1000 Fax: 954-485-8866 www.millerlegg.com
 One of the LEADERS in Irrigation in the U.S. Since 1960

CITY OF COCONUT CREEK	PROJECT ID	10-00247
ROAD NO. 814	COUNTY BROWARD	PROJECT NO. 10-00247

SHEET NO. LD-27

Handwritten: 3-8-11
 3-8-11

PROJECT SPECIFIC GENERAL NOTES:

1. Traffic controls shall be in accordance with the project plans, the current edition of the Florida Department of Transportation (FDOT) Design Standards (GDO series), the Standard Specification for Road and Bridge Construction, and the current Manual on Uniform Traffic Control Devices as minimum criteria.
2. Notification of lane closures shall be accompanied 14 working days prior to closure submitting the required lane closure form, sketches, calculations, and other data through the Engineer to the District Traffic Operations Office.
3. Traffic disruptions which are not shown by the traffic control plan, but which are necessary to construct the project shall be submitted in writing to the engineer 14 days prior to the commencement of work. Submittal material shall include sketches, calculations and other data required by the Engineer.
4. The traffic and travel ways shall not be altered by the Contractor to create a work zone until all labor and material are available for the construction in that area.
5. Lane closings shall occur only during non-peak hours. Peak hours are from: 7:00-9:00am and 4:00-6:00pm.
6. The regulatory speed through the work zone shall be posted 45 mph.
7. As approved by the Engineer, the Contractor shall cover work zone signs when conditions no longer warrant their use. Cost of covering and uncovering the signs, daily maintenance and monitoring shall be included in maintenance of traffic.
8. Contractor shall remove, relocate or cover any existing or proposed signs that conflict with the traffic control plans. When the conflict no longer exists, the contractor shall restore the signs to their original position. Cost of temporarily removing, relocating, covering and restoring the signs shall be included in maintenance of traffic.
9. Uniformed, off-duty law enforcement officers can be used only as approved by the Engineer and use is limited to construction operations for setting and removing traffic control devices, night work, moving operations, or other situations specifically approved by the Engineer. All cost for the officer(s) shall be included in the maintenance of traffic.
10. All existing signage shall be maintained in an appropriate location for the duration of the project.
11. The contractor shall maintain a minimum of one lane of traffic at all times for minor side streets. During one lane operation a flag man shall be used. If operation exceeds one work period, contractor shall cover excavation and return two way traffic at the end of each work period.
12. If temporary lane closure causes extended congestion, the contractor shall, at the direction of the Engineer, reopen the closed lane(s) at no additional cost until such time the traffic flow has returned to an acceptable level.
13. Provisions for traffic control plan which are not anticipated in the traffic control plans, but are necessary for project construction shall be submitted to the engineer at least 72 hours prior to using such provisions.
14. A certified maintenance of traffic supervisors shall be available to the project at all times when the contractor is working and shall be on call for emergencies when the Contractor is not working. All work shall cease when MOT Supervisor is not present.
15. Access shall be provided to all places of business and residences whenever construction interferes with the existing means of access. Adequate accommodations for intersecting and crossing traffic shall be provided and maintained by the contractor. No road or street crossings within the project shall be blocked or unduly restricted as determined by the engineer.
16. Contractor shall be responsible for the immediate removal of storm water from roadways utilized for maintaining traffic in a manner approved by the Engineer. Cost for removing the water shall be included in maintenance of traffic.
17. Arrows provided on details denote direction of traffic only and do not reflect pavement markings unless specifically noted.

Markings:

1. The contractor shall maintain all existing pavement markings during construction. If necessary, Contractor shall submit to the Engineer any modifications or temporary markings to the existing pavement markings during construction. Cost of removal of temporary pavement markings, regardless of method, is included in the related pavement marking maintenance of traffic. Use of black paint to cover existing and/or temporary pavement markings is prohibited.

Drop offs: The contractor's attention is directed to lot standard index no. 600, sheet 6 of 10.

Signals:

1. The contractor shall have full responsibility for the normal maintenance of existing traffic signal(s) within the project limits. All signals shall remain in full operation unless deemed necessary for construction activities. The contractor shall notify Broward County Traffic Engineering Division (BCTED) (Telephone number (954) 847-2600) a minimum of 10 working days prior to any modification and/or changes of an existing traffic signal (i.e. Taking signals off-line, removing or replacing loop assemblies or rearranging traffic signal heads). The contractor shall install the temporary signalization system and have the system in operation before taking the existing system out of service. Portable temporary units shall not be used. The temporary signal system shall be adjusted to the traffic needs of each construction phase. Signal heads are to be located with respect to approach lanes. Cost of adjusting temporary signal for the required top phases shall be included in maintenance of traffic.
2. The contractor shall utilize the existing signal equipment or provide all necessary signalization components and appurtenances, including but not limited to poles, temporary electric service connections, temporary conduits and wires, relocation of existing controllers or temporary controllers, and necessary signal timing coordination with Broward County Traffic. The contractor shall provide maintenance of the temporary signal system until the permanent system is installed and functional. Cost to be included in maintenance of traffic.

Pedestrian, bicycles & wheelchairs:

1. The contractor shall maintain pedestrian, bicycle, and wheel chair traffic on at least one side of the roadway at all times during construction. This shall be done in accordance to index 660 1011.
2. At the end of each work day or whenever the work zone becomes inactive, any drop-off adjacent to pedestrian travel paths shall be backfilled flush with the travel path or shall be protected with barricades, temporary barrier wall or approved handrail.
3. Pedestrian, bicycles, and wheelchair traffic shall be guided and maintained using approved warning lights, signing, markings, and channelization devices. Such control devices shall be installed and maintained in accordance with, but not less than, standards and the current manual. All additional requirements must be maintained.
4. The contractor shall maintain access and signs for existing bus stop locations within the project limits. If existing bus stops need to be relocated, provisions to accommodate bus stops must be coordinated with the Broward County Mass Transit Agency, telephone number (954) 357-8400.
5. The maintenance of traffic shall include provisions for school pedestrian traffic with the following minimum requirements: The safe walk routes for all schools within the vicinity of the construction zone shall be maintained during the times students are arriving at or leaving school. All construction equipment around any designated crosswalk shall cease to operate during the times students are arriving at or leaving school. All construction equipment adjacent to a designated walk route shall cease operating unless satisfactorily barricaded from the walk route. In the case that a designated crossing on any portion of the designated walk route cannot be maintained, then the contractor shall notify the school safety coordinator at Broward County Traffic Engineering Division, (954) 847-2600, a minimum of ten (10) working days prior to closing that route so that an alternate crossing route can be established. Thirty (30) days prior to the beginning of construction the contractor shall notify the school safety coordinator at Broward County Traffic Engineering Division, (954) 847-2600, to arrange a pre-construction school safety meeting.

Landscaping plan specific notes:

1. For landscape work within or near median, reference sheets LD-26 and LD-27 (index 6 13). For landscape work along outer edges and ramp area, reference sheet LD-8 (index 6 12).
2. INTERSECTIONS: Vista Verde Entrances, South Lyons Road on and off ramps, North Lyons Road on and off ramps, Lyons Road, Florida's Turnpike on ramp.
3. Traffic control at intersections must provide sight distances for the road user to perceive potential conflicts and to traverse the intersection safely.
4. FDOT standard index 616 must be implemented when median work near intersection condition exists.
5. Contractor to cover signal heads or make signal head revisions where impacted due to maintenance of traffic per FDOT standard index 600 and lot traffic operations office. Broward County Transit Route 42 runs along SR 814.
6. Maintenance of traffic shall include provisions for pedestrians and / or school traffic as well as vehicular traffic. Contractor to comply with all school safety requirements as outlined in the BCTED Maintenance of traffic Schedule / pedestrian criteria.

DATE	BY	DESCRIPTION	REVISIONS

MILLER LEGG
 570 North Adams Way Fort Lauderdale, Florida 33309-3344
 954-535-1000 Fax: 954-535-9660 www.millerlegg.com
 Cal. # of Mch. 180003101 - Register of Firms for C. (Contractors) 18-0882

CITY OF COCONUT CREEK
 ROAD NO. 814 COUNTY BROWARD
 MILLER LEGG PROJECT ID 10-00247

TRAFFIC CONTROL NOTES
 SHEET NO. LD-28

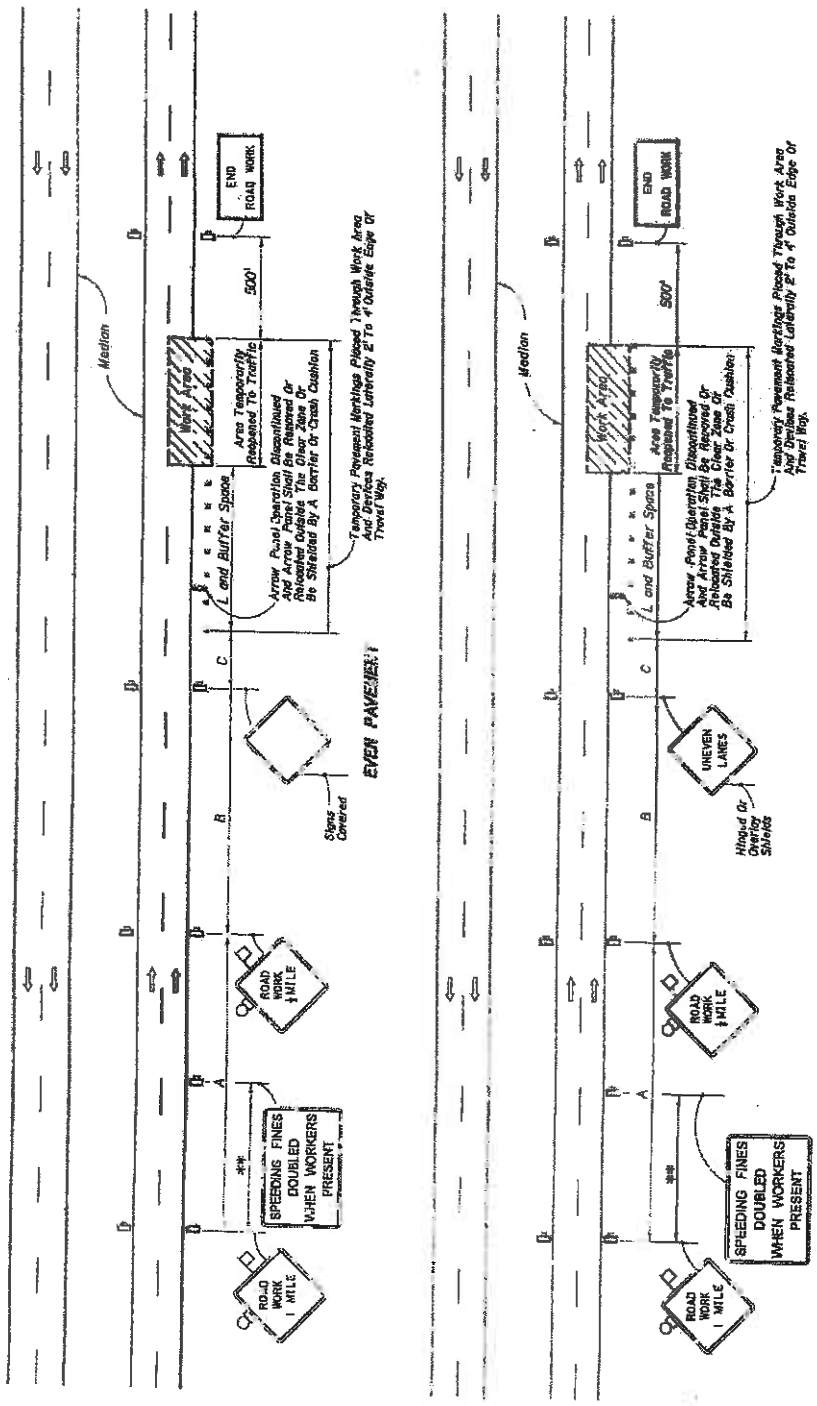

INTERMITTENT WORK STOPPAGE - LANE RESERVED TO TRAFFIC

09/25/11

REVISIONS		DESCRIPTION		DATE		BY	

CITY OF COCONUT CREEK		MILLER LEGG PROJECT ID
ROAD NO. 814	COUNTY BROWARD	10-00249

MILLER LEGG		TRAFFIC CONTROL DETAIL	
600 N.W. 10TH AVENUE, SUITE 100, BOCA RATON, FL 33430			
Tel: 561-391-1100 Fax: 561-391-1101			
Web: www.millerlegg.com			

SHEET NO.	LD-29
-----------	-------

CITY OF COCONUT CREEK
 ROAD NO. 814 COUNTY BROWARD MILLER LEGG PROJECT ID 10-00249
 MILLER LEGG
 600 N.W. 10TH AVENUE, SUITE 100, BOCA RATON, FL 33430
 Tel: 561-391-1100 Fax: 561-391-1101 Web: www.millerlegg.com
 C.O.D. No. 100000000. Subject to Board Order No. 1. Copyright © 2008
 3/17/09 3/17/09
 10/25/11
 10/25/11
 10/25/11

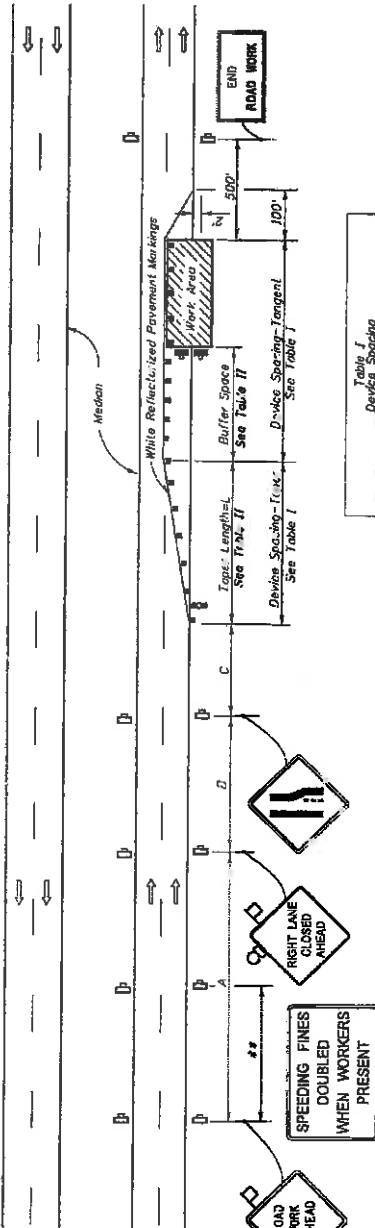

**Table II
Buffer Space and Taper Length**

Speed (mph)	Buffer Space (ft.)	Taper Length (ft.)	Notes (see text)
25	195	125	
30	200	180	
35	250	245	$L = \frac{W^2}{60}$
40	305	320	
45	360	400	
50	425	500	
55	495	600	
60	570	720	L 1WS
65	645	860	
70	730	1000	

When Buffer Space cannot be obtained due to geometric constraints, the greatest obtainable length shall be used, but not less than 200 ft.

For tapered transitions other than 1", use formula for L shown in the notes column.

Where:
L = Length of taper in feet
W = Width of lateral transition in feet
S = Posted speed limit (mph)

**Table I
Device Spacing**

Spacing (ft.)	Sign or Barricade	Type I or Type II	Notes
30 to 45	Sign	Sign	
50 to 70	Sign	Sign	
75 to 100	Sign	Sign	

GENERAL NOTES

- Work operations shall be confined to one traffic lane, leaving the adjacent lanes open to traffic.
- On undivided highways the median signs as shown are to be omitted.
- When work is performed in the median lane on divided highways, the remaining traffic lane is inverted and left lane closed and lane ends sign substituted for the right lane closed and lane ends sign. The same applies to undivided highways with the following exceptions:
(a) Work shall be confined within one median lane.
(b) Additional barricades, cones or drums shall be placed along the median, abutting the work area and across the trailing end of the work area.
- When work on undivided highways occurs across the centerline so as to encroach on both median lanes, the inverted plan is applied to the approach on both roadways.
- Signs and traffic control devices are to be modified in accordance with INTERMITTENT WORK STOPPAGE details (sheet 2 of 2) when no work is being performed and the highway is open to traffic.
- The two channelizing devices directly in front of the work area may be omitted provided vehicles in the high-intensity retarding, flashing, excavating, or strobe lights operating.
- When pavement shoulders having a width of 8 ft. or more are closed, channelizing devices shall be used to close the shoulder in advance of the work area. The devices shall be spaced to remain within the travel way. See Index No. 612 for shoulder taper formulas.

DISTANCE BETWEEN SIGNS

Speed	Spacing (ft.)
40 mph or less	A, B, C
45 mph	250
50 mph	300
55 mph	350
60 mph	400
65 mph or greater	450, 500, 600, 700, 800

* The ROAD WORK 1 MILE sign may be used as an alternative to the ROAD WORK AHEAD sign and the RIGHT LANE CLOSED 1/2 MILE sign on alternate to the ROAD WORK AHEAD sign.

** 500' beyond the ROAD WORK AHEAD sign or midway between signs whichever is less.

SYMBOLS

- Work Area
- Sign With 18" x 18" (M6)
- Orange Flag And Type B Light
- Channelizing Device (See Index No. 600)
- Type I Type II Or Type III Barricade Or Vertical Panel Drum (With Flashing Light)
- Work Zone Sign
- Advance Warning Arrow Panel

- When a side road intersects the highway within the TTC zone, additional TTC devices shall be placed in accordance with other applicable TTC indexes.
- This TTC plan does not apply when work is being performed in the middle lane(s) of a six or more lane highway. See Index No. 614.
- For general TTC requirements and additional information, refer to Index No. 600.

DURATION NOTES

- Temporary white signage may be omitted for work operations less than 3 days.
- Signs, arrow panels and buffer space may be omitted if all of the following conditions are met:
a) Work operations are 60 minutes or less.
b) The sign is placed in the work area to vehicles approaching the work area for a distance equal to the buffer space and the taper length combined.
c) Vehicles in the work area have high-intensity, rotating, flashing, excavating, or strobe lights operating.
d) Volume and complexity of the roadway has been considered.

CONDITIONS

WHERE ANY VEHICLE, EQUIPMENT, WORKERS OR THEIR ACTIVITIES ENCLOSED ON THE LANE ADJACENT TO EITHER SHOULDER AND THE AREA 2' OUTSIDE THE EDGE OF TRAVEL WAY.

02/21/11
S. O.

DATE	BY	DESCRIPTION	REVISIONS	DATE	BY	DESCRIPTION

CITY OF COCONUT CREEK
MILLER LEGG PROJECT ID
ROAD NO. 614 COUNTY PAVEMENT PROJECT ID 10-00249
E-TOWN-STD

MILLER LEGG
600 N.W. 28th Way, Suite 400, Fort Lauderdale, FL 33309
561-991-2000 Fax: 561-991-6700 www.millerlegg.com
City of Miami, 33007315 - Supplier of Roadway Signs & Channelizing Devices

TRAFFIC CONTROL DETAIL

SHEET NO. LD-30

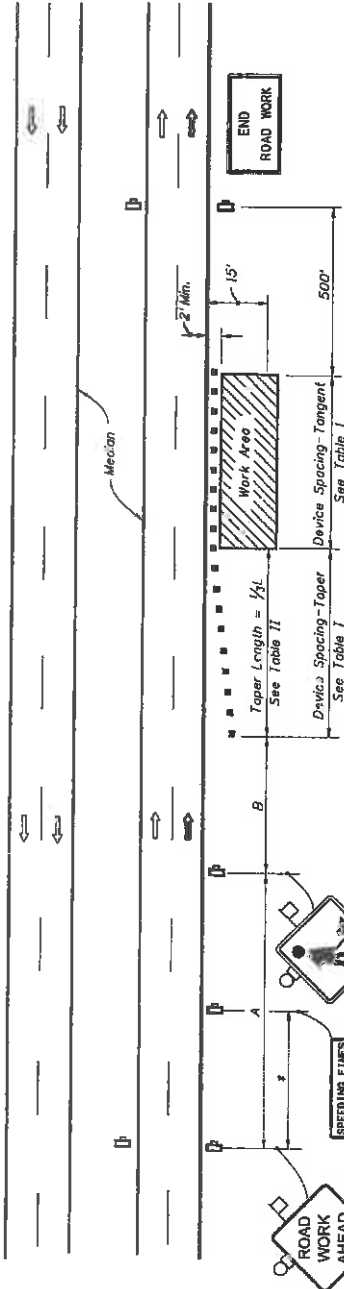

Table II
Taper Length - Shoulder

Speed (mph)	1/2 L (ft.)		Notes
	8' Shldr.	12' Shldr.	
25	28	35	42
30	40	50	60
35	55	68	82
40	72	90	107
45	120	150	180
50	133	167	200
55	147	185	220
60	160	200	240
65	173	217	260
70	187	233	280

8' minimum shoulder width.
1/2 L = Length of shoulder taper in feet
W = Width of total shoulder in feet (combined paved and unpaved width)
S = Posted speed limit (mph)

Table I
Device Spacing

Speed (mph)	Max. Distance Between Devices (ft.)	
	Cones or Tubular Markers	Type I or Type II Barricades or Vertical Panels or Drums
25	25	50
30 to 45	25	50
50 to 70	25	50
70 to 100	30	100

DISTANCE BETWEEN SIGNS

Speed	Spacing (ft.)	
	A	B
40 mph or less	200	500
45 mph	350	350
50 mph or greater	500	500

* 500' beyond the ROAD WORK AHEAD sign or midway between signs, whichever is less.

SYMBOLS

- Work Area
- Sign With 18"x18" (Min.) Orange Flag And Type B Light
- Channelizing Device (See Index No. 600)
- Work Zone Sign
- Lane Identification + Direction of Traffic

GENERAL NOTES

1. If the work operation encroaches on the through traffic lanes or in a one hour period (excluding establishing and terminating the work area), a flagger shall be provided and a FLAGGER sign shall be substituted for the WORKERS sign. The flagger shall be positioned at the point of vehicle entry or departure from the work area.
2. This TCZ plan also applies to work performed in the median more than 2' but less than 15' from the edge of travelway.
3. When work is being performed on a multilane undivided roadway the signs normally mounted in the median (as shown) shall be omitted.
4. WORKERS signs to be removed or fully covered when no work is being performed.
5. SHOULDER WORK sign may be used as an alternate to the WORKER symbol sign.
6. When a side road intersects the highway within the TTC zone, additional TTC devices shall be placed in accordance with other applicable TCZ indexes.
7. For general TCZ requirements and additional information, refer to Index No. 600.

DURATION NOTES

1. Signs and channelizing devices may be omitted if all the following conditions are met:
 - a) Work operations are night or less.
 - b) Vehicles in the work area have sign-intensity, rotating, flashing, oscillating, or strobe lights operating.

CONDITIONS

WHERE ANY VEHICLE, EQUIPMENT, WORKERS OR THEIR ACTIVITIES ENDOURGE THE AREA CLOSER THAN 15' BUT NOT CLOSER THAN 2' TO THE EDGE OF TRAVEL WAY.

REVISIONS		DESCRIPTION	
DATE	BY	DATE	BY

MILLER LEGG
601 N.W. 18th Way, Suite 100, Ft. Lauderdale, Florida 33309
Phone: (305) 554-4400 Fax: (305) 554-4402 www.millerlegg.com
Out of State: (800) 318-1111 E-mail: sales@millerglegg.com

CITY OF COCONUT CREEK
ROAD NO. COUNTY MILLER LEGG PROJECT ID
B14 BROWARD 10-00249

TRAFFIC CONTROL DETAIL

SHEET NO. LD-31

DATE: 12/25/03 PW PROJECT NO: 10-00249 - SP-PM Alternate Bid LA 300-10000-1-36-00000 - 10/10/03

MAINTENANCE PLAN

Landscape Improvements

Project State Road No(s): 814
Project Limits: MP 0.899 to MP 1.230 and MP 1.230 to MP 1.715
FM No(s): 426010-1-58-01 and 426011-1-58-01
Maintaining Agency: City of Coconut Creek
RLA of Record: Brian Shore
Date: 03-08-11

I. General Maintenance Requirements and Recommendations:

The purpose of a plan for the landscape improvements maintenance practices is to allow the plant material on your project to thrive in a safe and vigorous manner while fulfilling their intended purpose and conserving our natural resources. Plantings and all other landscape improvements shall be maintained to avoid potential roadway hazards and to provide required clear visibility, accessibility, clearance, and setbacks as set forth by Florida Department of Transportation (FDOT) governing standards and specifications: *FDOT Design Standards, FDOT Plans Preparation Manual Vol. I, Chapter 2.11* and *FDOT Standard Specifications for Road and Bridge Construction*, as amended by the contract documents, and all other requirements set forth by the District 4 Operations Maintenance Engineer. The initial portion of the Maintenance Plan describes general maintenance requirements and recommendations. The concluding section provides recommendations prepared by the Registered Landscape Architect of Record specific to the attached approved plans.

Watering Requirements:

Watering is a critical concern for not only the maintenance of healthy plant material but also for observing water conservation practices. The amount of water to apply at any one time varies with the weather, drainage conditions and water holding capacity of the soil. For plant materials that have been established, it is imperative that any mandated water restrictions be fully conformed to on FDOT roadways.

Proper watering techniques should provide even and thorough water dispersal to wet the entire root zone, but not saturate the soil or over-spray onto travel lanes.

Irrigation System:

The Agency shall ensure there are no roadway overspray or irrigation activities during daytime hours (most notably "rush hour" traffic periods). It is imperative the irrigation controller is properly set to run early enough that the watering process will be entirely completed before high traffic periods, while adhering to mandated water restrictions. To ensure water conservation, the Agency shall monitor the system for water leaks and the rain sensors to ensure they are functioning properly so that the system shuts down when there is sufficient rainfall.

Integrated Plant Management:

An assessment of each planting area's soil is recommended to periodically determine the nutrient levels needed to sustain healthy, vigorous plant growth.

Palms, shrubs, trees and turf areas shall be fertilized in such a manner and frequency to ensure that the plant material remains healthy and vigorously growing. Establishment of an integrated pest management program is encouraged to ensure healthy plants, which are free of disease and pests.

Mulching:

Mulch planting beds in such a manner as to prevent weed growth, retain moisture to the plants, protect against soil erosion and nutrient loss, maintain a more uniform soil temperature, and improve the appearance of the planting beds. Avoid mulch mounded up on the trunks of trees, palms, and the base of shrubs to encourage air movement in this area which aids in lowering disease susceptibility. Cypress mulch is prohibited on state right of way.

Pruning:

All pruning, and the associated safety criteria, shall be performed according to American National Standard Institute (ANSI) A300 standards and shall be supervised by an International Society of Arboriculture (ISA) Certified Arborist. Pruning shall be carried out with the health and natural growth of plant materials in mind, to specific pruning heights maintaining clear visibility for motorists, and provide vertical clearance for pedestrian, bicyclist, and truck traffic where applicable. Visibility windows must be maintained free of view obstructions, and all trees and palms (with particular attention to fronds and fruit) must be maintained to prevent potential roadway and pedestrian hazards. The specific pruning heights are determined by understanding the designer's intent when selecting and placing the plants. The intended mature maintained height and spread of plants are noted on the planting plans. (See Part II. Specific Requirements and Recommendations per approved landscape & irrigation design for these guidelines). The understory plant materials selected for use within the restricted planting areas (Limits of Clear Sight) are to be maintained at a height in compliance with *FDOT Design Standards* Index 546; Page 6 of 6, Window Detail. Vertical tree heights must meet *FDOT Maintenance Rating Program* (MRP) standards.

Staking and Guying:

All staking materials, except for replacements, are to be removed by the completion of FDOT warranty period or at one year (whichever comes first). Any subsequent staking and guying activities by the Agency must adhere to *FDOT Design Standards* guidelines (See Index 544). The Agency shall closely monitor staking and guying attachment materials so that they are securely fastened to avoid potential roadway hazards.

Turf Mowing:

All grassed areas are to be mowed and trimmed with sufficient frequency to maintain a deep, healthy root system while providing a neat and clean appearance to the urban landscape. All turf efforts, mowing, curb/sidewalk edging and turf condition, must meet *FDOT Maintenance Rating Program* (MRP).

Litter Control:

The project site shall remain as litter free as practicable. It is recommended to recycle this litter to avoid unnecessary waste by its reuse. Litter removal efforts must meet *FDOT Maintenance Rating Program* (MRP) standards.

Weeding/Herbicide:

All planting areas shall be maintained as weed free as practicable by enlisting integrated pest management practices in areas specified on the plans and maintaining proper mulch levels. Extreme care is recommended if using a chemical herbicide to avoid overspray onto plant materials. It is the applicator's responsibility to restore any damage, resulting from overspray to the plantings, per the approved plans.

Plant Replacement:

Plant replacement shall be the same species and specification as the approved plan. Move and replace all plant materials that may conflict with utility relocations and service. Only plants graded Florida #1 or better, per the *Florida Department of Agriculture and Consumer Services, Grades and Standards for Nursery Plants* are permitted on FDOT roadways. Should it become necessary to change the species, a general use permit is required from FDOT for approval by the FDOT District Landscape Architect.

Hardscape (Specialty Surfacing):

All specialty surfacing shall be maintained in such a manner as to prevent any potential tripping hazards and protect damage to the pavers. Final surface tolerance from grade elevations shall, at a minimum, meet the most current *Interlocking Concrete Pavement Institute (ICPI), Guide Specifications for Pavers on an Aggregate Base, Section 23 14 13 Interlocking Concrete Pavers, Part 3.05*. If the specialty surfacing or tree grates become damaged, they shall be replaced with the same type and specification as the approved plan.

Maintenance of Traffic Control :

Reference the FDOT website regarding the selection of the proper traffic control requirements to be provided during routine maintenance and / or new installations of this DOT roadway.

II. Specific Project Site Maintenance Requirements and Recommendations:

Hardscape Surfaces: a. Integrally-Colored Overlay surfaces; b. Pavers.

Routine maintenance of hardscape surfaces shall include inspections to determine color stability, cleanliness, potential trip hazard issues or settling issues, and chipping / cracking or delamination problems.

Remove efflorescence from the surfaces, as needed, with a mild acid solution or efflorescence remover. Apply a colored curing compound after efflorescence removal, matching the color of the concrete or paver. Re-seal the surface (with a clear sealer) following the efflorescence removal and curing.

Color-conditioned concrete flatwork / horizontal surfaces should be maintained by sweeping. On overlay surfaces, use low-pressure water or scrub surfaces with a mild detergent to remove surface dirt. Heavily soiled areas may be cleaned by scrubbing with a stiff bristle brush and properly diluted, high-quality commercial detergent.

Re-seal overlay surfaces as necessary or after the sealer coat is weathered or worn from the surface. Sealer should be a clear industry-approved concrete sealer suitable for colored-concrete surfaces. Follow manufacturer's instruction on application procedures.

Repair damaged areas to concrete surfaces (overlay areas) as needed with an integrally-colored concrete patch. Patch color to match existing surface color.

For pavers: sweep polymer sand in between the joints periodically or replace joint sand as needed. Remove weeds that appear in the paver field or between paver joints. Re-set pavers, as necessary, that become loose. Replace damaged pavers with a matching paver (match color and type). Seal pavers as needed with an industry-approved sealer.

REFERENCES

This reference list is provided as a courtesy. The list may not contain the most current websites. The most current references must be accessed for up to date information.

Accessible Sidewalk Videos (ADA)

<http://www.access-board.gov/news/sidewalk-videos.htm>

Americans with Disabilities Act (ADA) (ADAAG)

<http://www.ada.gov/NPRM2008/adastandards/adastds08.pdf>

American National Standard Institute, *ANSI A300, (Part 1) for Tree Care Operations – Trees, Shrub, and Other Woody Plant Maintenance – Standard Practices (Pruning)*, available for purchase

<http://www.treespecialists.com/pdfs/pruningstandards.pdf>

Florida Department of Agriculture and Consumer Services, Division of Plant Industry, *Florida Grades and Standards for Nursery Plants*, available for purchase

<http://www.doacs.state.fl.us/pi/pubs.html>

Florida Department of Community Affairs (DCA), *Florida Board of Building Codes & Standards, 2007 Florida Building Code, Chapter 11 Florida Accessibility Code for Building Construction Part A*

http://www2.iccsafe.org/states/florida_codes/

Florida Department of Transportation, *FDOT Design Standards for Design, Construction, Maintenance and Utility Operations on the State Highway System, Index 544 Landscape Installation*

<http://www.dot.state.fl.us/rddesign/rd/RTDS/10/544.pdf>

Florida Department of Transportation, *FDOT Design Standards for Design, Construction, Maintenance and Utility Operations on the State Highway System, Index 546 Sight Distance at Intersections*

<http://www.dot.state.fl.us/rddesign/rd/RTDS/10/546.pdf>

Florida Department of Transportation, *FDOT Design Standards for Design, Construction, Maintenance and Utility Operations on the State Highway System, Index 600 Traffic Control through Work Zones*

<http://www.dot.state.fl.us/rddesign/rd/rtds/10/600.pdf>

Florida Department of Transportation, *FDOT Design Standards for Design, Construction, Maintenance and Utility Operations on the State Highway System, Index 700 Roadside Offsets*

<http://www.dot.state.fl.us/rddesign/rd/RTDS/10/700.pdf>

Florida Department of Transportation, *FDOT Plans Preparation Manual (PPM) Vol. I Chapters 2.11.5, Horizontal Clearance to Trees; Table 2.11.9 Horizontal Clearance and Clear Zone; Figure 4.1.2 Clear Zone; and Table 25.4.11.1 Clear Zone Width (feet) and Table 25.4.14.6 (for existing) trees*

<http://www.dot.state.fl.us/rddesign/PPMManual/2009/Volume1/zChap02.pdf>

Florida Department of Transportation, *FDOT Standard Specifications for Road and Bridge Construction, Section 580 Landscape Installation*

<ftp://ftp.dot.state.fl.us/LTS/CO/Specifications/SpecBook/2010Book/580.pdf>

Florida Department of Transportation, Landscape Architecture Website
<http://www.dot.state.fl.us/emo/beauty/FLA.shtm>

Florida Department of Transportation, *Maintenance Rating Program Handbook*
<http://ombnet.dot.state.fl.us/procedures/bin/850065002.pdf>

Florida Department of Transportation, *Maintenance Rating Program Standards*
<http://www.dot.state.fl.us/statemaintenanceoffice/MRPHandbook2009Final.pdf>

Florida Department of Transportation Outdoor Advertising Database
<http://www2.dot.state.fl.us/rightofway/Default.aspx>

Florida Irrigation Society
<http://www.fisstaterg.org>

Florida Power and Light (FPL), *Plant the Right Tree in the Right Place*
www.FPL/trees

Guide to Roadside Mowing and Guide to Turf Management, available for purchase
<http://infonet.dot.state.fl.us/SupportServicesOffice/plist.htm>

Interlocking Concrete Pavement Institute (ICPI)
<http://www.icpi.org/>

International Society of Arboriculture (ISA)
www.isa-arbor.com

U.S. Department of Transportation, Federal Highway Administration, *Manual on Uniform Traffic Control Devices*
<http://www.mutcd.fhwa.dot.gov>

SECTION NO: 86039000
S.R. NO(S): 814 (Atlantic Blvd)
COUNTY: Broward
FM NO.(S): 426010-1-58-01
426011-1-58-01

EXHIBIT D

APPROXIMATE COST FOR LANDSCAPE IMPROVEMENTS

This Exhibit forms an integral part of the DISTRICT FOUR (4) Amendment to the HIGHWAY MAINTENANCE MEMORANDUM OF AGREEMENT between the State of Florida, Department of Transportation and the AGENCY.

Anticipated Terms of Separate Agreement

FM No. 426010-1-58-01

FDOT PARTICIPATION Via Separate Agreement	Up to	\$200,000.00
Estimated Project Cost Dated March 16, 2011		\$208,328.00

FM No. 426011-1-58-01

FDOT PARTICIPATION Via Separate Agreement	Up to	\$300,000.00
Estimated Project Cost Dated March 16, 2011		\$240,569.41

TOTAL APPROXIMATE PROJECT COST DATED MARCH 16, 2011 \$448,897.41

**TOTAL FDOT PARTICIPATION
VIA SEPARATE AGREEMENT UP TO \$500,000.00**

OPINION OF PROBABLE COST

SR 814 / ATLANTIC BOULEVARD - CITY OF COCONUT CREEK

FM 426010-1-58-01

FROM WEST OF LYONS ROAD (WESTERN CITY LIMITS) (MP 0.889) TO LYONS ROAD (MP 1.230)

DETAILED QUANTITY SUMMARY

	QUANTITY	UNIT		TOTAL COST
MISCELLANEOUS PROJECT				
MOBILIZATION	1	LS	=	\$6,898.54
CLEARING AND GRUBBING	1	LS	=	\$2,232.86
MAINTENANCE OF TRAFFIC	1	LS	=	\$3,349.27
SUBTOTAL			=	\$12,280.66
LANDSCAPING				
LARGE CANOPY TREES & SOIL & STAKING & MULCH	12	EA	=	\$35,000.00
FLOWERING CANOPY TREES & SOIL & STAKING & MULCH	3	EA	=	\$11,200.00
ACCENT TREES IN BOSQUES & SOIL & STAKING & MULCH	28	EA	=	\$25,100.00
PALMS & SOIL & STAKING & MULCH	28	EA	=	\$9,450.00
HORIZONTAL COCOPLUM & SOIL & MULCH	210	EA	=	\$3,570.00
BLUEBERRY FLAX LILY & SOIL & MULCH	0	EA	=	\$0.00
PARSONS JUNIPER & SOIL & MULCH	135	EA	=	\$1,620.00
DWARF YALPON HOLLY & SOIL & MULCH	215	EA	=	\$3,655.00
MUHLI GRASS & SOIL & MULCH	130	EA	=	\$1,300.00
FAKAHATCHEE GRASS & SOIL & MULCH	130	EA	=	\$1,300.00
PERFORMANCE TURF - SOD & SOIL	0.24	AC	=	\$11,818.00
MOWING (DURING CONSTRUCTION)	0.47	AC	=	\$5,000.00
LITTER REMOVAL & DISPOSAL	0.47	AC	=	\$2,500.00
PLANT ESTABLISHMENT & MAINTENANCE	1	LS	=	\$15,000.00
LANDSCAPING SUBTOTAL			=	\$124,513.00
IRRIGATION				
PUMP STATION & CONTROLLER (shared cost)	1	EA	=	\$6,250.00
WELL (shared cost)	1	EA	=	\$2,250.00
IRRIGATION MAINLINE	1,358	LF	=	\$5,433.33
LATERAL LINES & FITTINGS	2,873	LF	=	\$5,746.00
BRIDGE CROSSING	0	LF	=	\$0.00
HEADS & MISC RISERS & ACCESSORIES	143	EA	=	\$2,850.00
REMOTE CONTROL VALVES & VALVE BOXES	8	EA	=	\$1,200.00
CONTROL W/IFE	2500	LF	=	\$1,250.00
ISOLATION GATE VALVES & VALVE BOXES	2	EA	=	\$350.00
SLEEVING	250	LF	=	\$2,000.00
DIRECTIONAL BORE	315	LF	=	\$12,600.00
IRRIGATION MAINTENANCE	1	LS	=	\$4,000.00
IRRIGATION SUBTOTAL			=	\$43,929.33
HARDSCAPE				
DECORATIVE OVERLAY - PATTERN CONCRETE MEDIAN NOSES	76	SY	=	\$4,180.00
DECORATIVE OVERLAY - PATTERN CONCRETE BRIDGE MEDIAN	0	SY	=	\$0.00
NEW HARDSCAPE TREATMENT - ARCHITECTURAL PAVERS	195	SY	=	\$17,550.00
NEW HARDSCAPE TREATMENT - PATTERN CONCRETE OVERLAY	0	SY	=	\$0.00
NEW HARDSCAPE TREATMENT - NEW CONCRETE BASE	0	SY	=	\$0.00
NEW HARDSCAPE TREATMENT - NEW LIMEROCK SUBBASE	195	SY	=	\$4,875.00
HARDSCAPE MAINTENANCE	1	LS	=	\$1,000.00
HARDSCAPE SUBTOTAL			=	\$27,605.00
TOTAL PROJECT				\$208,328.00

OPINION OF PROBABLE COST

SR 814 / ATLANTIC BOULEVARD - CITY OF COCONUT CREEK

FM 426011-1-58-01

FROM LYONS ROAD (MP 1.230) TO FLORIDA'S TURNPIKE (MP 1.715)

DETAILED QUANTITY SUMMARY

	QUANTITY	UNIT	TOTAL COST
MISCELLANEOUS PROJECT			
MOBILIZATION	1	LS =	\$9,279.01
CLEARING AND GRUBBING	1	LS =	\$3,093.10
MAINTENANCE OF TRAFFIC	1	LS =	\$4,633.06
SUBTOTAL		=	\$17,012.08
LANDSCAPING			
LARGE CANOPY TREES & SOIL & STAKING & MULCH	8	EA =	\$35,000.00
FLOWERING CANOPY TREES & SOIL & STAKING & MULCH	9	EA =	\$11,200.00
ACCENT TREES IN BOSQUES & SOIL & STAKING & MULCH	14	EA =	\$23,100.00
PALMS & SOIL & STAKING & MULCH	14	EA =	\$9,450.00
HORIZONTAL COCOPLUM & SOIL & MULCH	195	EA =	\$3,315.00
BLUEBERRY FLAX LILY & SOIL & MULCH	0	EA =	\$0.00
PARSONS JUNIPER & SOIL & MULCH	95	EA =	\$1,140.00
DWARF YAUPON HOLLY & SOIL & MULCH	350	EA =	\$5,950.00
MUFLY GRASS & SOIL & MULCH	65	EA =	\$650.00
FAKAHATCHEE GRASS & SOIL & MULCH	65	EA =	\$650.00
PERFORMANCE TURF - SOD & SOIL	0.24	AC =	\$11,818.00
MOWING (DURING CONSTRUCTION)	0.47	AC =	\$5,000.00
LITTER REMOVAL & DISPOSAL	0.47	AC =	\$2,500.00
PLANT ESTABLISHMENT & MAINTENANCE	1	LS =	\$15,000.00
LANDSCAPING SUBTOTAL		=	\$124,773.00
IRRIGATION			
PUMP STATION & CONTROLLER	1	EA =	\$6,250.00
WELL	1	EA =	\$2,250.00
IRRIGATION MAINLINE	1,358	LF =	\$5,433.33
LATERAL LINES & FITTINGS	2,973	LF =	\$5,748.00
BRIDGE CROSSING	150	LF =	\$2,250.00
HEADS & MISC RISERS & ACCESSORIES	143	EA =	\$2,850.00
REMOTE CONTROL VALVES & VALVE BOXES	5	EA =	\$1,200.00
CONTROL WIRE	2500	LF =	\$1,250.00
ISOLATION GATE VALVES & VALVE BOXES	2	EA =	\$350.00
SLEEVING	250	LF =	\$2,000.00
DIRECTIONAL BORE	315	LF =	\$12,600.00
IRRIGATION MAINTENANCE	1	LS =	\$4,000.00
IRRIGATION SUBTOTAL		=	\$46,179.33
HARDSCAPE			
DECORATIVE OVERLAY - PATTERN CONCRETE MEDIAN NOSES	76	SY =	\$4,180.00
DECORATIVE OVERLAY - PATTERN CONCRETE BRIDGE MEDIAN	295	SY =	\$16,225.00
NEW HARDSCAPE TREATMENT - ARCHITECTURAL PAVERS	207	SY =	\$18,630.00
NEW HARDSCAPE TREATMENT - PATTERN CONCRETE OVERLAY	47	SY =	\$2,585.00
NEW HARDSCAPE TREATMENT - NEW CONCRETE BASE	47	SY =	\$2,585.00
NEW HARDSCAPE TREATMENT - NEW LIMEROCK SUBBASE	256	SY =	\$6,400.00
HARDSCAPE MAINTENANCE	1	LS =	\$2,000.00
HARDSCAPE SUBTOTAL		=	\$52,605.00
TOTAL PROJECT			\$240,569.41