

**SECTION: 86028000**  
**COUNTY: BROWARD**  
**STATE RD: 834**  
**PERMIT: 2024-L-491-00007**

**AMENDMENT NUMBER NINE (9) TO  
FLORIDA DEPARTMENT OF TRANSPORTATION DISTRICT FOUR (4)  
LANDSCAPE INCLUSIVE MAINTENANCE MEMORANDUM OF AGREEMENT**

**THIS AMENDMENT** Number Nine (9) to the Agreement dated May 27, 2009, made and entered into this \_\_\_\_\_ day of \_\_\_\_\_ 20\_\_\_\_ by and between the **STATE OF FLORIDA DEPARTMENT OF TRANSPORTATION** hereinafter called the **DEPARTMENT** and the **CITY OF COCONUT CREEK**, a municipal subdivision of the State of Florida, hereinafter called the **AGENCY**.

**W I T N E S S E T H**

**WHEREAS**, the parties entered into the Landscape Inclusive Maintenance Memorandum of Agreement dated, May 27, 2009 (Original Agreement) for the purpose of the **AGENCY** maintaining landscape improvements on various state roads within the **AGENCY'S** jurisdiction, including **State Road 834 (Sample Road)**; and,

**WHEREAS**, the **DEPARTMENT** and the **AGENCY** have agreed to add additional landscape on **State Road 834 (Sample Road)** in accordance with the Original Agreement; and,

**NOW THEREFORE**, for and in consideration of mutual benefits that flow each to the other, the parties covenant and agree as follows:

1. Pursuant to Page 7, Paragraph 8 of the Original Agreement, the **DEPARTMENT** will allow an Adjacent Property Owner to construct, via permit, additional landscape improvements within the **DEPARTMENT'S** right-of-way, or to modify an improvement located as indicated in **Exhibit "A"** on **State Road 834 (Sample Road)** from M.P. 4.387 to M.P. 4.455, in accordance with the plans attached as **Exhibit "B"**.
2. The **AGENCY** shall agree to maintain the additional landscape improvements in this Amendment, including the meandering concrete sidewalk, shrubs, and irrigation, in accordance with the Original Agreement's Exhibit "C", Maintenance Plan, Part I, and Part II as follows:

## **II. SPECIFIC PROJECT SITE MAINTENANCE REQUIREMENTS AND RECOMMENDATIONS**

- A. The design intent for this project is to line the new 12' curved sidewalk path with various low groundcover & shrub materials placed within and along the FDOT sidewalk easement. These plantings follow the City's initiative (code implemented) for a tiered layered planting buffer that fronts the subject property per approved plans.
- B. Canopy Trees are intended to be maintained at mature height and spread for their specific type / species. Note: No canopy trees are being proposed within the defined / recorded FDOT sidewalk easements, however, trees that are in close proximity (those trees that will ultimately have canopy overhanging these easements) shall be subject to all applicable maintenance objectives herein, including Live Oaks, Strangler Fig, Japanese Blueberry and Royal Palms. Refer to Part I Pruning, for clear sight window and vertical clear zone pruning requirements.
- C. Remove suckering growth from base and clear trunk areas for single and multi-trunked trees on a quarterly basis.
- D. To maintain the intended appearance of all palms, apply the latest palm fertilizer recommended by the University of Florida IFAS Extension per the manufacturer's specifications.
- E. To maintain the intended appearance of all shrubs or turf grass, apply the latest fertilizer recommended by the University of Florida IFAS Extension per the manufacturer's specifications.
- F. Do not remove fronds from self-cleaning palms, unless damaged. Palms with persistent fronds shall only have dead fronds removed, do not remove any green fronds. If it is deemed necessary to prune a palm's fronds, no fronds shall be trimmed above 3 o'clock and 9 o'clock on the horizontal plain.
- G. Shrub horizontal growth shall be maintained to prevent foliage from growing beyond the limits of the planting areas shown on the plan. Maintain a 6" minimum setback from the foliage to the edge of curb, pavement, sidewalk and/or other hardscape improvements. Groundcover horizontal growth shall be maintained are 4" from the edge of curb, pavement, sidewalk and/or other hardscape improvements.
- H. Maintain the vertical heights of shrubs as follows:
  - a. *Philodendron Xanadu*: between 30" and 36", full to ground
  - b. *Jatropha (bush form)*: between 48" and 60"
  - c. *Juniper horizontalis*: between 36" and 48"
  - d. *Indian Hawthorne*: between 24" and 30"
  - e. *Liriope E.G.*: mature height 18"- 24", do not trim.  
Remove blades from overhanging sidewalk only.
  - f. *Sand Cord Grass*: mature height 36"- 48", do not trim.  
Remove dead blades once a year.
- I. Inspect groundcovers and shrubs on a monthly basis for maintaining full to ground coverage.

- J. Evaluate plant material on a monthly basis for pests, diseases, drought stress or general decline. If required, follow the integrated pest management program established by the Agency to ensure healthy plants.
- K. Inspect the irrigation system performance on a monthly basis to ensure the system is providing 100% coverage, does not have sections of low pressure, heads and valves are clean and clear of debris and any damaged irrigation components (i.e., spray nozzles, spray heads, valve boxes, etc.) are repaired or replaced.

Except as modified by this Amendment, all terms and conditions of the Original Agreement and all Amendments thereto shall remain in full force and effect.

#### **LIST OF EXHIBITS**

- Exhibit A - Landscape Maintenance Boundaries
- Exhibit B - Landscape Improvement Plans

**In Witness whereof**, the parties hereto have executed this Amendment effective the day and year written and approved.

**CITY OF COCONUT CREEK**

By: \_\_\_\_\_ Date: \_\_\_\_\_  
Sheila N. Rose, City Manager

Attest:

\_\_\_\_\_  
Joseph J. Kavanagh, City Clerk (SEAL)

Legal Review:

\_\_\_\_\_  
Terrill C. Pyburn, City Attorney

**STATE OF FLORIDA  
DEPARTMENT OF TRANSPORTATION**

By: \_\_\_\_\_ Date: \_\_\_\_\_  
John Krane, P.E., Director of Transportation Development

Attest:

\_\_\_\_\_  
Alia Channel, Executive Secretary (SEAL)

Legal Review:

\_\_\_\_\_  
Francine Steelman, Office of the General Counsel



**SECTION: 86028000**  
**COUNTY: BROWARD**  
**STATE RD: 834**  
**PERMIT: 2024-L-491-00007**

**EXHIBIT A**

**LANDSCAPE MAINTENANCE BOUNDARIES**

**I. ORIGINAL LIMITS OF INCLUSIVE LANDSCAPE MAINTENANCE AGREEMENT FOR STATE ROAD 834 (SAMPLE ROAD):**

M.P. 3.008 (State Road 91) to M.P. 5.030 (West of State Road 7)

**II. LIMITS OF LANDSCAPE IMPROVEMENTS FOR AMENDMENT #9 \*:**

State Road 834 (Sample Road) from M.P. 4.387 to M.P. 4.455 (Coral Tree Circle)

**III. LANDSCAPE IMPROVEMENTS MAINTENANCE RESPONSIBILITIES MAP FOR AMENDMENT #9:**

Please See Attached\*

**\*All other limits of the Original Agreement and Amendments shall apply.**

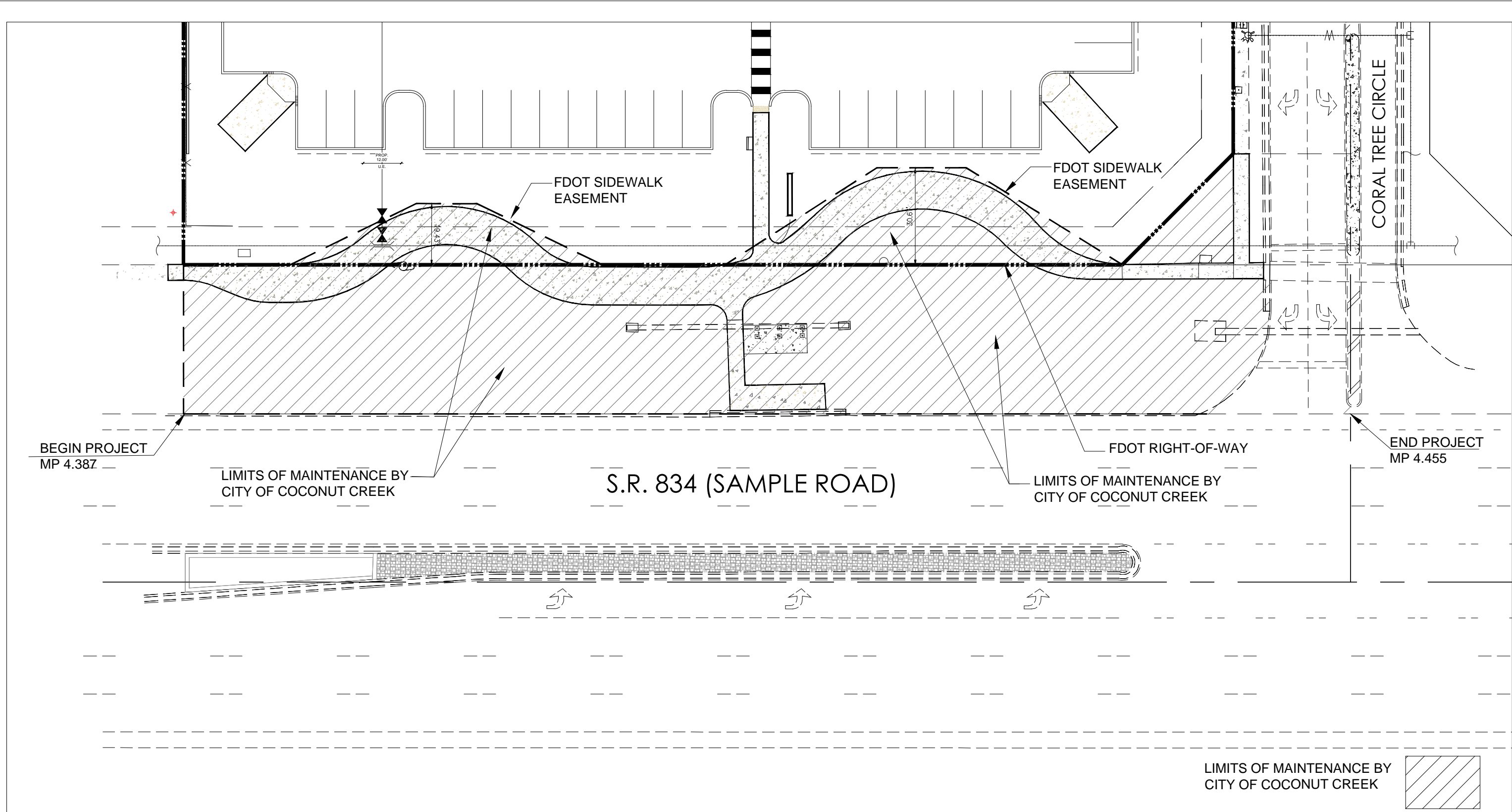

# COCONUT CREEK MAZDA

3757 CORAL TREE CIRCLE  
 COCONUT CREEK, FLORIDA 33073

FDOT - SR 834 & SIDEWALK EASEMENT

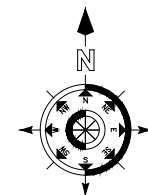

Graphic Scale in Feet

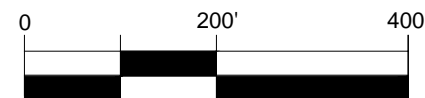

SCALE = 1" = 200'

NOTE: Printed drawing size may have changed from original. Verify scale using Bar Scale above.

LANDSCAPE IMPROVEMENT  
 MAINTENANCE BOUNDARY MAP  
 CITY OF COCONUT CREEK, FLORIDA

**SECTION: 86028000**  
**COUNTY: BROWARD**  
**STATE RD: 834**  
**PERMIT: 2024-L-491-00007**

**EXHIBIT B**

**LANDSCAPE IMPROVEMENT PLANS**

The AGENCY agrees to install the landscape improvements in accordance with the plans and specifications attached hereto and incorporated herein.

**Please see attached plans prepared by:** Lynn Bender, RLA  
LBLA, Inc.

**Date:** May 16, 2024

**Sheets:** Cover, LP1, LP2, LP5, LP8,  
IR-1, IR-2, IR-5, IR-Details

**FDOT GENERAL NOTES**

1. GOVERNING STANDARD PLANS: Florida Department of Transportation, FY 2023-24 Standard Plans for Road and Bridge Construction and applicable Interim Revisions (IR) are available at the following website: <https://www.fl.dot.gov/designstandardplans>

2. GOVERNING STANDARD SPECIFICATIONS: Florida Department of Transportation, FY 2023-24 Standard Specifications for Road and Bridge Construction at the following website: <https://www.fl.dot.gov/programmanagement/implemented/specbooks>

3. Contractor shall repair all damage done to FDOT property during demolition, relocation and/or installation activities at his sole expense.

4. Any plant material substitution within or impacting the FDOT Right of Way whether requested by the Contractor, Owner, Architect or other will need to get approval from the FDOT District Landscape Architect.

5. Ownership of all suitable excavated materials, as determined by the Department, shall remain in the Department until a final acceptance of the permitted project is fulfilled. Excavated materials shall be hauled by the Permittee, at their cost & expense from the site to the FDOT Broward Operations Center or stockpiled in those areas as directed by the Department, including asphalt millings.

**FDOT PLANTING NOTES**

1. For the portion of landscape plant material that will be installed within the FDOT Right of Way, landscape installation shall comply with current applicable FDOT Maintenance Specification 580. Online Reference: <https://www.fl.dot.gov/programmanagement/implemented/specbooks>

2. For the portion of landscape plant material that will be installed within the FDOT Right of Way refer to the FDOT Standard Plans Index 580-001 Landscape Installation. Online Reference: <https://www.fl.dot.gov/programmanagement/implemented/specbooks>

3. Cypress Mulch is not permitted on FDOT right of way. Mulch products to be used are Hardwood Mulch (containing no Cypress products), Recycled Mulch or approved equal, certified by the Mulch and Soil Council (MSC). Submit proof of certification to the FDOT District Operations Permit Landscape Inspector upon inspection.

4. Sodded areas will be in accordance with Standard Plans Index 570-010 and Standard Specifications Sections 162, 570, 981, 982, 983, 987 of the Department's latest edition of Governing Design Standards and Standard Specifications. All disturbed areas will be sodded within one (1) week of installation of said permitted work.

**FDOT IRRIGATION NOTES**

1. The irrigation system shall use the lowest quality water available which adequately and safely meets the water needs of the system. Storm water, reclaim water, or grey water irrigation shall be used whenever possible.

2. FDOT requires 24-hour emergency access to the water source.

3. The contractor shall provide FDOT District Operations Manager with a set of "As-Built" irrigation plans.

**NOTE TO CONTRACTOR:**

LANDSCAPE INSTALLATION METHODS SHALL MEET OR EXCEED FDOT STANDARD PLANS INDEX 580-001 LANDSCAPE INSTALLATION FOR ALL PLANT MATERIAL INSTALLED WITHIN THE FDOT RIGHT OF WAY.

<https://www.fl.dot.gov/programmanagement/implemented/specbooks>

<https://www.fl.dot.gov/programmanagement/implemented/specbooks>

<https://www.fl.dot.gov/programmanagement/implemented/specbooks>

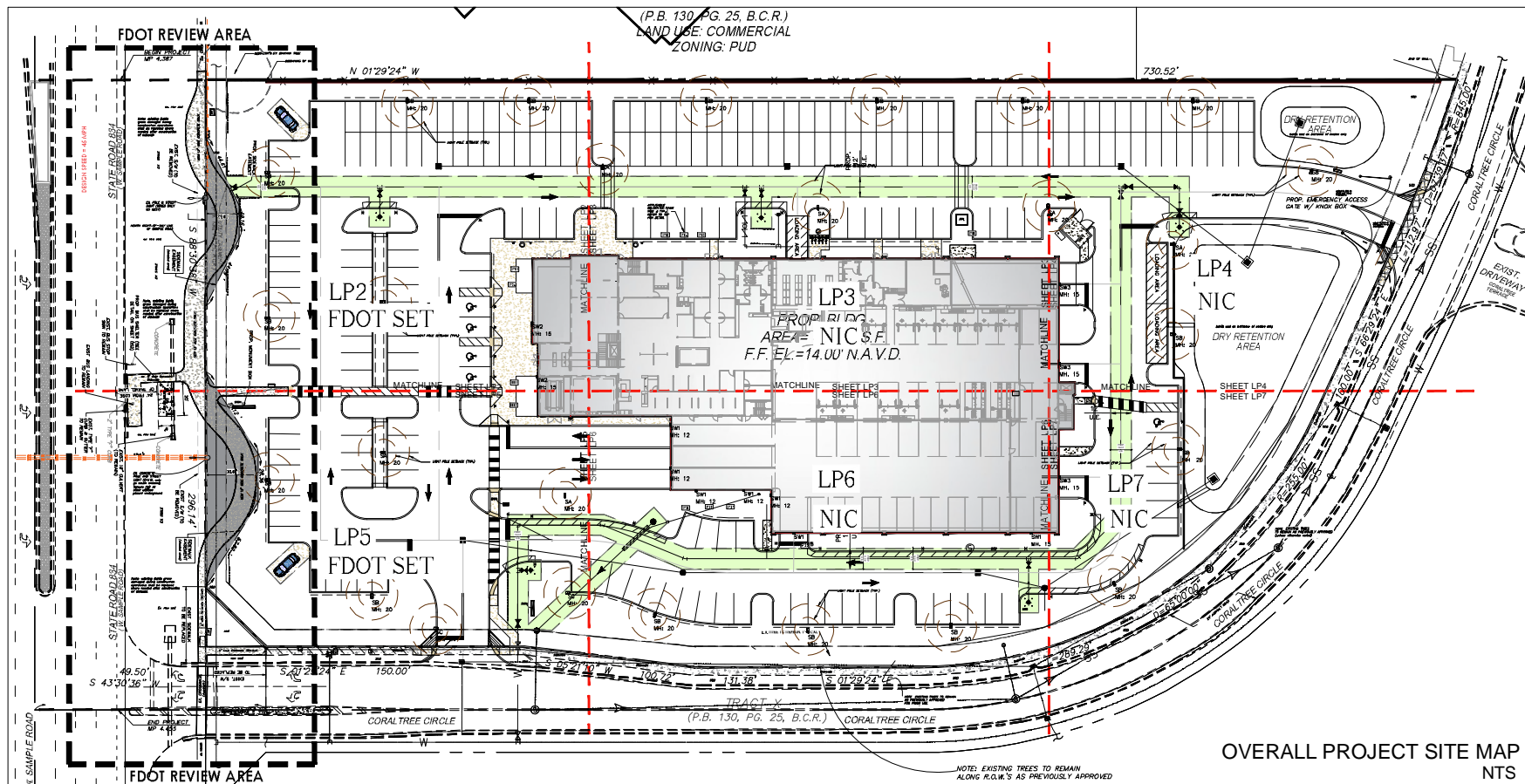

**SHEET INDEX - FDOT PERMIT ONLY**

COVER	
OVERALL LANDSCAPE PLAN	LP1
LANDSCAPE PLAN	LP2
LANDSCAPE PLAN	LP5
LANDSCAPE DETAILS & SPECIFICATIONS	LP8
OVERALL IRRIGATION PLAN	IR-1
IRRIGATION PLAN	IR-2
IRRIGATION DETAILS & SPECIFICATIONS	IR-5
IRRIGATION DETAILS & SPECIFICATIONS	IR-8

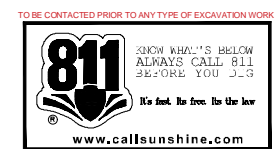

- LIST OF NON-STANDARD FDOT COMPONENTS**
- The following landscape & irrigation items are proposed within the FDOT Sidewalk Easement: (designated & labeled in gray shaded areas along the proposed 12' wide concrete sidewalk)
- shrubs
  - groundcover
  - root barrier
  - irrigation heads & lateral lines

Refer to applicable LP & IR sheets for specific information of each non-standard item.

**NOTE:** Refer to Civil Engineering plans for Hardscape items such as concrete sidewalk.

**NOTE TO CONTRACTOR:**

LANDSCAPE INSTALLATION METHODS SHALL MEET OR EXCEED FDOT STANDARD PLANS INDEX 580-001 LANDSCAPE INSTALLATION FOR ALL PLANT MATERIAL INSTALLED WITHIN THE FDOT RIGHT OF WAY.

<https://www.fl.dot.gov/programmanagement/implemented/specbooks>

<https://www.fl.dot.gov/programmanagement/implemented/specbooks>

<https://www.fl.dot.gov/programmanagement/implemented/specbooks>

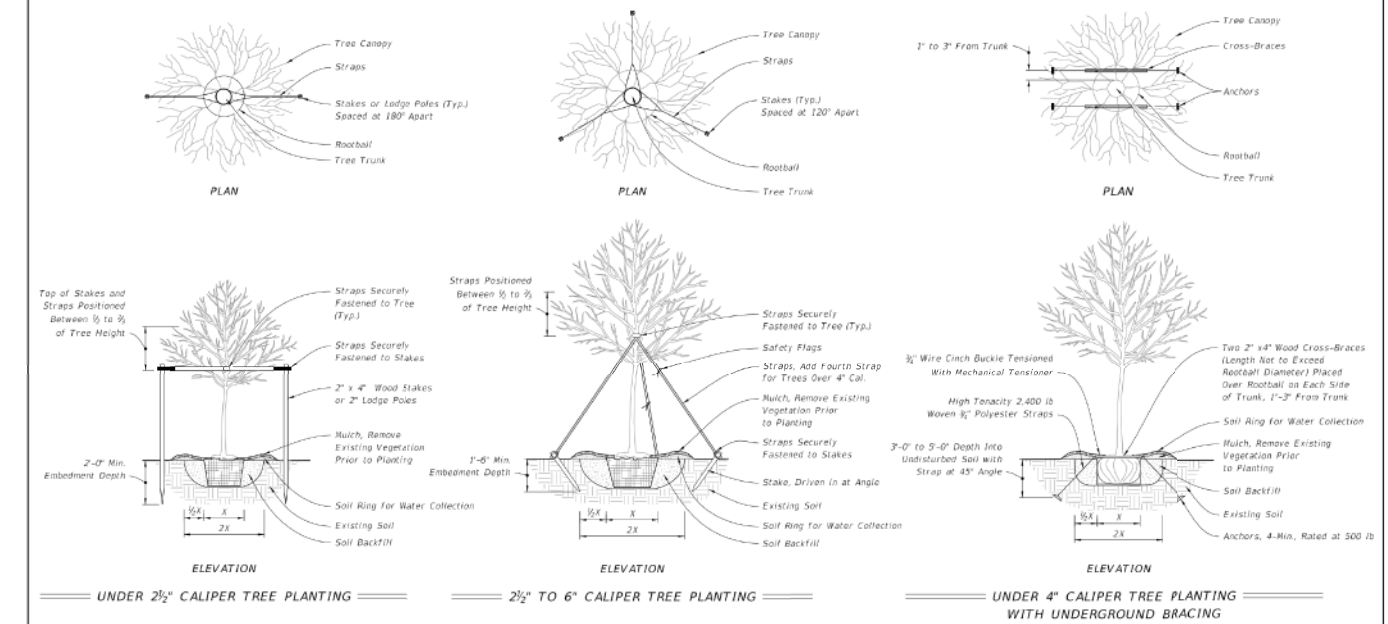

**GENERAL NOTES:**

- Staking guidelines are based on standard horticultural requirements and are provided for plant establishment purposes only. Details are intended to apply when bracing is intended to address safety considerations. When bracing for safety, refer to Designer generated signed and sealed details. These guidelines are not intended to apply when the tree or palm is within falling distance of a roadway, pedestrian or bicycle route, under extreme wind loads, non-standard soil properties, non-standard plant dimensions, or when rootball is anticipated to be greater than 4 feet diameter and planted on 1:3 slope or steeper.
- All dimensions 6\" and less are exaggerated for illustrative purposes only. Dimensions shown for wood materials are nominal. Slopes shown are vertical/horizontal.
- Remove plant containers prior to planting. Remove a minimum of the top 1/3 of burlap, fabric, or wire mesh for plants not grown in containers.
- Allow no more than 1\" of soil to cover the uppermost root on all trees. Set the top of rootball 1\"-2\" above finish grade after setting and set prims to the horizon.
- Backfill with loosened existing soil or as shown in the plans. Remove rocks, sticks, or other deleterious material greater than 2\" in any direction prior to backfilling. Water and tamp to remove air pockets. Contact the Engineer prior to planting if existing soils contain excessive sand, clay, or other material not conducive to proper plant growth.
- Construct soil rings at the outer edge of the planting pit with a height of 2\" and gently sloping sides unless a permanent, subsurface or drip irrigation system is provided. Do not pile soil on top of rootball.
- Construct a 3\" deep layer of mulch placed 2\" off the edge of the trunk flare, around the base of shrub, or solidly around ground cover. Never pile mulch against the tree trunk.
- Install guying with minimum 1\" wide nylon or polypropylene straps with a minimum 600 lb. break strength. Check straps monthly and adjust as required to eliminate girdling of tree. Locate all wood stakes beyond the edge of soil ring in existing soil and embed a minimum of 18\" below finished grade unless otherwise specified. Alternate tree bracing and guying systems specified or approved by the Engineer may be used in lieu of the tree bracing and guying methods detailed in the Index.
- Relocated Trees and Palms: Brace relocated trees and palms in accordance with the Contract Documents. Remove bracing at the conclusion of the contract or as directed by the Engineer. Bracing or straps must not damage or become embedded in the tree bark.
- Use 2\" x 2\" minimum wood stakes unless otherwise shown in the Plans or directed by the Engineer. Use wood meeting #2 Common or better in accordance with the Standard Grading Rules for Southern Pine.
- Drive stakes into existing, undisturbed soil. Localized compaction may be provided to prevent displacement of the stakes for previously disturbed existing soils that do not provide sufficient stability.

LAST REVISION	DESCRIPTION:	FDOT	FY 2022-23	STANDARD PLANS	LANDSCAPE INSTALLATION	INDEX	SHEET
11/01/19						580-001	1 of 2

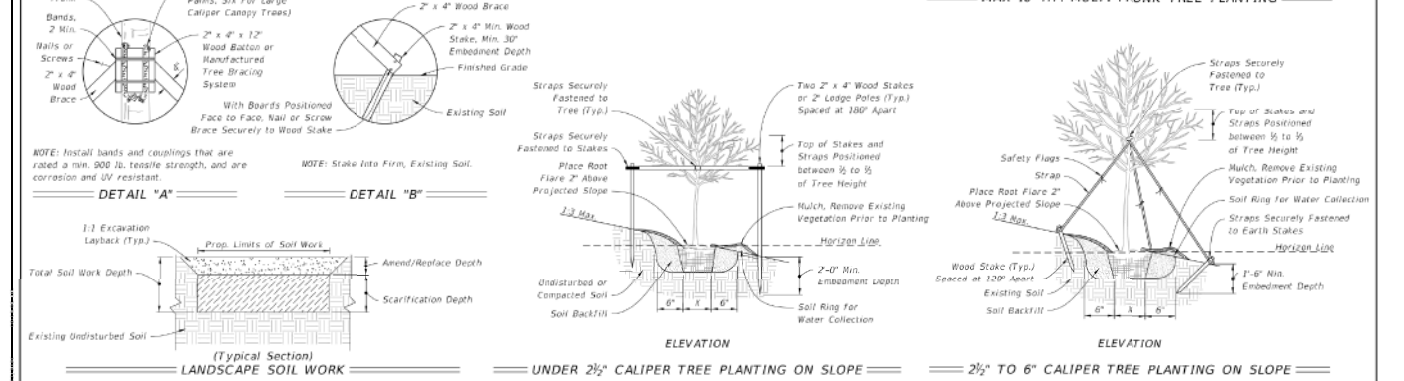
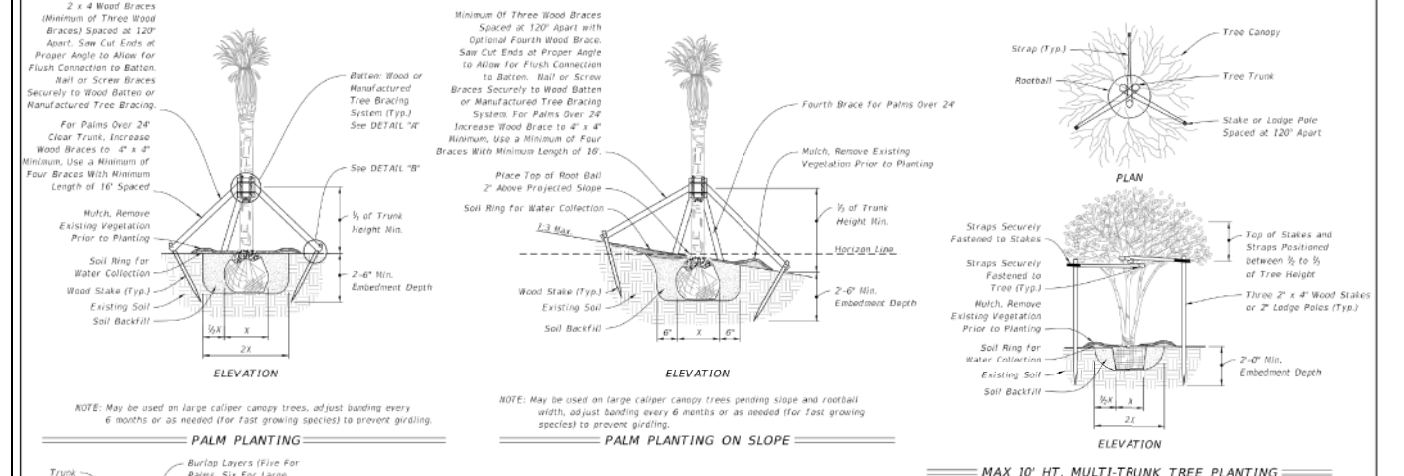

LAST REVISION	DESCRIPTION:	FDOT	FY 2022-23	STANDARD PLANS	LANDSCAPE INSTALLATION	INDEX	SHEET
11/01/19						580-001	2 of 2

REVISION	DATE	
1	FDOT comments (added cover sheet)	4/17/24
2	COA comments	5/16/24

Lynn M Bender  
Digitally signed by Lynn M Bender  
Date: 2024.05.16 19:38:47 -0400

**LBLA, Inc.**  
Landscape Architecture

5610 Adair Way  
Lake Worth, FL 33467  
Phone: 561-644-3237  
LbenderLarch@gmail.com  
FL-LA6666715

ALL DRAWINGS, SPECIFICATIONS AND RELATED DOCUMENTS ARE THE COPYRIGHT PROPERTY OF THE LANDSCAPE ARCHITECT. REPRODUCTION OF DRAWINGS, SPECIFICATIONS AND RELATED DOCUMENTS IN WHOLE OR IN PART WITHOUT THE WRITTEN PERMISSION OF THE LANDSCAPE ARCHITECT IS PROHIBITED.

CONTRACTOR MUST CHECK AND VERIFY ALL DIMENSIONS AND FIELD CONDITIONS AND NOTIFY THE ARCHITECT AND/OR ENGINEER IMMEDIATELY OF ANY DISCREPANCIES.

**COCONUT CREEK MAZDA**  
3757 CORAL TREE CIRCLE  
COCONUT CREEK, FLORIDA 33073

**FDOT - SR 834 & SIDEWALK EASEMENT COVER SHEET & APPLICABLE PERMIT REQUIREMENTS**

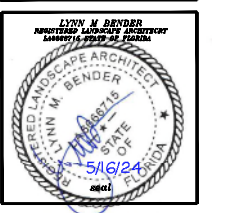

PROJECT NO:	CADD ID:
20-569	MAZDA LP
DRAWN BY:	
LMB	
CHECKED BY:	
LMB	
SCALE:	N/A
DATE:	04-17-2024







STATE ROAD 834  
(W. SAMPLE ROAD)

LP2  
1"=10'-0"

LANDSCAPE PLAN : FOR FDOT S.R. 834 ONLY

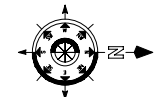

NOTE: REFER TO LP8 FOR COMPLETE OVERALL PLANT SCHEDULE

code-MIT = mitigation  
code-E = existing  
code-T = transplanted

PLANT LEGEND OVERALL

CODE	QTY	BOTANICAL / COMMON NAME
<b>A - SHADE TREE</b>		
AR	4	Acer rubrum Red Maple
AR-E	2	Acer rubrum Red Maple
BS	4	Bursera simaruba Gumbo Limbo
CE	18	Conocarpus erectus Buttonwood
FA-MIT	1	Ficus aurea Strangler Fig
FB-E	1	Ficus benghalensis Indian Banyan
LE-E	13	Quercus laevis Laurel Oak
QV	31	Quercus virginiana Southern Live Oak
QV-MIT	19	Quercus virginiana Southern Live Oak
QV-E	15	Quercus virginiana Southern Live Oak
TA-MIT	6	Taxodium ascendens Pond Cypress
TD	12	Taxodium distichum Bald Cypress
TD-E	3	Taxodium distichum Bald Cypress
<b>B - INTERMEDIATE</b>		
CO10	25	Chrysophyllum oliviforme Saitleaf
CR	6	Ficus rosea Autograph Tree
CD	9	Coccoloba diversifolia Pigeon Plum
CS10	6	Cordia sebestena Orange Geiger Tree
ED	9	Elaeagnus argentea Japanese Blueberry Tree
LS	9	Lagerstroemia speciosa Queen's Cape Myrtle
<b>C - SMALL TREE</b>		
CES	1	Conocarpus erectus 'Sericeus' Silver Buttonwood
EF	13	Eugenia foenicia Spanish Stopper
JAT	9	Jatropha integrifolia Spicy Jatropha
LI	6	Lagerstroemia x Muskogee Cape Myrtle
MF	4	Myrcianthes fragrans Simpson's Stopper
<b>D - PALMS</b>		
PD	2	Phoenix dactylopera 'Medford' Dwarf Palm
PHO-T	1	Phoenix roebelenii Pygmy Date Palm
RE	6	Rapisia exata Florida Royal Palm
SP-MIT	5	Sabal palmetto Cabbage Palmetto
SP	30	Sabal palmetto Cabbage Palmetto
SP-T	5	Sabal palmetto Cabbage Palmetto
VM-T	12	Veitchia merrillii Christmas Palm
<b>SHRUBS</b>		
AEC	23	Aechmea blanchetiana 'Orangeade' Orange Bromeliad
CHR	423	Chrysobalanus icaco 'Red Tip' Red Tip Coccoloba
CLU	253	Clusia guiliera Small Leaf Clusia
CLU6	86	Clusia guiliera Small Leaf Clusia
CON	90	Conocarpus erectus Buttonwood
COR	14	Cordia terminalis 'Auntie Lou' Auntie Lou TI Plant
JA	4	Jatropha integrifolia Spicy Jatropha
MYR	152	Myrcianthes fragrans Simpson's Stopper
PRC	51	Philodendron x Rojo Congo Rojo Congo Philodendron
POD	188	Podocarpus macrophyllus Dwarf Pingala
PDD	60	Podocarpus macrophyllus Dwarf Pingala
PSY	53	Psychotria nervosa Wild Coffee
SER	6	Sesuvia repens Saw Palmetto
THR	80	Thryallis glauca Thryallis
<b>SHRUB AREAS</b>		
BOU	78	Bougainvillea x Raspberry Ice Bougainvillea bush
DIA	205	Disanella tasmanica Flax Lily
FIC	424	Ficus microcarpa Green Island Green Island Ficus
HAM	337	Hamelia patens Firebush
ILX	570	Ilex vomitoria 'Schilling's Dwarf' Dwarf Schilling's Holly Hedge
IKO	347	Izora taiwanensis Dwarf Izora Pestsy Red
JAS	305	Jasminum multiflorum Downey Jasmine
MUH	162	Muhlenbergia capillaris Pink Muhly Grass
NEP	171	Nepenthes exaltata Boston Fern
PHX	92	Philodendron vanderi Xanadu Philodendron
RHA	128	Rhapidolepia indica Alba White Indian Hawthorn
TRI	183	Schefflera arborescens 'Trenette' Schefflera arborescens
SPA	160	Spartina bakeri Sand Cord Grass
DFK	302	Tropaeum dactyloides Dwarf Fakahatchee
ZAM	235	Zamia floridana Ft. Coonata
<b>GROUND COVERS</b>		
ASP	396	Asparagus densiflorus 'Myers' Myers Asparagus Fern
JUN	664	Juniperus horizontalis Creeeping Juniper
LIR	1,071	Liriope muscari 'Evergreen Giant' Evergreen Giant Border Grass
<b>TURF</b>		
SOD-B	8,081 sf	Paspalum notatum Bahia Grass
SOD	33,640 sf	Stenotaphrum secundatum 'Florim' Florim St. Augustine Sod

REVISION	DATE
1	FDOT comments 4/17/24
2	COA comments 5/16/24

Lynn M Bender  
Digitally signed by Lynn M Bender  
Date: 2024.05.16 19:44:42 -0400

**LBLA, Inc.**  
Landscape Architecture  
5610 Adair Way  
Lake Worth, FL 33467  
Phone: 561-644-3237  
LbenderLarch@gmail.com  
FL-LA6666715

ALL DRAWINGS, SPECIFICATIONS AND RELATED DOCUMENTS ARE THE PROPERTY OF THE LANDSCAPE ARCHITECT. REPRODUCTION OF DRAWINGS, SPECIFICATIONS AND RELATED DOCUMENTS IN PART OR WHOLE IS PROHIBITED WITHOUT THE LANDSCAPE ARCHITECT'S WRITTEN PERMISSION.

CONTRACTOR MUST CHECK AND VERIFY ALL DIMENSIONS AND FIELD CONDITIONS AND NOTIFY L.A. ARCHITECT AND/OR ENGINEER IMMEDIATELY OF ANY DISCREPANCIES.

COCONUT CREEK MAZDA  
3757 CORAL TREE CIRCLE  
COCONUT CREEK, FLORIDA 33073  
FDOT - SR 834 & SIDEWALK EASEMENT  
LANDSCAPE PLAN

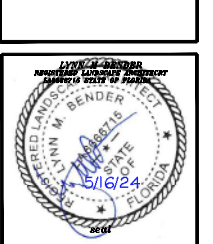

PROJECT NO: 20-569  
DRAWN BY: MAZDA LP  
CHECKED BY: LMB  
SCALE: 1" = 10'-0"  
DATE: 04-20-2021

SHEET: LP2  
2 OF 8 SHEETS

FDOT LANDSCAPE PERMIT # 2024-L-491-00007

FDOT SET : COVER, LP1, LP2, LP5 & LP8 ONLY

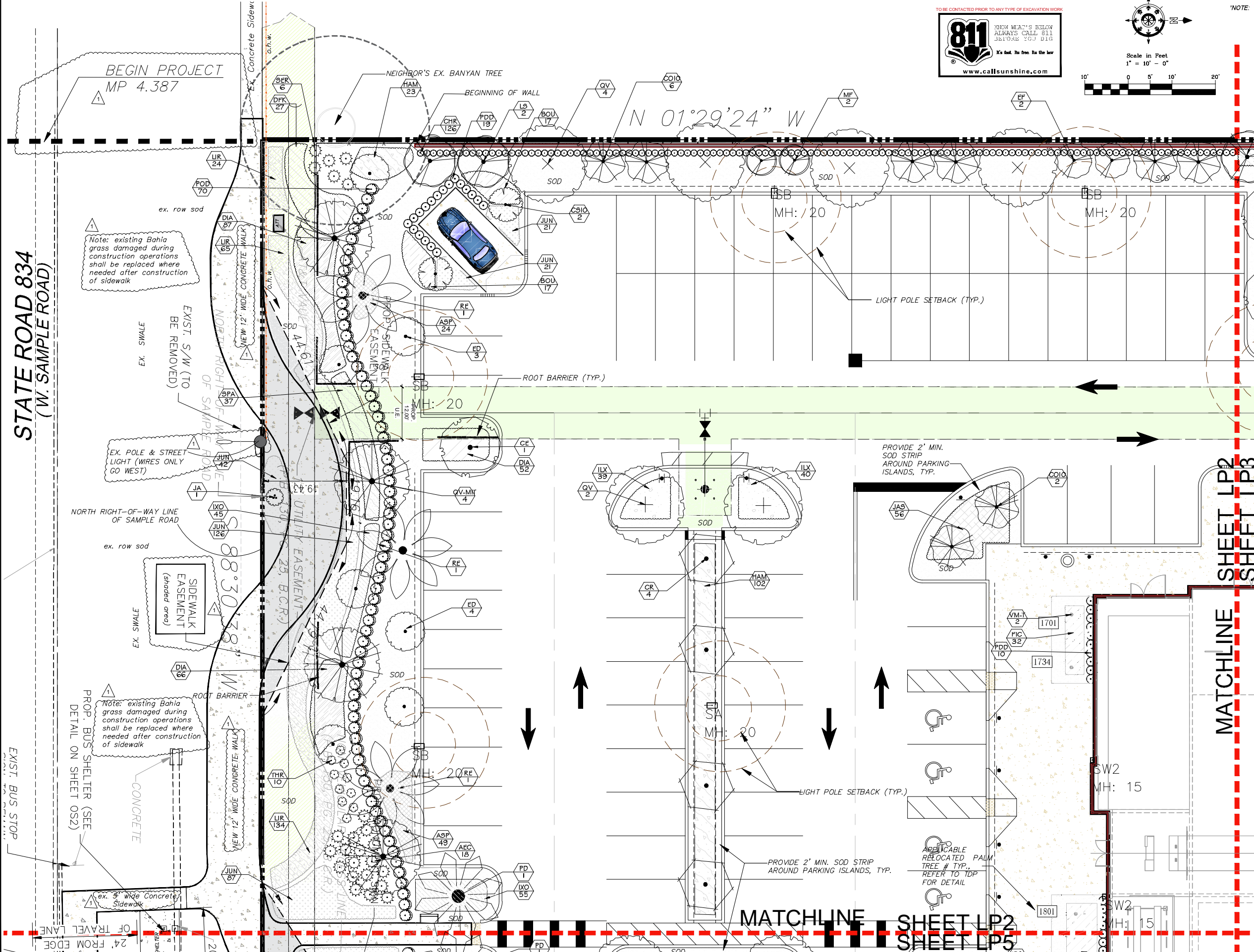

NOTE: ALL SOD TO BE 1" ABOVE SLAB. EXCEPT FOR BOTTOM OF DRY RETENTION POND WHICH SHALL BE 5" ABOVE FIN. QUANTITIES SHALL BE DETERMINED AT TIME OF PERFORMING & BOUND BY THE PROJECT RECORDS.



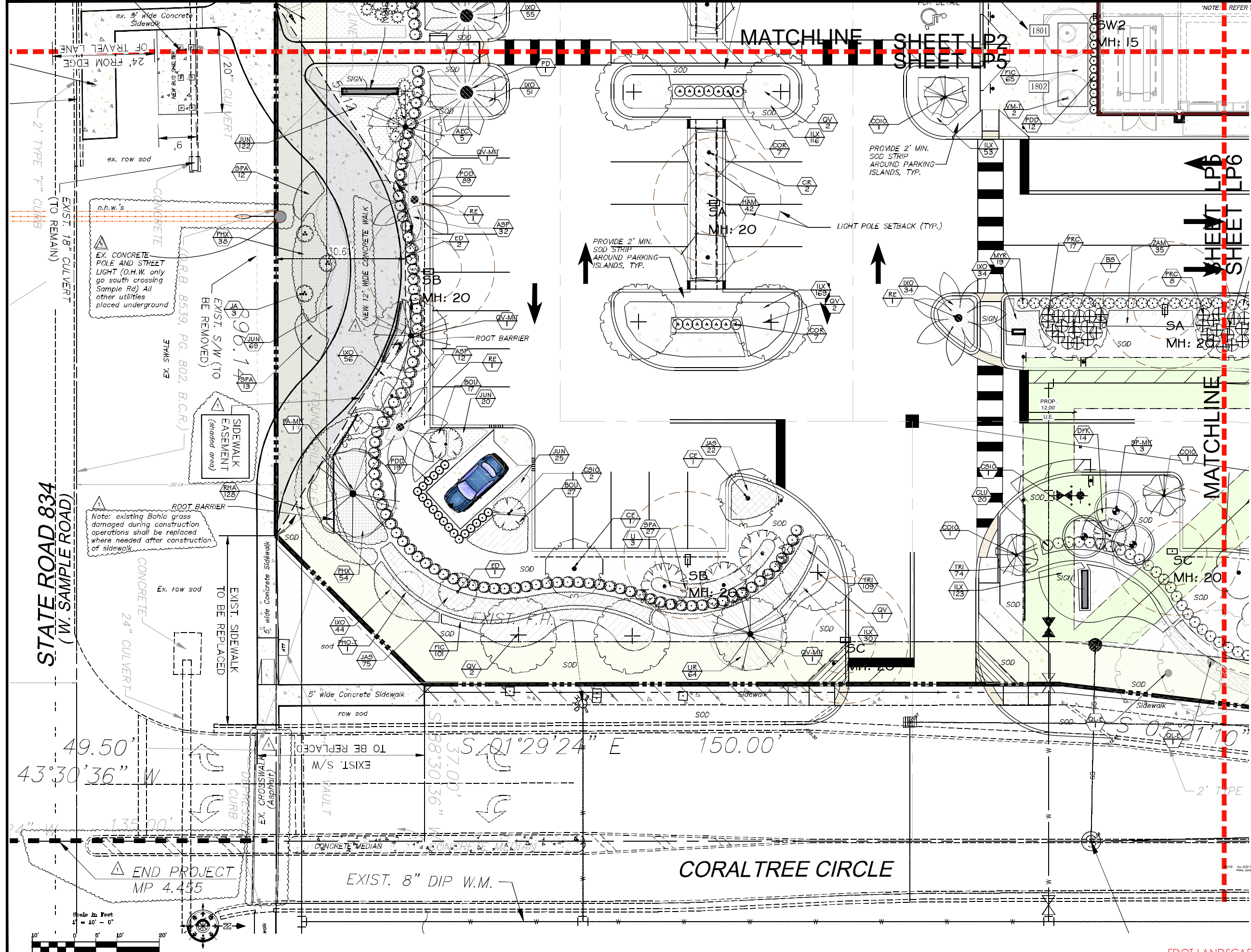

NOTE: REFER TO LP8 FOR COMPLETE OVERALL PLANT SCHEDULE

code-MIT = mitigation  
code-E = existing  
code-T = transplanted

**PLANT LEGEND OVERALL**

CODE	QTY	BOTANICAL / COMMON NAME
<b>A - SHADE TREE</b>		
AR	4	Acer rubrum Red Maple
AR-E	2	Acer rubrum Red Maple
BS	4	Bumelia americana Gumbo Limbo
CE	18	Conocarpus erectus Buttonwood
FA-MIT	1	Ficus aurea Strangler Fig
FB-E	1	Ficus benghalensis Indian Banyan
QLE	13	Quercus laevis Live Oak
QV	31	Quercus virginiana Southern Live Oak
QV-MIT	19	Quercus virginiana Southern Live Oak
QV-E	15	Quercus virginiana Southern Live Oak
TA-MIT	8	Taxodium ascendens Pond Cypress
TD	12	Taxodium distichum Bald Cypress
TD-E	3	Taxodium distichum Bald Cypress
<b>B - INTERMEDIATE</b>		
CO	25	Chrysophyllum oliviforme Spanish Laurel
CR	6	Clusia rosea Allspice Tree
CD	9	Cordia alliodora Pigeon Plum
CS	6	Cordia sebestena Orange Ginger Tree
ED	9	Elaeocarpus decipiens Japanese Blueberry Tree
LS	9	Lagerstroemia speciosa Queen's Cape Myrtle
<b>C - SMALL TREE</b>		
CES	1	Conocarpus erectus Sericeus Silver Buttonwood
EF	13	Eugenia foetida Spanish Shupper
JAT	9	Jatropha integrirama Spicy Jatropha
LI	6	Lagotis linearis Muskogee Creeper Myrtle
MF	4	Myrciophora fragrans Simpson's Stopper
<b>D - PALMS</b>		
PD	2	Phoenix dactylopera Medjool Date Palm
PHO-T	1	Phoenix roebelenii Pygmy Date Palm
RE	6	Roystonea elata Florida Royal Palm
SP-MIT	5	Sabal palmetto Cabbage Palmetto
SP	30	Sabal palmetto Cabbage Palmetto
SP-T	5	Sabal palmetto Cabbage Palmetto
VM-T	12	Washingtonia robusta Christmas Palm
<b>SHRUBS</b>		
AEC	23	Asclepias tuberosa Orangeade Butterfly
CHR	423	Chrysobalanus icaco Red Tip Red Tip Coccoloba
CLU	253	Clusia guiterria Small Leaf Clusia
CLU6	86	Clusia guiterria Small Leaf Clusia
ODN	90	Conocarpus erectus Buttonwood
COR	14	Cordyline terminalis Auntee Lou
JA	4	Jatropha integrirama Spicy Jatropha
MYR	152	Myrciophora fragrans Simpson's Stopper
PRC	51	Philodendron x Rigo Longo
POD	188	Podocarpus macrophyllus Dwarf Podocarpus
PDD	60	Podocarpus macrophyllus Dwarf Podocarpus
PSY	53	Psychotria nervosa Wild Coffee
SER	6	Senecio repens Sea Hibiscus
THR	80	Thryallis glauca Thryallis
<b>SHRUB AREAS</b>		
BOU	78	Bougainvillea x Raspberry Ice
DIA	205	Dioscorea sp. Florida Arrowroot
FIC	424	Ficus microcarpa Green Island
HAM	337	Hamelia patens Scarlet Bush
ILK	570	Impatiens schlingens Dwarf Schlingens Holly Hedge
IXO	347	IXORA sp. Dwarf Ixora
JAS	305	Jasminum multiflorum Downy Jasmine
MUH	162	Muhlenbergia capillaris Pink Muhly Grass
NEP	171	Nepenthes exaltata Boston Fern
PHX	92	Philodendron xanadu Florida Philodendron
RHA	128	Rhipidophora indica Alba White Indian Harefoot
TRI	183	Triplaris hirsuta Florida Triplaris
SPA	160	Sparganium angustifolium Sand Cord Grass
DFK	302	Triplaris hirsuta Florida Triplaris
ZAM	235	Zamia floridana Florida Cycad
<b>GROUND COVERS</b>		
ASP	396	Asparagus densiflorus Myers
JUN	664	Juniperus horizontalis Creeping Juniper
LIR	1,071	Liriodendron muscari Evergreen Giant
<b>TURF</b>		
SOD-B	8,081 sf	Paspalum notatum Bahua Grass
SOD	33,640 sf	Stenotaphrum secundatum Floristam

REVISION	DATE
1	FDOT comments 4/17/24
2	COA comments 5/16/24

Lynn M Bender  
Digitally signed by Lynn M Bender  
Date: 2024.05.16 19:45:02 -0400

**LBLA, Inc.**  
Landscape Architecture  
5610 Adair Way  
Lake Worth, FL 33467  
Phone: 561-644-3367  
lbender.larch@gmail.com  
FL-LA6666715

ALL DRAWINGS, SPECIFICATIONS AND RELATED DOCUMENTS ARE THE PROPERTY OF LBLA, INC. ANY REPRODUCTION OF DRAWINGS, SPECIFICATIONS AND RELATED DOCUMENTS IN PART OR WHOLE IS PROHIBITED WITHOUT THE WRITTEN PERMISSION OF LBLA, INC.

**COCONUT CREEK MAZDA**  
3757 CORAL TREE CIRCLE  
COCONUT CREEK, FLORIDA 33073  
FDOT - SR 834 & SIDEWALK EASEMENT  
LANDSCAPE PLAN



PROJECT NO: 20-569  
DRAWN BY: MAZDA LP  
CHECKED BY: LMB  
SCALE: 1" = 10'-0"  
DATE: 04-20-2021

SHEET: **LP5**  
5 OF 8 SHEETS









REVISION	DATE
1	FDOT comments 4/17/24
2	COA comments 5/16/24

**Lynn M Bender**  
 Digitally signed by Lynn M Bender  
 Date: 2024.05.16 17:45:38 -0500  
 174538.51907

**LBLA, Inc.**  
 Landscape Architecture  
 5610 Adair Way  
 Lake Worth, FL 33467  
 Phone: 561-644-3237  
 lbenderlarch@gmail.com  
 FL-LA666715

ALL DRAWINGS, SPECIFICATIONS AND RELATED DOCUMENTS ARE THE PROPERTY OF LBLA, INC. ANY REPRODUCTION OR TRANSMISSION OF THESE DRAWINGS, SPECIFICATIONS AND RELATED DOCUMENTS IN ANY FORM OR BY ANY MEANS WITHOUT THE WRITTEN PERMISSION OF LBLA, INC. IS STRICTLY PROHIBITED.

CONTRACTOR MUST CHECK AND VERIFY ALL DIMENSIONS AND FIELD CONDITIONS AND NOTIFY LBLA ARCHITECT & ENGINEER IMMEDIATELY OF ANY DISCREPANCIES.

**COCONUT CREEK MAZDA**  
 3757 CORAL TREE CIRCLE  
 COCONUT CREEK, FLORIDA 33073

**FDOT - SR 834 & SIDEWALK EASEMENT  
 OVERALL IRRIGATION PLAN**

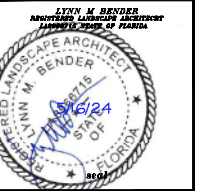

PROJECT NO.	COA D.D.
20-569	MAZDA LP
DRAWN BY:	LMB
CHECKED BY:	LMB
SCALE:	1" = 30'-0"
DATE:	08-04-2021

SHEET:  
**IR-1**  
 1 OF 8 SHEETS

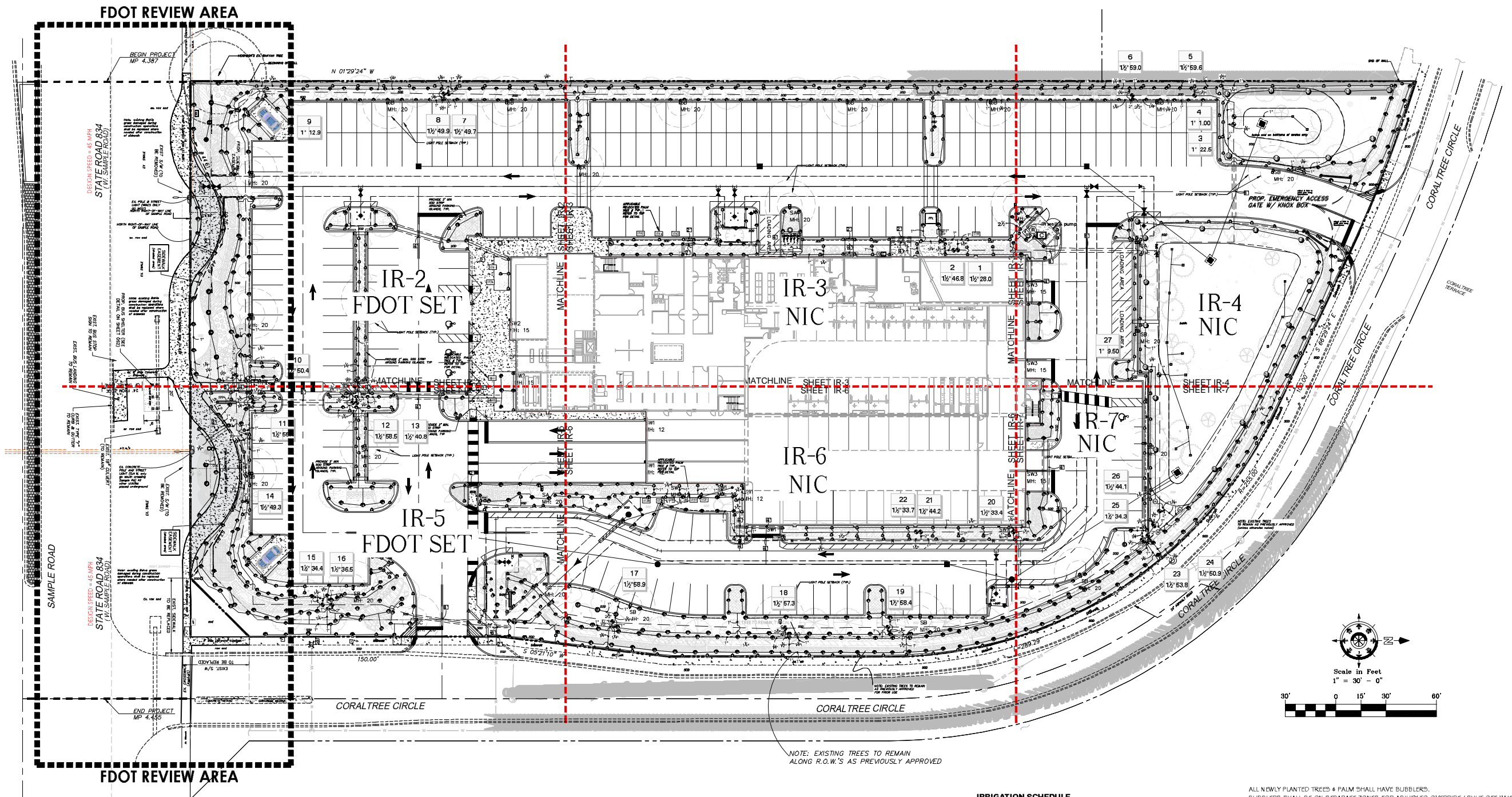

**NOTE TO CONTRACTOR:**  
 THE FOLLOWING IRRIGATION INSPECTIONS ARE REQUIRED BY CITY:

- ROUGH
- SLEEVES
- MAINLINE PRESSURE TEST
- FINAL

**IRRIGATION SCHEDULE**

SYMBOL	MANUFACTURER/MODEL	QTY	ARC	PSI	RADIUS
⊙	Hunter PROS-04 5' strip spray	35	LCS	30	5x15'
⊙	Hunter PROS-04 5' strip spray	37	RCS	30	5x15'
⊙	Hunter PROS-04 5' strip spray	168	SST	30	5x30'
⊙	Hunter PROS-04 8' radius	179	180	30	8'
⊙	Hunter PROS-04 8' radius	21	90	30	8'
⊙	Hunter PROS-04 10' radius	2	360	30	10'
⊙	Hunter PROS-04 10' radius	34	180	30	10'
⊙	Hunter PROS-04 10' radius	23	90	30	10'
⊙	Hunter PROS-04 12' radius	2	360	30	12'
⊙	Hunter PROS-04 12' radius	42	180	30	12'
⊙	Hunter PROS-04 12' radius	3	90	30	12'
⊙	Hunter PROS-04 15' radius	19	180	30	15'
⊙	Hunter PROS-04 15' radius	8	90	30	15'
⊙	Hunter PROS-12 5' strip spray	30	LCS	30	5x15'
⊙	Hunter PROS-12 5' strip spray	30	RCS	30	5x15'
⊙	Hunter PROS-12 5' strip spray	117	SST	30	5x30'
⊙	Hunter PROS-12 8' radius	80	180	30	8'
⊙	Hunter PROS-12 8' radius	54	90	30	8'
⊙	Hunter PROS-12 10' radius	2	360	30	10'
⊙	Hunter PROS-12 10' radius	124	180	30	10'
⊙	Hunter PROS-12 10' radius	23	90	30	10'
⊙	Hunter PROS-12 12' radius	6	360	30	12'
⊙	Hunter PROS-12 12' radius	52	180	30	12'
⊙	Hunter PROS-12 12' radius	24	90	30	12'
⊙	Hunter PROS-12 15' radius	1	360	30	15'
⊙	Hunter PROS-12 15' radius	38	180	30	15'
⊙	Hunter PROS-12 15' radius	15	90	30	15'
⊙	Hunter PCB 50	21	360	30	3'

TOTAL NO. OF HEADS: 1,192

ALL NEWLY PLANTED TREES & PALM SHALL HAVE BUBBLERS. BUBBLERS SHALL BE ON SEPARATE ZONES FOR ABILITY TO OVERRIDE / SHUT OFF WHEN NOT NEEDED.

SYMBOL	MANUFACTURER/MODEL	QTY	PSI	RADIUS
⊙	Hunter PGP-ADJ-B	7	45	31'
⊙	Hunter PGP-ADJ-B	17	45	38'
⊙	Hunter PGP-ADJ-LA	3	40	24'

SYMBOL	MANUFACTURER/MODEL	QTY
⊙	Hunter PGM-1010 1"	4
⊙	Hunter PGM-151 Glade 1-1/2"	23
⊙	Misto-Noxia 514TX 2 1/2"	3
⊙	Hunter SC-8000-PL	1
⊙	Hunter RAIN-CLK	1
⊙	Pump 5 HP - SURFACE MOUNT 4" WELL - 120 GPM	1

SYMBOL	DESCRIPTION	QTY
—	Irrigation Lateral Line: PVC Class 200 SDR 21 1"	12,024.1'
—	Irrigation Lateral Line: PVC Class 200 SDR 21 1 1/4"	1,386.1'
—	Irrigation Lateral Line: PVC Class 200 SDR 21 1 1/2"	301.21'
—	Irrigation Lateral Line: PVC Class 200 SDR 21 2"	82.71'
—	Irrigation Lateral Line: PVC Class 200 SDR 21 2 1/2"	38.81'
—	Irrigation Mainline: PVC Class 200 SDR 21 2 1/2"	2,098.1'
---	Pipe Sleeve: PVC Schedule 40 2"	122.51'
---	Pipe Sleeve: PVC Schedule 40 4"	217.71'
---	Pipe Sleeve: PVC Schedule 40 6"	183.51'



IRRIGATION SYSTEM SHALL BE RUST-FREE. CONTRACTOR SHALL COORDINATE WITH OWNER FOR INSTALLATION OF A RUST INHIBITOR SYSTEM IF APPLICABLE TO THIS SITE. OWNERS TO SECURE A COMPANY TO PROVIDE ON-GOING SERVICES TO PROPERLY MAINTAIN THE RUST INHIBITOR SYSTEM.

TO BE CONTACTED PRIOR TO ANY TYPE OF EXCAVATION WORK

**IR-1**  
 1" = 30'-0"  
**OVERALL IRRIGATION PLAN - KEY**

FDOT LANDSCAPE PERMIT # 2024-L-491-00007  
 FDOT SET : IR-1, IR-2, IR-5 & IR-8 ONLY



REVISION	DATE
1	FDOT comments 4/17/24
2	COA comments 5/16/24

Lynn M Bender  
 Designer  
 LMA  
 2024.05.16  
 19:45:56  
 -0400

**LBLA, Inc.**  
 Landscape Architecture  
 5610 Adair Way  
 Lake Worth, FL 33467  
 Phone: 561-644-3237  
 lbenderlarch@gmail.com  
 FL-LA666715

ALL DRAWINGS, SPECIFICATIONS AND RELATED DOCUMENTS ARE THE COPYRIGHT PROPERTY OF THE LANDSCAPE ARCHITECT. MUST BE RETURNED UPON REQUEST. REPRODUCTION OF DRAWINGS, SPECIFICATIONS AND RELATED DOCUMENTS IN PART OR WHOLE IS PROHIBITED WITHOUT THE LANDSCAPE ARCHITECT'S WRITTEN PERMISSION.  
 CONTRACTOR MUST CHECK AND VERIFY ALL DIMENSIONS AND FIELD CONDITIONS AND NOTIFY LAND ARCHITECT AND ENGINEER IMMEDIATELY OF ANY DISCREPANCIES.

**COCONUT CREEK MAZDA**  
 3757 CORAL TREE CIRCLE  
 COCONUT CREEK, FLORIDA 33073  
**FDOT - SR 834 & SIDEWALK EASEMENT**  
 IRRIGATION PLAN

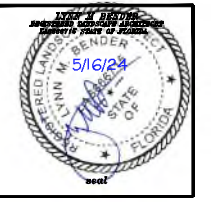

PROJECT NO:	20-569	CADD ID:	MAZDA LP
DRAWN BY:	LMB	CHECKED BY:	LMB
SCALE:	1" = 10'-0"		
DATE:	08-04-2021		

SHEET:  
**IR-2**  
 2 OF 8 SHEETS

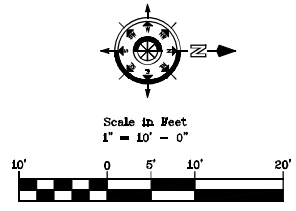
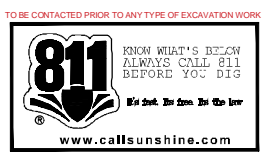
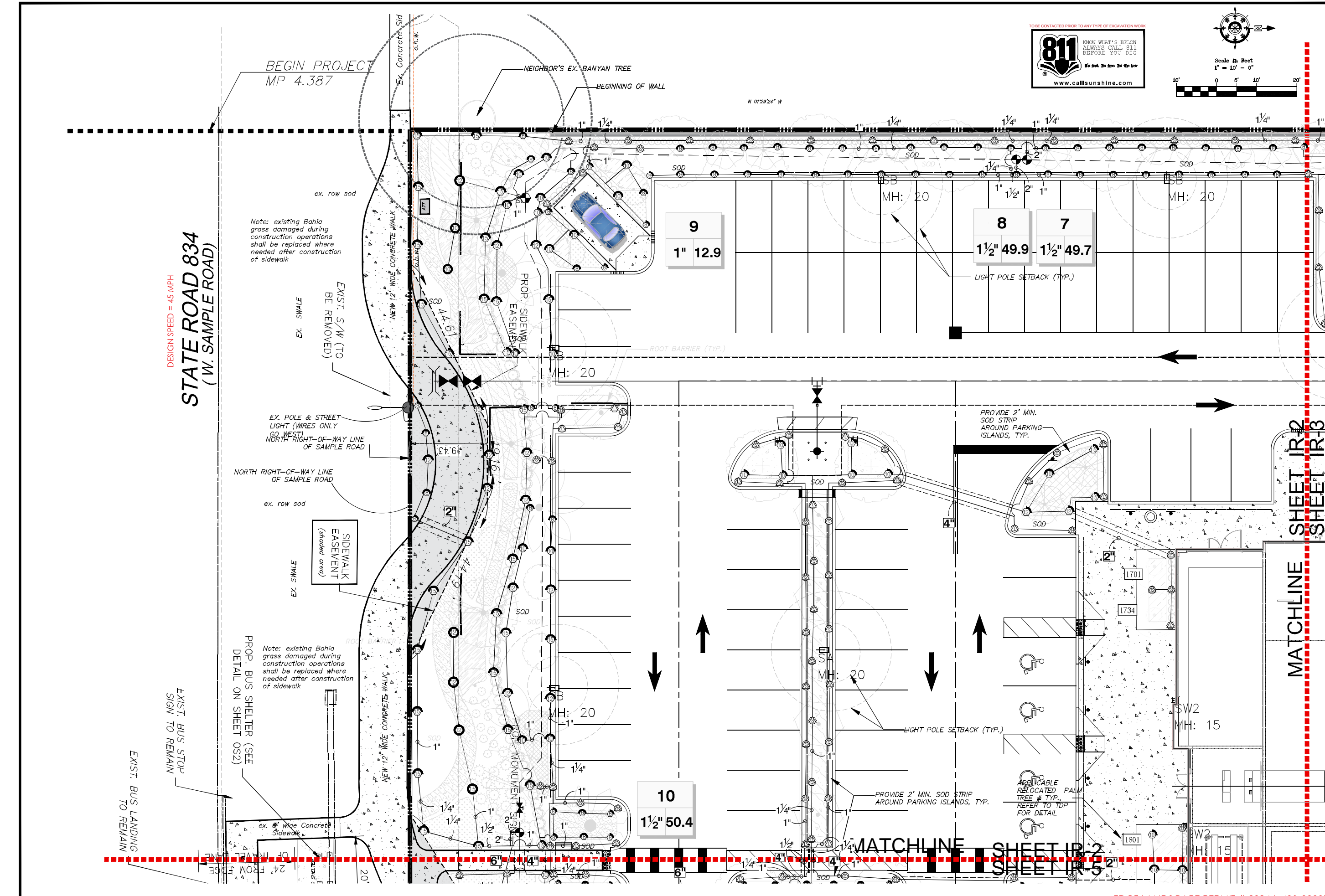

REVISION	DATE
1	FDOT comments 4/17/24
2	COA comments 5/16/24

Lynn M Bender  
 Digitally signed by Lynn M Bender  
 Date: 2024.05.16 19:46:17 -0400

**LBLA, Inc.**  
 Landscape Architecture  
 5610 Adair Way  
 Lake Worth, FL 33467  
 Phone: 561-644-3237  
 LbenderLarch@gmail.com  
 FL-LA6666715

ALL DRAWINGS, SPECIFICATIONS AND RELATED DOCUMENTS ARE THE COPYRIGHT PROPERTY OF THE LANDSCAPE ARCHITECT AND MUST BE RETURNED UPON REQUEST. REPRODUCTION OF DRAWINGS, SPECIFICATIONS AND RELATED DOCUMENTS IN PART OR WHOLE IS FORBIDDEN WITHOUT THE LANDSCAPE ARCHITECT'S WRITTEN PERMISSION.  
 CONTRACTOR MUST CHECK AND VERIFY ALL DIMENSIONS AND FIELD CONDITIONS AND NOTIFY LA, ARCHITECT AND/OR ENGINEER IMMEDIATELY OF ANY DISCREPANCIES.

**COCONUT CREEK MAZDA**  
 3757 CORAL TREE CIRCLE  
 COCONUT CREEK, FLORIDA 33073  
**FDOT - SR 834 & SIDEWALK EASEMENT IRRIGATION PLAN**



PROJECT NO:	20-569	CADD I.D.:	MAZDA LP
DRAWN BY:	LMB	CHECKED BY:	LMB
SCALE:	1" = 10'-0"	DATE:	08-04-2021

SHEET:  
**IR-5**  
 5 OF 8 SHEETS

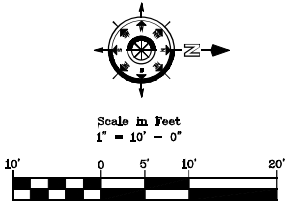
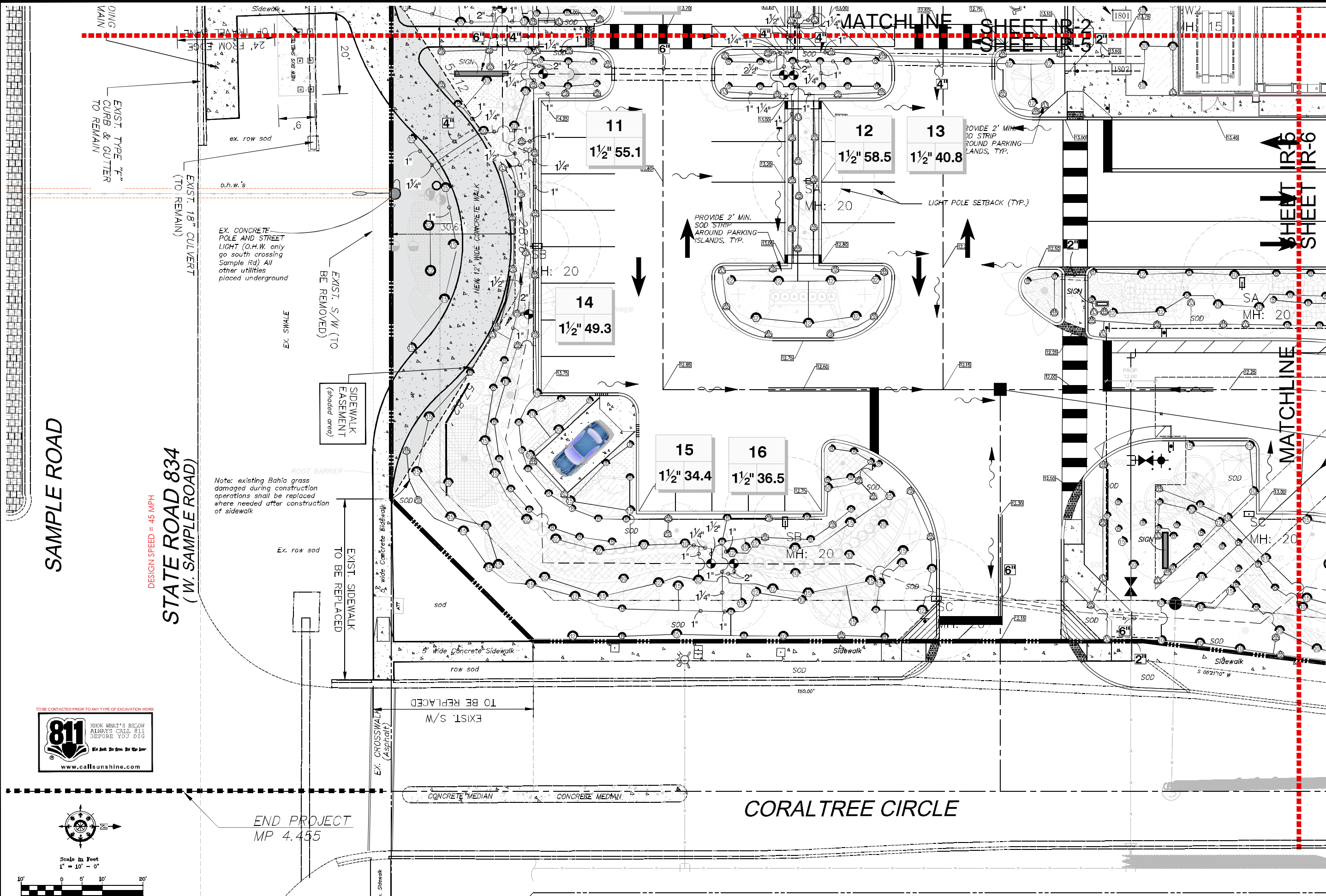

IR-5 IRRIGATION PLAN

FDOT LANDSCAPE PERMIT # 2024-L-491-00007  
 FDOT SET : IR-1, IR-2, IR-5 & IR-8 ONLY



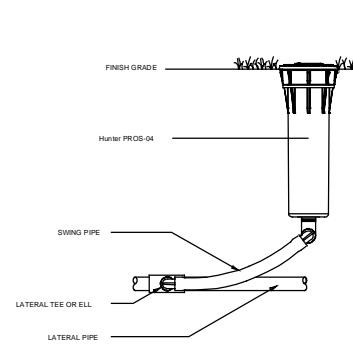

POP-UP SPRAY SPRINKLER

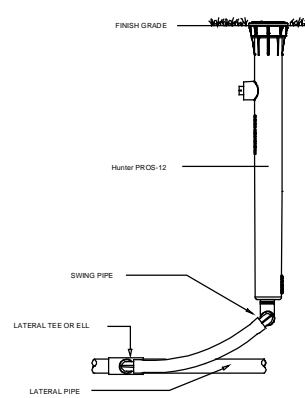

POP-UP SPRAY SPRINKLER

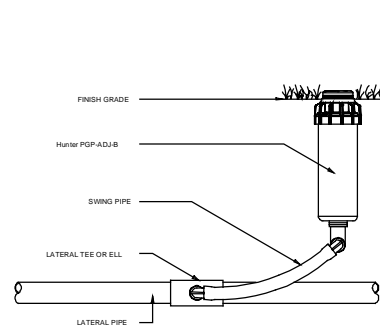

ROTOR

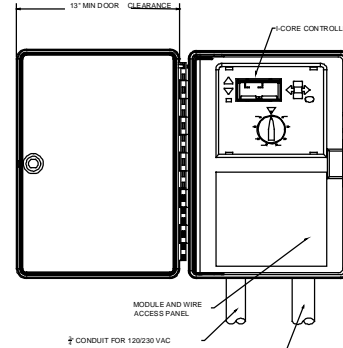

HUNTER I-CORE CONTROLLER

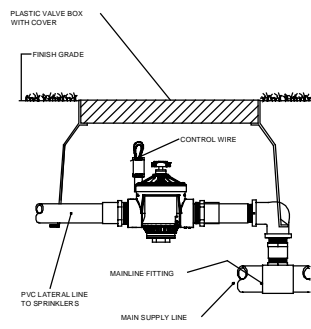

REMOTE CONTROL VALVE

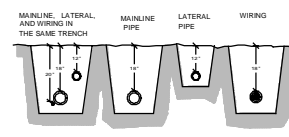

PIPE AND WIRE TRENCH

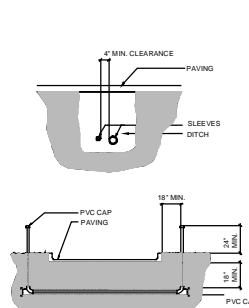
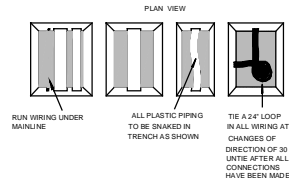

IRRIGATION SLEEVING

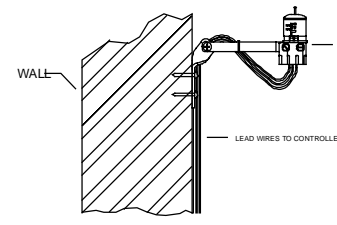

HUNTER RAIN-CLICK RAIN SENSOR



## CRITICAL ANALYSIS

Generated:

Pump 5 HP - SURFACE MOUNT  
Water Source Information: 4\"/>

FLOW AVAILABLE  
Pump:  
Flow Available: 120.00 gpm

PRESSURE AVAILABLE  
Static Pressure at Pump: 70.00 PSI  
Elevation Change: 5.00 ft  
Service Line Size: 3"  
Length of Service Line: 20 ft  
Pressure Available: 68.00 psi

DESIGN ANALYSIS  
Maximum Station Flow: 59.56 gpm  
Flow Available at Pump: 120.00 gpm  
Residual Flow Available: 60.44 gpm

Pressure Req. at Critical Station: 52.92 psi  
Loss for Fittings: 0.10 psi  
Loss for Main Line: 1.02 psi  
Loss for Pump to Valve Elevation: 0.00 psi  
Loss for Backflow: 0.00 psi  
Loss for Pump: 1.55 psi  
Critical Station Pressure at Pump: 55.59 psi  
Pressure Available: 68.00 psi  
Residual Pressure Available: 12.41 psi

**NOTE TO CONTRACTOR:**  
THE FOLLOWING IRRIGATION INSPECTIONS ARE REQUIRED BY CITY:  
- ROUGH  
- SLEEVES  
- MAINLINE PRESSURE TEST  
- FINAL

IRRIGATION SYSTEM SHALL BE RUST-FREE. CONTRACTOR SHALL COORDINATE WITH OWNER FOR INSTALLATION OF A RUST INHIBITOR SYSTEM IF APPLICABLE TO THIS SITE. OWNERS TO SECURE A COMPANY TO PROVIDE ON-GOING SERVICES TO PROPERLY MAINTAIN THE RUST INHIBITOR SYSTEM.

## VALVE SCHEDULE

NUMBER	MODEL	SIZE	TYPE	GPM	HEADS	PIPE	DESIGN PSI	FRICTION LOSS	VALVE LOSS	PSI	PSI @ POC	PRECIP
1	Hunter PGV-151 Globe	1-1/2"	Turf Spray	28.01	37	470.0	30	4.02	3	37.02	37.86	1.45 in/h
2	Hunter PGV-151 Globe	1-1/2"	Shrub Spray	42.31	71	656.2	30	3.51	3.23	36.74	38.46	1.62 in/h
3	Hunter PGV-101G	1"	Turf Rotor	22.50	9	232.4	45	1.17	4	50.17	50.96	0.77 in/h
4	Hunter PGV-101G	1"	Bubbler	1.00	2	46.6	30	0.01	1.1	31.11	31.51	1.7 in/h
5	Hunter PGV-151 Globe	1-1/2"	Shrub Spray	59.56	54	666.3	30	3.34	4.96	38.3	42.95	1.56 in/h
6	Hunter PGV-151 Globe	1-1/2"	Turf Spray	58.97	101	936.5	30	3.74	4.9	38.63	43.39	1.34 in/h
7	Hunter PGV-151 Globe	1-1/2"	Shrub Spray	49.72	46	575.4	30	3.02	3.97	37.0	41.19	1.33 in/h
8	Hunter PGV-151 Globe	1-1/2"	Turf Spray	49.85	81	732.6	30	3.22	3.99	37.21	41.42	1.39 in/h
9	Hunter PGV-101G	1"	Shrub Spray	12.90	8	92.3	30	0.21	1.73	31.93	32.52	1.03 in/h
10	Hunter PGV-151 Globe	1-1/2"	Shrub Spray	50.44	39	457.6	30	2.31	4.04	36.35	40.54	1.56 in/h
11	Hunter PGV-151 Globe	1-1/2"	Turf Spray	55.08	60	581.7	30	1.97	4.51	36.47	41.53	1.59 in/h
12	Hunter PGV-151 Globe	1-1/2"	Turf Spray	58.50	55	717.6	30	2.88	4.85	37.73	43.87	1.56 in/h
13	Hunter PGV-151 Globe	1-1/2"	Shrub Spray	40.75	54	635.3	30	3.09	3.08	36.17	39.35	1.53 in/h
14	Hunter PGV-151 Globe	1-1/2"	Shrub Spray	49.31	41	440.2	30	2.01	3.93	35.94	40.03	1.43 in/h
15	Hunter PGV-151 Globe	1-1/2"	Shrub Spray	34.43	36	360.9	30	0.76	3	33.75	35.9	1.4 in/h
16	Hunter PGV-151 Globe	1-1/2"	Turf Spray	36.50	38	404.2	30	1.13	3	34.13	36.53	1.32 in/h
17	Hunter PGV-151 Globe	1-1/2"	Turf Spray	58.90	48	593.0	30	1.52	4.89	36.4	42.08	1.55 in/h
18	Hunter PGV-151 Globe	1-1/2"	Shrub Spray	57.30	71	688.2	30	2.81	4.73	37.54	42.76	1.54 in/h
19	Hunter PGV-151 Globe	1-1/2"	Turf Spray	58.39	48	602.4	30	1.54	4.84	36.38	41.62	1.52 in/h
20	Hunter PGV-151 Globe	1-1/2"	Shrub Spray	33.37	38	379.6	30	1.9	3	34.9	36.8	1.85 in/h
21	Hunter PGV-151 Globe	1-1/2"	Turf Spray	44.24	53	624.1	30	4.98	3.42	38.41	41.84	1.54 in/h
22	Hunter PGV-151 Globe	1-1/2"	Shrub Spray	33.71	43	496.8	30	4.79	3	37.79	39.88	1.63 in/h
23	Hunter PGV-151 Globe	1-1/2"	Turf Spray	53.80	52	640.0	30	4.12	4.38	38.5	42.43	1.49 in/h
24	Hunter PGV-151 Globe	1-1/2"	Shrub Spray	50.91	56	550.6	30	4.23	4.09	38.33	41.84	1.26 in/h
25	Hunter PGV-151 Globe	1-1/2"	Shrub Spray	34.26	41	408.6	30	3.07	3	36.07	37.76	1.1 in/h
26	Hunter PGV-151 Globe	1-1/2"	Turf Rotor	44.10	18	474.1	45	4.51	3.41	52.92	55.59	0.9 in/h
27	Hunter PGV-101G	1"	Bubbler	9.50	19	308.9	30	0.36	1.9	32.26	32.71	1.7 in/h

### IRRIGATION SPECIFICATIONS

- IRRIGATION POINT OF CONNECTION SHALL BE CAPABLE OF DELIVERING A VARIABLE FLOW RATE OF 60 GPM AT A CONSTANT PRESSURE OF 70 PSI DOWNSTREAM OF BACKFLOW PREVENTION DEVICE. POINT OF CONNECTION SHALL BE ABLE TO MAINTAIN THE MAXIMUM FLOW RATE AND PRESSURE FOR THE DURATION OF AN IRRIGATION CYCLE. CONTRACTOR SHALL VERIFY THESE PARAMETERS PRIOR TO CONSTRUCTION, AND NOTIFY OWNER'S REPRESENTATIVE AND IRRIGATION CONSULTANT IF THEY CANNOT BE MET.
- IF THE POINT OF CONNECTION EXCEEDS THE ABOVE PRESSURE REQUIREMENTS, A PRESSURE REGULATOR SHALL BE INSTALLED AT THE OWNER'S EXPENSE. PRESSURE REGULATOR SHALL BE SET AT THE PRESSURE RECOMMENDED ABOVE.
- POWER FOR THE IRRIGATION CONTROLLER, PUMP AND OTHER ELECTRICAL COMPONENTS SHALL BE PROVIDED BY OTHER. CONTRACTOR SHALL VERIFY POWER AVAILABLE MEETS THE REQUIREMENTS OF THE COMPONENT'S MANUFACTURER. IF POWER AVAILABLE IS INADQUATE, CONTRACTOR SHALL NOTIFY THE OWNER'S REPRESENTATIVE PRIOR TO CONSTRUCTION.
- IRRIGATION SYSTEM IS DISPLAYED SCHEMATIC IN NATURE. MINOR FIELD ADJUSTMENTS MAY BE NECESSARY TO ACCOMMODATE FOR LANDSCAPING CHANGES, PLANTING BEDS OR OTHER OBSTRUCTIONS. THESE ADJUSTMENTS MAY BE MADE ONLY AFTER NOTIFYING THE OWNER'S REPRESENTATIVE.
- SOME IRRIGATION COMPONENTS AND PIPING ARE SHOWN IN HARDSCAPE AREAS AND OUTSIDE OF PROPERTY LINES TO IMPROVE ON THE READABILITY OF THE IRRIGATION PLAN. ALL COMPONENTS AND PIPING SHALL BE INSTALLED INSIDE OF THE PROPERTY LINES AND OUTSIDE OF HARDSCAPE AREAS.
- MAINLINE, LATERALS AND CONTROL WIRES SHALL BE INSTALLED INSIDE THE SAME TRENCH WHENEVER POSSIBLE..
- SYSTEM TO BE INSTALLED PER MANUFACTURER'S SPECIFICATIONS.
- CONTROLLER SHALL BE GROUNDED PER MANUFACTURER'S SPECIFICATIONS.
- ALL CONTROLLER/VALVE WIRE SHALL BE #14 GAUGE. THE COMMON WIRE SHALL BE COLORED WHITE, WHILE THE STATION WIRES SHALL BE OF AT LEAST ONE COLOR OTHER THAN WHITE.
- ALL FIELD WIRE ABOVE GRADE OR WITHIN STRUCTURE TO BE INSTALLED IN CONDUIT PER LOCAL CODE.
- ALL UNDERGROUND SPLICES TO UTILIZE 3M DBY, OR KING WATER PROOF SPLICE KITS, DEPENDING ON NUMBER AND SIZE OF WIRES. ALL SPLICES SHALL BE MADE INSIDE A VALVE BOX.
- DEPTH OF IRRIGATION PIPING; 18" ON MAINLINE; 12" ON LATERALS.
- SLEEVING UNDER PAVED AREAS SHALL BE INSTALLED AT A DEPTH OF 24".
- ALL NEW TREES AND PALMS SHALL HAVE BUBBLERS

REVISION	DATE
1	FDOT comments 4/17/24
2	COA comments 5/16/24

Lynn M Bender  
Digitally signed by  
Lynn M Bender  
Date: 2024.05.16  
19:46:34 -0400

**LBLA, Inc.**  
Landscape Architecture  
5610 Adair Way  
Lake Worth, FL 33467  
Phone: 561-644-3237  
lbenderlarch@gmail.com  
FL-LA666715

ALL DRAWING SPECIFICATIONS AND RELATED DOCUMENTS ARE THE COPYRIGHT PROPERTY OF THE LANDSCAPE ARCHITECT. THESE DRAWINGS, SPECIFICATIONS AND RELATED DOCUMENTS IN PART OR WHOLE IS FORBIDDEN WITHOUT THE LANDSCAPE ARCHITECT'S WRITTEN PERMISSION.  
CONTRACTOR MUST CHECK AND VERIFY ALL DIMENSIONS AND FIELD CONDITIONS AND NOTIFY LA ARCHITECT &/OR ENGINEER IMMEDIATELY OF ANY DISCREPANCIES.

COCONUT CREEK MAZDA  
3757 CORAL TREE CIRCLE  
COCONUT CREEK, FLORIDA 33073  
FDOT - SR 834 & SIDEWALK EASEMENT  
IRRIGATION, DETAILS & SPECIFICATIONS

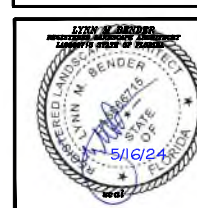

PROJECT NO: 20-569	CADD I.D. MAZDA LP
DRAWN BY: LMB	
CHECKED BY: LMB	
SCALE: N.T.S	
DATE: 08-04-2021	