

SECTION: 86028000
COUNTY: BROWARD
STATE RD: 834
PERMIT: 2024-L-491-00007

**AMENDMENT NUMBER NINE (9) TO
FLORIDA DEPARTMENT OF TRANSPORTATION DISTRICT FOUR (4)
LANDSCAPE INCLUSIVE MAINTENANCE MEMORANDUM OF AGREEMENT**

THIS AMENDMENT Number Nine (9) to the Agreement dated May 27, 2009, made and entered into this 8th day of October 2024 by and between the STATE OF **FLORIDA DEPARTMENT OF TRANSPORTATION** hereinafter called the **DEPARTMENT** and the **CITY OF COCONUT CREEK**, a municipal subdivision of the State of Florida, hereinafter called the **AGENCY**.

W I T N E S S E T H

WHEREAS, the parties entered into the Landscape Inclusive Maintenance Memorandum of Agreement dated, May 27, 2009 (Original Agreement) for the purpose of the AGENCY maintaining landscape improvements on various state roads within the AGENCY'S jurisdiction, including **State Road 834 (Sample Road)**; and,

WHEREAS, the DEPARTMENT and the AGENCY have agreed to add additional landscape on **State Road 834 (Sample Road)** in accordance with the Original Agreement; and,

NOW THEREFORE, for and in consideration of mutual benefits that flow each to the other, the parties covenant and agree as follows:

1. Pursuant to Page 7, Paragraph 8 of the Original Agreement, the DEPARTMENT will allow an Adjacent Property Owner to construct, via permit, additional landscape improvements within the DEPARTMENT's right-of-way, or to modify an improvement located as indicated in **Exhibit "A"** on **State Road 834 (Sample Road)** from M.P. 4.387 to M.P. 4.455, in accordance with the plans attached as **Exhibit "B"**.
2. The AGENCY shall agree to maintain the additional landscape improvements in this Amendment, including the meandering concrete sidewalk, shrubs, and irrigation, in accordance with the Original Agreement's Exhibit "C", Maintenance Plan, Part I, and Part II as follows:

II. SPECIFIC PROJECT SITE MAINTENANCE REQUIREMENTS AND RECOMMENDATIONS

- A. The design intent for this project is to line the new 12' curved sidewalk path with various low groundcover & shrub materials placed within and along the FDOT sidewalk easement. These plantings follow the City's initiative (code implemented) for a tiered layered planting buffer that fronts the subject property per approved plans.
- B. Canopy Trees are intended to be maintained at mature height and spread for their specific type / species. Note: No canopy trees are being proposed within the defined / recorded FDOT sidewalk easements, however, trees that are in close proximity (those trees that will ultimately have canopy overhanging these easements) shall be subject to all applicable maintenance objectives herein, including Live Oaks, Strangler Fig, Japanese Blueberry and Royal Palms. Refer to Part I Pruning, for clear sight window and vertical clear zone pruning requirements.
- C. Remove suckering growth from base and clear trunk areas for single and multi-trunked trees on a quarterly basis.
- D. To maintain the intended appearance of all palms, apply the latest palm fertilizer recommended by the University of Florida IFAS Extension per the manufacturer's specifications.
- E. To maintain the intended appearance of all shrubs or turf grass, apply the latest fertilizer recommended by the University of Florida IFAS Extension per the manufacturer's specifications.
- F. Do not remove fronds from self-cleaning palms, unless damaged. Palms with persistent fronds shall only have dead fronds removed, do not remove any green fronds. If it is deemed necessary to prune a palm's fronds, no fronds shall be trimmed above 3 o'clock and 9 o'clock on the horizontal plain.
- G. Shrub horizontal growth shall be maintained to prevent foliage from growing beyond the limits of the planting areas shown on the plan. Maintain a 6" minimum setback from the foliage to the edge of curb, pavement, sidewalk and/or other hardscape improvements. Groundcover horizontal growth shall be maintained are 4" from the edge of curb, pavement, sidewalk and/or other hardscape improvements.
- H. Maintain the vertical heights of shrubs as follows:
 - a. *Philodendron Xanadu*: between 30" and 36", full to ground
 - b. *Jatropha (bush form)*: between 48" and 60"
 - c. *Juniper horizontalis*: between 36" and 48"
 - d. *Indian Hawthorne*: between 24" and 30"
 - e. *Liriope E.G.*: mature height 18"- 24", do not trim.
Remove blades from overhanging sidewalk only.
 - f. *Sand Cord Grass*: mature height 36"- 48", do not trim.
Remove dead blades once a year.
- I. Inspect groundcovers and shrubs on a monthly basis for maintaining full to ground coverage.

- J. Evaluate plant material on a monthly basis for pests, diseases, drought stress or general decline. If required, follow the integrated pest management program established by the Agency to ensure healthy plants.
- K. Inspect the irrigation system performance on a monthly basis to ensure the system is providing 100% coverage, does not have sections of low pressure, heads and valves are clean and clear of debris and any damaged irrigation components (i.e., spray nozzles, spray heads, valve boxes, etc.) are repaired or replaced.

Except as modified by this Amendment, all terms and conditions of the Original Agreement and all Amendments thereto shall remain in full force and effect.

LIST OF EXHIBITS

- Exhibit A - Landscape Maintenance Boundaries
- Exhibit B - Landscape Improvement Plans

In Witness whereof, the parties hereto have executed this Amendment effective the day and year written and approved.

CITY OF COCONUT CREEK

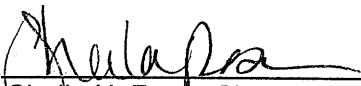
By: 
Sheila N. Rose, City Manager

Date: 9/20/24

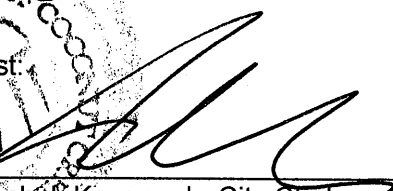

Attest: 
Joseph J. Kavanagh, City Clerk

(SEAL)

Legal Review:

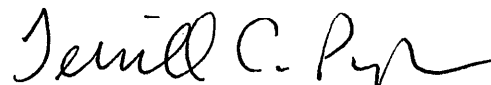
Terrill C. Pyburn, City Attorney

**STATE OF FLORIDA
DEPARTMENT OF TRANSPORTATION**

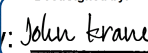
DocuSigned by:
By:  Date: 10/08/2024 | 2:56 PM EDT
AS74C9FD7984A5
John Krane, P.E., Director of Transportation Development

Attest:

DocuSigned by:

E14548B0681D471...
Alia Channel, Executive Secretary

(SEAL)

Legal Review:

DocuSigned by:

43DE68B3D38F409
Francine Steelman, Office of the General Counsel

SECTION: 86028000
COUNTY: BROWARD
STATE RD: 834
PERMIT: 2024-L-491-00007

EXHIBIT A

LANDSCAPE MAINTENANCE BOUNDARIES

I. ORIGINAL LIMITS OF INCLUSIVE LANDSCAPE MAINTENANCE AGREEMENT FOR STATE ROAD 834 (SAMPLE ROAD):

M.P. 3.008 (State Road 91) to M.P. 5.030 (West of State Road 7)

II. LIMITS OF LANDSCAPE IMPROVEMENTS FOR AMENDMENT #9 *:

State Road 834 (Sample Road) from M.P. 4.387 to M.P. 4.455 (Coral Tree Circle)

III. LANDSCAPE IMPROVEMENTS MAINTENANCE RESPONSIBILITIES MAP FOR AMENDMENT #9:

Please See Attached*

***All other limits of the Original Agreement and Amendments shall apply.**

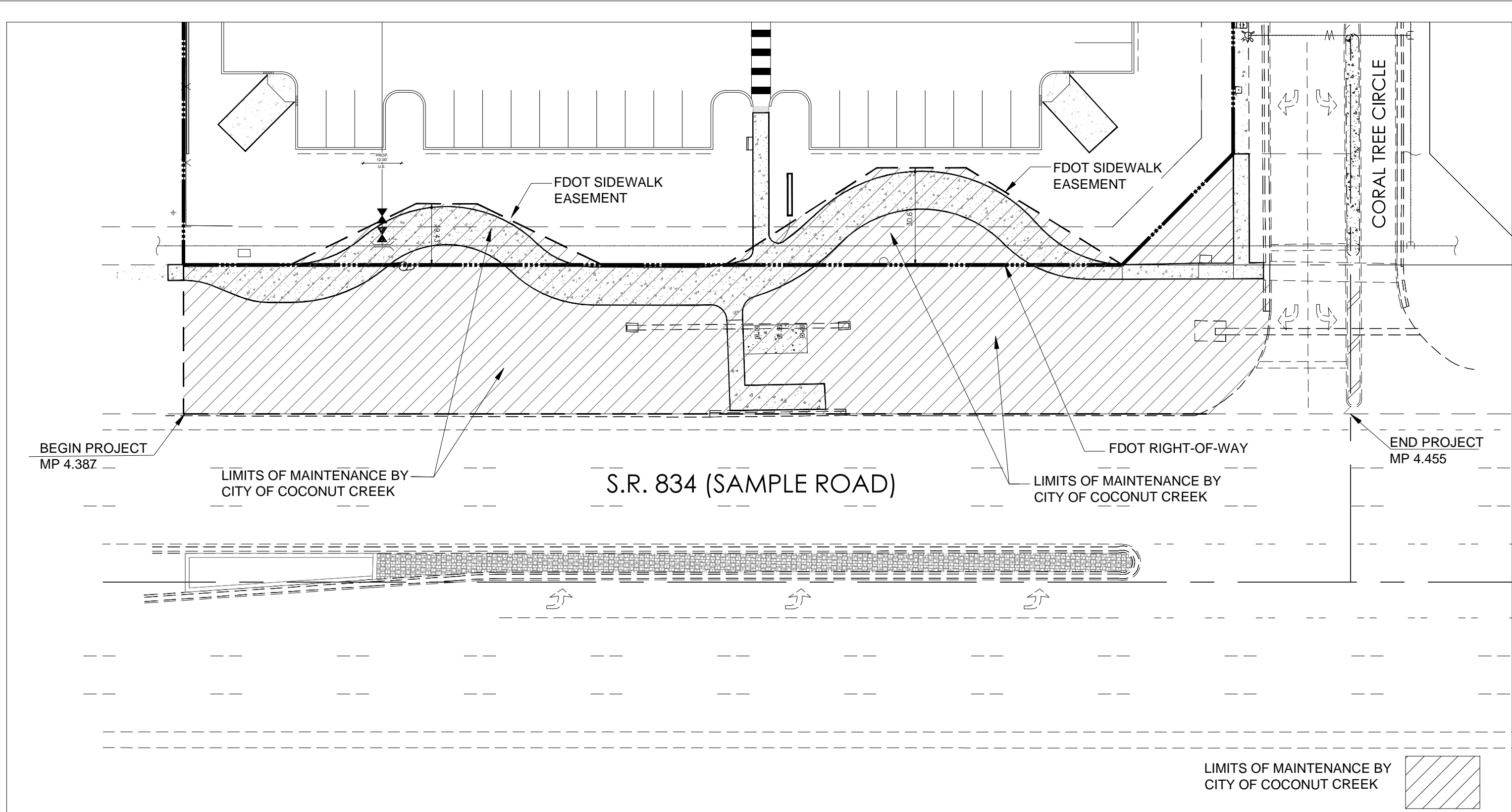

COCONUT CREEK MAZDA

3757 CORAL TREE CIRCLE
COCONUT CREEK, FLORIDA 33073

FDOT - SR 834 & SIDEWALK EASEMENT

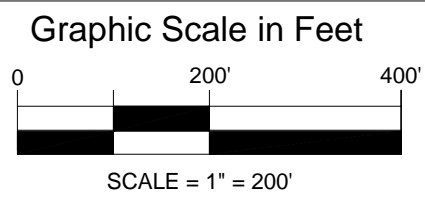
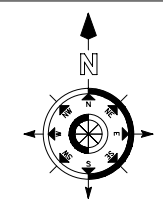

LANDSCAPE IMPROVEMENT
MAINTENANCE BOUNDARY MAP
CITY OF COCONUT CREEK, FLORIDA

NOTE: Printed drawing size may have changed from original. Verify scale using Bar Scale above.

SECTION: 86028000
COUNTY: BROWARD
STATE RD: 834
PERMIT: 2024-L-491-00007

EXHIBIT B
LANDSCAPE IMPROVEMENT PLANS

The AGENCY agrees to install the landscape improvements in accordance with the plans and specifications attached hereto and incorporated herein.

Please see attached plans prepared by: Lynn Bender, RLA
LBLA, Inc.

Date: May 16, 2024

Sheets: Cover, LP1, LP2, LP5, LP8,
IR-1, IR-2, IR-5, IR-Details

FDOT GENERAL NOTES

- GOVERNING STANDARD PLANS: Florida Department of Transportation, FY 2023-24 Standard Plans for Road and Bridge Construction and applicable Interim Revisions (IRs) are available at the following website: <https://www.fl.dot.gov/designstandards>
- GOVERNING STANDARD SPECIFICATIONS: Florida Department of Transportation, FY 2023-24 Standard Specifications for Road and Bridge Construction at the following website: <https://www.fl.dot.gov/programmanagement/implemented/specbooks>
- Contractor shall repair all damage done to FDOT property during demolition, relocation and/or installation activities at his sole expense.
- Any plant material substitution within or impacting the FDOT Right of Way whether requested by the Contractor, Owner, Landscape Architect or other will need to get approval from the FDOT District Landscape Architect.
- Ownership of all suitable excavated materials, as determined by the Department, shall remain in the Department until a final acceptance of the permitted project is fulfilled. Excavated materials shall be hauled by the Permittee, at their cost & expense from the site to the FDOT Board Operations Center or stockpiled in those areas as directed by the Department, including asphalt millings.

FDOT PLANTING NOTES

- For the portion of landscape plant material that will be installed within the FDOT Right of Way, landscape installation shall comply with current applicable FDOT Maintenance Specification 580. Online Reference: <https://www.fl.dot.gov/designstandards/specbooks>
- For the portion of landscape plant material that will be installed within the FDOT Right of Way refer to the FDOT Standard Plans Index 580-001 Landscape Installation. Online Reference: <https://www.fl.dot.gov/designstandards/specbooks>
- Cypress Mulch is not permitted on FDOT right of way. Mulch to be used are Hardwood Mulch (containing no Cypress products), Recycled Mulch or approved equal, certified by the Mulch and Soil Council (MSC). Submit proof of certification to the FDOT District Operations Permit Landscape Inspector upon inspection.
- Sodded areas will be in accordance with Standard Plans Index 570-010 and Standard Specifications Sections 162, 670, 901, 982, 983, 987 of the Department's latest edition of Governing Design Standards and Standard Specifications. All disturbed areas will be sodded within one (1) week of installation of said permitted work.

FDOT IRRIGATION NOTES

- The irrigation system shall use the lowest quality water available which adequately and safely meets the water needs of the system. Storm water, reclaim water, or gray water irrigation shall be used whenever possible.
- FDOT requires 24-hour emergency access to the water source.
- The contractor shall provide FDOT District Operations Manager with a set of "As-Built" Irrigation plans.

NOTE TO CONTRACTOR

LANDSCAPE INSTALLATION METHODS SHALL MEET OR EXCEED FDOT STANDARD PLANS INDEX 580-001 LANDSCAPE INSTALLATION FOR ALL PLANT MATERIAL INSTALLED WITHIN THE FDOT RIGHT OF WAY.
<https://www.fl.dot.gov/designstandards/specbooks>
<https://www.fl.dot.gov/designstandards/specbooks>

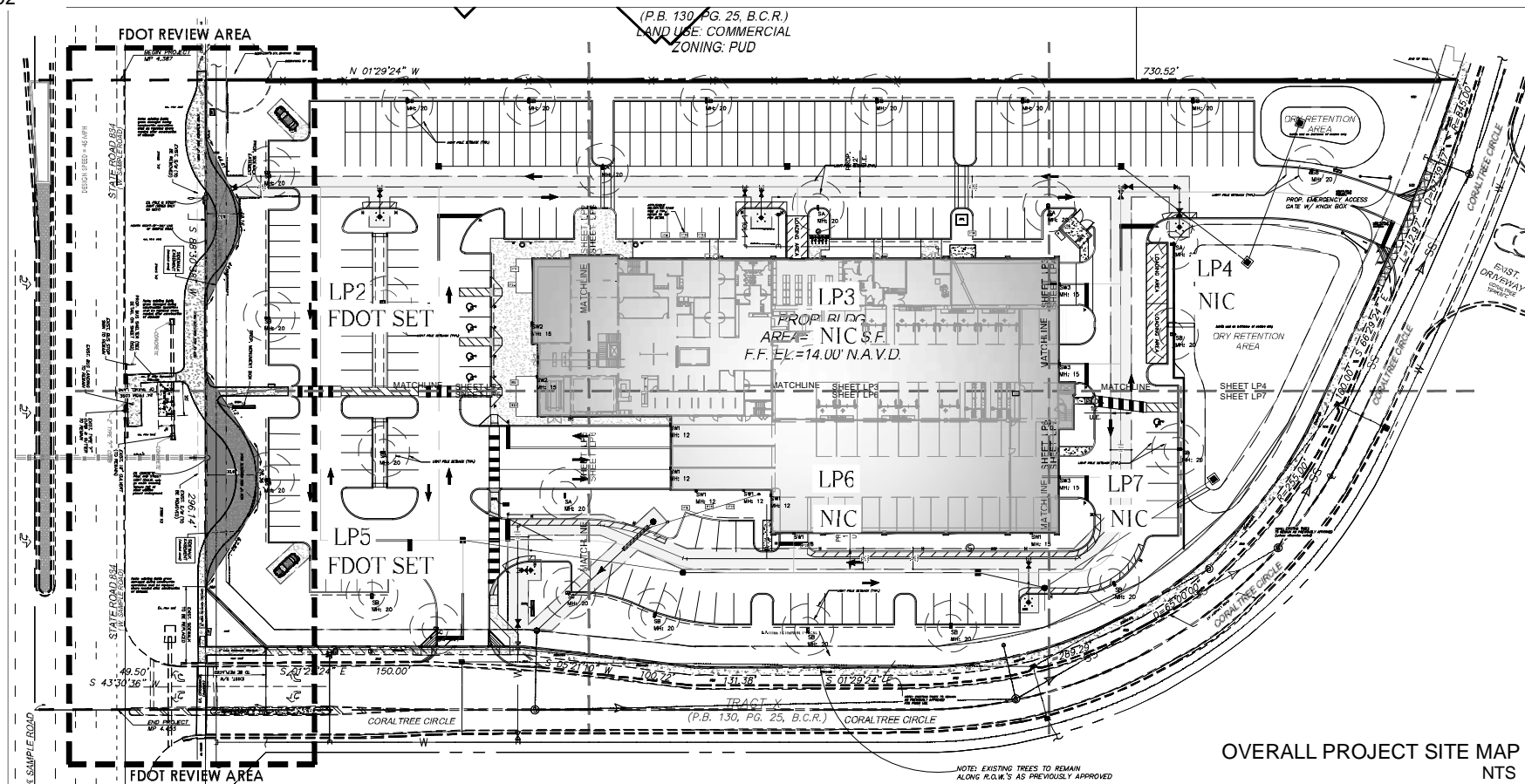

REVISION	DATE	
1	FDOT comments (added cover sheet)	4/17/24
2	COA comments	5/16/24

Lynn M Bender
 Digitally signed by Lynn M Bender
 Date: 2024.05.16 19:38:47 -0400

LOCATION MAP NTS

SHEET INDEX - FDOT PERMIT ONLY

COVER	
OVERALL LANDSCAPE PLAN	LP1
LANDSCAPE PLAN	LP2
LANDSCAPE PLAN	LP5
LANDSCAPE DETAILS & SPECIFICATIONS	LP8
OVERALL IRRIGATION PLAN	IR-1
IRRIGATION PLAN	IR-2
IRRIGATION PLAN	IR-5
IRRIGATION DETAILS & SPECIFICATIONS	IR-8

TO BE CONTACTED PRIOR TO ANY TYPE OF EXCAVATION WORK

811 SHOW WHAT'S BELOW ALWAYS CALL 811 BEFORE YOU DIG
 It's fast. It's free. It's the law.
www.callsunshine.com

LIST OF NON-STANDARD FDOT COMPONENTS

- The following landscape & irrigation items are proposed within the FDOT Sidewalk Easement: (designated & labeled in gray shaded areas along the proposed 12' wide concrete sidewalk)
- shrubs
 - groundcover
 - root barrier
 - irrigation heads & lateral lines
- Refer to applicable LP & IR sheets for specific information of each non-standard item.
- NOTE:** Refer to Civil Engineering plans for Hardscape items such as concrete sidewalk.

LBLA, Inc.
 Landscape Architecture
 5610 Adair Way
 Lake Worth, FL 33467
 Phone: 561-644-3237
 lbenderlarch@gmail.com
 FL-LA666715

ALL DRAWINGS, SPECIFICATIONS AND RELATED DOCUMENTS TO BE THE COPYRIGHT PROPERTY OF THE LANDSCAPE ARCHITECT. NO PARTS OR WHOLE REPRODUCTION OR TRANSMISSION IN ANY FORM OR BY ANY MEANS, ELECTRONIC OR MECHANICAL, INCLUDING PHOTOCOPYING, RECORDING, OR BY ANY INFORMATION STORAGE AND RETRIEVAL SYSTEM, IS PERMITTED WITHOUT THE WRITTEN PERMISSION OF THE LANDSCAPE ARCHITECT.

CONTRACTOR MUST CHECK AND VERIFY ALL DIMENSIONS AND FIELD CONDITIONS AND NOTIFY THE ARCHITECT AND/OR ENGINEER IMMEDIATELY OF ANY DISCREPANCIES.

COCONUT CREEK MAZDA
 3757 CORAL TREE CIRCLE
 COCONUT CREEK, FLORIDA 33073
FDOT - SR 834 & SIDEWALK EASEMENT COVER SHEET & APPLICABLE PERMIT REQUIREMENTS

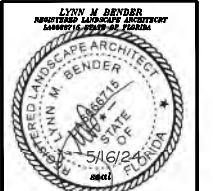

PROJECT NO:	20-569	CADD ID:	MAZDA LP
DRAWN BY:	LMB	CHECKED BY:	LMB
SCALE:	N/A	DATE:	04-17-2024

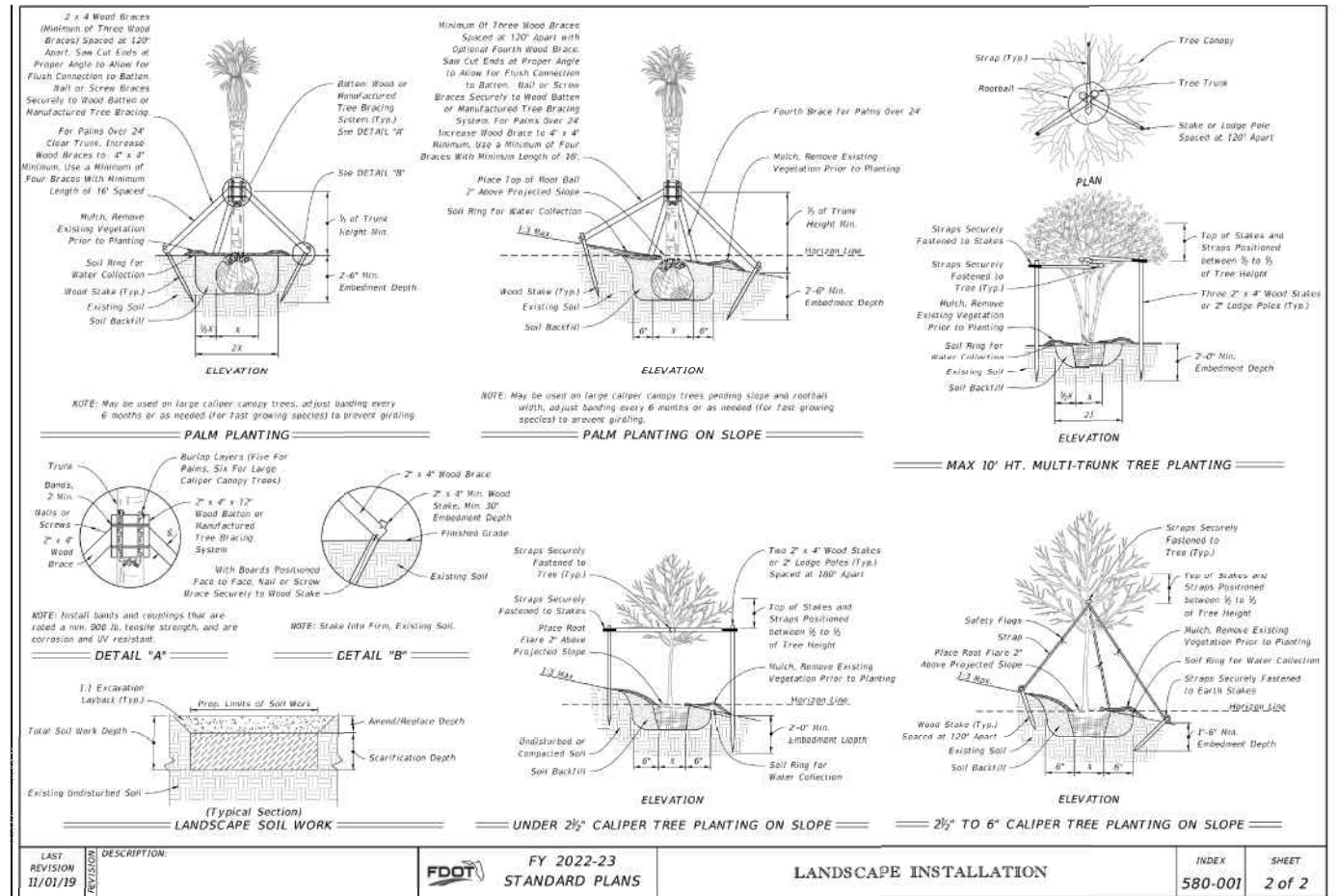
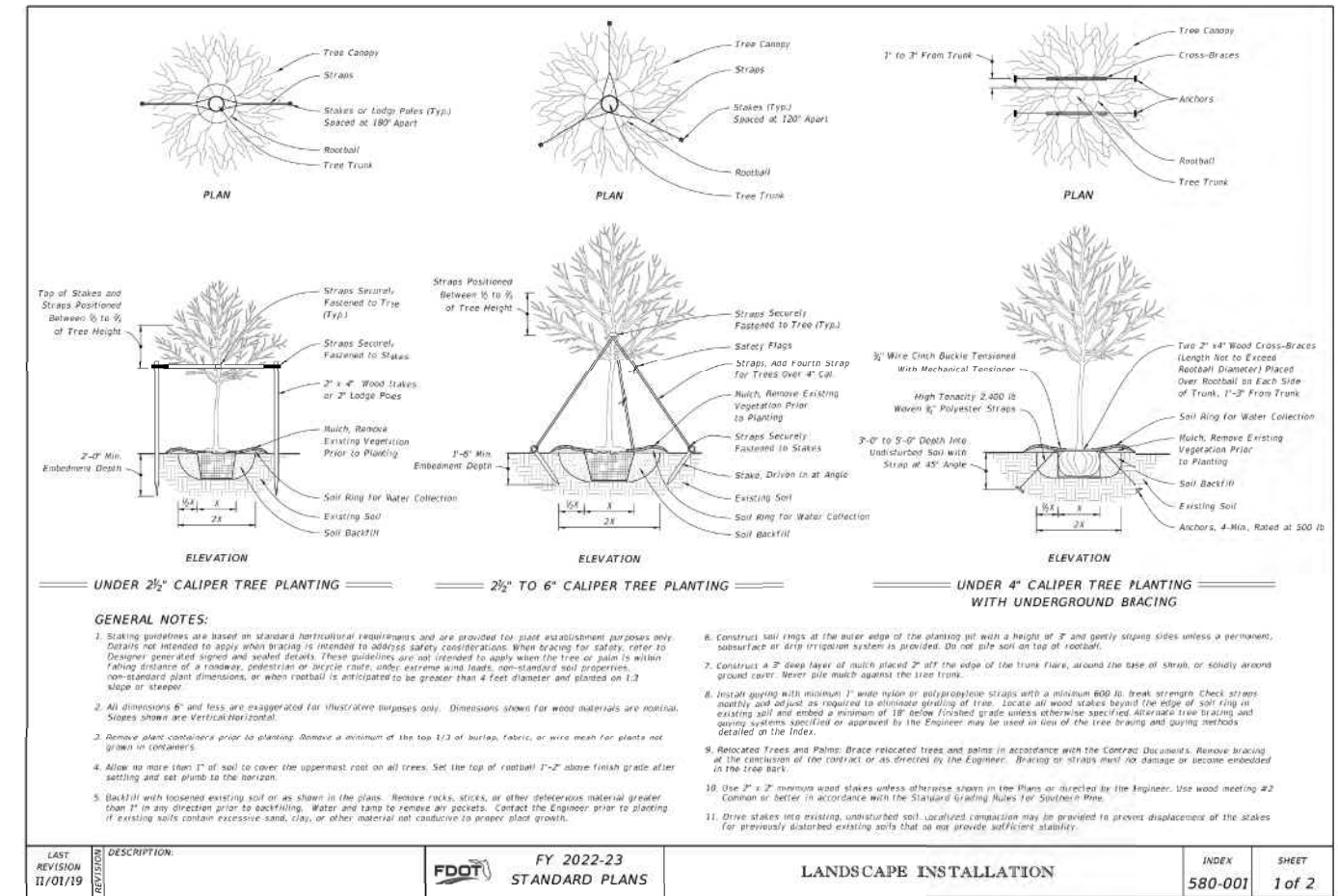

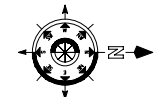

NOTE: REFER TO LP8 FOR COMPLETE OVERALL PLANT SCHEDULE

code-MIT = mitigation
code-E = existing
code-T = transplanted

PLANT LEGEND OVERALL

CODE	QTY	BOTANICAL / COMMON NAME
A - SHADE TREE		
AR	4	Acer rubrum Red Maple
AR-E	2	Acer rubrum Red Maple
BS	4	Bursera simaruba Gumbo Limbo
CE	18	Conocarpus erectus Buttonwood
FA-MIT	1	Ficus aurea Strangler Fig
FB-E	1	Ficus benghalensis Indian Banyan
QL-E	13	Quercus laevis Laurel Oak
QV	31	Quercus virginiana Southern Live Oak
QV-MIT	19	Quercus virginiana Southern Live Oak
QV-E	15	Quercus virginiana Southern Live Oak
TA-MIT	6	Taxodium ascendens Pond Cypress
TD	12	Taxodium distichum Bald Cypress
TD-E	3	Taxodium distichum Bald Cypress
B - INTERMEDIATE		
CO10	25	Chrysophyllum oliviforme Sairleaf
CR	6	Ficus rosea Autograph Tree
CD	9	Coccoloba diversifolia Pigeon Plum
CS10	6	Cordia sebestena Orange Geiger Tree
ED	9	Elaeagnus argentea Japanese Blueberry Tree
LS	9	Lagerstroemia speciosa Queen's Cape Myrtle
C - SMALL TREE		
CES	1	Conocarpus erectus 'Sericeus'
EF	13	Eugenia foenicia Spanish Stopper
JAT	9	Jatropha inaequalis Spicy Jatropha
LI	6	Lagerstroemia x Muskogee Cape Myrtle
MF	4	Myrcianthes fragrans Simpson's Stopper
D - PALMS		
PD	2	Phoenix dactylifera Medjool Date Palm
PHO-T	1	Phoenix roebelenii Pygmy Date Palm
RE	6	Rapisia exata Florida Royal Palm
SP	5	Sabal palmetto Cabbage Palmetto
SP-MIT	30	Sabal palmetto Cabbage Palmetto
SP-T	5	Sabal palmetto Cabbage Palmetto
VM-T	12	Veitchia merrillii Christmas Palm
SHRUBS		
AEC	23	Aechmea blanchetiana 'Orangeade'
CHR	423	Chrysobalanus icaco Red Tip Coccoloba
CLU	253	Clusia guiliera Small Leaf Clusia
CLU6	86	Clusia guiliera Small Leaf Clusia
CON	90	Conocarpus erectus Buttonwood
COR	14	Cordia terminalis 'Auntie Lou'
JA	4	Jatropha inaequalis Spicy Jatropha
MYR	152	Myrcianthes fragrans Simpson's Stopper
PRC	51	Philodendron x Rojo Congo Philodendron
POD	188	Podocarpus macrophyllus Dwarf Pingala
PDD	60	Dwarf Podocarpus
PSY	53	Psychotria nervosa Wild Coffee
SER	6	Sereia repens Saw Palmetto
THR	80	Thryallis glauca Thryallis
SHRUB AREAS		
BOU	78	Bougainvillea x Raspberry Ice Bougainvillea bush
DIA	205	Disanella tasmatica Flax Lily
FIC	424	Ficus microcarpa Green Island Green Island Ficus
HAM	337	Hamelia patens Firebush
ILX	570	Ilex vomitoria 'Schilling's Dwarf'
ISO	347	Isoetes taiwanensis Dwarf Schilling's Holly Hedge
JAS	305	Jasminum multiflorum Downey Jasmine
MUH	162	Muhlenbergia capillaris Pink Moony Grass
NEP	171	Nepenthes exaltata Boston Fern
PHX	92	Philodendron vanderi Xanadu Philodendron
RHA	128	Rhapidocephala indica Alba White Indian Hawthorn
TRI	183	Schefflera arborescens Tranele Schefflera arborescens
SPA	160	Spartina bakeri Sand Cord Grass
DFK	302	Tropaeum dactyloides Dwarf Fakahatchee
ZAM	235	Zamia floridana Ft. Coonina
GROUND COVERS		
ASP	396	Asparagus densiflorus 'Myers'
JUN	664	Juniperus horizontalis Creeeping Juniper
LIR	1,071	Liriope muscari 'Evergreen Giant'
TURF		
SOD-B	8,081 sf	Paspalum notatum Bahia Grass
SOD	33,640 sf	Stenandrium secundatum 'Florim'

REVISION	DATE
1	FDOT comments 4/17/24
2	COA comments 5/16/24

Lynn M Bender
 Digitally signed by Lynn M Bender
 Date: 2024.05.16 19:44:42 -0400

LBLA, Inc.
 Landscape Architecture
 5610 Adair Way
 Lake Worth, FL 33467
 Phone: 561-644-3237
 lbenderlarch@gmail.com
 FL-LA666715

ALL DRAWINGS, SPECIFICATIONS AND RELATED DOCUMENTS ARE THE PROPERTY OF LBLA, INC. AND ARE NOT TO BE REPRODUCED OR TRANSMITTED IN ANY FORM OR BY ANY MEANS, ELECTRONIC OR MECHANICAL, INCLUDING PHOTOCOPYING, RECORDING, OR BY ANY INFORMATION STORAGE AND RETRIEVAL SYSTEM, WITHOUT THE WRITTEN PERMISSION OF LBLA, INC.

CONTRACTOR MUST CHECK AND VERIFY ALL DIMENSIONS AND FIELD CONDITIONS AND NOTIFY LBLA, ARCHITECT AND/OR ENGINEER IMMEDIATELY OF ANY DISCREPANCIES.

COCONUT CREEK MAZDA
 3757 CORAL TREE CIRCLE
 COCONUT CREEK, FLORIDA 33073

FDOT - SR 834 & SIDEWALK EASEMENT
 LANDSCAPE PLAN

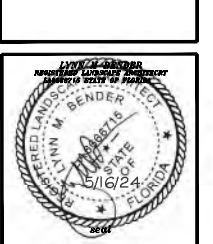

PROJECT NO: CADD LD. 20-569 MAZDA LP
 DRAWN BY: LMB
 CHECKED BY: LMB
 SCALE: 1" = 10'-0"
 DATE: 04-20-2021

SHEET: **LP2**
 MOA Page 10 of 18
 2 OF 8 SHEETS

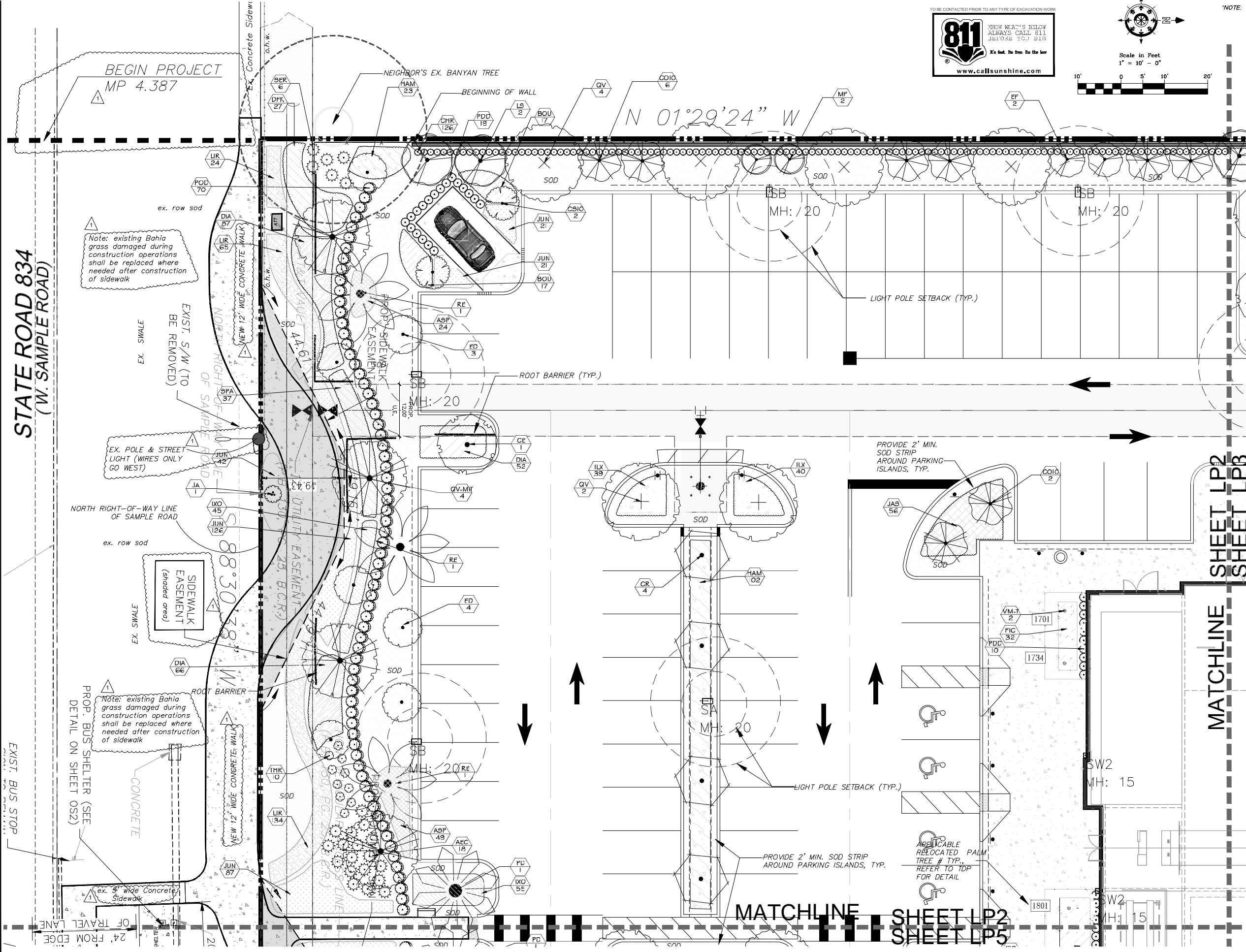

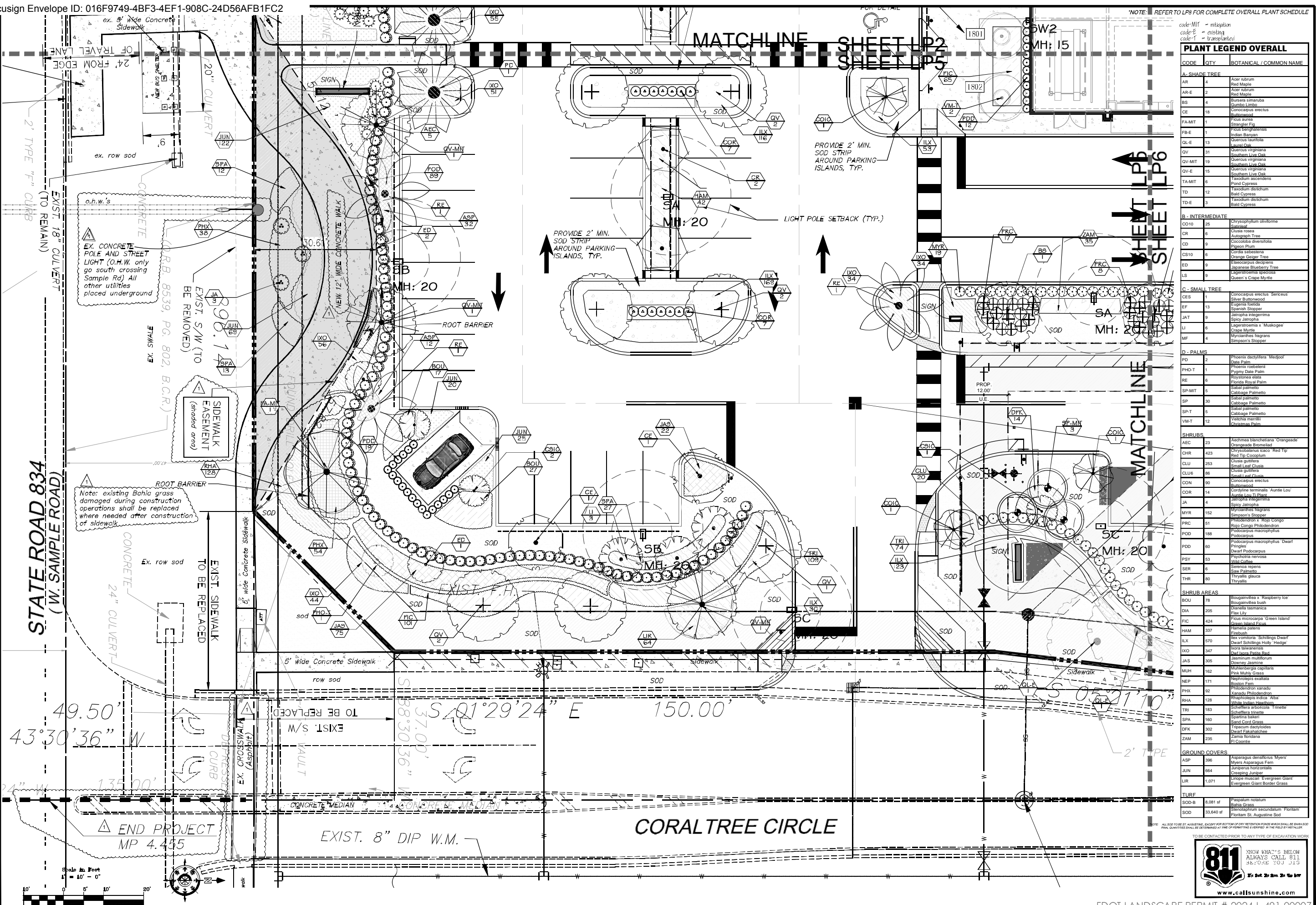

PLANT LEGEND OVERALL

CODE	QTY	BOTANICAL / COMMON NAME
A - SHADE TREE		
AR	4	Acer rubrum Red Maple
AR-E	2	Acer rubrum Red Maple
BS	4	Bumelia aemula Gumbo Limbo
CE	18	Conocarpus erectus Buttonwood
FA-MIT	1	Ficus aurea Strangler Fig
FB-E	1	Ficus benghalensis Indian Banyan
QLE	13	Quercus laurifolia Live Oak
QV	31	Quercus virginiana Southern Live Oak
QV-MIT	19	Quercus virginiana Southern Live Oak
QV-E	15	Quercus virginiana Southern Live Oak
TA-MIT	8	Taxodium ascendens Pond Cypress
TD	12	Taxodium distichum Bald Cypress
TD-E	3	Taxodium distichum Bald Cypress
B - INTERMEDIATE		
CO10	25	Chrysophyllum oviforme Sapota
CR	6	Clusia rosea Autograph Tree
CD	9	Cordia alliodora Pigeon Plum
CS10	6	Cordia sebestena Orange Grew Tree
ED	9	Etiopocarpus drooping Japanese Blueberry Tree
LS	9	Lagerstroemia speciosa Queen's Cape Myrtle
C - SMALL TREE		
CES	1	Conocarpus erectus Sericeus Silver Buttonwood
EF	13	Eugenia foetida Spanish Stopper
JAT	9	Jatropha integrirama Spicy Jatropha
LI	6	Lagerstroemia speciosa Queen's Cape Myrtle
MF	4	Myrciandra fragrans Simpson's Stopper
D - PALMS		
PD	2	Phoenix dactylifera Medjool Date Palm
PHO-T	1	Phoenix roebelenii Pygmy Date Palm
RE	6	Roystonea elata Florida Royal Palm
SP-MIT	5	Sabal palmetto Cabbage Palmetto
SP	30	Sabal palmetto Cabbage Palmetto
SP-T	5	Sabal palmetto Cabbage Palmetto
VM-T	12	Veitchia merrillii Queensland Palm
SHRUBS		
AEC	23	Aechmea blanchetiana Orangeade
CHR	423	Chrysobalanus icaco Red Tip
CLU	253	Clusia guiteria Small Leaf Clusia
CLU6	86	Clusia guiteria Small Leaf Clusia
CO	90	Conocarpus erectus Buttonwood
COR	14	Cordyline terminalis Auntie Lou
JA	4	Jatropha integrirama Spicy Jatropha
MYR	152	Myrciandra fragrans Simpson's Stopper
PRC	51	Philodendron x Rogo Longo Philodendron
PDD	188	Podocarpus macrophyllus Dwarf Podocarpus
PDD	60	Podocarpus macrophyllus Dwarf Podocarpus
PSY	53	Psychotria nervosa Dwarf Psychotria
SER	6	Senecio repens Sea Purslane
THR	80	Thryallis glauca Thryallis
SHRUB AREAS		
BOU	78	Bougainvillea x Raspberry Ice Bougainvillea bush
DIA	205	Dioscorea torricelliana Flax Lily
FIC	424	Ficus microcarpa Green Island Fig
HAM	337	Hamelia patens Hamelia
ILK	570	Illicium parviflorum Schilling's Dwarf Star Anise
IXO	347	IXORA sp. Wax Plant
JAS	305	Jasminum multiflorum Dwarf Jasmine
MUH	162	Muhlenbergia capillaris Pink Muhly Grass
NEP	171	Nepenthes exaltata Boston Fern
PHX	92	Philodendron xanadu Xantho Philodendron
RHA	128	Rhapidoisops indica Alba White Indian Hawthorn
TRI	183	Triplaris hirsuta Schaffneria tinctoria
SPA	160	Sparganium bakeri Sand Cord Grass
DFK	302	Triplaris hirsuta Schaffneria tinctoria
ZAM	235	Zamia floridana Florida Cycad
GROUND COVERS		
ASP	398	Asparagus densiflorus Myers
JUN	684	Juniperus horizontalis Creeping Juniper
LIR	1,071	Liriodendron muscari Evergreen Giant
TURF	6,081 sf	Paspalum notatum Bahua Grass
SOD	33,640 sf	Stenotaphrum secundatum Floristam

REVISION	DATE
1	FDOT comments 4/17/24
2	COA comments 5/16/24

Lynn M Bender
Date: 2024.05.16
19:45:02
-0400

LBLA, Inc.
Landscape Architecture
5610 Adair Way
Lake Worth, FL 33467
Phone: 561-644-3237
lbender.larch@gmail.com
FL-LA666715

ALL DRAWINGS, SPECIFICATIONS AND RELATED DOCUMENTS TO BE THE PROPERTY OF LBLA, INC. AND NOT TO BE REPRODUCED OR TRANSMITTED IN ANY FORM OR BY ANY MEANS, ELECTRONIC OR MECHANICAL, INCLUDING PHOTOCOPYING, RECORDING, OR BY ANY INFORMATION STORAGE AND RETRIEVAL SYSTEM, WITHOUT THE WRITTEN PERMISSION OF LBLA, INC. CONTRACTOR MUST CHECK AND VERIFY ALL DIMENSIONS AND FIELD CONDITIONS AND NOTIFY LBLA, ARCHITECT AND ENGINEER IMMEDIATELY OF ANY DISCREPANCIES.

COCONUT CREEK MAZDA
3757 CORAL TREE CIRCLE
COCONUT CREEK, FLORIDA 33073
FDOT - SR 834 & SIDEWALK EASEMENT
LANDSCAPE PLAN

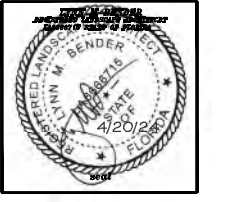

PROJECT NO: 20-569 MAZDA LP
DRAWN BY: LMB
CHECKED BY: LMB
SCALE: 1" = 10'-0"
DATE: 04-20-2021

SHEET: **LP5**
MOA Page 11 of 18
5 of 8 SHEETS



REVISION	DATE
1	FDOT comments 4/17/24
2	COA comments 5/16/24

Lynn M Bender
 Designer
 LBLA, Inc.
 Landscape Architecture
 5610 Adair Way
 Lake Worth, FL 33467
 Phone: 561-644-3237
 lbenderlarch@gmail.com
 FL-LA666715

ALL DRAWINGS, SPECIFICATIONS AND RELATED DOCUMENTS ARE THE COPYRIGHT PROPERTY OF THE LANDSCAPE ARCHITECT. THESE DRAWINGS SHALL BE USED ONLY FOR THE PROJECT AND SITE SPECIFICALLY IDENTIFIED IN THESE DOCUMENTS. NO PART OF THESE DRAWINGS OR DOCUMENTS MAY BE REPRODUCED OR TRANSMITTED IN ANY FORM OR BY ANY MEANS, ELECTRONIC OR MECHANICAL, WITHOUT THE WRITTEN PERMISSION OF THE LANDSCAPE ARCHITECT.

COCONUT CREEK MAZDA
 3757 CORAL TREE CIRCLE
 COCONUT CREEK, FLORIDA 33073
FDOT - SR 834 & SIDEWALK EASEMENT
OVERALL IRRIGATION PLAN



PROJECT NO. 20-569	CADD I.D. MAZDA LP
DRAWN BY: LMB	CHECKED BY: LMB
SCALE: 1" = 30'-0"	DATE: 08-04-2021

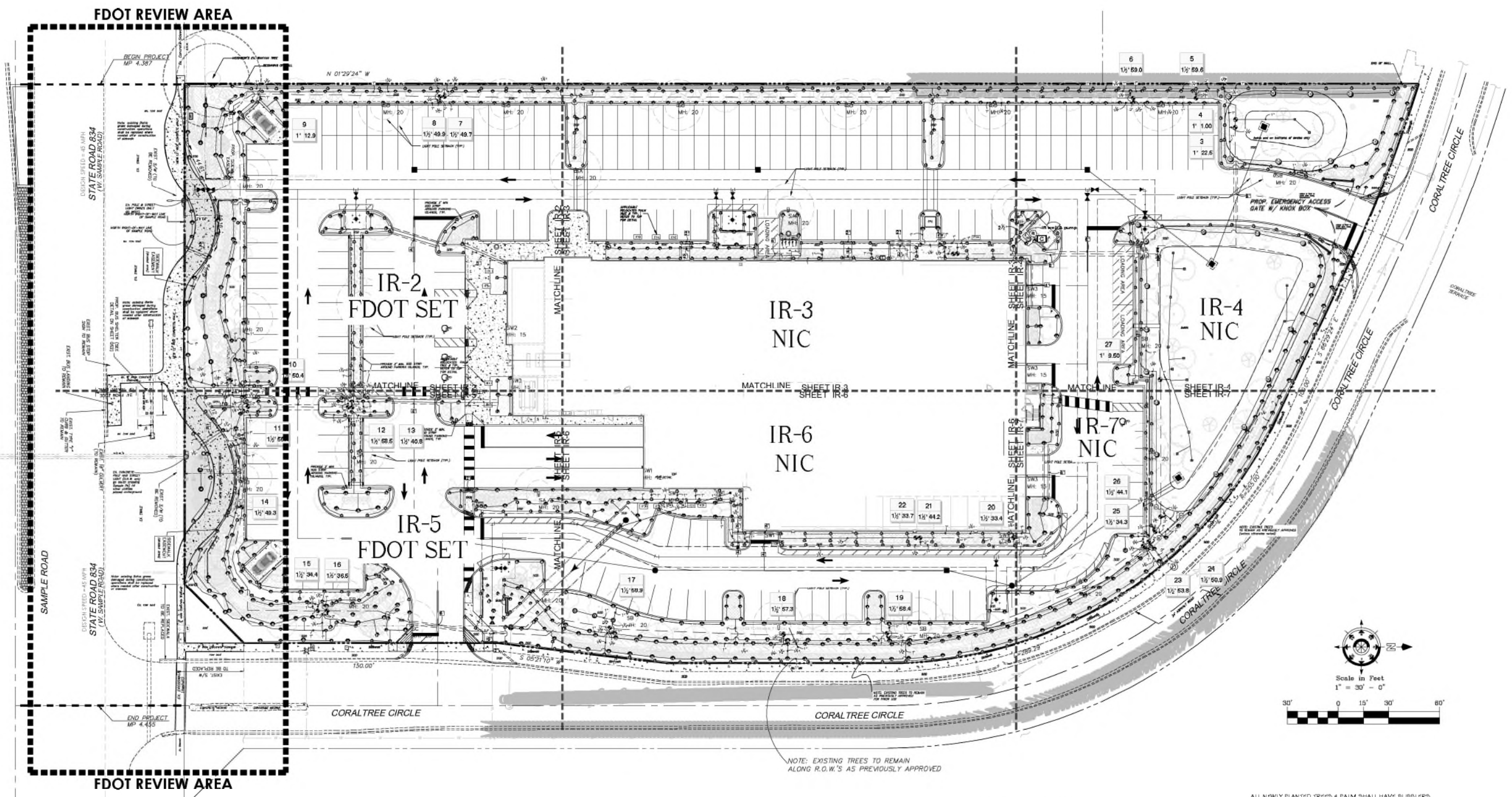

NOTE TO CONTRACTOR:
 THE FOLLOWING IRRIGATION INSPECTIONS ARE REQUIRED BY CITY:
 - ROUGH
 - SLEEVES
 - MAINLINE PRESSURE TEST
 - FINAL

IRRIGATION SCHEDULE

SYMBOL	MANUFACTURER/MODEL	QTY	ARC	PSI	RADIUS
●	Hunter PROS-04 5' slip spray	35	108	30	5x15'
●	Hunter PROS-04 5' slip spray	37	108	30	5x15'
●	Hunter PROS-04 5' slip spray	188	108	30	5x30'
●	Hunter PROS-04 8' radius	179	180	30	8'
●	Hunter PROS-04 8' radius	21	90	30	8'
●	Hunter PROS-04 10' radius	2	360	30	10'
●	Hunter PROS-04 10' radius	34	180	30	10'
●	Hunter PROS-04 12' radius	23	90	30	12'
●	Hunter PROS-04 12' radius	2	360	30	12'
●	Hunter PROS-04 12' radius	42	180	30	12'
●	Hunter PROS-04 12' radius	3	90	30	12'
●	Hunter PROS-04 15' radius	19	180	30	15'
●	Hunter PROS-04 15' radius	8	90	30	15'
●	Hunter PROS-12 5' slip spray	30	108	30	5x15'
●	Hunter PROS-12 5' slip spray	30	108	30	5x15'
●	Hunter PROS-12 5' slip spray	117	108	30	5x30'
●	Hunter PROS-12 8' radius	82	180	30	8'
●	Hunter PROS-12 8' radius	54	90	30	8'
●	Hunter PROS-12 10' radius	2	360	30	10'
●	Hunter PROS-12 10' radius	124	180	30	10'
●	Hunter PROS-12 10' radius	23	90	30	10'
●	Hunter PROS-12 12' radius	5	360	30	12'
●	Hunter PROS-12 12' radius	52	180	30	12'
●	Hunter PROS-12 12' radius	24	90	30	12'
●	Hunter PROS-12 15' radius	1	360	30	15'
●	Hunter PROS-12 15' radius	38	180	30	15'
●	Hunter PROS-12 15' radius	15	90	30	15'
●	Hunter PCB 30	21	360	30	2'

TOTAL NO. OF HEADS 1,192

ALL NEWLY PLANTED TREES & PALM SHALL HAVE BUBBLERS.
 BUBBLERS SHALL BE ON SEPARATE ZONES FOR ABILITY TO OVERRIDE / SHUT OFF WHEN NOT NEEDED.

SYMBOL	MANUFACTURER/MODEL	QTY	PSI	RADIUS
●	Hunter PGP-ADJ-B	7	45	30'
●	Hunter PGP-ADJ-B	17	45	30'
●	Hunter PGP-ADJ-LA	3	40	24'

SYMBOL	MANUFACTURER/MODEL	QTY
●	Hunter PGM 1010 1"	4
●	Hunter PGM 1010 1-1/2"	23
●	Milco-Norca (MTR) 2 1/2"	3
●	Hunter IC-088-PL	1
●	Hunter R04M-CLM	1
●	Pump S 11P - SURFACE MOUNT 4" WELL - 120 GPM	1

SYMBOL	DESCRIPTION	QTY
—	Irrigation Lateral Line: PVC Class 200 SDR 21 1"	12,024 LF
—	Irrigation Lateral Line: PVC Class 200 SDR 21 1 1/2"	1,336 LF
—	Irrigation Lateral Line: PVC Class 200 SDR 21 1 1/2"	301 2 LF
—	Irrigation Lateral Line: PVC Class 200 SDR 21 2"	82 7 LF
—	Irrigation Lateral Line: PVC Class 200 SDR 21 2 1/2"	28 8 LF
—	Irrigation Mainline: PVC Class 200 SDR 21 2 1/2"	2,886 LF
—	Pipe Sleeve: PVC Schedule 40 2"	122 5 LF
—	Pipe Sleeve: PVC Schedule 40 4"	217 7 LF
—	Pipe Sleeve: PVC Schedule 40 6"	183 5 LF

IRRIGATION SYSTEM SHALL BE RUST-FREE; CONTRACTOR SHALL COORDINATE WITH OWNER FOR INSTALLATION OF A RUST INHIBITOR SYSTEM IF APPLICABLE TO THIS SITE. OWNERS TO SECURE A COMPANY TO PROVIDE ON-GOING SERVICES TO PROPERLY MAINTAIN THE RUST INHIBITOR SYSTEM.

FDOT LANDSCAPE PERMIT # 2024-L-491-00007

FDOT SET : IR-1, IR-2, IR-5 & IR-8 ONLY



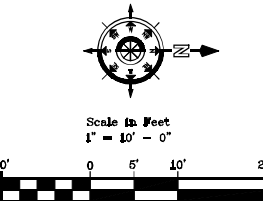
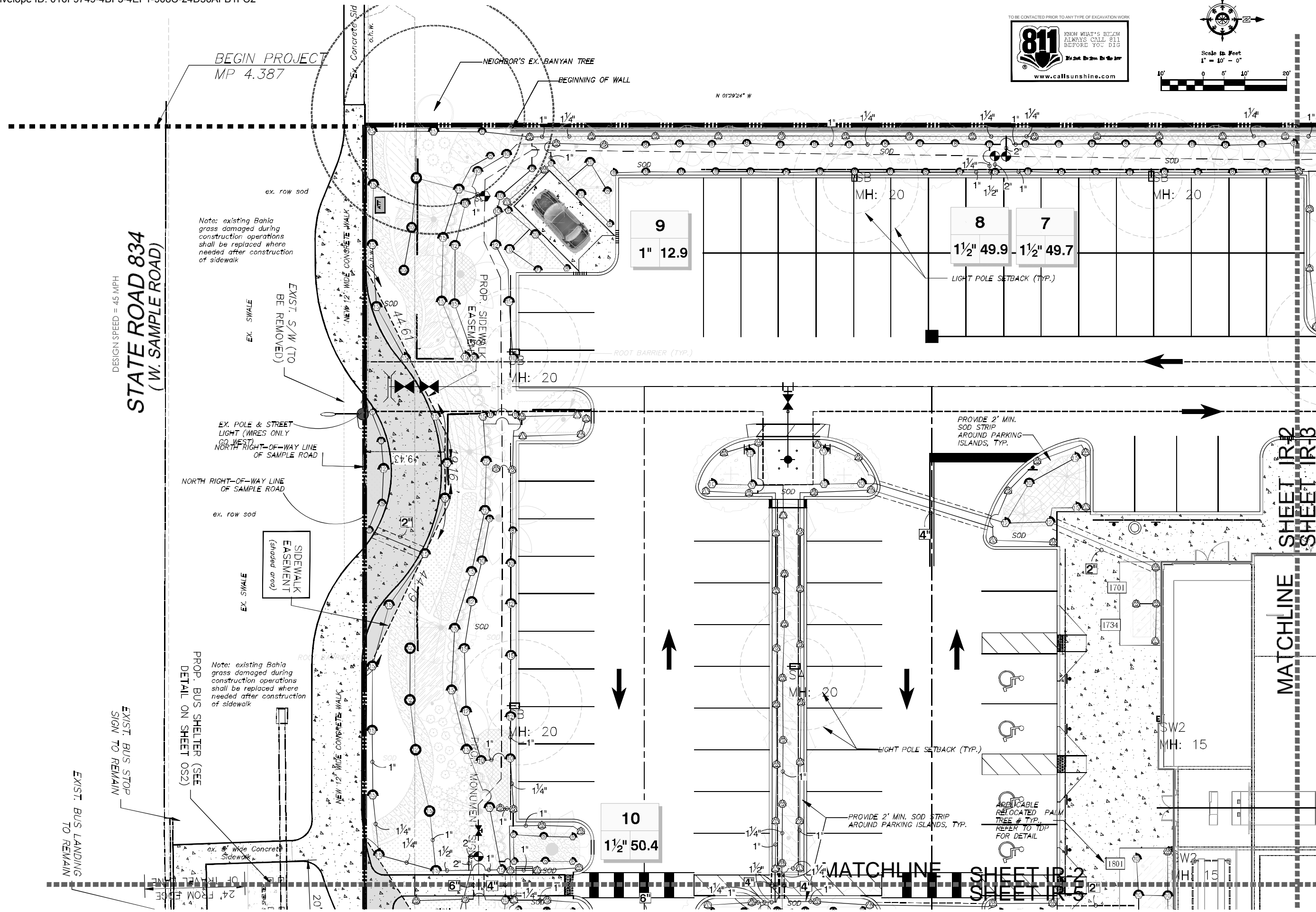

REVISION	DATE
1	FDOT comments 4/17/24
2	COA comments 5/16/24

Lynn M Bender
 20240516
 194656
 9400

LBLA, Inc.
 Landscape Architecture
 5610 Adair Way
 Lake Worth, FL 33467
 Phone: 561-644-3237
 lbenderlarch@gmail.com
 FL-LA6666715

ALL DRAWINGS, SPECIFICATIONS AND RELATED DOCUMENTS ARE THE COPYRIGHT PROPERTY OF THE LANDSCAPE ARCHITECT. MUST BE RETURNED UPON REQUEST. REPRODUCTION OF DRAWINGS, SPECIFICATIONS AND RELATED DOCUMENTS IN PART OR WHOLE IS PROHIBITED WITHOUT THE LANDSCAPE ARCHITECT'S WRITTEN PERMISSION.
 CONTRACTOR MUST CHECK AND VERIFY ALL DIMENSIONS AND FIELD CONDITIONS AND NOTIFY THE ARCHITECT AND/OR ENGINEER IMMEDIATELY OF ANY DISCREPANCIES.

COCONUT CREEK MAZDA
 3757 CORAL TREE CIRCLE
 COCONUT CREEK, FLORIDA 33073
FDOT - SR 834 & SIDEWALK EASEMENT IRRIGATION PLAN



PROJECT NO.	20-569	CADD ID.	MAZDA LP
DRAWN BY:	LMB	CHECKED BY:	LMB
SCALE:	1" = 10'-0"	DATE:	08-04-2021

SHEET: **IR-2**
 Page 14 of 18
 2 OF 8 SHEETS

REVISION	DATE
1	FDOT comments 4/17/24
2	COA comments 5/16/24

Lynn M Bender
 Digitally signed by Lynn M Bender
 Date: 2024.05.16 19:46:17 -0400

LBLA, Inc.
 Landscape Architecture
 5610 Adair Way
 Lake Worth, FL 33467
 Phone: 561-644-3237
 lbenderlarch@gmail.com
 FL-LA666715

ALL DRAWINGS, SPECIFICATIONS AND RELATED DOCUMENTS ARE THE COPYRIGHT PROPERTY OF LBLA, INC. AND SHALL REMAIN THE PROPERTY OF LBLA, INC. UPON COMPLETION OF THE PROJECT. NO REPRODUCTION OR TRANSMISSION OF ANY KIND IS PERMITTED WITHOUT THE WRITTEN PERMISSION OF LBLA, INC.

COCONUT CREEK MAZDA
 3757 CORAL TREE CIRCLE
 COCONUT CREEK, FLORIDA 33073
FDOT - SR 834 & SIDEWALK EASEMENT
 IRRIGATION PLAN



PROJECT NO:	20-569	CADD I.D.:	MAZDA LP
DRAWN BY:	LMB	CHECKED BY:	LMB
SCALE:	1" = 10'-0"	DATE:	08-04-2021

SHEET:
IR-5
 MOA Page 15 of 18
 5 of 8 SHEETS

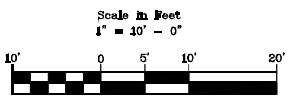
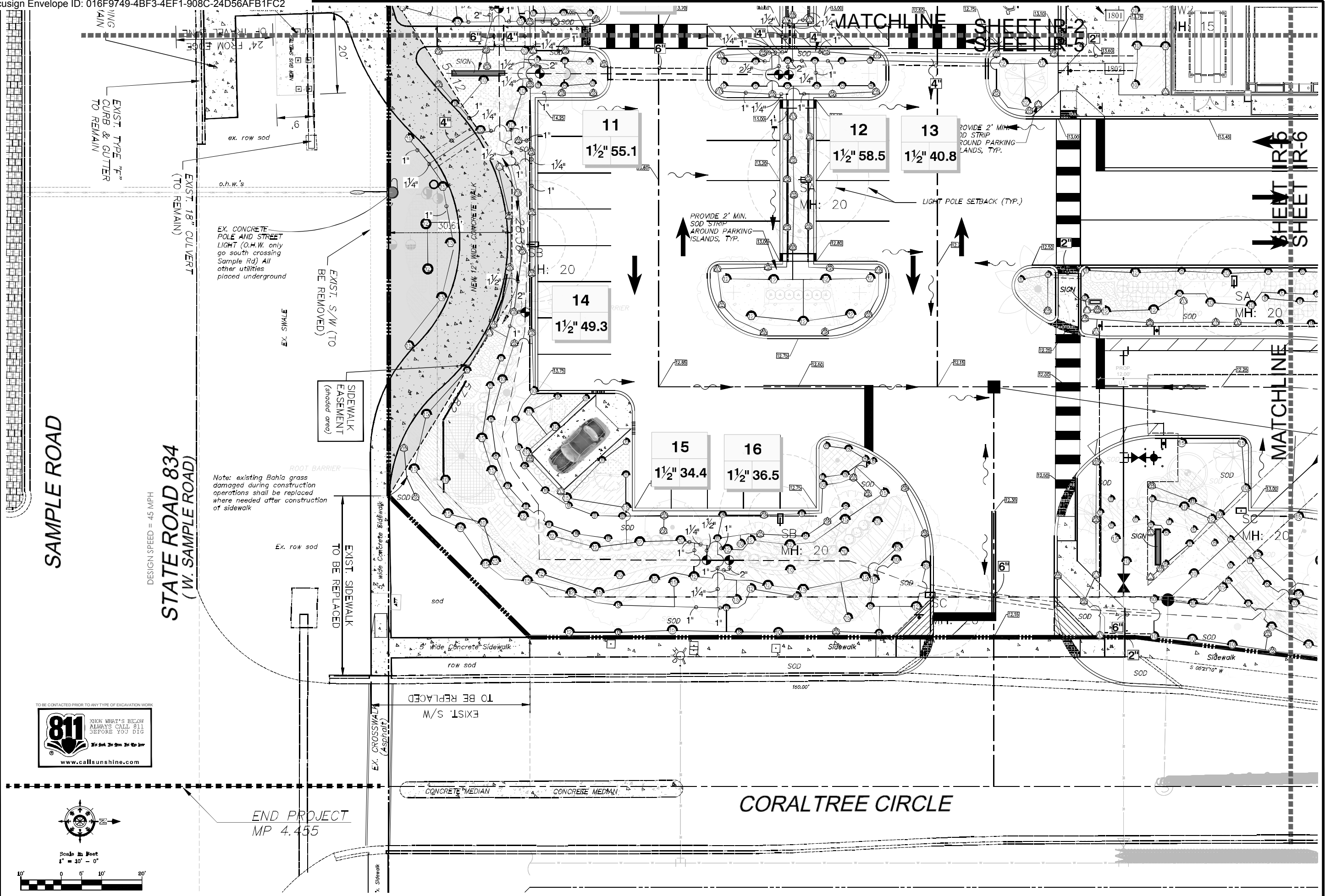

END PROJECT
 MP 4.455

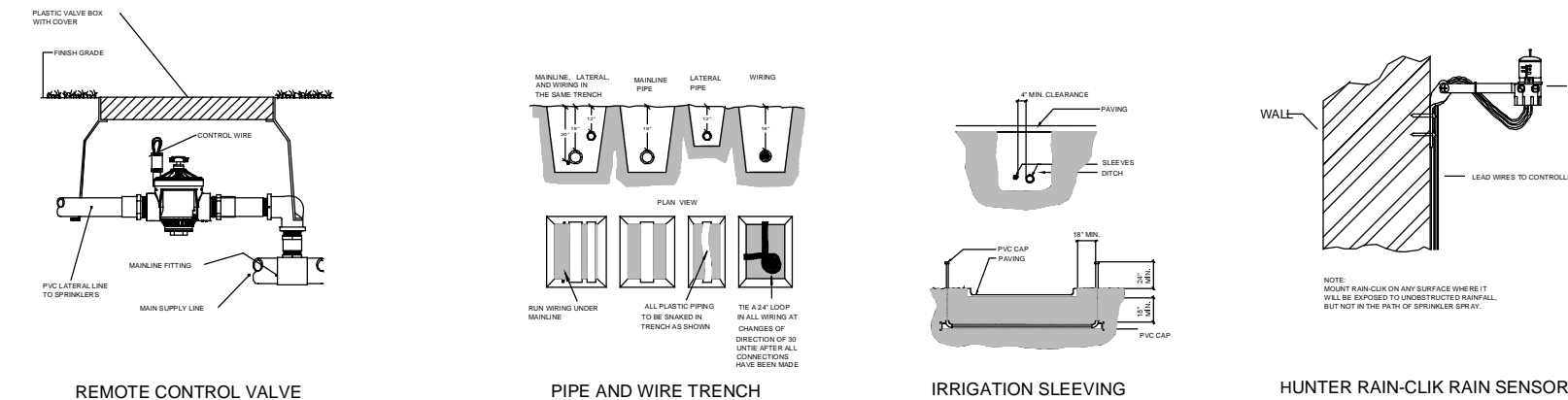
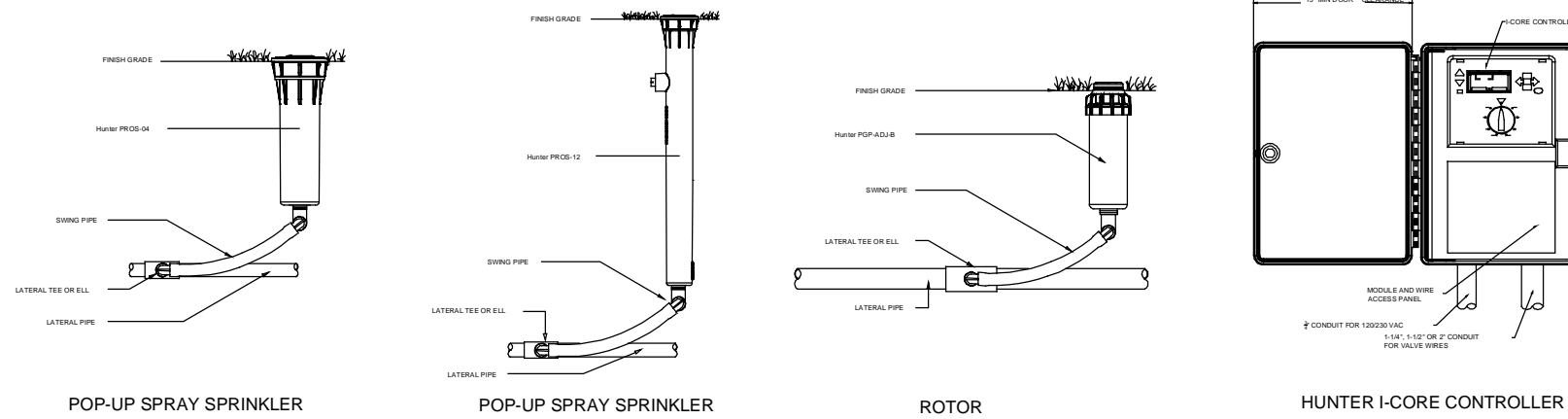

VALVE SCHEDULE

NUMBER	MODEL	SIZE	TYPE	GPM	HEADS	PIPE	DESIGN PSI	FRICTION LOSS	VALVE LOSS	PSI	PSI @ POC	PRECIP
1	Hunter PGV-151 Globe	1-1/2"	Turf Spray	28.01	37	470.0	30	4.02	3	37.02	37.86	1.45 in/h
2	Hunter PGV-151 Globe	1-1/2"	Shrub Spray	42.31	71	656.2	30	3.51	3.23	36.74	38.46	1.62 in/h
3	Hunter PGV-101G	1"	Turf Rotor	22.50	9	232.4	45	1.17	4	50.17	50.96	0.77 in/h
4	Hunter PGV-101G	1"	Bubbler	1.00	2	46.6	30	0.01	1.1	31.11	31.51	1.7 in/h
5	Hunter PGV-151 Globe	1-1/2"	Shrub Spray	59.56	54	666.3	30	3.34	4.96	38.3	42.95	1.56 in/h
6	Hunter PGV-151 Globe	1-1/2"	Turf Spray	58.97	101	936.5	30	3.74	4.9	38.63	43.39	1.34 in/h
7	Hunter PGV-151 Globe	1-1/2"	Shrub Spray	49.72	46	575.4	30	3.02	3.97	37.0	41.19	1.33 in/h
8	Hunter PGV-151 Globe	1-1/2"	Turf Spray	49.85	81	732.6	30	3.22	3.99	37.21	41.42	1.39 in/h
9	Hunter PGV-101G	1"	Shrub Spray	12.90	8	92.3	30	0.21	1.73	31.93	32.52	1.03 in/h
10	Hunter PGV-151 Globe	1-1/2"	Shrub Spray	50.44	39	457.6	30	2.31	4.04	36.35	40.54	1.56 in/h
11	Hunter PGV-151 Globe	1-1/2"	Turf Spray	55.08	60	581.7	30	1.97	4.51	36.47	41.53	1.59 in/h
12	Hunter PGV-151 Globe	1-1/2"	Turf Spray	58.50	55	717.6	30	2.88	4.85	37.73	43.87	1.56 in/h
13	Hunter PGV-151 Globe	1-1/2"	Shrub Spray	40.75	54	635.3	30	3.09	3.08	36.17	39.35	1.53 in/h
14	Hunter PGV-151 Globe	1-1/2"	Shrub Spray	49.31	41	440.2	30	2.01	3.93	35.94	40.03	1.43 in/h
15	Hunter PGV-151 Globe	1-1/2"	Shrub Spray	34.43	36	360.9	30	0.76	3	33.75	35.9	1.4 in/h
16	Hunter PGV-151 Globe	1-1/2"	Turf Spray	36.50	38	404.2	30	1.13	3	34.13	36.53	1.32 in/h
17	Hunter PGV-151 Globe	1-1/2"	Turf Spray	58.90	48	593.0	30	1.52	4.89	36.4	42.08	1.55 in/h
18	Hunter PGV-151 Globe	1-1/2"	Shrub Spray	57.30	71	688.2	30	2.81	4.73	37.54	42.76	1.54 in/h
19	Hunter PGV-151 Globe	1-1/2"	Turf Spray	58.39	48	602.4	30	1.54	4.84	36.38	41.62	1.52 in/h
20	Hunter PGV-151 Globe	1-1/2"	Shrub Spray	33.37	38	379.6	30	1.9	3	34.9	36.8	1.85 in/h
21	Hunter PGV-151 Globe	1-1/2"	Turf Spray	44.24	53	624.1	30	4.98	3.42	38.41	41.84	1.54 in/h
22	Hunter PGV-151 Globe	1-1/2"	Shrub Spray	33.71	43	496.8	30	4.79	3	37.79	39.88	1.63 in/h
23	Hunter PGV-151 Globe	1-1/2"	Turf Spray	53.80	52	640.0	30	4.12	4.38	38.5	42.43	1.49 in/h
24	Hunter PGV-151 Globe	1-1/2"	Shrub Spray	50.91	56	550.6	30	4.23	4.09	38.33	41.84	1.26 in/h
25	Hunter PGV-151 Globe	1-1/2"	Shrub Spray	34.26	41	408.6	30	3.07	3	36.07	37.76	1.1 in/h
26	Hunter PGV-151 Globe	1-1/2"	Turf Rotor	44.10	18	474.1	45	4.51	3.41	52.92	55.59	0.9 in/h
27	Hunter PGV-101G	1"	Bubbler	9.50	19	308.9	30	0.36	1.9	32.26	32.71	1.7 in/h

IRRIGATION SPECIFICATIONS

- IRRIGATION POINT OF CONNECTION SHALL BE CAPABLE OF DELIVERING A VARIABLE FLOW RATE OF 60 GPM AT A CONSTANT PRESSURE OF 70 PSI DOWNSTREAM OF BACKFLOW PREVENTION DEVICE. POINT OF CONNECTION SHALL BE ABLE TO MAINTAIN THE MAXIMUM FLOW RATE AND PRESSURE FOR THE DURATION OF AN IRRIGATION CYCLE. CONTRACTOR SHALL VERIFY THESE PARAMETERS PRIOR TO CONSTRUCTION, AND NOTIFY OWNER'S REPRESENTATIVE AND IRRIGATION CONSULTANT IF THEY CANNOT BE MET.
- IF THE POINT OF CONNECTION EXCEEDS THE ABOVE PRESSURE REQUIREMENTS, A PRESSURE REGULATOR SHALL BE INSTALLED AT THE OWNER'S EXPENSE. PRESSURE REGULATOR SHALL BE SET AT THE PRESSURE RECOMMENDED ABOVE.
- POWER FOR THE IRRIGATION CONTROLLER, PUMP AND OTHER ELECTRICAL COMPONENTS SHALL BE PROVIDED BY OTHER. CONTRACTOR SHALL VERIFY POWER AVAILABLE MEETS THE REQUIREMENTS OF THE COMPONENT'S MANUFACTURER. IF POWER AVAILABLE IS INADQUATE, CONTRACTOR SHALL NOTIFY THE OWNER'S REPRESENTATIVE PRIOR TO CONSTRUCTION.
- IRRIGATION SYSTEM IS DISPLAYED SCHEMATIC IN NATURE. MINOR FIELD ADJUSTMENTS MAY BE NECESSARY TO ACCOMMODATE FOR LANDSCAPING CHANGES, PLANTING BEDS OR OTHER OBSTRUCTIONS. THESE ADJUSTMENTS MAY BE MADE ONLY AFTER NOTIFYING THE OWNER'S REPRESENTATIVE.
- SOME IRRIGATION COMPONENTS AND PIPING ARE SHOWN IN HARDSCAPE AREAS AND OUTSIDE OF PROPERTY LINES TO IMPROVE ON THE READABILITY OF THE IRRIGATION PLAN. ALL COMPONENTS AND PIPING SHALL BE INSTALLED INSIDE OF THE PROPERTY LINES AND OUTSIDE OF HARDSCAPE AREAS.
- MAINLINE, LATERALS AND CONTROL WIRES SHALL BE INSTALLED INSIDE THE SAME TRENCH WHENEVER POSSIBLE..
- SYSTEM TO BE INSTALLED PER MANUFACTURER'S SPECIFICATIONS.
- CONTROLLER SHALL BE GROUNDED PER MANUFACTURER'S SPECIFICATIONS.
- ALL CONTROLLER/VALVE WIRE SHALL BE #14 GAUGE. THE COMMON WIRE SHALL BE COLORED WHITE, WHILE THE STATION WIRES SHALL BE OF AT LEAST ONE COLOR OTHER THAN WHITE.
- ALL FIELD WIRE ABOVE GRADE OR WITHIN STRUCTURE TO BE INSTALLED IN CONDUIT PER LOCAL CODE.
- ALL UNDERGROUND SPLICES TO UTILIZE 3M DBY, OR KING WATER PROOF SPLICE KITS, DEPENDING ON NUMBER AND SIZE OF WIRES. ALL SPLICES SHALL BE MADE INSIDE A VALVE BOX.
- DEPTH OF IRRIGATION PIPING; 18" ON MAINLINE; 12" ON LATERALS.
- SLEEVING UNDER PAVED AREAS SHALL BE INSTALLED AT A DEPTH OF 24".
- ALL NEW TREES AND PALMS SHALL HAVE BUBBLERS

CRITICAL ANALYSIS

Generated:

Pump 5 HP - SURFACE MOUNT
Water Source Information: 4" WELL - 120 GPM

FLOW AVAILABLE

Pump:
Flow Available: 120.00 gpm

PRESSURE AVAILABLE

Static Pressure at Pump: 70.00 PSI
Elevation Change: 5.00 ft
Service Line Size: 3"
Length of Service Line: 20 ft
Pressure Available: 68.00 psi

DESIGN ANALYSIS

Maximum Station Flow: 59.56 gpm
Flow Available at Pump: 120.00 gpm
Residual Flow Available: 60.44 gpm

Pressure Req. at Critical Station: 52.92 psi
Loss for Fittings: 0.10 psi
Loss for Main Line: 1.02 psi
Loss for Pump to Valve Elevation: 0.00 psi
Loss for Backflow: 0.00 psi
Loss for Pump: 1.55 psi
Critical Station Pressure at Pump: 55.59 psi
Pressure Available: 68.00 psi
Residual Pressure Available: 12.41 psi

NOTE TO CONTRACTOR:
THE FOLLOWING IRRIGATION INSPECTIONS ARE REQUIRED BY CITY:

- ROUGH
- SLEEVES
- MAINLINE PRESSURE TEST
- FINAL

IRRIGATION SYSTEM SHALL BE RUST-FREE. CONTRACTOR SHALL COORDINATE WITH OWNER FOR INSTALLATION OF A RUST INHIBITOR SYSTEM IF APPLICABLE TO THIS SITE. OWNERS TO SECURE A COMPANY TO PROVIDE ON-GOING SERVICES TO PROPERLY MAINTAIN THE RUST INHIBITOR SYSTEM.



REVISION	DATE
1	FDOT comments 4/17/24
2	COA comments 5/16/24

Lynn M Bender
Digitally signed by Lynn M Bender
Date: 2024.05.16 19:46:34 -0400



LBLA, Inc.
Landscape Architecture
5610 Adair Way
Lake Worth, FL 33467
Phone: 561-644-3237
LbenderLarch@gmail.com
FL-LA666715

ALL DRAWINGS, SPECIFICATIONS AND RELATED DOCUMENTS ARE THE COPYRIGHT PROPERTY OF THE LANDSCAPE ARCHITECT. MUST BE RETURNED UPON REQUEST. REPRODUCTION OF DRAWINGS, SPECIFICATIONS AND RELATED DOCUMENTS IN ANY OR WHOLE IS FORBIDDEN WITHOUT THE LANDSCAPE ARCHITECT'S WRITTEN PERMISSION.
CONTRACTOR MUST CHECK AND VERIFY ALL DIMENSIONS AND FIELD CONDITIONS AND NOTIFY LA ARCHITECT &/OR ENGINEER IMMEDIATELY OF ANY DISCREPANCIES.

COCONUT CREEK MAZDA
3757 CORAL TREE CIRCLE
COCONUT CREEK, FLORIDA 33073
FDOT - SR 834 & SIDEWALK EASEMENT
IRRIGATION, DETAILS & SPECIFICATIONS



PROJECT NO. 20-569
CADD I.D. MAZDA LP
DRAWN BY: LMB
CHECKED BY: LMB
SCALE: N.T.S.
DATE: 08-04-2021

SHEET:
IR-DETAILS
MOA Page 16 of 18
8 OF 8 SHEETS

RESOLUTION NO. 2024-130

A RESOLUTION OF THE CITY COMMISSION OF THE CITY OF COCONUT CREEK, FLORIDA, AUTHORIZING THE CITY MANAGER, OR DESIGNEE, TO EXECUTE AMENDMENT NUMBER NINE (9) TO THE STATE OF FLORIDA DEPARTMENT OF TRANSPORTATION (FDOT) DISTRICT FOUR LANDSCAPE INCLUSIVE MAINTENANCE MEMORANDUM OF AGREEMENT FOR THE PURPOSE OF MAINTAINING SIDEWALKS, LANDSCAPING, AND OTHER IMPROVEMENTS WITHIN THE RIGHT-OF-WAY OF SAMPLE ROAD (STATE ROAD 834) RELATED TO THE MAZDA DEVELOPMENT PROJECT; PROVIDING FOR SEVERABILITY; AND PROVIDING AN EFFECTIVE DATE.

State of Florida
County of Broward
City of Coconut Creek
I HEREBY CERTIFY that this is a true and correct copy of Resolution 2024-130
Witness my hand and the Official Seal of The City of Coconut Creek this 30 day of September 2024
Joseph J. Kavanagh, City Clerk

WHEREAS, on October 14, 2021, Pompano Autoplex, LLC received site plan approval from the City for the design and construction of the Mazda automobile dealership located at 4101 West Sample Road; and

WHEREAS, a portion of the Mazda Development Project improvements, including, but not limited to, sidewalks, landscaping, and a bus rider shelter, will be constructed within the Florida Department of Transportation (FDOT) property and/or right-of-way; and

WHEREAS, the City of Coconut Creek recognizes the need to amend an existing FDOT Landscape Inclusive Maintenance Memorandum of Agreement (MMOA), designating and setting forth maintenance responsibilities related to these improvements; and

WHEREAS, it shall be the responsibility of the City of Coconut Creek to maintain or coordinate the maintenance of the improvements after the project's completion; and

WHEREAS, said maintenance responsibilities will be reassigned to Pompano Autoplex, LLC by separate resolution and agreement.

NOW, THEREFORE, BE IT RESOLVED BY THE CITY COMMISSION OF THE CITY OF COCONUT CREEK, FLORIDA:

Section 1: That the foregoing "WHEREAS" clauses are hereby ratified and confirmed as being true and correct and are hereby made a specific part of this resolution. All exhibits attached hereto are incorporated herein and made a specific part of this resolution.

Section 2: That the City Commission hereby accepts the future budgeting and funding resources projected to be necessary for maintenance contingency and supports the mobility project as it relates to the Mazda Development Project.

Section 3: That City Manager, or designee, is hereby authorized to execute Amendment Number Nine (9) to the FDOT District Four Landscape Inclusive Maintenance Memorandum of Agreement between FDOT and the City, designating maintenance responsibilities for the Sample Road right-of-way improvements related to the Mazda Development Project.

Section 4: That if any clause, section, other part or application of this resolution is held by any court of competent jurisdiction to be unconstitutional or invalid, in part or in application, it shall not affect the validity of the remaining portion or applications of this resolution.

Section 5: That this resolution shall be in full force and effect immediately upon its adoption.

Adopted this 26th day of September, 2024.

Sandra L. Welch, Mayor

Attest:

Joseph J. Kavanagh, City Clerk

Welch Aye
Railey Aye
Rydell Aye
Brodie Aye
Wasserman Aye