

Coming Soon 2017



Residence Inn[®] Marriott[®]

Another Quality Morlin Hospitality Project



305-254-8000



STATE ROAD 7 (441)

NW 61 ST STREET

~~N01°03'50"W 380.03' (P)~~
~~N01°03'50"W 380.03' (F)~~

Diagram illustrating a 120° angle with a radius of 8'-0". A label "SIGN LOCATION" points to the vertex of the angle.

~~N89°36'22"E 703.34' (P)~~
~~N89°30'06"E 703.93' (F)~~

(FUTURE DEVELOPMENT)

SITE PLAN ENLARGEMENT

NTS



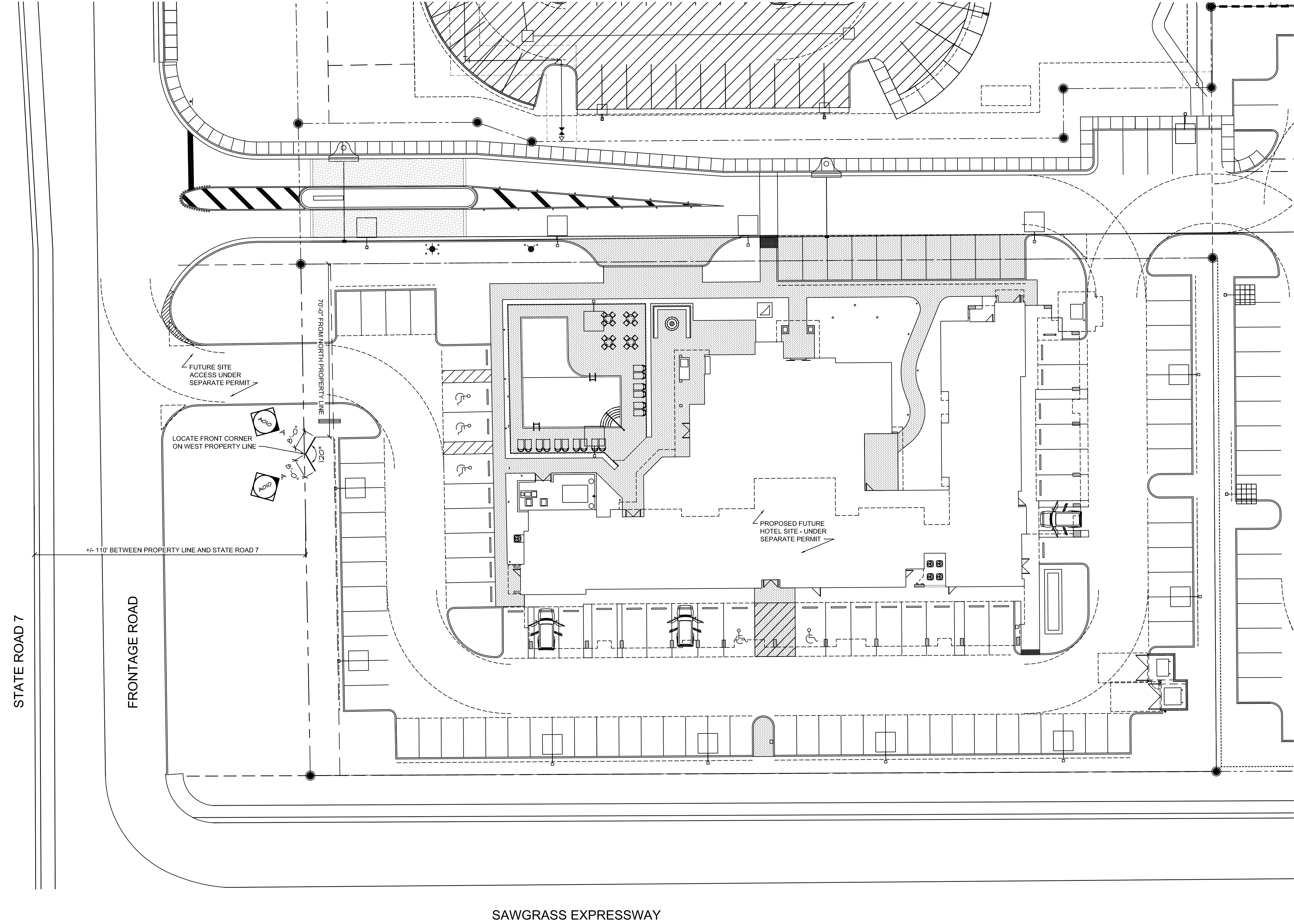

ENLARGED SITE PLAN
1'-0" = 20'

LOCATION MAP
NOT TO SCALE

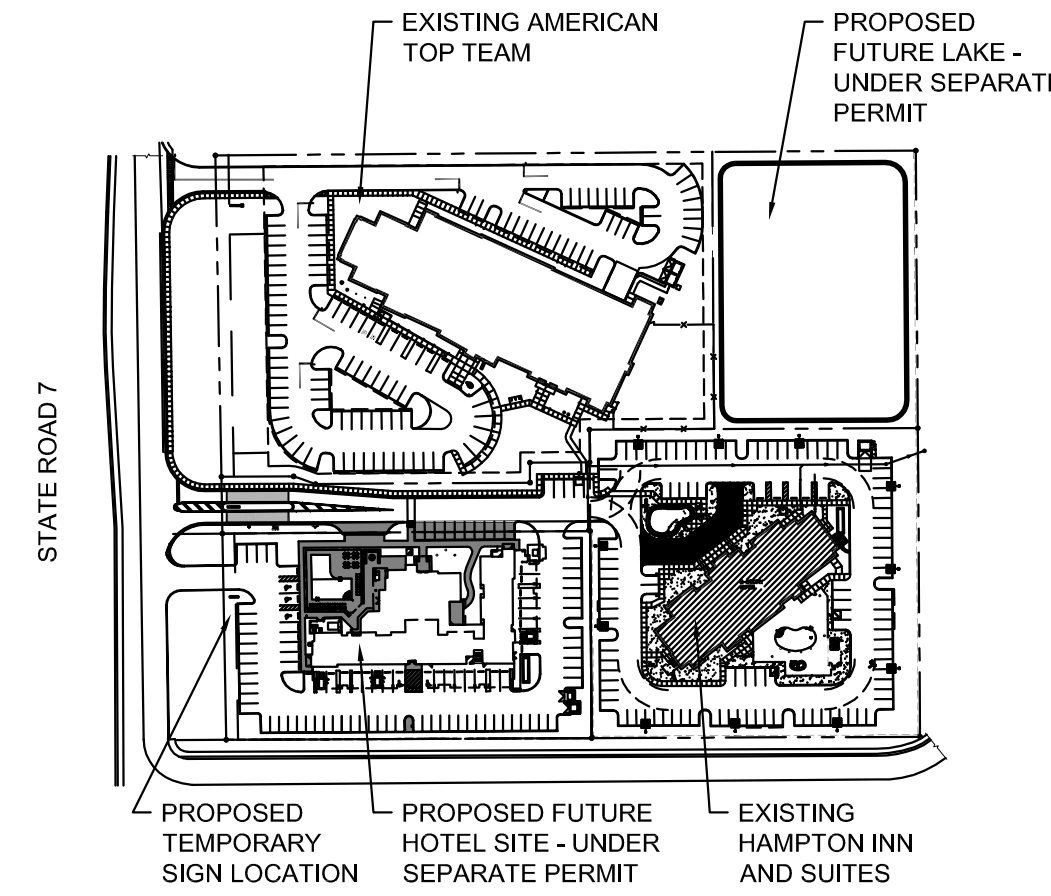

SITE KEY
NOT TO SCALE

SIGNAGE NOTES:

PROPOSED FREESTANDING V-SHAPED SIGN WITHIN THE PROPERTY BOUNDARIES FOR THE PROPOSED HOTEL PROJECT (UNDER SEPARATE PERMIT). SIGN TO BE CONSTRUCTED WITH (3) 4X4 POSTS, WITH LAMINATED SIGNAGE MATERIAL TO BE FASTENED AND AS REQUIRED.

DUE TO THE REMOTE LOCATION OF TARGET STREET STATE ROAD 7, THE APPLICATION FOR SIGNAGE DEVIATION INCLUDES REQUESTS FOR RELIEF ON THE FOLLOWING REQUIREMENTS:

- SECTION 13-469.1.b.3.a. : INCREASE OF ONE SIGN PER FRONTAGE ROAD TO A SINGLE SIGN WITH TWO SIDES FACING FRONTAGE ROAD
- SECTION 13-469.1.b.3.a. : INCREASE OF PERMITTED 32 SF PER SIGN TO 64 SF (EXCLUDING 24" POST HEIGHT), PER SIGN FACE.
- SECTION 13-469.1.b.3.a. : INCREASE OF PERMITTED 6'-0" SIGN HEIGHT TO 10' AS SHOWN IN ELEVATION A/A010.
- SECTION 13-469.e : REQUIRED SETBACK OF A GROUND IDENTIFICATION SIGN (13-466.6.a.4.a) IS 5'-0", PROPOSED SETBACK IS 0'-0"

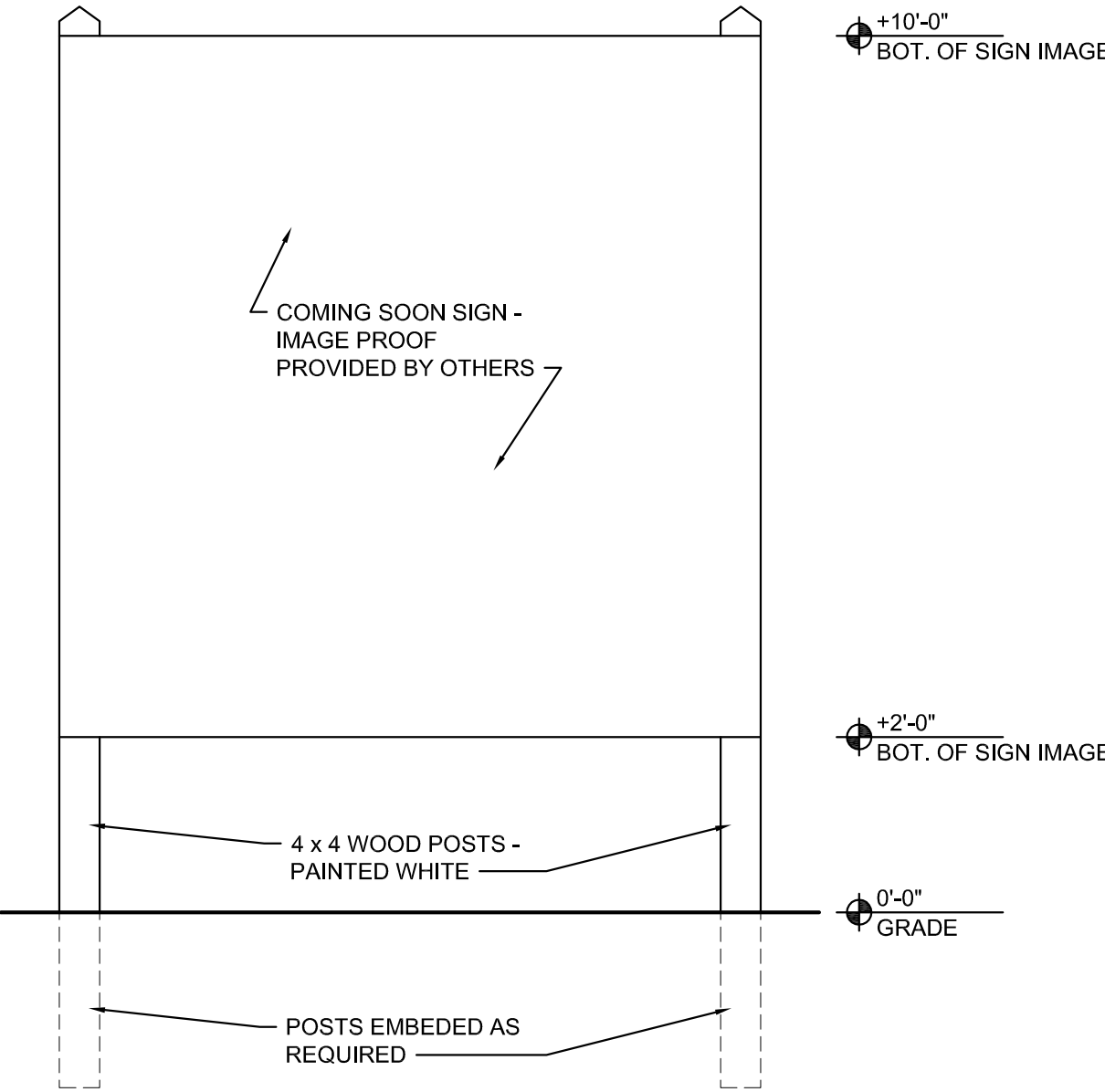

SIGNAGE ELEVATION
1/2" = 1'-0"

anderson
architecture, inc.

399 CAMINO GARDENS BLVD.
SUITE 202
BOCA RATON, FLORIDA 33432
V: 561.362.0220
www.andersonarchitecture.com

consultant:

ERIC ANDERSON
AR0010628
eric anderson

A Site Plan for:
**Proposed Temporary Sign
Grove Parc PCD**
State Road 7
Coconut Creek, Florida

revision:	
date:	
commission:	14-030
principal:	ERIC ANDERSON
project manager:	SB
file name:	4030-LAKE-010-SP
date:	08.09.16
title:	SITE PLAN

010

of: 1 A

AA C001997