

PlayCore Wisconsin, Inc., d/b/a GameTime
150 PlayCore Drive, SE
Fort Payne, Alabama 35967
Direct telephone: 423/648-5891
Direct facsimile: 423/648-5903
Website: <http://www.gametime.com>



7-23-21

City of Coconut Creek
4800 W. Copans Road
Coconut Creek, FL. 33063

EXECUTIVE SUMMARY AND PROJECT OVERVIEW - REQUEST FOR PROPOSAL FOR COCO POINT PARK AND LAKEWOOD PARK PLAYGROUNDS

The GameTime Division of PlayCore Wisconsin, Inc., a wholly-owned subsidiary of PCH Holdings, Inc., acting in collaboration with Dominica Recreation, Inc. and D.W Recreation Services. is pleased to submit the accompanying proposal to manufacture, furnish and install GameTime Playground equipment in accordance with the terms and conditions of RFP# 07-28-21-11

As demonstrated by the accompanying references, GameTime is fully qualified to provide design, equipment, certified staff and supervision services to meet the requirements to build for City of Coconut Creek.

GameTime has been manufacturing commercial playground apparatus continuously since 1929. The GameTime Division is a vertically integrated company with extensive design, manufacturing, distribution and installation capabilities. With 400,000 sq. ft. under roof on an 81-acre facility devoted solely to the manufacture of playground equipment, GameTime is well equipped to handle orders of any size. Seasonal weekly production can exceed \$4,850,000. The daily inventory often exceeds \$6,000,000. GameTime does all metal fabrication, rotationally molded plastic, PVC coating and powder coating "in-house". GameTime is an ISO 9001:2008 and 14001:2004 Certified facility. Once an order is entered and accepted, GameTime is in a position to deliver equipment within 55 to 60 days.

GameTime currently employs 425 people at its Fort Payne facility in the design and manufacture of commercial playground and recreation equipment. Our staff includes five industrial designers, four product managers, three structural engineers, and ten CAD operators in our product development, design and processing groups. GameTime office staff total 129. Additionally, we collaborate with a number of consultants in key areas. GameTime products are distributed in the United States by a

network of 13 domestic independent sales organizations employing 127 sales and 98 support personnel. Seventeen international distributors market GameTime products worldwide.

Dominica Recreation, Inc. (DRP), the exclusive GameTime regional sales representative in Florida. Their offices are located at 632 Florida Central Parkway, Longwood, FL. Rob Dominica, President of DRP will be providing all pre-sale, post-sale, on-site service and project management. Representing GameTime since 1968, the DRP organization is well versed in all aspects of playground sales and support from creating site and client-specific ASTM, CPSC and ADA-compliant play area designs utilizing GameTime's proprietary GTCad software; managing professional turnkey installations employing the DRP Five Star Plus Certified Installation process; coordinating manufacturing and installation scheduling; contract administration; and providing technical support for field service and replacement parts. The DRP Group attend "GT College" annually and seminars throughout the year to learn the latest in product improvements and new design, computer technology, safety compliance, risk management, installation techniques, ADA requirements, and related topics. DRP employs NPSI certified playground safety inspectors (CPSI); provides local on-site playground design services; furnishes CPSI safety audits; equipment selection consultations; safety surfacing materials; and installation by "factory-certified" installers for complete "turnkey" packages. Please see more about DRP in Section C of proposal.

GameTime installation-supervision services will be provided by DW Recreation Services, a GameTime factory-certified installer headed by Donald West, who has more than 20-years' experience in the playground industry. DW Recreation Inc has installed thousands of playgrounds in South Florida. Operating five fully equipped installation crews, DW Recreation is in a position to maintain tight scheduling.

We submit this as verification GameTime is financially sound, experienced, and well positioned to provide A full-solution, total turnkey package for playground equipment. Should further financial particulars On PlayCore be necessary, kindly contact Ms. Joni Manley, Vice President Finance, 423-648-5890.

GAMETIME DIVISION

A handwritten signature in black ink, appearing to read "D. R. King", with a long horizontal flourish extending to the right.

Donald R. King
Director of Sales Administration

PlayCore Wisconsin, Inc., d/b/a GameTime

150 PlayCore Drive, SE

Fort Payne, Alabama 35967

Direct telephone: 423/648-5891

Direct facsimile: 423/648-5903

Website: <http://www.gametime.com>

1. METHODOLOGY

D. Staffing Plan

D.W Recreation Services

1. Supervisor of Installation Crew – Donald West. Donald has supervised the installation of thousands of playground projects in south Florida over the past 20 years. D.W Recreation Services, Inc, Donald West, holds his GC license and is a certified GameTime Installer for the state of Florida. Donald also holds his CPSA Certification. D.W Recreation has 5 installation crews and all are directly managed by Donald and our supervisor Dave Cirillo who has been with D.W Recreation for the past 12 years.

Dominica Recreation, Inc. (DRP):

1. Rob Dominica, Agency Principal, would be responsible for communicating with GameTime and the client regarding Contract matters. Rob is the second generation Principal of DRP and has spent his career in the playground industry. He is a graduate of Stetson University with an MBA in Marketing. Rob is a member of the ASTM Committee on Public Playground Equipment and is a CPSI Certified Playground Safety Inspector. Rob also serves on the GameTime Field Advisory Board.

2. DRP Project Support Staff:

- Gina Wilson: Agency Vice President
- Rob Wilson: Field Sales Manager
- Roy May: Project Field Sales Liaison
- Gina Wilson: Project Manager
- JoEllen Green: Project Contract Administrator
- Pat Duberke: Project Support Specialist/Customer Service

GameTime Division

1. Spencer Cheak, Senior Vice President and General Manager, responsible for all aspects of the GameTime business unit as well as all operational issues at the GameTime facility in Fort Payne, Alabama. Spencer has been employed at GameTime since 1999.
2. Bob Barron, Senior Vice President of Sales, responsible for managing all field sales activities, sales force management, and sales support. Employed with GameTime since 2002, Bob has been in the commercial play industry for 25 years and was formerly Vice President of Global Sales for Little Tikes Commercial Play Systems.
3. Clint Whiteside, Director of Sales Operations, responsible for special projects and contracts, product pricing activities, manages international sales.

I. Quality Program Objectives

GameTime's main goal is to meet or exceed customer expectations. In order to do so, we strive for professionalism, a high standard of workmanship, and integrity.

The Project consists of excavation and drainage work, installation of play equipment, installation of concrete curbing and pads, and installation of stone sub base and wood fiber surfacing. Throughout the Project, we will strive to meet these goals of professionalism, a high quality product, and demonstrate the work ethic and integrity of our company.

II. Quality Management Organization

To ensure that we meet the objectives and all of our customer's needs, we begin by placing qualified and ethical professionals on site.

Project Manager

- Liaison between GameTime and client
- Certified with the National Recreation and Park Association as a Certified Playground Safety Inspector
- Schedules installers on a daily basis
- Manages Lead Installer
- Responsible for quality inspections
- Responsible for Project completion in timely manner
- Responsible for the safety of themselves and others

Lead Installer

- Reports to PM daily
- Manages installers
- Supports PM with quality inspections
- Supports PM with Project completion in timely manner
- Knowledge of rules and regulations pertaining to playground Installations
- Ability to operate a skid steer
- Responsible for job site safety
- Responsible for vehicle and tool upkeep
- Responsible for the safety of themselves and others

Installer

- Reports to Lead Installer
- Responsible for job site cleanliness
- Basic mechanical skills
- Responsible for the safety of themselves and others

III. Process Implementation

All processes are driven by the goals of the Quality Program. This is maintained by the professional, competent installers who are responsible for the Project. This crew will set forth milestones and will review the success of each milestone as it is reached before moving on to the following milestone. This includes a weekly meeting of all installers to review the Quality Program in relation to this Project and looking at various aspects such as performance and the product.

The main goal during this process is to maintain communication among everyone involved. In order to do so, we implement the following meetings/reviews:

- Pre-Construction meeting Construction begins
- Daily Toolbox meetings Weekly meetings
- Final Completion
- Post Construction Review

IV. Quality Program Inspection

GameTime wants to ensure that all work meets or exceeds the specifications of the contract. The Project Manager is a Certified Playground Safety Installer and will do a walk through and inspection at completion of the Project. The PM will verify that all playground equipment was installed according to manufacturer's guidelines and meets ASTM and CPSC standards. The PM will ensure that the final product of installation of play equipment and surfacing meets GameTime's Quality Program goals and, most importantly, is satisfactory to the customer.

City of Coconut Creek Coco Point & Lakewood Park

Proposal from
GameTime/Dominica Recreation Products
P.O. Box 520700
Longwood, FL 32752-0700
800-432-0162 - drp@gametime.com

Compliance Guarantee –

| | |
|---|------------------|
| IPEMA Certified Playground Components | Certified |
| Complies to ASTM F 1487-17 | Complies |
| Complies to U.S. CPSC | Complies |
| Complies with CPSIA | Complies |
| Complies to ADA requirements as of March 15, 2012 | Complies |
| Manufacturer meets ISO9001 Certification | Certified |
| Manufacturer meets ISO14001 Green Certification | Certified |
| Manufacturer meets PCI4000 Paint Certification | Certified |
| Made in USA Certified | Certified |
| Designer/Engineer NPSI Certified | Certified |
| Installer NPSI Certified | Certified |
| Installer Factory Trained & Certified | Certified |
| Surfacing Meets all ASTM HIC Criteria | Certified |
| Surfacing Meets ADA requirements | Certified |
| Years Dominica Recreation Products has represented GameTime | 53 Years |

Other Notes –

| | |
|---------------------|---|
| Upright Size | 3.5" Aluminum & Steel (Swing Frame larger) |
| Connections | ALL Factory Installed Bolt Thru Connections (no exposed hardware) |
| Finished Grade | Stickers applied at the factory, not applied at installer discretion |
| Hardware | Stainless Steel |
| Primer | Zinc Rich Primer applied to all painted surfaces |
| Warranty | Equal or better to ALL manufacturers, if you find better, we will match |
| Liability Insurance | \$51 Million written on the preferred - Each Occurrence |
| One Company | All equipment, surfacing, borders are from GAMETIME |

Installation Notes and Time Frame –

Our installer will adhere to the Five Star Plus Installation Program; this guarantees a consistent installation that is documented and verifiable with you. Please note: the time it takes to manufacture this equipment is approx. 45 days from receipt of all order paper work. We would anticipate the onsite installation time frame is about 2-3 weeks at each site. Which a lot of the work can be handled simultaneously. Considering scarcity of materials and shipping issues, we believe 150 days is a fair and reasonable construction time frame! We will not remove the existing equipment until ready to install the new equipment.

BONUS OFFER – A GameTime Certified Installer will return after 90 days to inspect, touch up, clean, and address any issues. This is like having an inspection done for you at no charge.

Warranty –

GameTime has the leading warranty in the industry: Lifetime on Posts & Hardware, 15 Years on Decks and Plastics.

We are confident our warranty is one of the best you will find, but if it is not equal to a company that provided a bid and that is a determining factor, GameTime will match that published warranty's time and extent, so you can be sure you are getting the BEST warranty available.

Special Installation Warranty –

GameTime Certified Installer will provide a **3 Year Labor Warranty!** This is 300% more than all other companies. So no matter what the issue, for 3 years, GameTime and its installers will address and fix any issue at no cost to you.

Questions –

If you have questions or need additional information, do not hesitate to call. We welcome the opportunity to help you get exactly what you want or need.

If you require a sales professional to walk the site with you in person please call -

Roy May – 800-432-0162 roym@gametime.com

For questions about anything else, do not hesitate to contact the owner of the company

Rob Dominica 800-432-0162 ext. 113 robd@gametime.com

NPSI Certified* *ASTM Committee Member* *IPEMA Member* *ADA Design Consultant Certified

GameTime Warranty Coverage



Play Systems and Play Products

- ◆ Lifetime limited warranty on PowerScape®, PrimeTime®, Xscape®, IONiX®, and Modern City® uprights.
- ◆ Lifetime limited warranty on all hardware.
- ◆ Lifetime limited warranty on GameTime PowerScape Tru-Loc® connections.
- ◆ Lifetime limited warranty on IONiX®, PrimeTime® and Xscape® bolt-through connections.
- ◆ Fifteen-Year limited warranty on metal decks, pipes, rungs, rails, loop, braces, and footbucks.
- ◆ Fifteen-Year limited warranty on rotationally molded products.
- ◆ Twenty-Year limited warranty on Timber Decor® & Timbers recycled plastic lumber.
- ◆ Five-Year limited warranty on nylon-covered cable net climbers and components.
- ◆ Five-Year limited warranty on HDPE panels.
- ◆ Ten-Year limited warranty on pressure-treated pine and redwood products.
- ◆ Ten-Year limited warranty on site furnishings.
- ◆ Ten-Year limited warranty on integrated GTShade® products.
- ◆ Ten-Year limited warranty on iberglass and DHPL signage.
- ◆ Five-Year limited warranty on Super Seats™.
- ◆ Three-Year limited warranty on SaddleMates® rubber and “C”-springs. One-Year limited warranty on all other GameTime products.
- ◆ Three-Year limited warranty on Hand Sanitizer Lockbox

Fitness Products and Challenge Course

- ◆ Lifetime limited warranty on all hardware
- ◆ Ten-Year limited warranty on stationary GTit, Thrive, and Challenge Course posts, bars, welds and metal accessories (excluding cycle parts)
- ◆ Ten-Year limited warranty on HPL Instructional Signage Five-Year limited warranty on Net Climbers
- ◆ Five-Year limited warranty on rotationally-molded components
- ◆ Five-Year limited warranty on stainless damper module and aluminum cycle cover
- ◆ Five-Year limited warranty on HDPE panels.
- ◆ Two-Year limited warranty on bearings, damper, plastics, rubber parts and some cycle parts, including pedal and shaft
- ◆ One-Year limited warranty on Challenge Course timing systems (requires GTImpax surfacing)
- ◆ One-Year limited warranty on Recumbent Cycle belt (excludes cosmetic damage or defects)



Custom and Themed Products

- Five-Year limited warranty on glass fiber reinforced concrete (GFRC) PlayWorx® structures
- Five-Year limited warranty on glass fiber reinforced polymer (GFRP) TuffForms® sculptures
- Five-Year limited warranty on custom-routed HDPE panels.



VistaRopeProducts

- Lifetime Warranty Uprights and hardware, excluding cosmetic damages or defects
- 15 Year Limited Warranty on Punched Steel, Pipes, Rails, Loops and Rungs
- 15 Year Limited Warranty on Rotomolded Polyethylene Components 15 year limited warranty on nylon bearings and ring junction pieces excluding cosmetic damages or defects
- 10 year limited warranty on cable breakage, excluding cosmetic damages or defects
- 5 year limited warranty on rubber seat and rubber mats for net events, excluding cosmetic damages or defects
- 5 year limited warranty on premature wear of nylon cables, excluding cosmetic damages or defects

GeneralWarrantyDetails

For the purpose of this warranty, "lifetime" encompasses no specific term of years, but rather that seller warrants to its original customer for as long as the original customer owns the product and uses the product for its intended purpose that the product and all its parts will be free from defects in material and manufacturing workmanship.

All warranties specifically exclude damage caused by vandalism; negligence, improper installation or improper use; changes in appearance resulting from weathering; scratches, dents or marring as a result of use. Warranty valid only if products are installed and maintained in accordance with GameTime instructions and use approved parts.



GameTime Executive Summary

Our Mission

The GameTime mission is to be the global leader in the commercial park and playground market using its rotational molding capabilities, design engineering and manufacturing, new product innovation, dedicated employees, and outstanding "customer focused service". At GameTime, we understand our most important customers are children. We take our commitment to develop imaginative, safer and more accessible playgrounds seriously. We recognize the best play experience combines innovative and compliant equipment that engages children in physically and mentally stimulating activities. Products are developed to educate, challenge, stimulate and entertain the mind while providing opportunities for very active through somewhat passive physical play.

Industry Leadership

As the market leader in school and park playground equipment sales with 18.5% share, GameTime is differentiated by its unique and innovative products, price competitiveness, manufacturing quality and network of professional field representatives. Superior rotomold capabilities, an experienced and stable workforce, increasing manufacturing efficiencies and throughput, continuing process redesign, effective quality control, state-of-the-art facility and equipment, coupled with the fastest shipping cycle in the industry, result in lower prices and on-time deliveries of premium products.

GameTime is honored to have many repeat customers and has established longstanding supply relationships with the New York Housing Authority, New York Department of Parks, Chicago Public Building Commission, San Diego Unified School District, Baltimore County Recreation and Parks, Toronto District School Board, ARAMCO (Saudi Arabia), and others. GameTime is a vendor to the Federal Government under General Services Administration (GSA) contract GS-07F-0397K.

Innovation

With over 300 composite structure components, product innovation is a key GameTime strength. For example, our *BigFoot Slide* offers three different sliding experiences; our one-piece eight-foot high super-wide *RockSlide* spiral slide with natural rock-like texture on the slide and hood; our *Accessible Dragon* combines fantasy with accessibility; our *MegaRock Climber* provides realistic rock climbing and an underside cave experience complete with wall fossil. See our 2008 Park and Playground Catalog for many more examples.

With our PowerScape® PowerLock™ connection systems, the only factory installed "clamp" in the industry, customers are assured of proper and "compliant" equipment installation at reduced

time and expense. No onsite measuring and drilling of uprights, and no guesswork where components attach. Our systems come easy to follow instructions and diagrams; we leave no margin for error like clamp-based systems do. GameTime introduced the Entry Archway to reduce inadvertent falls while allowing access to the structure; now an ASTM industry requirement. GameTime decks bolt directly into the supporting upright using our exclusive vandal-resistant deck connection.

Manufacturing

GameTime is a vertically integrated company with extensive design, manufacturing and distribution capabilities. With 400,000 sq. ft. under roof on an 81-acre facility devoted solely to the manufacture of playground equipment, GameTime is well equipped to handle orders of any size. The company currently employs more than 445 employees in management, engineering and manufacturing roles. Seasonal weekly production can exceed \$2,750,000. The daily inventory of raw materials often is valued at approximately \$9,000,000. We do all metal fabrication, rotationally-molded plastic and powder coating "in-house". Once an order is entered and accepted, GameTime is in a position to deliver equipment to its customers within 30 to 45 days. Typically, GameTime operates on a 21-day production cycle, based on weekly manufacturing releases.

Product Specifications

Customers may choose between aluminum and galvanized steel supporting posts (uprights). Primary connecting hardware is of 304 stainless steel with button pin-in-head, torque-socket cap screws with a two-part epoxy locking patch added to the threads to reduce loosening resulting from vibration and use. Metal assemblies are MIG (metal inert gas) welded for maximum penetration and good structural integrity. See our full product specifications.

Paint finishes are applied electrostatically to a 3.0 – 5.0 mil thickness with a custom formula of TGIC polyester powder that is oven cured at 400 degrees for superior adhesion characteristics and maximum exterior durability and longevity. Prior to coating, all components are mechanically cleaned and washed in a six-stage bath system with an iron phosphate wash, a rust inhibitor, and sealer to prevent flash rusting before coating. Coatings are tested for hardness, adhesion and impact resistance in accordance with ASTM standards.

Rotationally-molded plastic products are produced of linear low-density polyethylene with UV-stabilized color and anti-static compound additives. GameTime has pioneered the manufacture of large, single-piece plastic parts. GameTime routinely inspects and tests its products at random for compliance with manufacturing tolerances and quality standards per ISO procedures.

Quality Assurance

As an ISO 9001/2000 certified (unconditionally) company, GameTime maintains a program of quality assurance and standardization in design control, development, production, installation and servicing in accordance with procedures by the International Organization for Standardization. GameTime's Quality Assurance Department inspects parts at random for compliance with manufacturing specifications and tolerances in accordance with ISO 9001/2000 procedures. Manufacturing

processes are carefully defined, documented and monitored to make possible the production of uniform, quality parts. Quality audits are performed daily to reduce manufacturing error. Special welding fixtures are used for each part to facilitate proper assembly and fitting. GameTime is ISO 9001/2000 certified, the most up-to-date certification possible.

Organizational Structure

GameTime employs 445 people at its Fort Payne facility devoted solely to the design, manufacture, and sales of commercial playground and recreation equipment. GameTime is a Division of Playcore of Wisconsin. A Wisconsin Corporation, In business since 1931. Federal ID number 39-1720480. GameTime works hand in hand with our exclusive sales agencies in managing the administration of contracts and services. Contract administration will be provided by Dominica Recreation Products, our sales representative. Their contact information is listed below:

Dominica Recreation Products-Registered agent since 1968
Attn: Rob Dominica
P.O. Box 520700
Longwood, FL 32752
Phone: 800-432-0162
Fax: 407-331-4720
Email: robd@gametime.com

Service Quality Program

Our experienced field sales representatives provide local on-site consultations and “in-house” design services by NPSI certified safety inspectors; provide supervision and installation services by GameTime “certified” installers, and coordinate equipment delivery with installation of equipment and safety surfacing. All GameTime Certified Installers provide the “Five Star Plus Installation” program which provides for initial contact, site readiness, confirmation of order, installation, customer approval, and a re-visit of the site within 90 days of completion. A copy of our Five Star Plus Installation commitment is attached.

GameTime’s response time to service calls is 3 business days for normal service calls, 1 business day for urgent service calls, and same day service for emergency service calls. Your service provider would be, D.W. Recreation Services, GameTime Certified Installer. Their contact information is listed below:

D.W. Recreation Services
Donald West and Candace West
9951 Equus Circle
Boynton Beach, FL. 33472
Office Phone: 561-818-4819
Office Fax: 561-433-0175
Email: dwest@dwrecreation.com

National Recreation and Park Association

Let it be known that

DONALD WEST

has met the requirements of the standards set forth by the
National Certification Board
and is hereby granted certification as a



**Certified
Playground
Safety Inspector**

CHAIRPERSON

March 10, 2020

DATE CERTIFIED

NRPA PRESIDENT AND CEO

48777-0423

CERTIFICATION NUMBER

April 01, 2023

EXPIRATION DATE

Management Team

Territory Sales Manager- **Roy May**: Having 14 years of commercial playground experience, Roy serves 5 counties in Southeast Florida for Dominica Recreation Products/GameTime. With an in-depth, consultative approach, Roy works directly with each project contact and conveys the vision, requirements, budget, and specifications with our project managers to create a design that is comprehensive and exciting.

Project Manager-President DRP-Registered Authorized Officer for all GameTime contract sales in Florida. **Rob Dominica**. Rob has been managing projects since 1995. Member of ASTM Committee on Public Playground Equipment and a NPSI certification holder. He will design and makes sure that all playgrounds are ADA compliant and that the design is done with the City's wishes and requirements in mind. He makes sure that the proper equipment is ordered and all drawings are complete and ready to submit for permitting.

Contract Administrator. **JoEllen Green**. Jo will help with all contract requirements including, Certificates of Insurance, building permit application, NOC. Being in contact with the city on any forms required for permits. Helping to coordinate from sales to installation.

Supervisor of Installation Crew- **Donald West**. Donald has supervised the installation of thousands of playground projects in South Florida over the past 20 years. D.W. Recreation Services, Inc, Donald West, holds his GC license and is a certified GameTime Installer for the state of Florida. Donald also holds his CPSI Certification. DW Recreation has 5 installation crews and all are directly managed by Donald and our supervisor Dave Cirillo who has been with D.W. Recreation for the past 12 years.



A PLAYCORE Company

grp **Dominica**
Recreation Products

Pasco County Parks & Recreation

4111 Land O Lakes Blvd. Land O Lakes, FL 34639

Katie MacMillen (P) 727-847-2411 (E) kmacmillen@pasccountyfl.net

Wesley Chapel Park—Installed November, 2019

\$ 324, 744. 00





A PLAYCORE Company

CRP **Dominica**
Recreation Products

City of Miami

444 SW 2nd Avenue 8th Floor, Miami, FL 33130

Tom Calautti Ph.:305-416-1253 E: tc Calautti@miamigov.com

Williams Park- Installed 2020 \$369,509.17





A PLAYCORE Company



City of Miami

444 SW 2nd Avenue 8th Floor, Miami, FL 33130

Tom Calautti Ph.:305-416-1253 E:

tcalautti@miamigov.com Bryan Park- Installed 2019

\$448,507.81

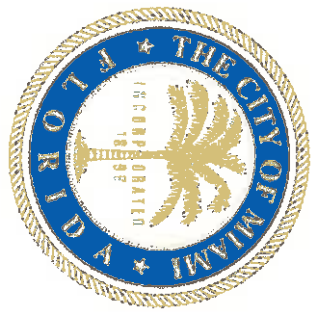



A PLAYCORE Company



City of Vero Beach

2266 14th Avenue Vero Beach, FL 32960

Patty Howard Ph: 772-567-2144

Troy Moody Park - Installed 06/29/2020 \$66,599.30





Playpalette: Jungle

7/23/21
Intellectual property of GameTime, a PlayCore Company. The site shown in rendering is an interpretation and may not reflect exact site conditions.

Coco Point Park

Coconut Creek, FL



www.gametime.com



www.playdrp.com



Playpalette: Jungle

Intellectual property of GameTime, a PlayCore Company. The site shown in rendering is an interpretation and may not reflect exact site conditions. 7/23/21

Coco Point Park Coconut Creek, FL



www.gametime.com



www.playdrp.com



Playpalette: Jungle

Intellectual property of GameTime, a PlayCore Company. The site shown in rendering is an interpretation and may not reflect exact site conditions. 7/23/21

Coco Point Park Coconut Creek, FL



www.gametime.com



www.playdrp.com



Playpalette: Jungle

7/23/21
Intellectual property of GameTime, a PlayCore Company. The site shown in rendering is an interpretation and may not reflect exact site conditions.

Coco Point Park Coconut Creek, FL



www.gametime.com



www.playdrp.com



Playpalette: Jungle

Intellectual property of GameTime, a PlayCore Company. The site shown in rendering is an interpretation and may not reflect exact site conditions. 7/23/21

Coco Point Park Coconut Creek, FL



www.gametime.com



www.playdrp.com



Playpalette: Jungle

Intellectual property of GameTime, a PlayCore Company. The site shown in rendering is an interpretation and may not reflect exact site conditions. 7/23/21

Coco Point Park Coconut Creek, FL

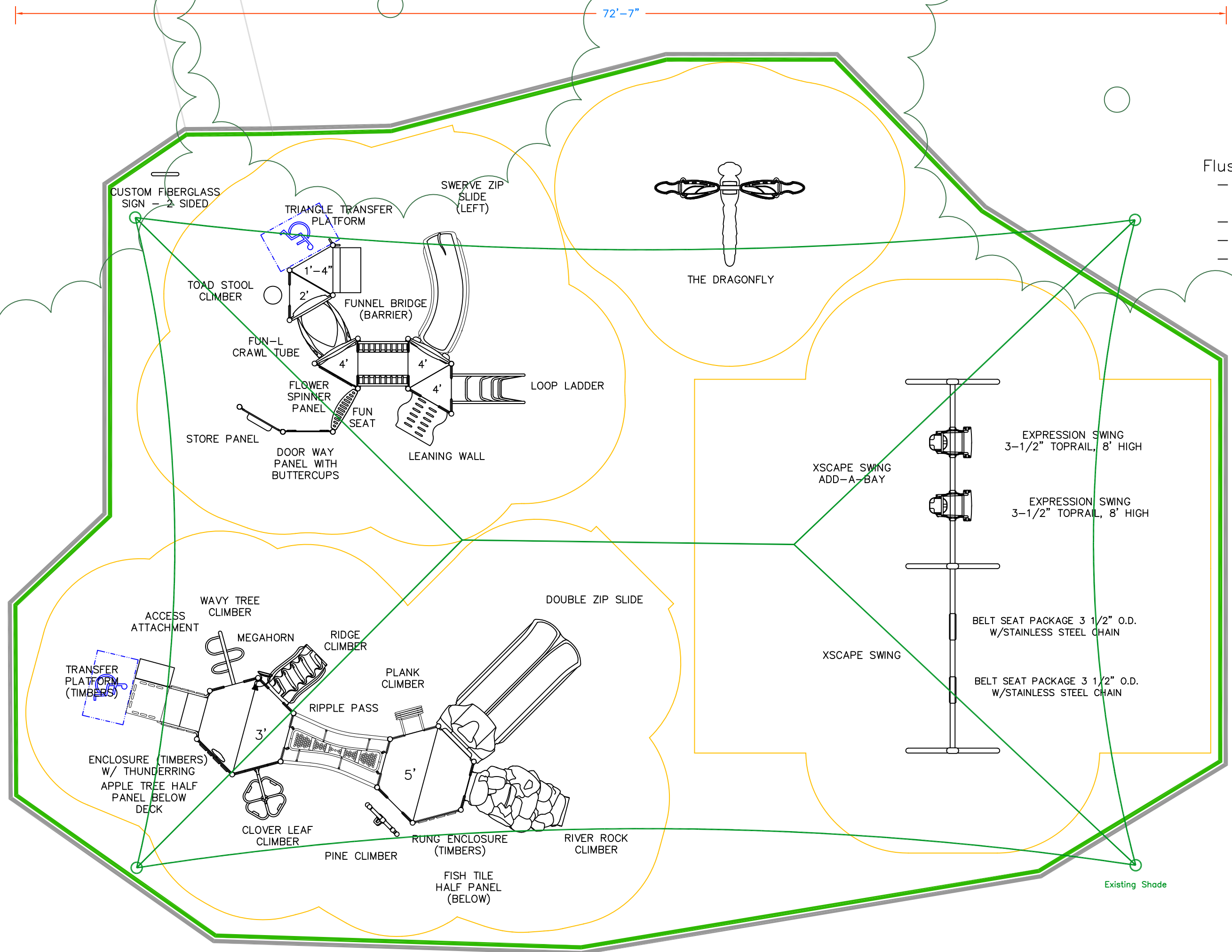

- Flush With Grade Installation
- Digout of area by installer
 - drainage not included
 - Concrete Curb
 - Crushed Stone Sub-base
 - Poured Rubber Surfacing
 - 50% Color / fall height as needed
 - includes designs

53'-9"

72'-7"

Existing Shade

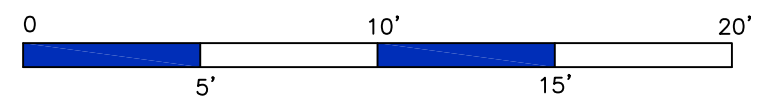

150 PlayCore Drive SE
 Fort Payne, AL 35967
www.gametime.com

Coco Point Park
 Coconut Creek, Florida

Representative
 Dominica Recreation Products

This play equipment is recommended for children ages 2-12

Minimum Area Required:
 Scale: 1" = 5'-0"
 This drawing can be scaled only when in an 18" x 24" format

IMPORTANT: Soft resilient surfacing should be placed in the use zones of all equipment, as specified for each type of equipment, and at depths to meet the critical fall heights as specified by the U.S. consumer Product Safety Commission, ASTM standard F 1487 and Canadian Standard CAN/CSA-Z-614

Drawn By: Rob
 Date: 7-22-21
 Drawing Name: Coco Point



GameTime
 c/o Dominica Recreation Products, Inc.
 P.O. Box 520700
 Longwood, FL 32752-0700
 800-432-0162 * 407-331-0101
 Fax: 407-331-4720
www.playdrp.com

07/23/2021
 Quote #102803-01-01

Coco Point Park

City of Coconut Creek
 Attn: Wayne Tobey
 1100 Lyons Road
 Coconut Creek, FL 33063
 Phone: 954-956-1580
wtobey@coconutcreek.net

Ship to Zip 33063

| Qty | Part # | Description | List \$ | Selling \$ | Ext. Selling \$ |
|------|---------|---|-------------|-------------|-----------------|
| 1 | INSTALL | 5-Star Plus - Removal of Existing Playground Equipment- <i>Includes disposal</i> | | \$4,000.00 | \$4,000.00 |
| 3200 | Digout | 5-Star Plus - Digout/Sitework of area (per sq. ft.) | | \$1.45 | \$4,640.00 |
| 1 | 178749 | GameTime - Owner's Kit | | \$60.00 | \$60.00 |
| 1 | RDU | GameTime - Two Playground Systems | \$50,431.00 | \$31,267.22 | \$31,267.22 |
| | | (3) 12009 -- 3 1/2" Uprt Ass'Y Alum 6' | | | |
| | | (2) 12023 -- 3 1/2" Uprt Ass'Y Alum 8' | | | |
| | | (5) 12024 -- 3 1/2" Uprt Ass'Y Alum 9' | | | |
| | | (10) 12025 -- 3 1/2" Uprt Ass'Y Alum 10' | | | |
| | | (6) 12026 -- 3 1/2" Uprt Ass'Y Alum 11' | | | |
| | | (1) 12421 -- Counter Panel | | | |
| | | (4) 18201 -- 36" Tri Punched Deck P/T | | | |
| | | (1) 18237 -- 3'-0" Funnel Bdg W/Barrier | | | |
| | | (1) 18337 -- 36" Tri Transfer Platform | | | |
| | | (1) 18680 -- Megahorn | | | |
| | | (1) 18766 -- Fun Seat 36" | | | |
| | | (1) 19035 -- Optional Access Step (3' & 5') | | | |
| | | (1) 19059 -- Wavy Tree (2'-6" & 3') | | | |
| | | (1) 19104 -- Ridge Climber | | | |
| | | (1) 19106 -- Clover Leaf (3' & 3'-6") | | | |
| | | (1) 19147 -- Toad Stool | | | |
| | | (1) 19172 -- Leaning Wall (4') | | | |
| | | (1) 19232 -- Loop Ladder (3'6" & 4') | | | |
| | | (1) 19287 -- River Rock Climber | | | |
| | | (2) 19289 -- Two Piece Hex Deck | | | |
| | | (1) 19362 -- 3'-6"/4'-0" Zip Swerve Slide Left | | | |
| | | (1) 19420 -- Fun-L Crawl Tube (Link) | | | |
| | | (1) 19453 -- Fish Tile Half Slide Below Dk | | | |
| | | (1) 19632 -- Transfer Platform (Timbers) 3' | | | |
| | | (1) 19635 -- Rung Enclosure (Timbers) | | | |
| | | (1) 19638 -- Plank Climber 5' | | | |
| | | (1) 19683 -- Pine Climber 5' | | | |



GameTime
 c/o Dominica Recreation Products, Inc.
 P.O. Box 520700
 Longwood, FL 32752-0700
 800-432-0162 * 407-331-0101
 Fax: 407-331-4720
www.playdrp.com

07/23/2021
 Quote #102803-01-01

Coco Point Park

| Qty | Part # | Description | List \$ | Selling \$ | Ext. Selling \$ |
|------|----------|--|-------------|---------------------------|---------------------|
| | | (1) 19704 -- Timbers Encl W/ Thunderring (Above) | | | |
| | | (1) 19793 -- Double Zip slide 5'-0" | | | |
| | | (1) 19807 -- Ripple Pass | | | |
| | | (1) 19832 -- Flower Spinner Panel | | | |
| | | (1) 19840 -- Apple Tree Half Panel | | | |
| | | (1) 19872 -- Door Way Panel with Buttercups | | | |
| 1 | 38000 | GameTime - The Dragonfly | \$5,230.00 | \$3,361.32 | \$3,361.32 |
| 1 | RDU | GameTime - Swing Frame | \$5,554.00 | \$4,715.16 | \$4,715.16 |
| | | (2) 5128 -- Expression Swing 3 1/2" X 8' | | | |
| | | (1) 26168 -- Xscape Swing 3 1/2" X 8' | | | |
| | | (1) 26169 -- Xscape Swing Add A Bay 3 1/2" X 8' | | | |
| | | (2) SS1483 -- Belt Seat 3 1/2"/8' & 10' High | | | |
| 1 | 5036 | GameTime - Custom Fiberglass Sign 2S | \$2,501.00 | \$1,607.39 | \$1,607.39 |
| 1 | INSTALL | 5-Star Plus - Five Star Plus Playground Installation Services- <i>Performed by a Certified Installer, includes meeting and unloading delivery truck, signed completion forms, site walkthrough, 90 day site revisit by installation foreman, and 3-Year Labor Warranty!</i> | \$18,300.00 | \$18,300.00 | \$18,300.00 |
| 220 | Curb | GT-Impax - Concrete Curb (ln. ft.)- 4" Wide - Not Reinforced | | \$31.50 | \$6,930.00 |
| 3200 | Crush | GT-Impax - Crushed & Compacted Stone Sub-Base (sq. ft.)- <i>Extra Thick to account for wood fiber sub-base. Installed per specification of Unitary Surfacing requirements. (note since existing surfacing is wood fiber, sub-base warranty only 2 year)</i> | | \$4.50 | \$14,400.00 |
| 3200 | Poured-8 | GT-Impax - Poured Rubber Surfacing - 8' fall height- 50% Standard Color - Aromatic Binder - 3.5" Thick with 1/2" EPDM wear course cap - 5-year warranty | \$18.87 | \$16.04 | \$51,328.00 |
| 1 | Custom | GT-Impax - Custom Designs in Poured Rubber | | \$3,000.00 | \$3,000.00 |
| 1 | INSTALL | 5-Star Plus - Signed/Sealed FBC 2020 7th Ed Building Code Drawings | | \$2,000.00 | \$2,000.00 |
| 1 | INSTALL | 5-Star Plus - Building Permits- <i>Estimated Costs of Permits running Time. If actual permit fees are significantly higher or lower, final invoice will be adjusted accordingly. Includes two visits to the permit office, if additional time spent acquiring permits, final invoice to be adjusted. Site Plans are to be provided by the owner for the permit application.</i> | | \$1,200.00 | \$1,200.00 |
| | | | | Sub Total | \$146,809.09 |
| | | | | Material Surcharge | \$8,954.44 |
| | | | | Freight | \$3,785.47 |
| | | | | Total | \$159,549.00 |

Comments

Note : Lead time for 2021 for all permitted projects is 150 days. (Hopefully the project goes faster, but with material allocations and scarcity, lead time on equipment shipment is greatly delayed)

This quote was prepared by Rob Dominica, President.
 For questions or to order please call - 800-432-0162 ext. 113 robd@gametime.com



GameTime
 c/o Dominica Recreation Products, Inc.
 P.O. Box 520700
 Longwood, FL 32752-0700
 800-432-0162 * 407-331-0101
 Fax: 407-331-4720
www.playdrp.com

07/23/2021
 Quote #102803-01-01

Coco Point Park

Permits are not included in cost, unless specifically listed in pricing. If permits are required Signed/Sealed drawings are usually needed and are also not included unless specifically listed in pricing. Any costs for municipal permits, paid by installer, will be charged back to the owner. Adding permits to any job will increase the length of completion, expect total time to be about **120 days**, after receipt of Site Plan from owner/customer (this is not due to manufacturing but rather the permit process at the municipality level). It is expected that the **owner will provide approved site plans** of the area for the permit office, and will help and assist in the securing of all required approvals before assembly of equipment can begin. Installer cannot provide site plans. The permit process can not begin until the site plans are available. If additional permitting requirements are needed during the process, those will be added and billed accordingly, i.e. soil density test, formed footers, etc.

Payment Terms: Governmental Purchase Order.

Purchases in excess of \$1,000.00 to be supported by your written purchase order made out to GameTime.

Net 30 days subject to approval by GameTime Credit Manager. A completed Credit Application and Bank Reference Authorization, must be received with the order. The decision on credit is the sole discretion of GameTime/PlayCore. A 1.5% per month finance charge will be imposed on all past due accounts.

Multiple Invoices: Invoices will be generated upon services rendered. When equipment ships it will be invoiced separately from installation and/or other services. Terms are Net 30 for each individual invoice.

This Quotation is subject to policies in the current GameTime Park and Playground Catalog and the following terms and conditions. Our quotation is based on shipment of all items at one time to a single destination, unless noted, and changes are subject to price adjustment.

Pricing: Firm for 60 days from date of quotation.

Shipment: F.O.B. factory, order shall ship within 45 days after GameTime's receipt and acceptance of your purchase order, color selections, approved submittals, and receipt of payment.

Taxes: State and local taxes will be added at time of invoicing, if not already included, unless a tax exempt certificate is provided at the time of order entry.

Exclusions: Unless specifically discussed, this quotation excludes all sitework and landscaping; removal of existing equipment; acceptance of equipment and off-loading; storage of goods prior to installation; security of equipment (on site and at night); equipment assembly and installation; safety surfacing; borders; drainage; signed/sealed drawings; or permits.

Installation Terms: Shall be by a Certified Installer. The installer is an independent installer and not part of PlayCore, GameTime, nor Dominica Recreation Products. If playground equipment, installer will be NPSI and Factory Trained and Certified. Unless otherwise noted, installation is based on a standard installation consistent with GameTime installation sheets and in suitable soil with a sub-base that will allow proper playground installation. Drainage is not part of our scope of work unless otherwise noted. Customer shall be responsible for scheduling and coordination with the installer. Site should be level and allow for unrestricted access of trucks and machinery. Customer shall also provide a staging and construction area. Installer not responsible for sod replacement or damage to access path and staging area. Customer shall be responsible for unknown conditions such as buried utilities, tree stumps, rock, or any concealed materials or conditions that may result in additional labor or material costs. Customer will be billed hourly or per job directly by the installer for any additional costs that were not previously included.

Unitary Surfacing Notes : The installer of the Unitary Surfacing (Poured, Bonded, Turf, Tiles) is not the same installer of the playground equipment. However, your certified equipment installer will coordinate the timing of the unitary surfacing installation, but more than likely they will not be on-site at the time. They will continue to be your contact should you have any questions. Security is needed to protect surfacing at night or after installation as the product set. Normally it is not needed or a concern, however in some areas additional security is needed to prevent vandalism. **Security is not included.** Vandalism will be the responsible of the owner.

Acceptance of quotation:

Accepted By (printed): _____

P.O. No: _____

Signature: _____

Date: _____

Title: _____

Phone: _____

E-Mail: _____

Purchase Amount: **\$159,549.00**



Decks: Brown
Plastic: Beige
Uprights: Blue
Accents: Bronze
Sails: Champagne

7/23/21
Intellectual property of GameTime, a PlayCore Company. The site shown in rendering is an interpretation and may not reflect exact site conditions.

Lakewood Park Coconut Creek, FL



www.gametime.com



www.playdrp.com



Decks: Brown
Plastic: Beige
Uprights: Blue
Accents: Bronze
Sails: Champagne

Intellectual property of GameTime, a PlayCore Company. The site shown in rendering is an interpretation and may not reflect exact site conditions. 7/23/21

Lakewood Park Coconut Creek, FL



www.gametime.com



www.playdrp.com



Decks: Brown
Plastic: Beige
Uprights: Blue
Accents: Bronze
Sails: Champagne

Intellectual property of GameTime, a PlayCore Company. The site shown in rendering is an interpretation and may not reflect exact site conditions.

7/23/21

Lakewood Park Coconut Creek, FL



www.gametime.com



www.playdrp.com



Decks: Brown
Plastic: Beige
Uprights: Blue
Accents: Bronze
Sails: Champagne

7/23/21
Intellectual property of GameTime, a PlayCore Company. The site shown in rendering is an interpretation and may not reflect exact site conditions.

Lakewood Park Coconut Creek, FL



www.gametime.com



www.playdrp.com



Decks: Brown
Plastic: Beige
Uprights: Blue
Accents: Bronze
Sails: Champagne

7/23/21
Intellectual property of GameTime, a PlayCore Company. The site shown in rendering is an interpretation and may not reflect exact site conditions.

Lakewood Park Coconut Creek, FL



Decks: Brown
Plastic: Beige
Uprights: Blue
Accents: Bronze
Sails: Champagne

Intellectual property of GameTime, a PlayCore Company. The site shown in rendering is an interpretation and may not reflect exact site conditions.

7/23/21

Lakewood Park Coconut Creek, FL



www.gametime.com



www.playdrp.com



GameTime
 c/o Dominica Recreation Products, Inc.
 P.O. Box 520700
 Longwood, FL 32752-0700
 800-432-0162 * 407-331-0101
 Fax: 407-331-4720
www.playdrp.com

07/23/2021
 Quote #102803-02-01

Lakewood Park

City of Coconut Creek
 Attn: Wayne Tobey
 1100 Lyons Road
 Coconut Creek, FL 33063
 Phone: 954-956-1580
wtobey@coconutcreek.net

Ship to Zip 33063

| Qty | Part # | Description | List \$ | Selling \$ | Ext. Selling \$ |
|------|---------|---|-------------|-------------|-----------------|
| 1 | INSTALL | 5-Star Plus - Removal of Existing Playground Equipment- <i>Includes disposal</i> | | \$3,500.00 | \$3,500.00 |
| 4000 | Digout | 5-Star Plus - Digout/Sitework of area (per sq. ft.) | | \$1.45 | \$5,800.00 |
| 1 | 178749 | GameTime - Owner's Kit | | \$60.00 | \$60.00 |
| 1 | RDU | GameTime - Two Playground Systems | \$64,203.00 | \$41,106.30 | \$41,106.30 |
| | | (2) 10768 -- Toad Stool Seat | | | |
| | | (1) 12023 -- 3 1/2" Uprt Ass'Y Alum 8' | | | |
| | | (14) 12025 -- 3 1/2" Uprt Ass'Y Alum 10' | | | |
| | | (1) 12026 -- 3 1/2" Uprt Ass'Y Alum 11' | | | |
| | | (6) 12027 -- 3 1/2" Uprt Ass'Y Alum 12' | | | |
| | | (1) 12055 -- Handhold Transfer | | | |
| | | (2) 12068 -- 3 1/2"Uprt Ass'Y Alum 13' | | | |
| | | (1) 12437 -- 12" Barrier | | | |
| | | (1) 12828 -- 1'6" Entrance Barrier | | | |
| | | (1) 12969 -- Telescope Upright Attachment | | | |
| | | (1) 18200 -- 36" Sq Punched Deck P/T 1.3125 | | | |
| | | (11) 18201 -- 36" Tri Punched Deck P/T | | | |
| | | (1) 18237 -- 3'-0" Funnel Bdg W/Barrier | | | |
| | | (1) 18337 -- 36" Tri Transfer Platform | | | |
| | | (1) 18680 -- Megahorn | | | |
| | | (1) 18766 -- Fun Seat 36" | | | |
| | | (1) 18774 -- Schooner Sail | | | |
| | | (1) 18775 -- Schooner Sail & Crows Nest | | | |
| | | (4) 18776 -- Schooner Panel 36" | | | |
| | | (1) 18778 -- Schooner Bow | | | |
| | | (1) 18807 -- Cannon Panel | | | |
| | | (1) 18808 -- Porthole Panel | | | |
| | | (1) 18809 -- Hatch Panel | | | |
| | | (1) 19014 -- Transfer Platform W/ Barrier (4') | | | |
| | | (1) 19036 -- Optional Access Step (4') | | | |
| | | (1) 19077 -- Arch (3'6" & 4') | | | |
| | | (1) 19102 -- Stepped Deck (6" Rise) | | | |



GameTime
 c/o Dominica Recreation Products, Inc.
 P.O. Box 520700
 Longwood, FL 32752-0700
 800-432-0162 * 407-331-0101
 Fax: 407-331-4720
www.playdrp.com

07/23/2021
 Quote #102803-02-01

Lakewood Park

| Qty | Part # | Description | List \$ | Selling \$ | Ext. Selling \$ |
|------|----------|--|-------------|-------------|-----------------|
| | | (1) 19104 -- Ridge Climber | | | |
| | | (1) 19216 -- Rung Enclosure W/ Thunderring | | | |
| | | (1) 19218 -- Bubble (4') | | | |
| | | (1) 19287 -- River Rock Climber | | | |
| | | (1) 19289 -- Two Piece Hex Deck | | | |
| | | (1) 19363 -- 3'-6"/4'-0" Zip Swerve Slide Right | | | |
| | | (1) 19484 -- 360 Spiral Slide 6' w/roto hood | | | |
| | | (1) 19636 -- Plank Climber 3' | | | |
| | | (1) 19749 -- Traverse Climber Link (2' rise) | | | |
| | | (2) 19768 -- Edge Climber Small | | | |
| | | (1) 19792 -- Double Zip slide 4'-0" | | | |
| | | (1) 19804 -- Splitter 6' | | | |
| | | (2) G12026 -- 3 1/2" Uprt Ass'Y Galv 11' | | | |
| 1 | RDU | GameTime - Swing Frame | \$3,588.00 | \$3,102.12 | \$3,102.12 |
| | | (1) 26168 -- Xscape Swing 3 1/2" X 8' | | | |
| | | (1) 26169 -- Xscape Swing Add A Bay 3 1/2" X 8' | | | |
| | | (2) SS1483 -- Belt Seat 3 1/2"/8' & 10' High | | | |
| | | (2) SS8696 -- Encl Tot Seat 3 1/2"/8' High W/Clevis | | | |
| 1 | 8475 | GameTime - Surfboard | \$6,713.00 | \$6,182.00 | \$6,182.00 |
| 1 | 6253 | GameTime - Wrinkle Wall (8 Panel) | \$15,887.00 | \$11,438.64 | \$11,438.64 |
| 1 | 5036 | GameTime - Custom Fiberglass Sign 2S | \$2,501.00 | \$1,646.16 | \$1,646.16 |
| 2 | 28021 | GT-Site - P/S Food Court Table S/M | \$2,129.00 | \$1,885.65 | \$3,771.30 |
| 1 | INSTALL | 5-Star Plus - Five Star Plus Playground Installation Services- <i>Performed by a Certified Installer, includes meeting and unloading delivery truck, signed completion forms, site walkthrough, 90 day site revisit by installation foreman, and 3-Year Labor Warranty!</i> | \$26,500.00 | \$26,500.00 | \$26,500.00 |
| 275 | Curb | GT-Impax - Concrete Curb (In. ft.)- <i>4" Wide - Not Reinforced</i> | | \$31.50 | \$8,662.50 |
| 4000 | Crush | GT-Impax - Crushed & Compacted Stone Sub-Base (sq. ft.)- <i>Extra Thick to account for wood fiber sub-base. Installed per specification of Unitary Surfacing requirements. (note since existing surfacing is wood fiber, sub-base warranty only 2 year)</i> | | \$4.50 | \$18,000.00 |
| 4000 | Poured-8 | GT-Impax - Poured Rubber Surfacing - 8' fall height- <i>50% Standard Color - Aromatic Binder - 3.5" Thick with 1/2" EPDM wear course cap - 5-year warranty</i> | \$18.87 | \$16.04 | \$64,160.00 |
| 1 | Custom | GT-Impax - Custom Designs in Poured Rubber | | \$3,000.00 | \$3,000.00 |
| 1 | INSTALL | 5-Star Plus - Signed/Sealed FBC 2020 7th Ed Building Code Drawings | | \$2,000.00 | \$2,000.00 |



GameTime
 c/o Dominica Recreation Products, Inc.
 P.O. Box 520700
 Longwood, FL 32752-0700
 800-432-0162 * 407-331-0101
 Fax: 407-331-4720
www.playdrp.com

07/23/2021
 Quote #102803-02-01

Lakewood Park

| Qty | Part # | Description | List \$ | Selling \$ | Ext. Selling \$ |
|-----|---------|---|---------|---------------------------|---------------------|
| 1 | INSTALL | 5-Star Plus - Building Permits- <i>Estimated Costs of Permits running Time. If actual permit fees are significantly higher or lower, final invoice will be adjusted accordingly. Includes two visits to the permit office, if additional time spent acquiring permits, final invoice to be adjusted. Site Plans are to be provided by the owner for the permit application.</i> | | \$1,200.00 | \$1,200.00 |
| | | | | Sub Total | \$200,129.02 |
| | | | | Material Surcharge | \$13,760.00 |
| | | | | Freight | \$5,696.13 |
| | | | | Total | \$219,585.15 |

Comments

Note : Lead time for 2021 for all permitted projects is 150 days. (Hopefully the project goes faster, but with material allocations and scarcity, lead time on equipment shipment is greatly delayed)

This quote was prepared by Rob Dominica, President.
 For questions or to order please call - 800-432-0162 ext. 113 robd@gametime.com

Permits are not included in cost, unless specifically listed in pricing. If permits are required Signed/Sealed drawings are usually needed and are also not included unless specifically listed in pricing. Any costs for municipal permits, paid by installer, will be charged back to the owner. Adding permits to any job will increase the length of completion, expect total time to be about **120 days**, after receipt of Site Plan from owner/customer (this is not due to manufacturing but rather the permit process at the municipality level). It is expected that the **owner will provide approved site plans** of the area for the permit office, and will help and assist in the securing of all required approvals before assembly of equipment can begin. Installer cannot provide site plans. The permit process can not begin until the site plans are available. If additional permitting requirements are needed during the process, those will be added and billed accordingly, i.e. soil density test, formed footers, etc.

Payment Terms: Governmental Purchase Order.

Purchases in excess of \$1,000.00 to be supported by your written purchase order made out to GameTime.

Net 30 days subject to approval by GameTime Credit Manager. A completed Credit Application and Bank Reference Authorization, must be received with the order. The decision on credit is the sole discretion of GameTime/PlayCore. A 1.5% per month finance charge will be imposed on all past due accounts.

Multiple Invoices: Invoices will be generated upon services rendered. When equipment ships it will be invoiced separately from installation and/or other services. Terms are Net 30 for each individual invoice.

This Quotation is subject to policies in the current GameTime Park and Playground Catalog and the following terms and conditions. Our quotation is based on shipment of all items at one time to a single destination, unless noted, and changes are subject to price adjustment.

Pricing: Firm for 60 days from date of quotation.

Shipment: F.O.B. factory, order shall ship within 45 days after GameTime's receipt and acceptance of your purchase order, color selections, approved submittals, and receipt of payment.

Taxes: State and local taxes will be added at time of invoicing, if not already included, unless a tax exempt certificate is provided at the time of order entry.

Exclusions: Unless specifically discussed, this quotation excludes all sitework and landscaping; removal of existing equipment; acceptance of equipment and off-loading; storage of goods prior to installation; security of equipment (on site and at night); equipment assembly and installation; safety surfacing; borders; drainage; signed/sealed drawings; or permits.

Installation Terms: Shall be by a Certified Installer. The installer is an independent installer and not part of PlayCore, GameTime, nor Dominica Recreation Products. If playground equipment, installer will be NPSI and Factory Trained and Certified. Unless otherwise noted, installation is based on a standard installation consistent with GameTime installation sheets and in suitable soil with a sub-base that will allow proper playground installation. Drainage is not part of our scope of work unless otherwise noted. Customer shall be responsible for scheduling and coordination with the installer. Site should be level and allow for unrestricted access of trucks and machinery. Customer shall also provide a staging and construction area. Installer not responsible for sod replacement or damage to access path and staging area. Customer shall be responsible for unknown conditions such as buried utilities, tree stumps, rock, or any concealed materials or conditions that may result in additional labor or material costs. Customer will be billed hourly or per job directly by the installer for any additional costs that were not previously included.



GameTime
 c/o Dominica Recreation Products, Inc.
 P.O. Box 520700
 Longwood, FL 32752-0700
 800-432-0162 * 407-331-0101
 Fax: 407-331-4720
www.playdrp.com

07/23/2021
 Quote #102803-02-01

Lakewood Park

Unitary Surfacing Notes : The installer of the Unitary Surfacing (Poured, Bonded, Turf, Tiles) is not the same installer of the playground equipment. However, your certified equipment installer will coordinate the timing of the unitary surfacing installation, but more than likely they will not be on-site at the time. They will continue to be your contact should you have any questions. Security is needed to protect surfacing at night or after installation as the product set. Normally it is not needed or a concern, however in some areas additional security is needed to prevent vandalism. **Security is not included.** Vandalism will be the responsible of the owner.

Acceptance of quotation:

Accepted By (printed): _____

P.O. No: _____

Signature: _____

Date: _____

Title: _____

Phone: _____

E-Mail: _____

Purchase Amount: **\$219,585.15**

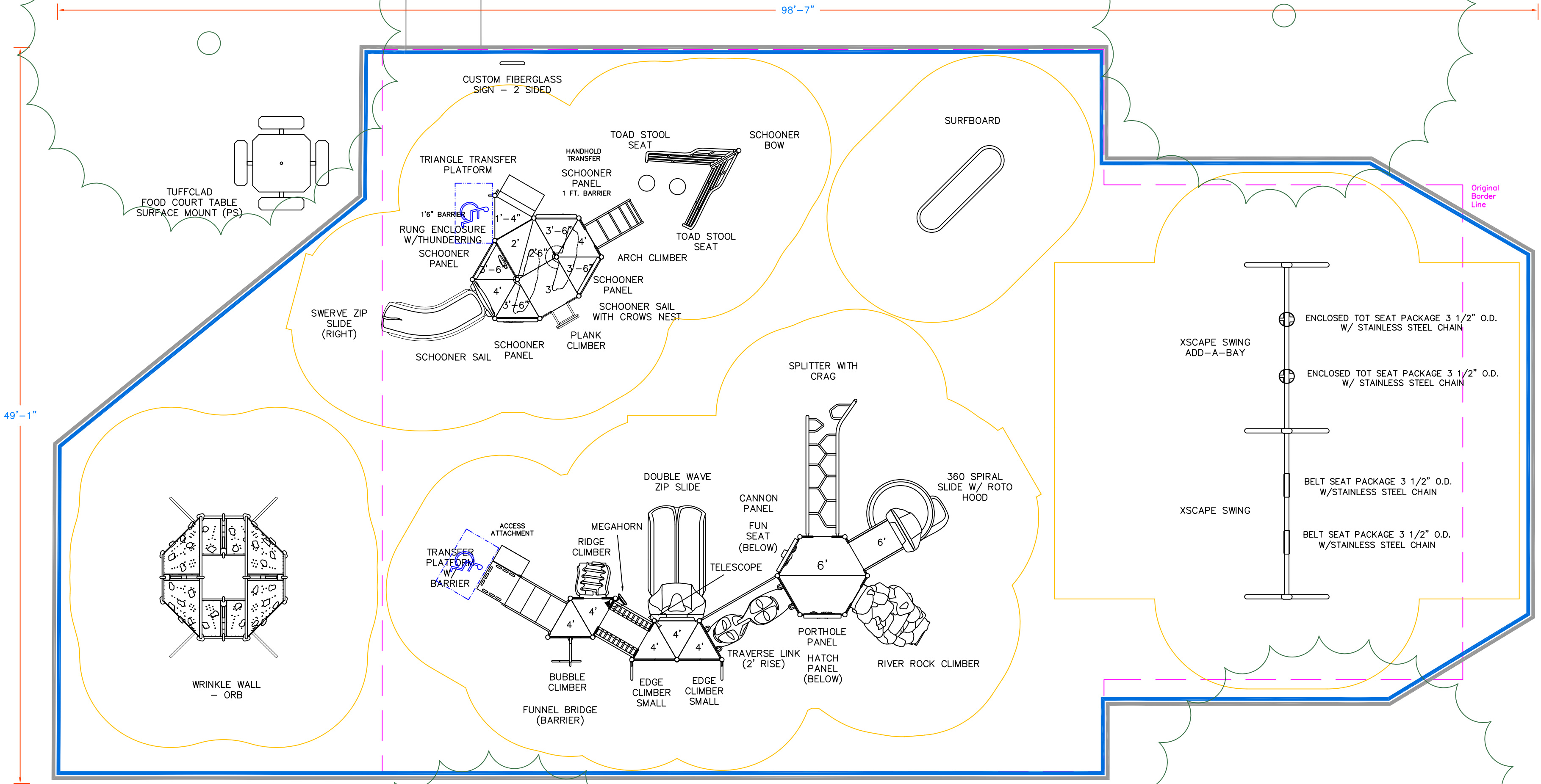

49'-1"

98'-7"

Original Border Line

TUFFCLAD FOOD COURT TABLE SURFACE MOUNT (PS)

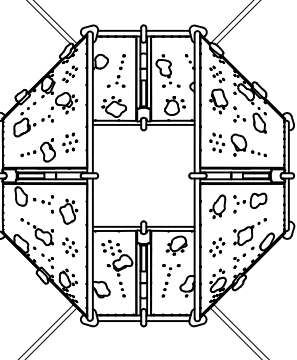

WRINKLE WALL - ORB

TUFFCLAD FOOD COURT TABLE SURFACE MOUNT (PS)

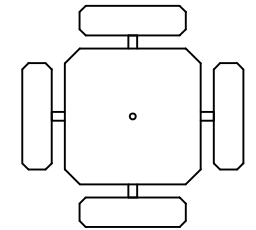

- Flush With Grade Installation
- Digout of area by installer
 - drainage not included
 - Concrete Curb
 - Crushed Stone Sub-base
 - Poured Rubber Surfacing
 - 50% Color / fall height as needed
 - includes designs

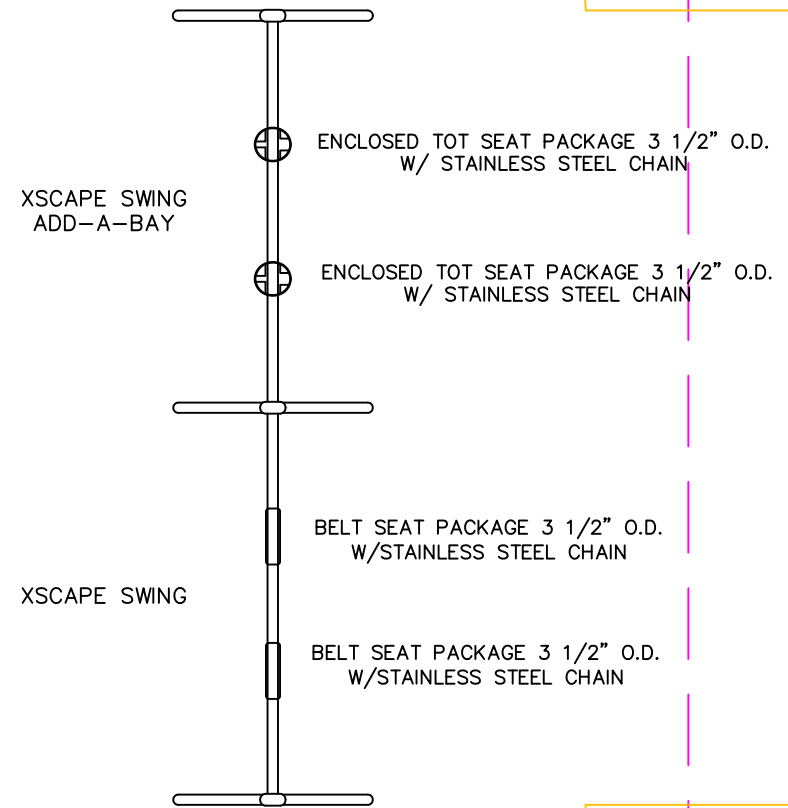

XSCAPE SWING ADD-A-BAY

XSCAPE SWING

ENCLOSED TOT SEAT PACKAGE 3 1/2" O.D. W/ STAINLESS STEEL CHAIN

ENCLOSED TOT SEAT PACKAGE 3 1/2" O.D. W/ STAINLESS STEEL CHAIN

BELT SEAT PACKAGE 3 1/2" O.D. W/STAINLESS STEEL CHAIN

BELT SEAT PACKAGE 3 1/2" O.D. W/STAINLESS STEEL CHAIN

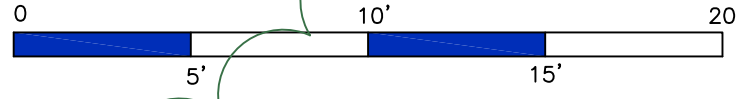

N



A PLAYCORE Company



150 PlayCore Drive SE
Fort Payne, AL 35967
www.gametime.com

Lakewood Park
Coconut Creek, Florida

Representative
Dominica Recreation Products

This play equipment is recommended for children ages 2-12

Minimum Area Required:
Scale: 1" = 5'-0"
This drawing can be scaled only when in an 18" x 24" format

IMPORTANT: Soft resilient surfacing should be placed in the use zones of all equipment, as specified for each type of equipment, and at depths to meet the critical fall heights as specified by the U.S. consumer Product Safety Commission, ASTM standard F 1487 and Canadian Standard CAN/CSA-Z-614

Drawn By: Rob
Date: 7/22/21
Drawing Name: Lakewood

SECTION IV - REQUIRED DOCUMENTS**Proposal Requirements Checklist**

Proposer has completed the required documents listed in the checklist below. The required documents shall be executed, notarized (if applicable), and submitted as a condition to this Request for Proposals.

Proposer shall electronically submit all required documents and any other pertinent information electronically through the eBid System.

| Required Documents | Yes | No |
|---|-------------------------------------|--------------------------|
| Proposer Information | <input checked="" type="checkbox"/> | <input type="checkbox"/> |
| Proposal Confirmation | <input checked="" type="checkbox"/> | <input type="checkbox"/> |
| Submitted Pricing through the eBid System "Line Items" Tab | <input checked="" type="checkbox"/> | <input type="checkbox"/> |
| Indemnification Clause | <input checked="" type="checkbox"/> | <input type="checkbox"/> |
| Non-Collusive Affidavit | <input checked="" type="checkbox"/> | <input type="checkbox"/> |
| Proposer's Qualification Statement | <input checked="" type="checkbox"/> | <input type="checkbox"/> |
| Drug-Free Workplace Form | <input checked="" type="checkbox"/> | <input type="checkbox"/> |
| Sworn Statement on Public Entity Crimes | <input checked="" type="checkbox"/> | <input type="checkbox"/> |
| Exceptions to the RFP | <input checked="" type="checkbox"/> | <input type="checkbox"/> |
| Scrutinized Companies Certification | <input checked="" type="checkbox"/> | <input type="checkbox"/> |
| E-Verify Form | <input checked="" type="checkbox"/> | <input type="checkbox"/> |
| Proposal Format | <input checked="" type="checkbox"/> | <input type="checkbox"/> |
| Bid Bond | <input checked="" type="checkbox"/> | <input type="checkbox"/> |
| Company's www.Sunbiz.org Record | <input checked="" type="checkbox"/> | <input type="checkbox"/> |
| Certificate of Insurance | <input checked="" type="checkbox"/> | <input type="checkbox"/> |
| Business Tax Receipt | <input checked="" type="checkbox"/> | <input type="checkbox"/> |
| Copies of Valid Licenses | <input type="checkbox"/> | <input type="checkbox"/> |

PROPOSER INFORMATION

Communications concerning this proposal shall be addressed to:

Company Name: PlayCore Wisconsin DBA GameTime
Social Security/Federal Tax I.D. No.: 39-1720480
Proposer's Name (Print): Rob Dominica Title: Pres/drp
Address: PO Box 520700
City/State/Zip: Longwood, FL, 32752
Phone: 407-331-0101 Fax: 407-331-4720
Email: robd@gametime.com

ACKNOWLEDGEMENT OF ADDENDA

Instructions: Complete Part I or Part II, Whichever Applies

Part I:

Proposer has examined copies of all the Contract Documents and of the following Addenda (receipt of all which is hereby acknowledged).

Addendum No: Dated:
Addendum No: Dated:
Addendum No: Dated:
Addendum No: Dated:
Addendum No: Dated:

Part II:

No Addendum was received in connection with this RFP.

It is understood and agreed by Proposer that the City reserves the right to reject any and all proposals, to make awards on all items or any items according to the best interest of the City, and to waive any irregularities in the proposal or in the proposals received as a result of the RFP. It is also understood and agreed by the Proposer that by submitting a proposal, Proposer shall be deemed to understand and agree that no property interest or legal right of any kind shall be created at any point during the aforesaid evaluation/selection process until and unless a contract has been agreed to and signed by both parties.

Proposer's Authorized Signature

7-27-21
Date

Rob Dominica
Proposer's Printed Name

PROPOSAL CONFIRMATION

In accordance with the requirements to provide Coco Point Park and Lakewood Park Playground ADA Improvements and Construction pursuant to RFP No. 07-28-21-11, the undersigned submits the attached proposal.

Proposer accepts and hereby incorporates by reference in this proposal all of the terms and conditions of the scope of work, including EPA Standards, Motor Vehicle Safety Standards and required warranty and guarantee certificates.

Proposer is fully aware of the scope of work based on these requirements, the legal requirements (federal, state, county and local laws, ordinances, rules and regulations) and the conditions affecting cost, progress or performance of the work and has made such independent investigation as Proposer deems necessary.

This proposal is genuine and not made in the interest of or on behalf of any undisclosed person, firm or corporation and is not submitted in conformity with any agreement or rules of any group, association, organization or corporation; Proposer has not directly or indirectly induced or solicited any other Proposer to submit a false or sham proposal; Proposer has not solicited or induced any person; firm or a corporation to refrain from proposing and Proposer has not sought by collusion to obtain for himself any advantage over any other Proposer or over City.

The Proposer shall acknowledge this Proposal by signing and completing the spaces provided. I hereby submit this Proposal Package for Coco Point Park and Lakewood Park Playground ADA Improvements and Construction, RFP No. 07-28-21-11 to the City of Coconut Creek with the full understanding of the Request for Proposal, General Terms and Conditions, Special Terms and Conditions, Detailed Requirements, and the entire Proposal Package.

GameTime by
Rob Dominica
Proposer's Name



Signature Rob Dominica

7-27-21
Date

State of: Florida

County of: Seminole

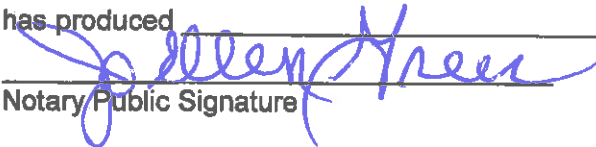
The foregoing instrument was acknowledged before me this 27 day of July, 2021, by Rob Dominica, who is (who are) personally known to me or who has produced _____ as identification and who did (did not) take an oath.

Notary Public Signature

Notary Name, Printed, Typed or Stamped

Commission Number: _____

My Commission Expires: _____



JOELLEN GREEN
Commission # HH 067935
Expires March 31, 2025
Bonded Thru Budget Notary Services

CITY OF COCONUT CREEK
COCO POINT PARK AND LAKEWOOD PARK PLAYGROUND
ADA IMPROVEMENTS AND CONSTRUCTION
RFP NO. 07-28-21-11

SCHEDULE OF PROPOSAL PRICES

PROPOSER SHALL SUBMIT PRICES ELECTRONICALLY THROUGH THE EBID SYSTEM "LINE ITEMS" TAB

WWW.COCONUTCREEK.NET/FIN/PROCUREMENT

PROPOSED PRICING

| Name | Location | Lump Sum Amount |
|-----------------|--|----------------------|
| Coco Point Park | 4870 NW 6 th Street, Coconut Creek, FL 33063 | \$ 159,549.00 |
| Lakewood Park | 4966 NW 10 th Street, Coconut Creek, FL 33063 | \$ 219,585.15 |
| Total | | \$ 379,134.15 |

PAYMENT METHODS

VISA PURCHASING CARD (reference informational flyer on following page):

The City of Coconut Creek has implemented a Visa Procurement Card (P-Card) Program through SunTrust Bank. The City's preference is to pay for goods/services with the P-Card. This program allows the City to expedite payment to our vendors. Some of the benefits of the P-Card Program to the vendor are: payment received within 72 hours of receipt and acceptance of goods, reduced paperwork, issue receipts instead of generating invoices, resulting in fewer invoice problems, and deal directly with the cardholder (in most cases).

Vendors accepting payment by the P-Card may not require the City (Cardholder) to pay a separate or additional convenience fee, surcharge or any part of any contemporaneous finance charge in connection with a transaction. Such charges are allowable, however must be included in the total cost of the bid. Vendors are not to add notations such as "+3% service fee" in their bid response. All bid responses shall be inclusive of any and all fees associated with the acceptance of the P-Card.

Vendors agreeing to accept payment by P-Card must presently have the capability to accept Visa or take whatever steps necessary to implement the ability before the start of the agreement term.

Signed, sealed and delivered
in the presence of:

[Signature]
[Signature]

By: [Signature]

Rob Dominica
(Printed Name)

Pres/drp
(Title)

ACKNOWLEDGEMENT

State of Florida

County of Seminole

The foregoing instrument was acknowledged before me this 27 day of July, 2021,
by Rob Dominica, who is personally known to me or who has produced
_____ as identification and who did (did not) take an oath.

WITNESS my hand and official seal

[Signature]
NOTARY PUBLIC



JOELLEN GREEN
Commission # HH 067935
Expires March 31, 2025
Bonded Thru Budget Notary Services

(Name of Notary Public: Print, Stamp, or
Type as Commissioned.)

NON-COLLUSIVE AFFIDAVIT

State of Florida)
County of Seminole)ss.

Rob Dominica being first duly sworn, deposes and says that:

- (1) He/she is the Register Agent for
(Owner, Partner, Officer, Representative or Agent)
of GameTime the Proposer that has submitted the attached proposal;
- (2) He/she is fully informed respecting the preparation and contents of the attached proposal and of all pertinent circumstances respecting such proposal;
- (3) Such proposal is genuine and is not a collusive or sham proposal;
- (4) Neither the said Proposer nor any of its officers, partners, owners, agents, representatives, employees or parties in interest, including this affiant, have in any way colluded, conspired, connived or agreed, directly or indirectly, with any other Proposer, firm, or person to submit a collusive or sham proposal in connection with the work for which the attached proposal has been submitted; or to refrain from bidding in connection with such work; or have in any manner, directly or indirectly, sought by agreement or collusion, or communication, or conference with any Proposer, firm or person to fix the price or prices in the attached proposal of any other Proposer, or to fix an overhead, profit, or cost elements of the proposal price or the proposal price of any other Proposer, or to secure through any collusion, conspiracy, connivance, or unlawful agreement any advantage against (Recipient), or any person interested in the proposed work;
- (5) The price or prices quoted in the attached proposal are fair and proper and are not tainted by any collusion, conspiracy, connivance, or unlawful agreement on the part of the Proposer or any other of its agents, representatives, owners, employees or parties in interest, including this affiant.

PROPOSER'S QUALIFICATION STATEMENT

In order to properly evaluate the proposal submittals, Proposers are expected to complete the questionnaire and include the following documentation. By attesting to this submittal, Proposer guarantees the truth and accuracy of all statements and answers herein contained.

SUBMITTED TO: City of Coconut Creek
Procurement Division
4800 West Copans Road
Coconut Creek, FL 33063

Submitted By: PlayCore Wisconsin DBA GameTime
Name: Rob Dominica
Address: PO Box 520700
City, State, Zip Longwood, FL. 32752
Telephone No. 407-331-0101
Fax No. 407-331-4720

- Check One
[X] Corporation
[] Partnership
[] Individual
[] Other

1. State the true, exact, correct and complete name of the partnership, corporation, trade or fictitious name under which you do business and the address of the place of business.

The correct name of the Proposer is: PlayCore Wisconsin DBA GameTime
The address of the principal place of business is: 150 PlayCore Drive
Ft. Payne, AL. Manufacture Plant

2. If Proposer is a corporation, answer the following:

- a. Date of Incorporation: 11-27-91
b. State of Incorporation: Wisconsin
c. President's Name: Mr. Roger Posacki CEO and Pres.
d. Vice President's Name: Richard E. Ruegger VP
e. Secretary's Name:
f. Treasurer's Name:
g. Name and Address of Resident Agent: Dominica Recreation
PO Box 520700 Longwood FL. 32752

3. If Proposer is an individual or a partnership, answer the following:

- a. Date of Organization:
b. Name, Address and Ownership Units of all Partners:
c. State whether general or limited partnership:

4. If Proposer is other than an individual, corporation or partnership, describe the organization and give the name and address of principals:

5. If Proposer is operating under a fictitious name, submit evidence of compliance with the Florida Fictitious Name Statute. See Attached

6. How many years has your organization been in business under its present business name? 50

- a. Under what other former name has your organization operated?

7. Indicate registration, license numbers or certificate numbers for the businesses or professions, which are the subject of this proposal. Please attach certificate of competency and/or state registration.

GameTime CBC 1264755

8. Litigation/Judgments/Settlements/Debarments/Suspensions:
Submit information on any pending litigation and any judgments and settlements of court cases relative to performing this type of work that have occurred within the last three (3) years. Also indicate if your firm has been debarred or suspended from bidding or proposing on a procurement project by any government during the last five (5) years.

None

9. Have you ever failed to complete any work awarded to you? If so, state when, where and why?

NO

10. List the pertinent experience of the key individuals of your organization (continue on insert sheet, if necessary).

Please see team management sheet

11. State the name of the individual(s) and titles who will personally supervise the work:

Donald West

12. State the name and address of the attorney, if any, for the business of the Proposer:

13. State the names and addresses of all businesses and/or individuals who own an interest of more than five percent (5%) of the Proposer's business and indicate the percentage owned of each such business and/or individual:

14. State the names, addresses and the type of business of all firms that are partially or wholly owned by Proposer:

15. State the name of Surety Company which will be providing the bond, and the name and address of agent:

Marsh USA

3560 Lenox RD Suite 2400

Atlanta GA 30326

16. List the following information concerning all Proposer's contracts in progress as of the date of submission and completed projects over the last five (5) years. (In case of any co-venture, list the information for all co-ventures.)

| <u>Name of Project</u> | <u>Owner</u> | <u>Total Contract Value</u> | <u>Contracted Date of Completion</u> | <u>% of Completion to Date</u> |
|---|--------------|-----------------------------|--------------------------------------|--------------------------------|
| GameTime has agents all over the US. It would be hard to be able to come up with this list. We have included references | | | | |

17. Have you personally inspected the site of the proposed work?

Territory Manager has been to site

Yes No

18. Do you have a complete set of documents, including drawings and addenda, if applicable?

Yes No

19. Did you attend the pre-proposal conference if any such conference was held?

Yes No No Conference Held

The Proposer acknowledges and understands that the information contained in response to this Qualification Statement shall be relied upon by City in awarding the contract and such information is warranted by Proposer to be true. The discovery of any omission or misstatement that materially affects the Proposer's qualifications to perform under the contract shall cause the City to reject the proposal, and if after the award, to cancel and terminate the award and /or contract.

Proposer's Signature

7-27-21
Date

REMAINDER OF PAGE LEFT INTENTIONALLY BLANK

**ACKNOWLEDGEMENT
PROPOSER'S QUALIFICATION STATEMENT**

State of Florida

County of Seminole

On this the 27 day of July, 2021, before me, the undersigned Notary Public of the State of Florida, Personally appeared

Rob Dominica And
(Name(s) of individual(s) who appeared before notary)

whose name(s) is/are Subscribed to within the instrument, and he/she/they acknowledge that he/she/they executed it.

WITNESS my hand and official seal.

NOTARY PUBLIC



JOELLEN GREEN
Commission # HH 067935
Expires March 31, 2025
Bonded Thru Budget Notary Services

SEAL OF OFFICE:

Joellen Green
NOTARY PUBLIC, STATE OF FLORIDA

JoEllen Green
(Name of Notary Public: Print, Stamp, or Type as Commissioned)

- Personally known to me, or
- Produced identification

(Type of Identification Produced)

- DID take an oath, or
- DID NOT take an oath

**SWORN STATEMENT
ON PUBLIC ENTITY CRIMES
UNDER FLORIDA STATUTES CHAPTER 287.133(3)(a).**

THIS FORM MUST BE SIGNED IN THE PRESENCE OF A NOTARY PUBLIC OR OTHER OFFICER AUTHORIZED TO ADMINISTER OATHS.

1. This sworn statement is submitted with RFP No. 07-28-21-11 for Coco Point Park and Lakewood Park Playground ADA Improvements and Construction.
2. This sworn statement is submitted by PlayCore Wisconsin
GameTime (name of entity submitting sworn statement) whose business address is PO Box 520700 Longwood, FL. and (if applicable) its Federal Employer Identification Number (FEIN) is 39-1720480. (If the entity has no FEIN, include the Social Security Number of the individual signing this sworn statement: _____.)
3. My name is Rob Dominica and my
(Please print name of individual signing)
relationship to the entity named above is registered agent. pres/drps.
4. I understand that a "public entity crime" as defined in Paragraph 287.133(1)(g), Florida Statutes, means a violation of any state or federal law by a person with respect to and directly related to the transaction of business with any public entity or with an agency or political subdivision of any other state or with the United States, including, but not limited to, any bid or contract for goods or services to be provided to any public entity or an agency or political subdivision of any other state or of the United States and involving antitrust, fraud, theft, bribery, collusion, racketeering, conspiracy, or material misrepresentation.
5. I understand that a "convicted" or "conviction" as defined in Paragraph 287.133(1)(b), Florida Statutes, means a finding of guilt or a conviction of a public entity crime, with or without an adjudication of guilt, in any federal or state trial court of record relating to charges brought by indictment or information after July 1, 1989, as a result of a jury verdict, nonjury trial, or entry of a plea of guilty or nolo contendere.
6. I understand that an "affiliate" as defined in Paragraph 287.133(1)(a), Florida Statutes, includes but is not limited to:
 1. A predecessor or successor of a person convicted of a public entity crime: or
 2. An entity under the control of any natural person who is active in the management of the entity and who has been convicted of a public entity crime. The term "affiliate" includes those officers, directors, executives, partners, shareholders, employees, members, and agents who are active in the management of an affiliate. The Ownership by one person of shares constituting a controlling interest in another person, or a pooling of equipment or income among persons when not for fair market value under an arm's length agreement, shall be a prima facie case that one person controls another person. A person who knowingly enters into a joint venture with a person who has been convicted of a public entity crime in Florida during the preceding thirty-six (36) months shall be considered an affiliate.
7. I understand that a "person" as defined in Paragraph 287.133(1)(e), Florida Statutes, means any natural person or entity organized under the laws of any state or of the United States with the legal

power to enter into a binding contract and which bids or applies to bid on contracts for the provision of goods or services let by a public entity, or which otherwise transacts or applies to transact business with a public entity. The term "person" includes those officers, who are active, or who have been active, directors, executives, partners, shareholders, employees, members, and agents who are active in management of an entity within the last five (5) years of this sworn statement.

8. Based on information and belief, the statement which I have marked below is true in relation to the entity submitting this sworn statement. **Please check all statements that are applicable.**
- Neither the entity submitting this sworn statement, nor any officers, directors, executives, partners, shareholders, employees, members, or agents who are active in management of the entity, nor any affiliate of the entity have been charged with and convicted of a public entity crime subsequent to July 1, 1989.
- The entity submitting this sworn statement, or one or more of the officers, directors, executives, partners, shareholders, employees, members, or agents who are active in management of the entity, or an affiliate of the entity has been charged with and convicted of a public entity crime subsequent to July 1, 1989, AND (Please indicate which additional statement applies.)
- There has been a proceeding concerning the conviction before a hearing officer of the State of Florida, Division of Administrative Hearings. The final order entered by the hearing officer did not place the person or affiliate on the convicted vendor list. (Please attach a copy of the final order.)
- The person or affiliate was placed on the convicted vendor list. There has been a subsequent proceeding before a hearing officer of the State of Florida, Division of Administrative Hearings. The final order entered by the hearing officer determined that it was in the public interest to remove the person or affiliate from the convicted vendor list. (Please attach a copy of the final order.)
9. Based on information and belief, the statement that I have marked below is true in relation to the entity submitting this sworn statement. **Please check if statement is applicable.**
- The person or affiliate has not been placed on the convicted vendor list.
(If the box is not checked, please describe any action taken by or pending with the Department of General Services.)
10. The herein sworn statement shall be subject to and incorporate all the terms and conditions contained in Section 287.133 of the Florida Statutes.
11. Conviction of a public entity crime shall be cause for disqualification.

PlayCore Wisconsin DBA
GameTime

Proposer's Name



Signature Rob Dominica

Date: 7-27-21

State of: Florida

County of: Seminole

The foregoing instrument was acknowledged before me this 27 day of July, 2021, by Rob Dominica, who is (who are) personally known to me or who has produced _____ as identification and who did (did not) take an oath.

Notary Public Signature

Notary Name, Printed, Typed or Stamped



JOELLEN GREEN
Commission # HH 067935
Expires March 31, 2025
Bonded Thru Budget Notary Services

Commission Number: _____

My Commission Expires: _____

**SCRUTINIZED COMPANIES
CERTIFICATION PURSUANT TO
FLORIDA STATUTE § 215.4725 AND § 215.473**

I, Rob Dominica, on behalf of PlayCore Wisconsin DBA GameTime
Print Name Company Name

certifies that PlayCore Wisconsin DBA GameTime does not:
Company Name

1. Participate in a boycott of Israel; and
2. Is not on the Scrutinized Companies that Boycott Israel list; and
3. Is not on the Scrutinized Companies with Activities in Sudan List; and
4. Is not on the Scrutinized Companies with Activities in the Iran Petroleum Energy Sector List; and
5. Has not engaged in business operations in Cuba or Syria.

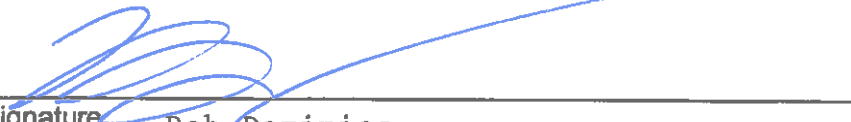
 Signature Rob Dominica
Pres/drp
 Title
407-331-0101 7-27-21
 Phone Date

E-VERIFY FORM

| | |
|---------------|--|
| Project Name: | Coco Point Park and Lakewood Park Playground ADA Improvements and Construction |
| Project No.: | RFP No. 07-28-21-11 |

ACKNOWLEDGEMENT

Definitions:

"Contractor" means a person or entity that has entered or is attempting to enter into a contract with a public employer to provide labor, supplies, or services to such employer in exchange for salary, wages, or other remuneration.

"Subcontractor" means a person or entity that provides labor, supplies, or services to or for a contractor or another subcontractor in exchange for salary, wages, or other remuneration.

Effective January 1, 2021, public and private employers, contractors and subcontractors will begin required registration with, and use of the E-verify system in order to verify the work authorization status of all newly hired employees. Vendor/Consultant/Contractor acknowledges and agrees to utilize the U.S. Department of Homeland Security's E-Verify System to verify the employment eligibility of:

- (a) All persons employed by Vendor/Consultant/Contractor to perform employment duties within Florida during the term of the contract; and
- (b) All persons (including subvendors/subconsultants/subcontractors) assigned by Vendor/Consultant/Contractor to perform work pursuant to the contract with the Department. The Vendor/Consultant/Contractor acknowledges and agrees that use of the U.S. Department of Homeland Security's E-Verify System during the term of the contract is a condition of the contract with the City of Coconut Creek; and

Should vendor become successful Contractor awarded for the above-named project, by entering into this Contract, the Contractor becomes obligated to comply with the provisions of Section 448.095, Fla. Stat., "Employment Eligibility," as amended from time to time. This includes but is not limited to utilization of the E-Verify System to verify the work authorization status of all newly hired employees, and requiring all subcontractors to provide an affidavit attesting that the subcontractor does not employ, contract with, or subcontract with, an unauthorized alien. The contractor shall maintain a copy of such affidavit for the duration of the contract. Failure to comply will lead to termination of this Contract, or if a subcontractor knowingly violates the statute, the subcontract must be terminated immediately. Any challenge to termination under this provision must be filed in the Circuit Court no later than 20 calendar days after the date of termination. If this contract is terminated for a violation of the statute by the Contractor, the Contractor may not be awarded a public contract for a period of 1 year after the date of termination.

COMPANY CONTACT INFORMATION

| | |
|-----------------------|---|
| Company Name: | PlayCore Wisconsin dba GameTime |
| Authorized Signature: |  |
| Print Name: | Rob Dominica |
| Title | Pres/drp |
| Date: | 7-27-21 |
| Phone: | 407-331-0101 |
| Email: | robd@gametime.com |
| Website: | www.gametime.com |

Document A310™ – 2010

Conforms with The American Institute of Architects AIA Document 310

Bond Number: 35413-ASI-2021-0103

Bid Bond

CONTRACTOR:

(Name, legal status and address)

PlayCore Wisconsin, Inc. dba GameTime

150 PlayCore Drive
Fort Payne, AL 35967

OWNER:

(Name, legal status and address)

City of Coconut Creek
4800 West Copans Road
Coconut Creek, FL 33063

SURETY:

(Name, legal status and principal place of business)

Atlantic Specialty Insurance Company
605 Highway 169 North, Suite 800
Plymouth, MN 55441
State of Inc: New York

This document has important legal consequences. Consultation with an attorney is encouraged with respect to its completion or modification.

Any singular reference to Contractor, Surety, Owner or other party shall be considered plural where applicable.

BOND AMOUNT: Five Percent of Amount Bid (5%)

PROJECT:

(Name, location or address, and Project number, if any)

Coco Point Park and Lakewood Park Playground ADA Improvements and Construction
RFP No. 07-28-21-11

The Contractor and Surety are bound to the Owner in the amount set forth above, for the payment of which the Contractor and Surety bind themselves, their heirs, executors, administrators, successors and assigns, jointly and severally, as provided herein. The conditions of this Bond are such that if the Owner accepts the bid of the Contractor within the time specified in the bid documents, or within such time period as may be agreed to by the Owner and Contractor, and the Contractor either (1) enters into a contract with the Owner in accordance with the terms of such bid, and gives such bond or bonds as may be specified in the bidding or Contract Documents, with a surety admitted in the jurisdiction of the Project and otherwise acceptable to the Owner, for the faithful performance of such Contract and for the prompt payment of labor and material furnished in the prosecution thereof; or (2) pays to the Owner the difference, not to exceed the amount of this Bond, between the amount specified in said bid and such larger amount for which the Owner may in good faith contract with another party to perform the work covered by said bid, then this obligation shall be null and void, otherwise to remain in full force and effect. The Surety hereby waives any notice of an agreement between the Owner and Contractor to extend the time in which the Owner may accept the bid. Waiver of notice by the Surety shall not apply to any extension exceeding sixty (60) days in the aggregate beyond the time for acceptance of bids specified in the bid documents, and the Owner and Contractor shall obtain the Surety's consent for an extension beyond sixty (60) days.

If this Bond is issued in connection with a subcontractor's bid to a Contractor, the term Contractor in this Bond shall be deemed to be Subcontractor and the term Owner shall be deemed to be Contractor.

When this Bond has been furnished to comply with a statutory or other legal requirement in the location of the Project, any provision in this Bond conflicting with said statutory or legal requirement shall be deemed deleted herefrom and provisions conforming to such statutory or other legal requirement shall be deemed incorporated herein. When so furnished, the intent is that this Bond shall be construed as a statutory bond and not as a common law bond.

Signed and sealed this 23rd day of July, 2021

(Witness) MARIA C. TOWNSEND
CORPRISE

(Witness) Camille Cruz, Surety Witness

PlayCore Wisconsin, Inc. dba GameTime
(Principal)  (Seal)

(Title) BILL COX, VP FINANCE
Atlantic Specialty Insurance Company

(Surety)  (Seal)

(Title) Ana W. Oliveras, Attorney-In-Fact



Power of Attorney

Surety Bond No: 35413-ASI-2021-0103

Principal: PlayCore Wisconsin, Inc. dba GameTime

Obligee: City of Coconut Creek

KNOW ALL MEN BY THESE PRESENTS, that ATLANTIC SPECIALTY INSURANCE COMPANY, a New York corporation with its principal office in Minnetonka, Minnesota, does hereby constitute and appoint: Ana W. Oliveras, each individually if there be more than one named, its true and lawful Attorney-in-Fact, to make, execute, seal and deliver, for and on its behalf as surety, any and all bonds, recognizances, contracts of indemnity, and all other writings obligatory in the nature thereof; provided that no bond or undertaking executed under this authority shall exceed in amount the sum of sixty million dollars (\$60,000,000) and the execution of such bonds, recognizances, contracts of indemnity, and all other writings obligatory in the nature thereof in pursuance of these presents, shall be as binding upon said Company as if they had been fully signed by an authorized officer of the Company and sealed with the Company seal. This Power of Attorney is made and executed by authority of the following resolutions adopted by the Board of Directors of ATLANTIC SPECIALTY INSURANCE COMPANY on the twenty-fifth day of September, 2012:

Resolved: That the President, any Senior Vice President or Vice-President (each an "Authorized Officer") may execute for and in behalf of the Company any and all bonds, recognizances, contracts of indemnity, and all other writings obligatory in the nature thereof, and affix the seal of the Company thereto; and that the Authorized Officer may appoint and authorize an Attorney-in-Fact to execute on behalf of the Company any and all such instruments and to affix the Company seal thereto; and that the Authorized Officer may at any time remove any such Attorney-in-Fact and revoke all power and authority given to any such Attorney-in-Fact.

Resolved: That the Attorney-in-Fact may be given full power and authority to execute for and in the name and on behalf of the Company any and all bonds, recognizances, contracts of indemnity, and all other writings obligatory in the nature thereof, and any such instrument executed by any such Attorney-in-Fact shall be as binding upon the Company as if signed and sealed by an Authorized Officer and, further, the Attorney-in-Fact is hereby authorized to verify any affidavit required to be attached to bonds, recognizances, contracts of indemnity, and all other writings obligatory in the nature thereof.

This power of attorney is signed and sealed by facsimile under the authority of the following Resolution adopted by the Board of Directors of ATLANTIC SPECIALTY INSURANCE COMPANY on the twenty-fifth day of September, 2012:

Resolved: That the signature of an Authorized Officer, the signature of the Secretary or the Assistant Secretary, and the Company seal may be affixed by facsimile to any power of attorney or to any certificate relating thereto appointing an Attorney-in-Fact for purposes only of executing and sealing any bond, undertaking, recognizance or other written obligation in the nature thereof, and any such signature and seal where so used, being hereby adopted by the Company as the original signature of such officer and the original seal of the Company, to be valid and binding upon the Company with the same force and effect as though manually affixed.

IN WITNESS WHEREOF, ATLANTIC SPECIALTY INSURANCE COMPANY has caused these presents to be signed by an Authorized Officer and the seal of the Company to be affixed this twenty-ninth day of April, 2019.



By Paul J. Brehm
Paul J. Brehm, Senior Vice President

STATE OF MINNESOTA
HENNIPEN COUNTY

On this twenty-ninth day of April, 2019, before me personally came Paul J. Brehm, Senior Vice President of ATLANTIC SPECIALTY INSURANCE COMPANY, to me personally known to be the individual and officer described in and who executed the preceding instrument, and he acknowledged the execution of the same, and being by me duly sworn, that he is the said officer of the Company aforesaid, and that the seal affixed to the preceding instrument is the seal of said Company and that the said seal and the signature as such officer was duly affixed and subscribed to the said instrument by the authority and at the direction of the Company.

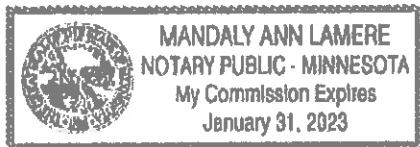

Mandaly Ann Lamere
Notary Public

I, the undersigned, Assistant Secretary of ATLANTIC SPECIALTY INSURANCE COMPANY, a New York Corporation, do hereby certify that the foregoing power of attorney is in full force and has not been revoked, and the resolutions set forth above are now in force.

Signed and sealed. Dated 23rd day of July, 2021.



Christopher V. Jerry
Christopher V. Jerry, Secretary

No Filing History

Submit

Fictitious Name Detail

Fictitious Name

GAME TIME

Filing Information

Registration Number G20000017187

Status ACTIVE

Filed Date 02/07/2020

Expiration Date 12/31/2025

Current Owners 1

County MULTIPLE

Total Pages 1

Events Filed NONE

FEI/EIN Number NONE

Mailing Address

544 CHESTNUT STREET
CHATTANOOGA, TN 37402

Owner Information

PLAYCORE WISCONSIN, INC.
544 CHESTNUT STREET
CHATTANOOGA, TN 37402
FEI/EIN Number: 39-1720480
Document Number: F07000002689

Document Images

[02/07/2020 -- REGISTRATION](#)

[View image in PDF format](#)

[Previous on List](#)

[Next on List](#)

[Return to List](#)

No Filing History

[Fictitious Name Search](#)

Submit



CERTIFICATE OF LIABILITY INSURANCE

DATE (MM/DD/YYYY)
08/03/2020

THIS CERTIFICATE IS ISSUED AS A MATTER OF INFORMATION ONLY AND CONFERS NO RIGHTS UPON THE CERTIFICATE HOLDER. THIS CERTIFICATE DOES NOT AFFIRMATIVELY OR NEGATIVELY AMEND, EXTEND OR ALTER THE COVERAGE AFFORDED BY THE POLICIES BELOW. THIS CERTIFICATE OF INSURANCE DOES NOT CONSTITUTE A CONTRACT BETWEEN THE ISSUING INSURER(S), AUTHORIZED REPRESENTATIVE OR PRODUCER, AND THE CERTIFICATE HOLDER.

IMPORTANT: If the certificate holder is an **ADDITIONAL INSURED**, the policy(ies) must have **ADDITIONAL INSURED** provisions or be endorsed. If **SUBROGATION IS WAIVED**, subject to the terms and conditions of the policy, certain policies may require an endorsement. A statement on this certificate does not confer rights to the certificate holder in lieu of such endorsement(s).

| PRODUCER Marsh USA, Inc. Two Alliance Center 3560 Lenox Road, Suite 2400 Atlanta, GA 30326 Attn: Atlanta.CertRequest@marsh.com / Fax: 212-948-4321 CN102326389-CAS-GAUWX-20-21 | CONTACT NAME: PHONE (A/C, No, Ext): _____ FAX (A/C, No): _____ E-MAIL ADDRESS: _____ | | | | | | | | | | | | | | |
|---|--|--|-------------------------------|--------|--|-------|--|-------|--|-------|--|-------|--|-------|---|
| | <table border="1"> <thead> <tr> <th>INSURER(S) AFFORDING COVERAGE</th> <th>NAIC #</th> </tr> </thead> <tbody> <tr> <td>INSURER A : Evanston Insurance Company</td> <td>35378</td> </tr> <tr> <td>INSURER B : Travelers Property Casualty Company Of America</td> <td>25674</td> </tr> <tr> <td>INSURER C : ACE Property And Casualty Ins Co</td> <td>20699</td> </tr> <tr> <td>INSURER D : The Travelers Indemnity Company of America</td> <td>25666</td> </tr> <tr> <td>INSURER E : National Union Fire Ins Co. of Pittsburgh PA</td> <td>19445</td> </tr> <tr> <td>INSURER F : Travelers Casualty And Surety Company</td> <td>19038</td> </tr> </tbody> </table> | | INSURER(S) AFFORDING COVERAGE | NAIC # | INSURER A : Evanston Insurance Company | 35378 | INSURER B : Travelers Property Casualty Company Of America | 25674 | INSURER C : ACE Property And Casualty Ins Co | 20699 | INSURER D : The Travelers Indemnity Company of America | 25666 | INSURER E : National Union Fire Ins Co. of Pittsburgh PA | 19445 | INSURER F : Travelers Casualty And Surety Company |
| INSURER(S) AFFORDING COVERAGE | NAIC # | | | | | | | | | | | | | | |
| INSURER A : Evanston Insurance Company | 35378 | | | | | | | | | | | | | | |
| INSURER B : Travelers Property Casualty Company Of America | 25674 | | | | | | | | | | | | | | |
| INSURER C : ACE Property And Casualty Ins Co | 20699 | | | | | | | | | | | | | | |
| INSURER D : The Travelers Indemnity Company of America | 25666 | | | | | | | | | | | | | | |
| INSURER E : National Union Fire Ins Co. of Pittsburgh PA | 19445 | | | | | | | | | | | | | | |
| INSURER F : Travelers Casualty And Surety Company | 19038 | | | | | | | | | | | | | | |

COVERAGES **CERTIFICATE NUMBER:** ATL-004720415-34 **REVISION NUMBER:** 12

THIS IS TO CERTIFY THAT THE POLICIES OF INSURANCE LISTED BELOW HAVE BEEN ISSUED TO THE INSURED NAMED ABOVE FOR THE POLICY PERIOD INDICATED. NOTWITHSTANDING ANY REQUIREMENT, TERM OR CONDITION OF ANY CONTRACT OR OTHER DOCUMENT WITH RESPECT TO WHICH THIS CERTIFICATE MAY BE ISSUED OR MAY PERTAIN, THE INSURANCE AFFORDED BY THE POLICIES DESCRIBED HEREIN IS SUBJECT TO ALL THE TERMS, EXCLUSIONS AND CONDITIONS OF SUCH POLICIES. LIMITS SHOWN MAY HAVE BEEN REDUCED BY PAID CLAIMS.

| INSR LTR | TYPE OF INSURANCE | ADDL INSD | SUBR WVD | POLICY NUMBER | POLICY EFF (MM/DD/YYYY) | POLICY EXP (MM/DD/YYYY) | LIMITS |
|----------|---|-----------|----------|---|-------------------------|-------------------------|---|
| A | <input checked="" type="checkbox"/> COMMERCIAL GENERAL LIABILITY <input type="checkbox"/> CLAIMS-MADE <input checked="" type="checkbox"/> OCCUR <input checked="" type="checkbox"/> SIR \$250,000 Per Occ. GEN'L AGGREGATE LIMIT APPLIES PER: <input type="checkbox"/> POLICY <input checked="" type="checkbox"/> PROJECT <input type="checkbox"/> LOC OTHER: _____ | | | MKLV2PBC000784 | 08/01/2020 | 08/01/2021 | EACH OCCURRENCE \$ 2,000,000 DAMAGE TO RENTED PREMISES (Ea occurrence) \$ 100,000 MED EXP (Any one person) \$ EXCLUDED PERSONAL & ADV INJURY \$ 2,000,000 GENERAL AGGREGATE \$ 4,000,000 PRODUCTS - COMP/OP AGG \$ 4,000,000 POLICY AGGREGATE \$ 10,000,000 |
| B | <input checked="" type="checkbox"/> AUTOMOBILE LIABILITY <input checked="" type="checkbox"/> ANY AUTO <input type="checkbox"/> OWNED AUTOS ONLY <input type="checkbox"/> SCHEDULED AUTOS <input type="checkbox"/> HIRED AUTOS ONLY <input type="checkbox"/> NON-OWNED AUTOS ONLY | | | TJ-CAP-9D897065TIL-20 | 08/01/2020 | 08/01/2021 | COMBINED SINGLE LIMIT (Ea accident) \$ 1,000,000 BODILY INJURY (Per person) \$ _____ BODILY INJURY (Per accident) \$ _____ PROPERTY DAMAGE (Per accident) \$ _____ Comp./Coll. Ded.: \$1,000 \$ _____ |
| C | <input checked="" type="checkbox"/> UMBRELLA LIAB <input checked="" type="checkbox"/> OCCUR <input type="checkbox"/> EXCESS LIAB <input type="checkbox"/> CLAIMS-MADE DED <input checked="" type="checkbox"/> RETENTION \$ 25,000 | | | XOOG71549501 002 | 08/01/2020 | 08/01/2021 | EACH OCCURRENCE \$ 10,000,000 AGGREGATE \$ 10,000,000 |
| B | <input checked="" type="checkbox"/> WORKERS COMPENSATION AND EMPLOYERS' LIABILITY <input type="checkbox"/> ANY PROPRIETOR/PARTNER/EXECUTIVE OFFICER/MEMBER EXCLUDED? (Mandatory in NH) If yes, describe under DESCRIPTION OF OPERATIONS below | | | UB-2N106953-20-51-R | 08/01/2020 | 08/01/2021 | <input checked="" type="checkbox"/> PER STATUTE <input type="checkbox"/> OTHER E.L. EACH ACCIDENT \$ 1,000,000 E.L. DISEASE - EA EMPLOYEE \$ 1,000,000 E.L. DISEASE - POLICY LIMIT \$ 1,000,000 |
| D | | | | UB-2N159031-20-51-K | 08/01/2020 | 08/01/2021 | |
| F | | | | UB-7J602089-20-14-G (See Additional Page.) | 08/01/2020 | 08/01/2021 | |
| E | Excess Umbrella | | | BE 016159343 | 08/01/2020 | 08/01/2021 | Each Occurrence 15,000,000 Aggregate 15,000,000 |

DESCRIPTION OF OPERATIONS / LOCATIONS / VEHICLES (ACORD 101, Additional Remarks Schedule, may be attached if more space is required)
For Information Only

| | |
|--|---|
| CERTIFICATE HOLDER GameTime A Division of PlayCore Wisconsin, Inc. 150 PlayCore Drive SE Fort Payne, AL 35967 | CANCELLATION SHOULD ANY OF THE ABOVE DESCRIBED POLICIES BE CANCELLED BEFORE THE EXPIRATION DATE THEREOF, NOTICE WILL BE DELIVERED IN ACCORDANCE WITH THE POLICY PROVISIONS. AUTHORIZED REPRESENTATIVE of Marsh USA Inc. Manashi Mukherjee <i>Manashi Mukherjee</i> |
|--|---|



ADDITIONAL REMARKS SCHEDULE

| | | | |
|----------------------------------|------------------|--|--|
| AGENCY Marsh USA, Inc. | | NAMED INSURED GameTime A Division of PlayCore Wl, Inc. 150 PlayCore Drive SE Fort Payne, AL 35967 | |
| POLICY NUMBER | | EFFECTIVE DATE: | |
| CARRIER | NAIC CODE | | |

ADDITIONAL REMARKS

THIS ADDITIONAL REMARKS FORM IS A SCHEDULE TO ACORD FORM,
 FORM NUMBER: 25 FORM TITLE: Certificate of Liability Insurance

Workers' Compensation (Continued):

UB-2N106953-20-51-R (AZ, FL, OR, WI)

UB-2N159031-20-51-K (AK AL CO GA IA IL IN KS KY MD MI MN MO MT NC ND NE NV NY OH OK PA PR SC TN TX UT VA WA WY)

UB-7J602089-20-14-G (AZ CA CO CT FL GA ID IL IN KS MD MI MN MO MT NC NH NM NV NY OK OR PA SC TN TX WY)

INSURED: PLAYCORE GROUP, INC.

EFFECTIVE DATES: 08-01-2020 TO 08-01-2021

POLICY NUMBER: MKLV2PBC000784

COMMERCIAL GENERAL LIABILITY
CG 20 10 04 13

THIS ENDORSEMENT CHANGES THE POLICY. PLEASE READ IT CAREFULLY

ADDITIONAL INSURED – OWNERS, LESSEES OR CONTRACTORS – SCHEDULED PERSON OR ORGANIZATION

This endorsement modifies insurance provided under the following:

COMMERCIAL GENERAL LIABILITY COVERAGE PART

SCHEDULE

| Name Of Additional Insured Person(s) Or Organization(s) | Location(s) Of Covered Operations |
|--|-----------------------------------|
| As required by written contract executed by both parties prior to loss | All locations |
| Information required to complete this Schedule, if not shown above, will be shown in the Declarations. | |

A. Section II – Who Is An Insured is amended to include as an additional insured the person(s) or organization(s) shown in the Schedule, but only with respect to liability for "bodily injury", "property damage" or "personal and advertising injury" caused, in whole or in part, by:

1. Your acts or omissions; or
2. The acts or omissions of those acting on your behalf;

in the performance of your ongoing operations for the additional insured(s) at the location(s) designated above.

However:

1. The insurance afforded to such additional insured only applies to the extent permitted by law; and
2. If coverage provided to the additional insured is required by a contract or agreement, the insurance afforded to such additional insured will not be broader than that which you are required by the contract or agreement to provide for such additional insured.

B. With respect to the insurance afforded to these additional insureds, the following additional exclusions apply:

This insurance does not apply to "bodily injury" or "property damage" occurring after:

1. All work, including materials, parts or equipment furnished in connection with such work, on the project (other than service, maintenance or repairs) to be performed by or on behalf of the additional insured(s) at the location of the covered operations has been completed; or
2. That portion of "your work" out of which the injury or damage arises has been put to its intended use by any person or organization other than another contractor or subcontractor engaged in performing operations for a principal as a part of the same project.

C. With respect to the insurance afforded to these additional insureds, the following is added to **Section III – Limits Of Insurance:**

If coverage provided to the additional insured is required by a contract or agreement, the most we will pay on behalf of the additional insured is the amount of insurance:

1. Required by the contract or agreement; or

2. Available under the applicable Limits of Insurance shown in the Declarations;

whichever is less.

This endorsement shall not increase the applicable Limits of Insurance shown in the Declarations.

THIS ENDORSEMENT CHANGES THE POLICY. PLEASE READ IT CAREFULLY.

**ADDITIONAL INSURED – OWNERS, LESSEES OR
CONTRACTORS – COMPLETED OPERATIONS**

This endorsement modifies insurance provided under the following:

COMMERCIAL GENERAL LIABILITY COVERAGE PART
PRODUCTS/COMPLETED OPERATIONS LIABILITY COVERAGE PART

SCHEDULE

| Name Of Additional Insured Person(s) Or Organization(s) | Location And Description Of Completed Operations |
|--|--|
| As required by written contract executed by both parties prior to loss | All locations |
| Information required to complete this Schedule, if not shown above, will be shown in the Declarations. | |

A. Section II – Who Is An Insured is amended to include as an additional insured the person(s) or organization(s) shown in the Schedule, but only with respect to liability for "bodily injury" or "property damage" caused, in whole or in part, by "your work" at the location designated and described in the Schedule of this endorsement performed for that additional insured and included in the "products-completed operations hazard".

However:

1. The insurance afforded to such additional insured only applies to the extent permitted by law; and
2. If coverage provided to the additional insured is required by a contract or agreement, the insurance afforded to such additional insured will not be broader than that which you are required by the contract or agreement to provide for such additional insured.

B. With respect to the insurance afforded to these additional insureds, the following is added to Section III – Limits Of Insurance:

If coverage provided to the additional insured is required by a contract or agreement, the most we will pay on behalf of the additional insured is the amount of insurance:

1. Required by the contract or agreement; or
 2. Available under the applicable Limits of Insurance shown in the Declarations;
- whichever is less.

This endorsement shall not increase the applicable Limits of Insurance shown in the Declarations.

THIS ENDORSEMENT CHANGES THE POLICY. PLEASE READ IT CAREFULLY.

BLANKET ADDITIONAL INSURED

This endorsement modifies insurance provided under the following:

**BUSINESS AUTO COVERAGE FORM
MOTOR CARRIER COVERAGE FORM**

The following is added to Paragraph c. in A.1., **Who Is An Insured**, of **SECTION II – COVERED AUTOS LIABILITY COVERAGE** in the **BUSINESS AUTO COVERAGE FORM** and Paragraph e. in A.1., **Who Is An Insured**, of **SECTION II – COVERED AUTOS LIABILITY COVERAGE** in the **MOTOR CARRIER COVERAGE FORM**, whichever Coverage Form is part of your policy:

This includes any person or organization who you are required under a written contract or agreement

between you and that person or organization, that is signed by you before the "bodily injury" or "property damage" occurs and that is in effect during the policy period, to name as an additional insured for Covered Autos Liability Coverage, but only for damages to which this insurance applies and only to the extent of that person's or organization's liability for the conduct of another "insured".

Request for Taxpayer Identification Number and Certification

**Give Form to the
requester. Do not
send to the IRS.**

▶ Go to www.irs.gov/FormW9 for instructions and the latest information.

Print or type.
See Specific Instructions on page 3.

| | |
|---|--|
| 1 Name (as shown on your income tax return). Name is required on this line; do not leave this line blank. PlayCore Wisconsin Inc | |
| 2 Business name/disregarded entity name, if different from above dba GameTime | |
| 3 Check appropriate box for federal tax classification of the person whose name is entered on line 1. Check only one of the following seven boxes. <input type="checkbox"/> Individual/sole proprietor or single-member LLC <input checked="" type="checkbox"/> C Corporation <input type="checkbox"/> S Corporation <input type="checkbox"/> Partnership <input type="checkbox"/> Trust/estate <input type="checkbox"/> Limited liability company. Enter the tax classification (C=C corporation, S=S corporation, P=Partnership) ▶ _____ <small>Note: Check the appropriate box in the line above for the tax classification of the single-member owner. Do not check LLC if the LLC is classified as a single-member LLC that is disregarded from the owner unless the owner of the LLC is another LLC that is not disregarded from the owner for U.S. federal tax purposes. Otherwise, a single-member LLC that is disregarded from the owner should check the appropriate box for the tax classification of its owner.</small> <input type="checkbox"/> Other (see instructions) ▶ _____ | 4 Exemptions (codes apply only to certain entities, not individuals; see instructions on page 3): Exempt payee code (if any) 5 Exemption from FATCA reporting code (if any) N/a <small>(Applies to accounts maintained outside the U.S.)</small> |
| 5 Address (number, street, and apt. or suite no.) See instructions. 150 PlayCore Drive S.E. | Requester's name and address (optional) |
| 6 City, state, and ZIP code Fort Payne Alabama 35967 | |
| 7 List account number(s) here (optional) ** Remit to PO Box 680121 Fort Payne, AL. 35968 ** | |

Part I Taxpayer Identification Number (TIN)

Enter your TIN in the appropriate box. The TIN provided must match the name given on line 1 to avoid backup withholding. For individuals, this is generally your social security number (SSN). However, for a resident alien, sole proprietor, or disregarded entity, see the instructions for Part I, later. For other entities, it is your employer identification number (EIN). If you do not have a number, see *How to get a TIN*, later.

Note: If the account is in more than one name, see the instructions for line 1. Also see *What Name and Number To Give the Requester* for guidelines on whose number to enter.

| | | | | | | | | | | | | | |
|---|---|---|---|---|---|---|---|---|---|---|--|--|--|
| Social security number | | | | | | | | | | | | | |
| <table style="width: 100%; border-collapse: collapse;"> <tr> <td style="border: 1px solid black; width: 20px; height: 20px;"></td> <td style="border: 1px solid black; width: 20px; height: 20px;"></td> <td style="border: 1px solid black; width: 20px; height: 20px;"></td> <td style="border: 1px solid black; width: 20px; height: 20px;"></td> <td style="border: 1px solid black; width: 20px; height: 20px;"></td> <td style="border: 1px solid black; width: 20px; height: 20px;"></td> <td style="border: 1px solid black; width: 20px; height: 20px;"></td> <td style="border: 1px solid black; width: 20px; height: 20px;"></td> <td style="border: 1px solid black; width: 20px; height: 20px;"></td> <td style="border: 1px solid black; width: 20px; height: 20px;"></td> <td style="border: 1px solid black; width: 20px; height: 20px;"></td> <td style="border: 1px solid black; width: 20px; height: 20px;"></td> </tr> </table> | | | | | | | | | | | | | |
| | | | | | | | | | | | | | |
| OR | | | | | | | | | | | | | |
| Employer identification number | | | | | | | | | | | | | |
| <table style="width: 100%; border-collapse: collapse;"> <tr> <td style="border: 1px solid black; width: 20px; height: 20px; text-align: center;">3</td> <td style="border: 1px solid black; width: 20px; height: 20px; text-align: center;">9</td> <td style="border: 1px solid black; width: 20px; height: 20px; text-align: center;">-</td> <td style="border: 1px solid black; width: 20px; height: 20px; text-align: center;">1</td> <td style="border: 1px solid black; width: 20px; height: 20px; text-align: center;">7</td> <td style="border: 1px solid black; width: 20px; height: 20px; text-align: center;">2</td> <td style="border: 1px solid black; width: 20px; height: 20px; text-align: center;">0</td> <td style="border: 1px solid black; width: 20px; height: 20px; text-align: center;">4</td> <td style="border: 1px solid black; width: 20px; height: 20px; text-align: center;">8</td> <td style="border: 1px solid black; width: 20px; height: 20px; text-align: center;">0</td> </tr> </table> | 3 | 9 | - | 1 | 7 | 2 | 0 | 4 | 8 | 0 | | | |
| 3 | 9 | - | 1 | 7 | 2 | 0 | 4 | 8 | 0 | | | | |

Part II Certification

Under penalties of perjury, I certify that:

1. The number shown on this form is my correct taxpayer identification number (or I am waiting for a number to be issued to me); and
2. I am not subject to backup withholding because: (a) I am exempt from backup withholding, or (b) I have not been notified by the Internal Revenue Service (IRS) that I am subject to backup withholding as a result of a failure to report all interest or dividends, or (c) the IRS has notified me that I am no longer subject to backup withholding; and
3. I am a U.S. citizen or other U.S. person (defined below); and
4. The FATCA code(s) entered on this form (if any) indicating that I am exempt from FATCA reporting is correct.

Certification instructions. You must cross out item 2 above if you have been notified by the IRS that you are currently subject to backup withholding because you have failed to report all interest and dividends on your tax return. For real estate transactions, item 2 does not apply. For mortgage interest paid, acquisition or abandonment of secured property, cancellation of debt, contributions to an individual retirement arrangement (IRA), and generally, payments other than interest and dividends, you are not required to sign the certification, but you must provide your correct TIN. See the instructions for Part II, later.

| | | |
|------------------|---|---|
| Sign Here | Signature of U.S. person ▶ Melissa Ben | Date ▶ Jan 7, 2021 |
|------------------|---|---|

General Instructions

Section references are to the Internal Revenue Code unless otherwise noted.

Future developments. For the latest information about developments related to Form W-9 and its instructions, such as legislation enacted after they were published, go to www.irs.gov/FormW9.

Purpose of Form

An individual or entity (Form W-9 requester) who is required to file an information return with the IRS must obtain your correct taxpayer identification number (TIN) which may be your social security number (SSN), individual taxpayer identification number (ITIN), adoption taxpayer identification number (ATIN), or employer identification number (EIN), to report on an information return the amount paid to you, or other amount reportable on an information return. Examples of information returns include, but are not limited to, the following.

- Form 1099-INT (interest earned or paid)

- Form 1099-DIV (dividends, including those from stocks or mutual funds)
 - Form 1099-MISC (various types of income, prizes, awards, or gross proceeds)
 - Form 1099-B (stock or mutual fund sales and certain other transactions by brokers)
 - Form 1099-S (proceeds from real estate transactions)
 - Form 1099-K (merchant card and third party network transactions)
 - Form 1098 (home mortgage interest), 1098-E (student loan interest), 1098-T (tuition)
 - Form 1099-C (canceled debt)
 - Form 1099-A (acquisition or abandonment of secured property)
- Use Form W-9 only if you are a U.S. person (including a resident alien), to provide your correct TIN.
- If you do not return Form W-9 to the requester with a TIN, you might be subject to backup withholding. See What is backup withholding, later.*

STATE OF ALABAMA

CONTROL NO.
20849

ACCOUNT NO.
551 2021



County
DEKALB



LICENSE NO.
0209

9:52 am jwilson

ISSUED TO:

LICENSE YEAR
2020 - 2021

**GAMETIME
PLAYCORE INC.
P.O. BOX 680121
FORT PAYNE AL 35968**

| DATE ISSUED | | |
|-------------|-----|----|
| 10 | 9 | 20 |
| MO | DAY | YR |

| LICENSE TYPE | |
|----------------------|---|
| STORE LICENSE | |
| CHAIN STORE LICENSE | |
| OCCUPATIONAL LICENSE | X |

BUSINESS LOCATION:

**GAMETIME
150 PLAYCORE DR SE
FORT PAYNE AL 35967**

**EXPIRES
September 30, 2021**

| SECTION | BUSINESS TYPE | LICENSE AMOUNT | FEE | PENALTY | CITATION | INTEREST | TOTAL | |
|--|----------------------------|----------------|--------|---------|----------|----------|---------------------------|-----------------|
| 064-001 | contractor over 200,000 | \$375.00 | \$1.00 | | | | \$376.00 | |
| 067-001 | manufacturing tools & over | \$300.00 | \$1.00 | | | | \$301.00 | |
| TRANSFER OF LICENSE | | | | | | | TOTAL | \$677.00 |
| Evidence having been adduced before me that a bona fide sale of the business by this certificate has been made by licensee, this license is transferred to said purchaser. | | | | | | | OTHER FEE | \$0.00 |
| | | | | | | | TOT WITH OTHER FEE | \$677.00 |

Kathleen D. Baxter
State Comptroller

Vernon Barnett
Commissioner of Revenue

Ronnie Osborn, Probate Judge
Issuing Authority



Name of Purchaser

Issuing Authority

**RENEW LICENSE
OCTOBER 1st THROUGH OCTOBER 31st**

Ron DeSantis, Governor



Julie I. Brown, Secretary



STATE OF FLORIDA
DEPARTMENT OF BUSINESS AND PROFESSIONAL REGULATION

CONSTRUCTION INDUSTRY LICENSING BOARD

THE BUILDING CONTRACTOR HEREIN IS CERTIFIED UNDER THE
PROVISIONS OF CHAPTER 489, FLORIDA STATUTES



LICENSE NUMBER: CBC1264755

EXPIRATION DATE: AUGUST 31, 2022

Always verify licenses online at MyFloridaLicense.com



Do not alter this document in any form.

This is your license. It is unlawful for anyone other than the licensee to use this document.

BIDDER'S INITIAL SECTION 3 GOALS

- 1. The Bidder agrees to comply with Section 3 of the Housing and Urban Development Act of 1968.
- 2. The Bidder estimates that there will be 0 New employees hired during the performance of this contract. Furthermore, should this contract be let to the Bidder, the Bidder agrees to delineate work force needs (skilled, semi-skilled, unskilled, labor and trainees) by category.
- 3. Of these new employees, the Bidder plans to hire at least % (percent) from the Section 3 Covered Area (Broward County).

I, Rob Dominica (please print), as an Authorized Officer of the Bidder, do hereby acknowledge that we are aware of the requirements under Section 3 of the Housing and Urban Development Act of 1968 and will abide by them. We further agree to abide by this Affirmative Action Plan to the greatest extent feasible and realize that should we be awarded the contract, Broward County Community Development Division will monitor the project to assure compliance with this plan.

Company Name: PlayCore Wisconsin DBA GameTime

Business Address: PO Box 520700 Longwood, FL. 32752

39-1720480
Employer Federal ID #

Rob Dominica
Printed Name

Signature
Rob Dominica

7-27-21
Date

**** Please Note Section 3 Clause**

SECTION 3
UNAVAILABILITY CERTIFICATION

I, Rob Dominica, Pres/drp Registered agent GameTime
(Title)

of PlayCore Wisconsin DBA GameTime
(Prime Contractor)

Certify that the undersigned does not have any entry-level jobs available. However, should such jobs become available during the project period, the undersigned agrees to accept referrals from Workforce One to interview these referrals for the available positions.

(If incorporated sign here)

ATTEST

PlayCore Wisconsin DBA GameTime
CONTRACTOR

Secretary

By 

Rob Dominica

(CORPORATE SEAL)

Seal is not at this office as it is office of Registered agent

(If not incorporated sign here)

WITNESSES:

CONTRACTOR

By _____